

**01 DOOR TYPE IDT10 - NBS REF L20/250A**  
1 : 20

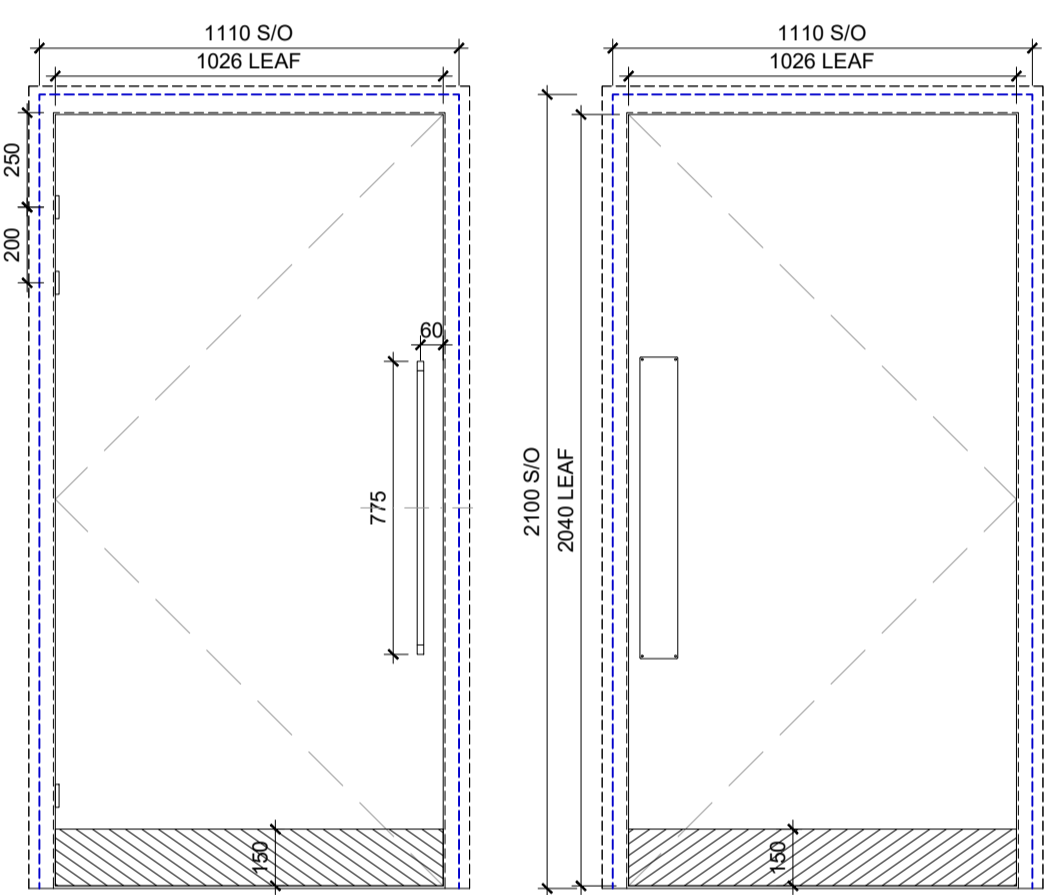

**02 DOOR TYPE EXT01 - NBS REF L20/480B**  
1 : 20

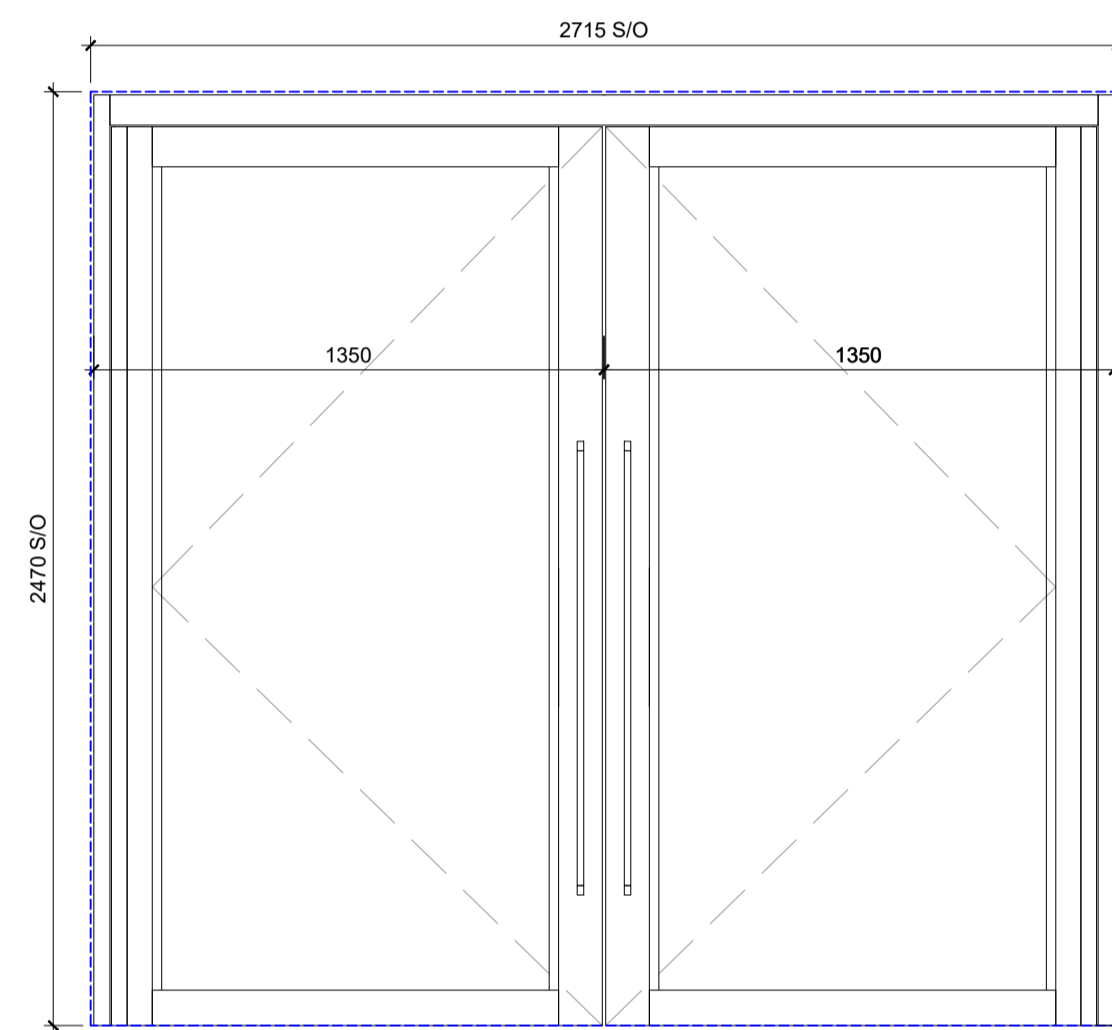

**03 DOOR TYPE EXT02 - NBS REF L20/480A**  
1 : 20

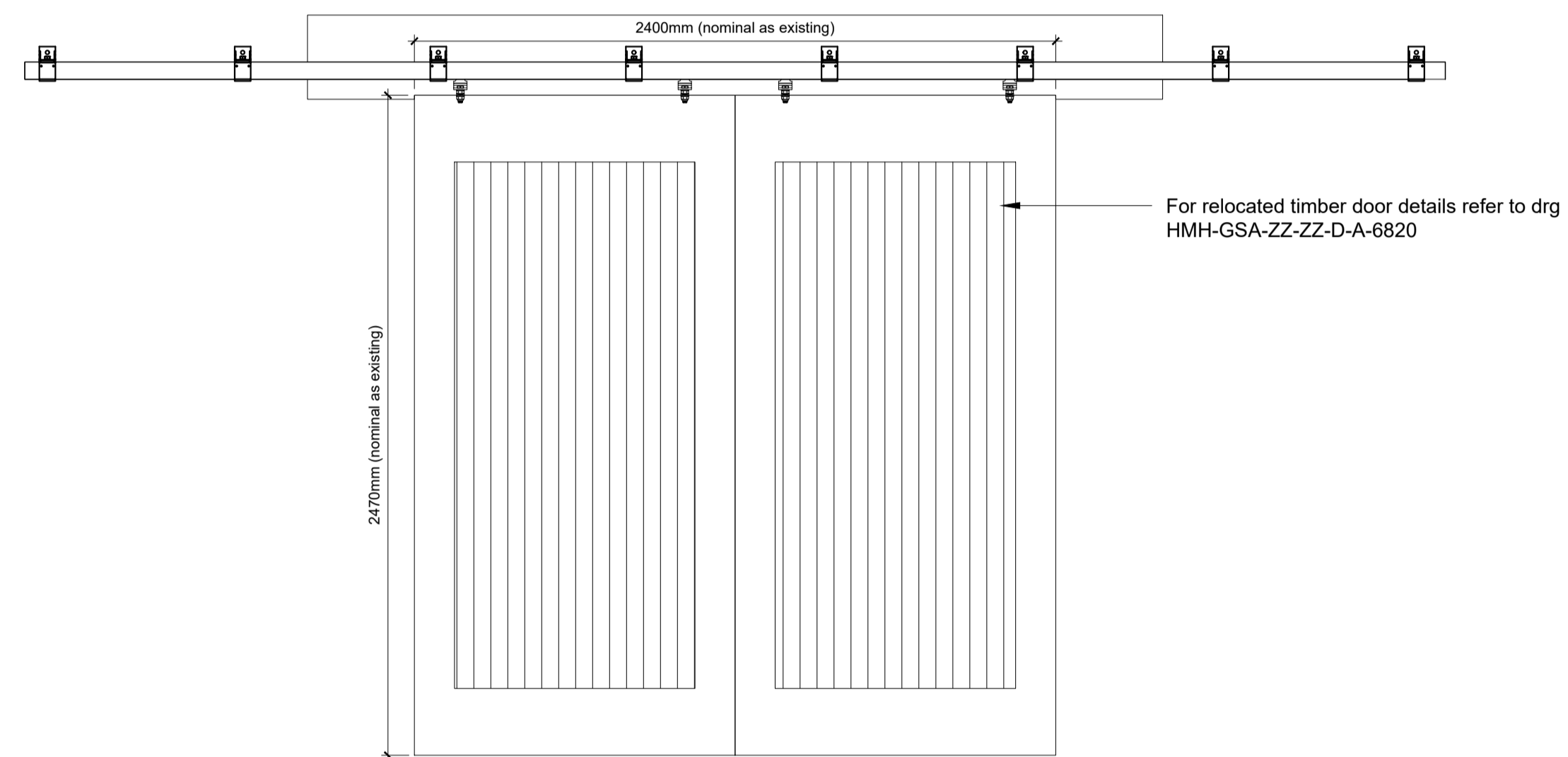

**04 DOOR TYPE EXT03 - NBS REF L20/520A**  
1 : 20

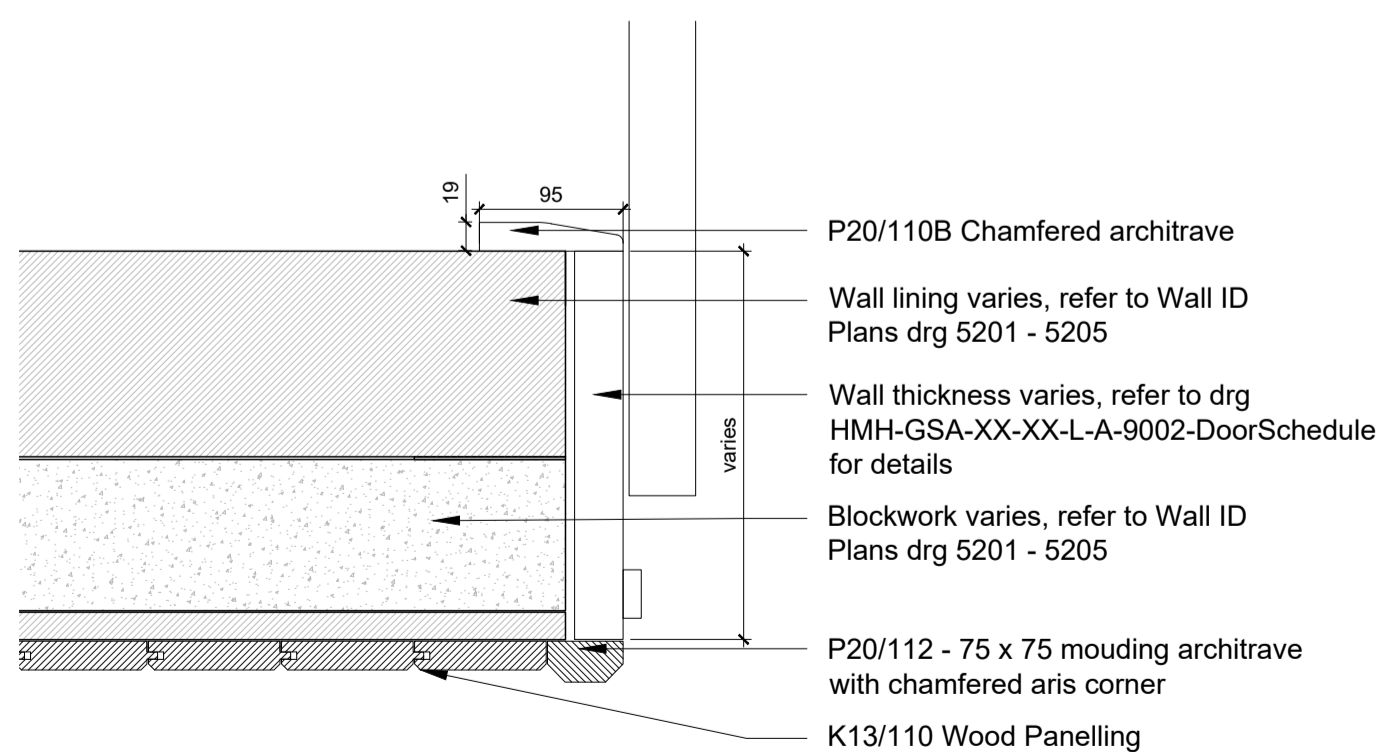

**05 TYPICAL DOOR JAMB TYPE 01**  
1 : 5

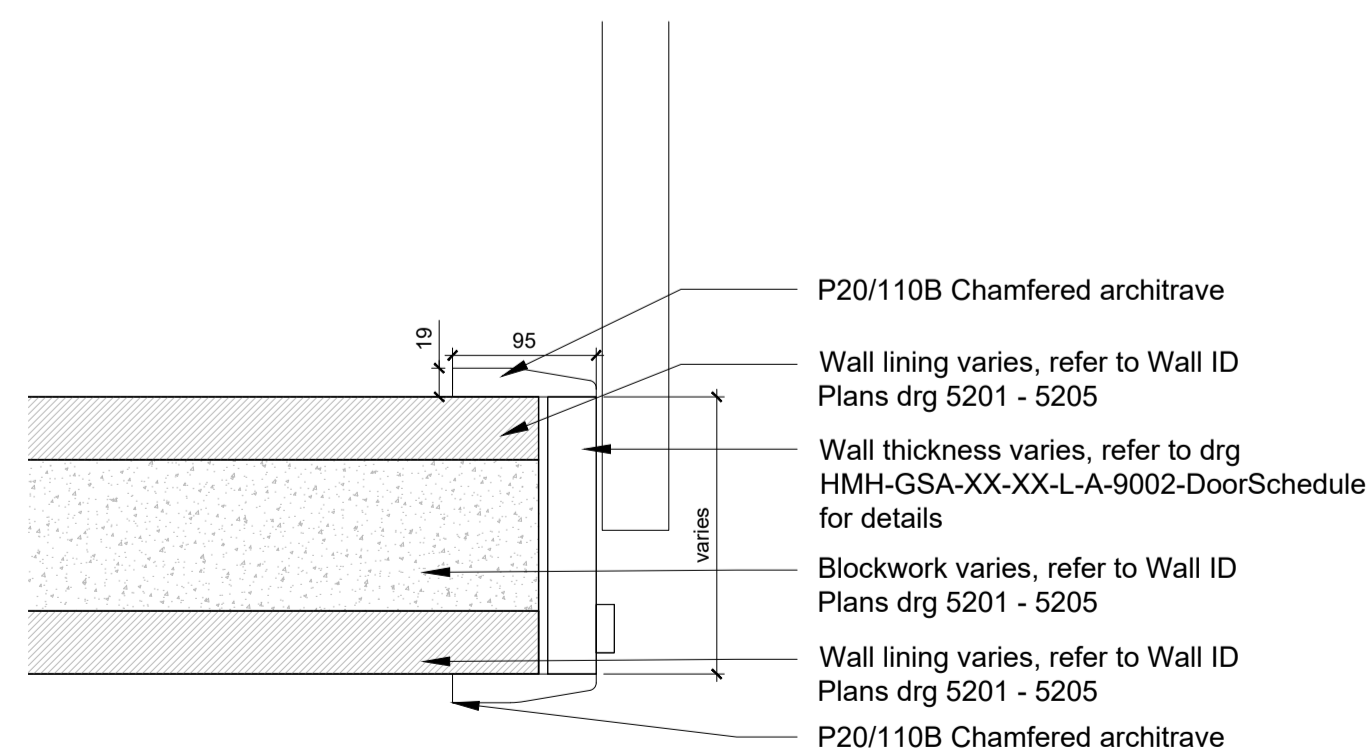

**06 TYPICAL DOOR JAMB TYPE 02**  
1 : 5

Do not remove this panel from this drawing. Do not scale from this drawing. All dimensions and levels are to be checked on site. All discrepancies, errors and omissions must be reported immediately to Greig and Stephenson Ltd. The contractor is responsible for setting out, checking and confirming all site conditions prior to fabrication and construction. All building and fabrication works are to be carried out in accordance with the Local and National Building Codes, practices and standards.

This drawing is copyright and must not be reproduced without the written consent of Greig and Stephenson Ltd. Greig and Stephenson Ltd. accept no responsibility for any loss or expenses arising from use of this drawing for any purpose other than those agreed in writing by Greig and Stephenson Ltd. This drawing is not to be used by any third party without the written consent of Greig and Stephenson Ltd.

NOTE: FOR DOOR SCHEDULE REFER TO: HMH-GSA-XX-XX-L-A-9002  
NOTE: All dimensions indicated are to be verified on site prior to commencement of fabrication or installation. Any discrepancies are to be reported.

REVISIONS	DATE	COMMENT	DRW	CHK
P02	16/01/26	Issue for tender - door jamb types included	TB	NM
P01	14/11/25	Issue for tender	TB	NM

**Greig & Stephenson Architects**  
Studio SW.201, Screenworks  
22 Highbury Grove  
London, N5 2ER  
tel. 020 7403 5511  
fax. 020 7403 5544  
email. info@gands.co.uk

CLIENT KIRKLEES COUNCIL

PROJECT HUDDERSFIELD MARKET

STATUS S4 - FOR TENDER

DRAWING DOOR TYPE ELEVATIONS SHEET 02  
INTERNAL DOOR TYPE 10  
EXTERNAL DOOR TYPE 1/2/3  
DOOR JAMB TYPE DETAILS

SCALE	DRAWN	CHECKED	DATE
1:20 @ A1	TB	NM	12/11/2025

DRAWING NUMBER	REVISION
HMH-GSA-ZZ-ZZ-D-A-6801	P02

