



**The MaxiCharger is a wall or pedestal-mounted, smart, single-outlet universal Type 2 socket EV charger. It is OCPP 1.6j compliant, has built-in PME fault detection on single and three-phase connection, and both static load management and dynamic load balancing capabilities.**

The MaxiCharger is robust, aesthetically pleasing, and suitable for all environments. Allowing EV drivers to charge with 7.4 kW charging speed, the MaxiCharger is an ideal charging solution for domestic and commercial requirements.



Product Code	Product Name and Description
EVAUTDSSEVO-BLK	MaxiCharger Smart Online AC Wallbox 7.4 kW - Socket (Black)
EVAUTDS4GSEVO	MaxiCharger Smart 4G AC Wallbox 7.4 kW - Socket (Black)

Technical Specification	
Charging type	Mode 3, Type 2
Charging power	7.4 kW on single-phase
Rated current	32 A/16 A
Rated frequency	50 Hz
Input/output voltage	230 V±10%: L1, N, PE
Network type	TT, TN
RCD	Integrated 6mA DC + 30mA AC leakage detection
Protection	Overcurrent, overvoltage, undervoltage, ground fault including DC residual current protection, integrated surge protection
PME fault detection	Incorporated within the unit

User Interface	
Status indication	LED/APP
User interface	MaxiCharger APP, MaxiCharger Service Software, web portal
Connectivity	Bluetooth, Wi-Fi, Ethernet, 4G (SIM not included)
Communication protocols	OCPP 1.6j
User authentication	APP, RFID card, QR code



### General Characteristics

IP and IK rating	IP54, IK08
Operating altitude	2000 m
Operating temperature range	-40°C ~ + 55°C
Storage temperature range	-40°C ~ + 85°C
Mounting	Wall or floor using a pedestal
Weight	3600 g
Dimensions (WxHxD)	187 mm x 336 mm x 85 mm

### Software Update

Software update	APP or web portal
-----------------	-------------------

### Certification and Standards

Safety standards	EN/IEC 61851-1, EN/IEC 62196-2, EN/IEC 62955, BS7671
Certification	CE, UKCA (TUV) Compliant to the Electric Vehicles (Smart Charge Points) Regulations 2021, inc. Schedule 1
Warranty	36 months

# PRODUCT OVERVIEW

## MaxiCharger

PRODUCT NAME	PRODUCT CODE	CONNECTION TYPE	CHARGING POWER	INPUT/OUTPUT VOLTAGE
<del>MaxiCharger Smart Online AC Wallbox 7.4kW - Socket</del>	<del>EVAUTDSSEVOB</del>	<del>Type 2 charging socket</del>	<del>Single-phase: 7.4kW</del>	<del>230 V±10%: L1, N, PE</del>
<b>MaxiCharger Smart 4G AC Wallbox 7.4kW - Socket</b>	EVAUTDS4GSEVOB	Type 2 charging socket	Single-phase: 7.4kW	230 V±10%: L1, N, PE
<del>MaxiCharger 3 Phase Smart 4G AC Wallbox 11kW/22kW Socket</del>	<del>EVAUTCS4GSEVB</del>	<del>Type 2 charging socket</del>	<del>Three-phase: 11kW/22kW</del>	<del>400 V±15%: L1, L2, L3, N, PE</del>
<del>MaxiCharger 3 Phase 4G AC Wallbox with LCD Screen 11kW/22kW Socket (or down-rated to 7.4kW)</del>	<del>EVAUTCS4GLCD</del>	<del>Type 2 charging socket</del>	<del>Single-phase: 7.4kW Three-phase: 11kW/22kW</del>	<del>Single-phase: 230 V±10%: L1, N, PE Three-phase: 400 V±15%: L1, L2, L3, N, PE</del>

## MaxiCharger Pedestal Accessories

PRODUCT NAME	PRODUCT CODE	MATERIAL	WEIGHT	DIMENSIONS
<b>Universal Pedestal (Single/Dual)</b>	BEVSPLUP	Powder-coated mild steel	12.9kg	Post: 75 x 1160 x 75mm (W x H x D) Base: 280 x 10 x 280mm (W x H x D)

UNIVERSAL PEDESTAL  
TOP VIEW  
SINGLE/DUAL

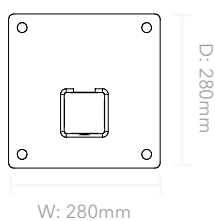

UNIVERSAL PEDESTAL  
FRONT VIEW  
SINGLE/DUAL

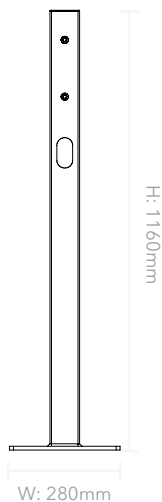

UNIVERSAL PEDESTAL  
SIDE VIEW  
SINGLE/DUAL

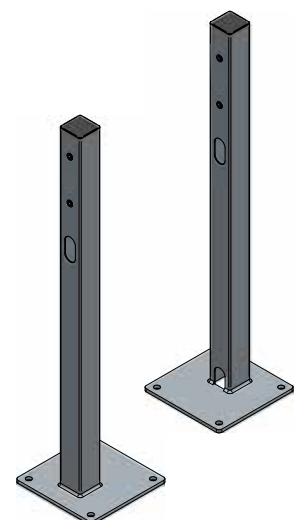

# TECHNICAL DATA

<b>CHARGING TYPE</b>	Mode 3, Type 2
<b>RATED CURRENT</b>	32 A/16 A
<b>RATED FREQUENCY</b>	50Hz
<b>NETWORK TYPE</b>	TT, TN
<b>RCD &amp; PROTECTION</b>	<ul style="list-style-type: none"> <li>• Integrated 6mA DC + 30mA AC leakage detection</li> <li>• Overcurrent</li> <li>• Overvoltage</li> <li>• Undervoltage</li> <li>• Integrated surge protection</li> </ul>
<b>PME FAULT DETECTION/PEN PROTECTION</b>	Yes ( <i>incorporated within the unit</i> )
<b>LOAD MANAGEMENT</b>	Intergrated static load management. Dynamic load balancing capabilities
<b>MATERIAL (MAXICHARGER)</b>	Plastic, full specification available upon request
<b>MATERIAL (UNIVERSAL POLE)</b>	Powder-coated mild steel
<b>IP &amp; IK RATING</b>	IP54, IK08
<b>OPERATING ALTITUDE</b>	2000m
<b>OPERATING TEMPERATURE RANGE</b>	-40°C ~ + 55°C
<b>OPERATING STORAGE RANGE</b>	-40°C ~ + 85°C
<b>WEIGHT (MAXICHARGER)</b>	3.6kg (Single-phase) 3.92kg (Three-phase)
<b>WEIGHT (UNIVERSAL POLE)</b>	12.9kg
<b>DIMENSIONS</b>	187 mm x 336 mm x 85 mm (W x H x D)
<b>SAFETY STANDARDS</b>	EN/IEC 61851-1, EN/IEC 62196-2, EN/IEC 62955, BS7671
<b>CERTIFICATION</b>	CE, UKCA (TUV) compliant to the electric vehicles ( <i>Smart charge points</i> ) regulations 2021, inc. schedule 1
<b>WARRANTY</b>	3 years as standard ( <i>optional 3 year extension available</i> )

FRONT VIEW



REAR VIEW

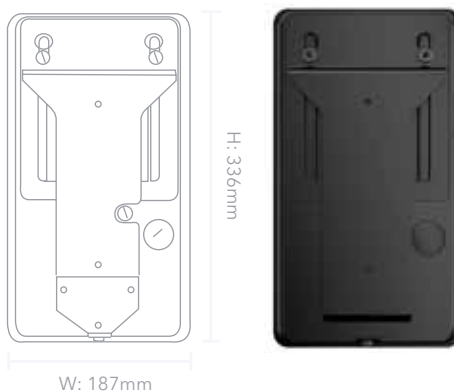

SIDE VIEW

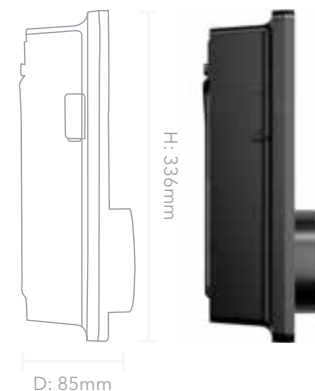

**Ensure duct/s for power and data are located within base to suit charger type.**

**MaxiCharger central to base / Universal pedestal offset on base.**

Based on group bearing capacity of 75kN/m<sup>2</sup> and assuming that the weight of the equipment is no more than 2.6kN (260kg)

The base can be buried or protrude above ground, if protrude above ground we would recommend 25mm chamfer to all exposed edges/corners.

Concrete grade to be PAV2 concrete.

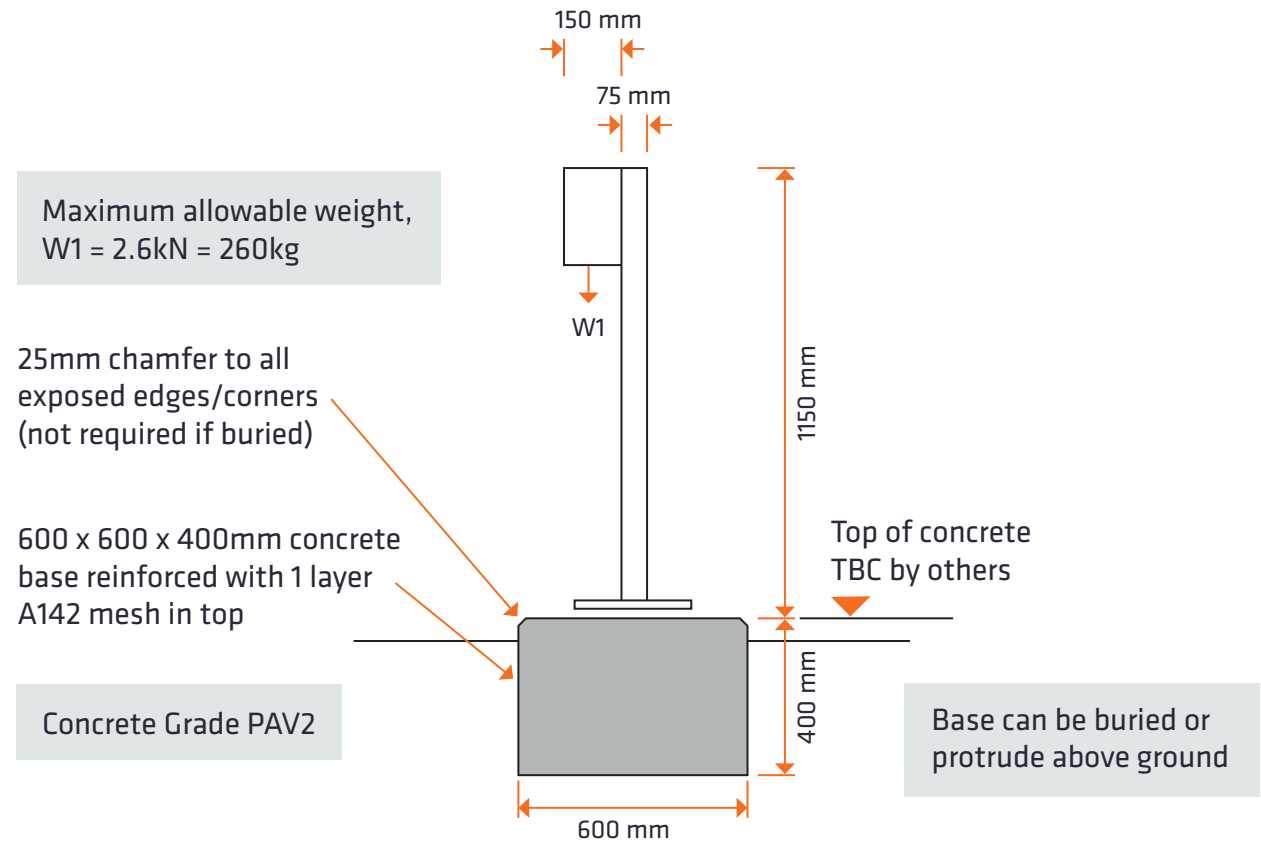

**EV Charger Concrete Base**