

VIEWPORT 1 - 16.5m ARTIC
ACCESS AND EGRESS TO SITE

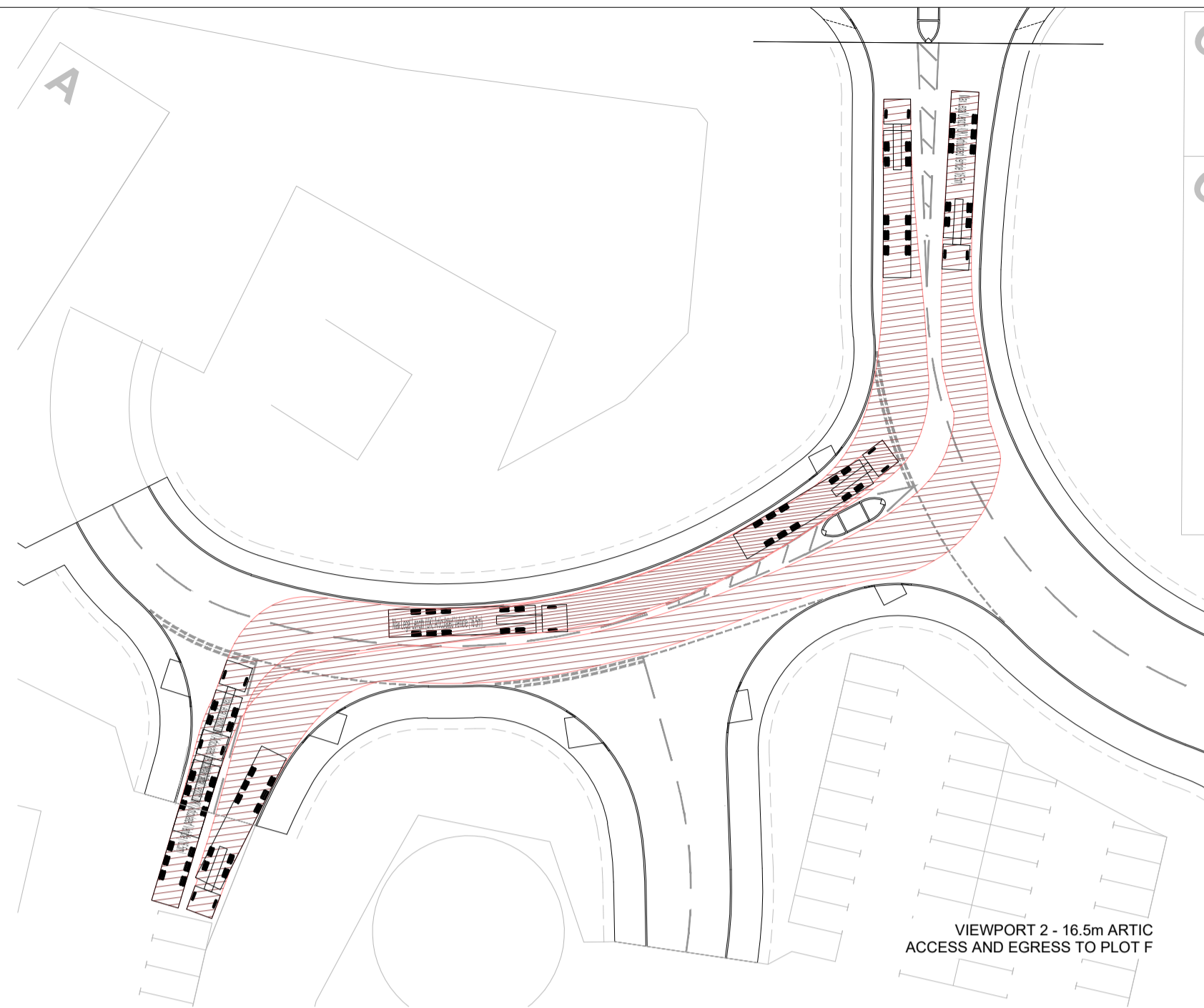

VIEWPORT 2 - 16.5m ARTIC
ACCESS AND EGRESS TO PLOT F

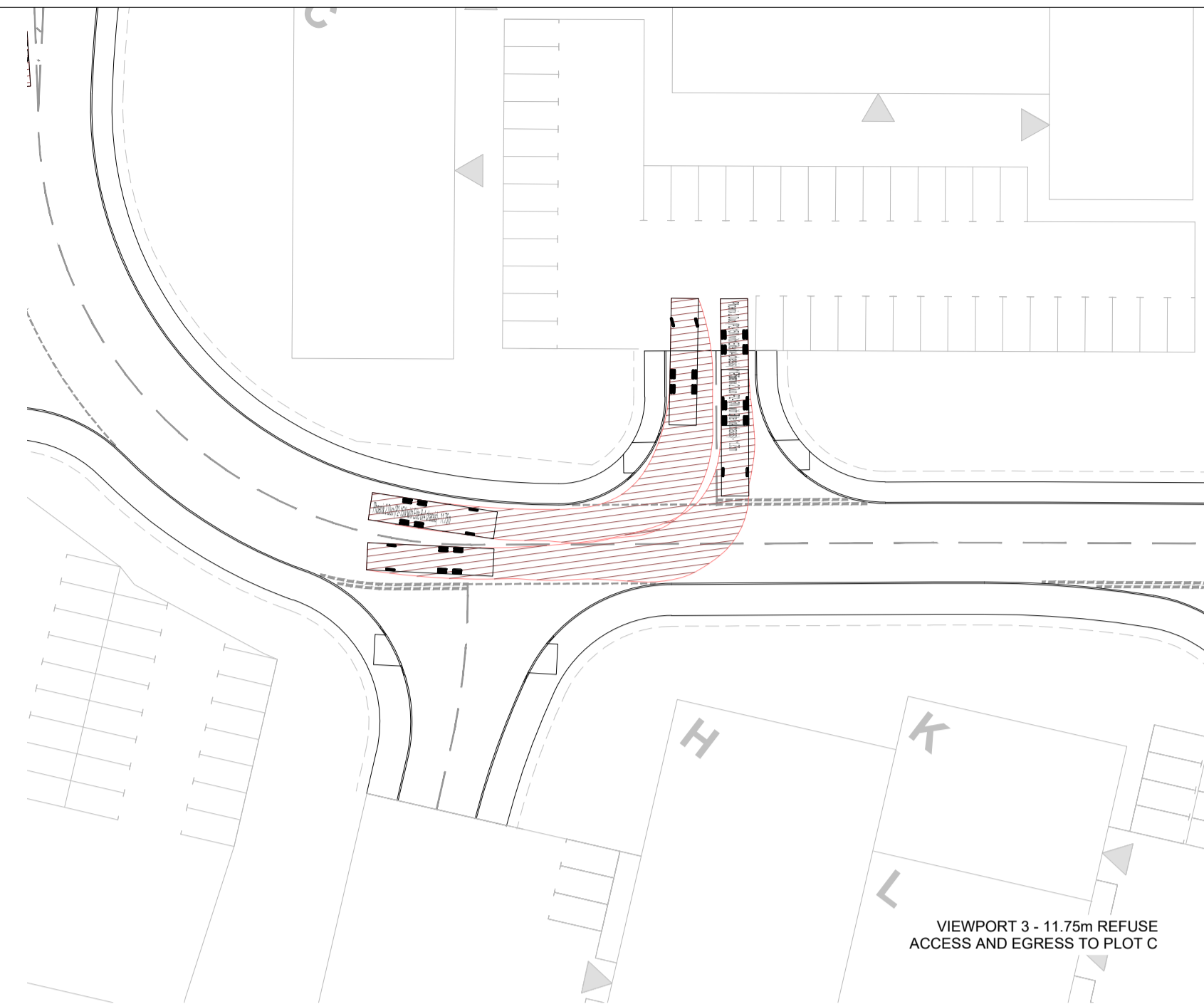

VIEWPORT 3 - 11.75m REFUSE
ACCESS AND EGRESS TO PLOT C

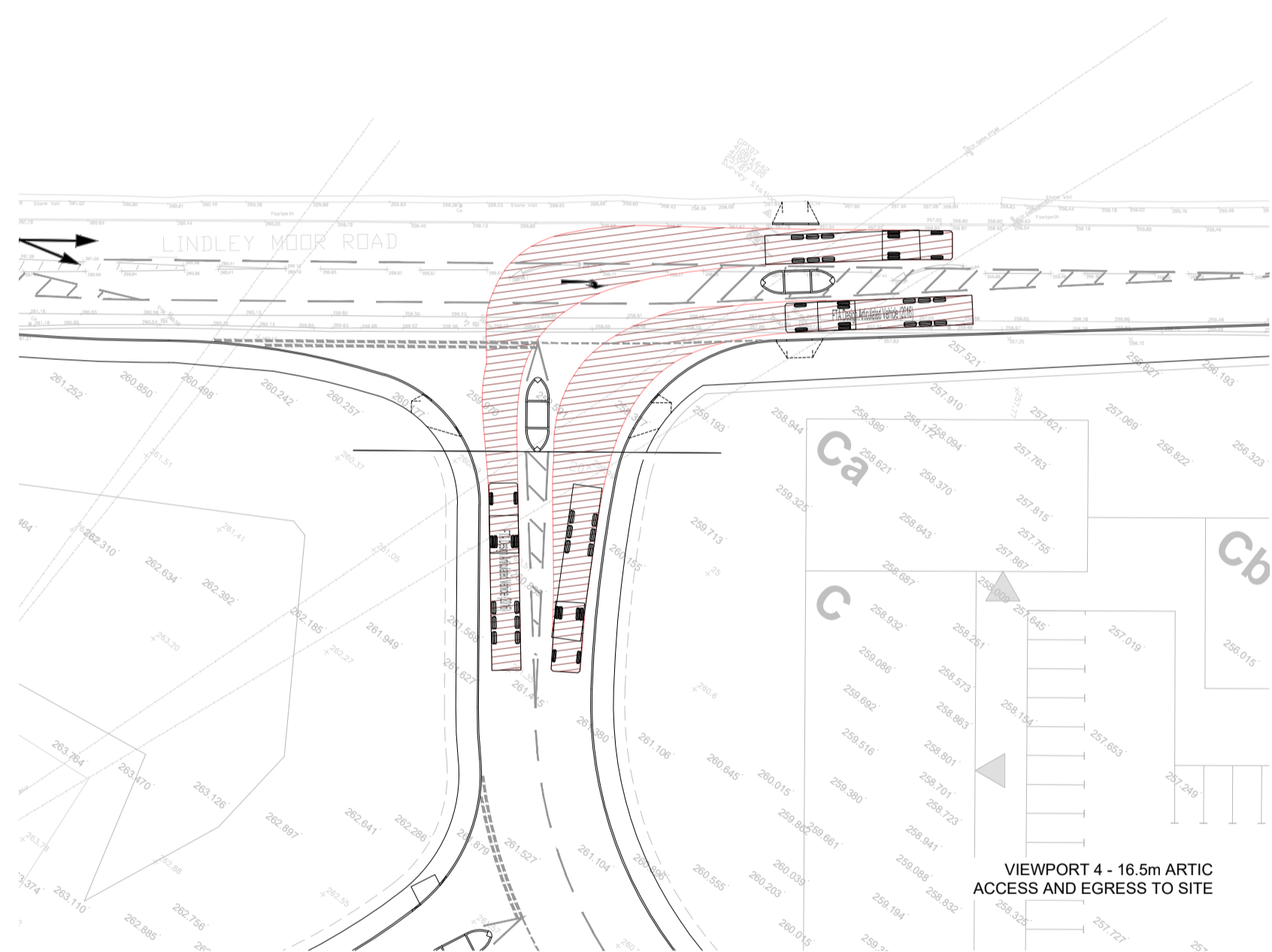

VIEWPORT 4 - 16.5m ARTIC
ACCESS AND EGRESS TO SITE

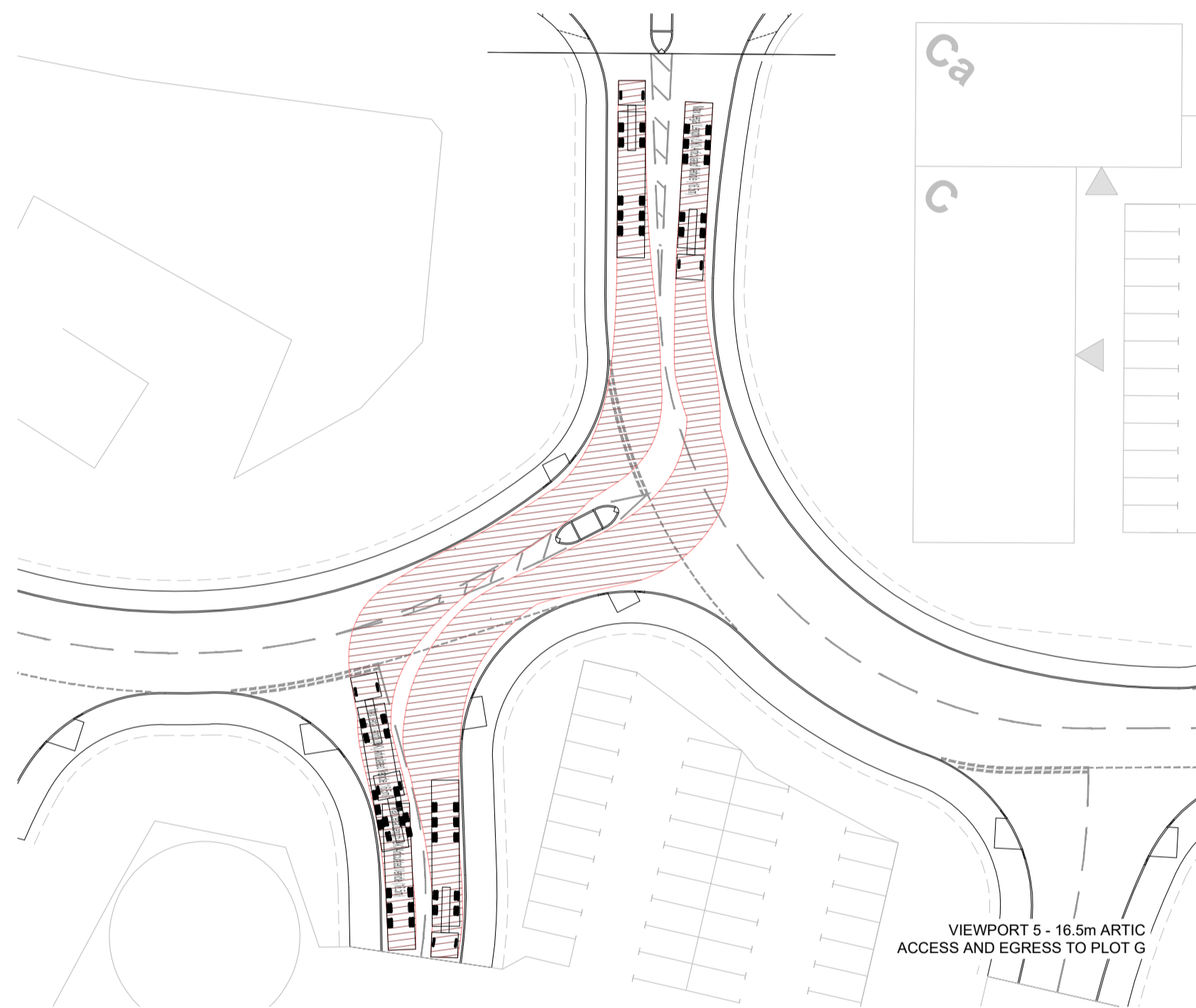

VIEWPORT 5 - 16.5m ARTIC
ACCESS AND EGRESS TO PLOT G

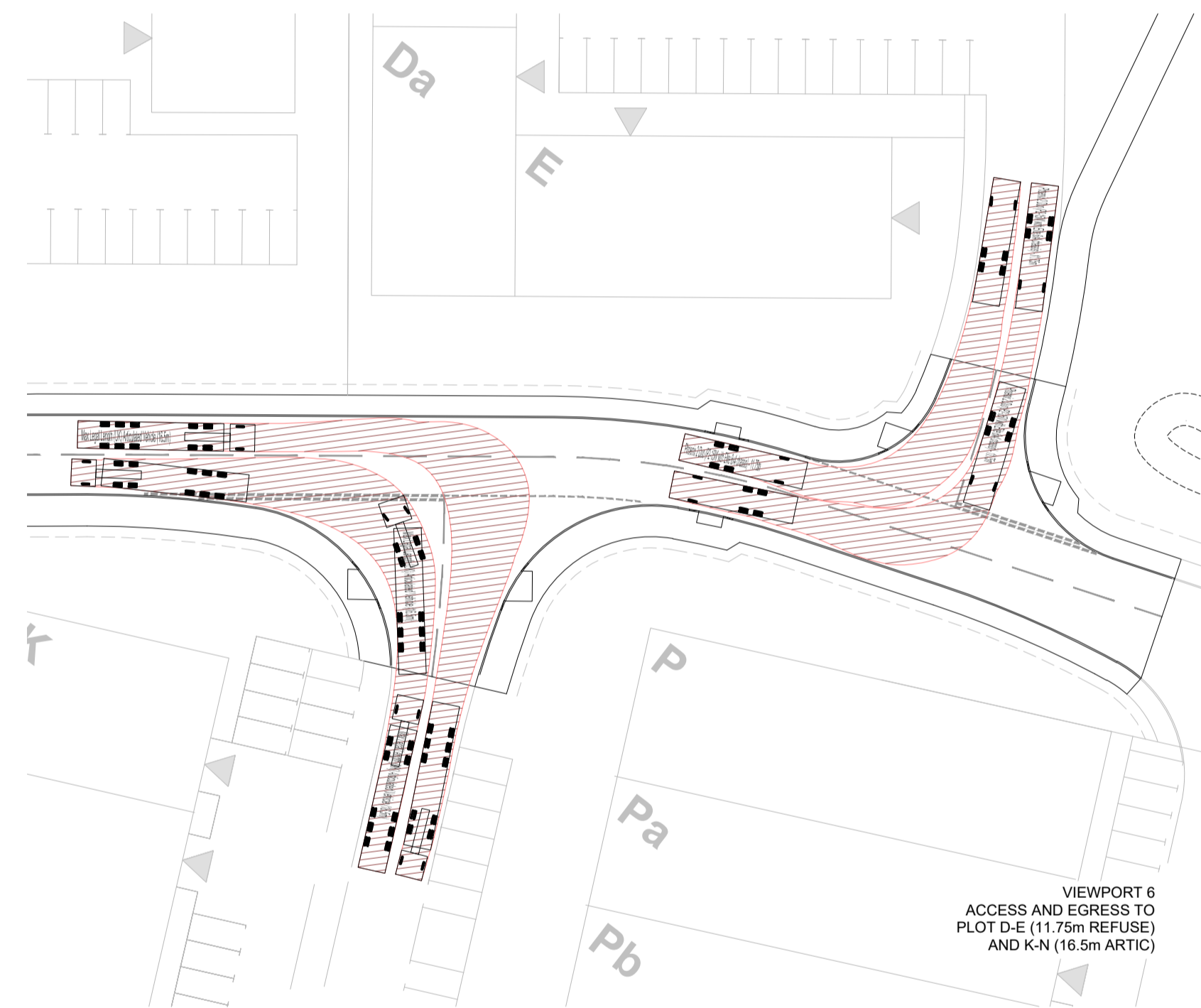

VIEWPORT 6
ACCESS AND EGRESS TO
PLOT D-E (11.75m REFUSE)
AND K-N (16.5m ARTIC)

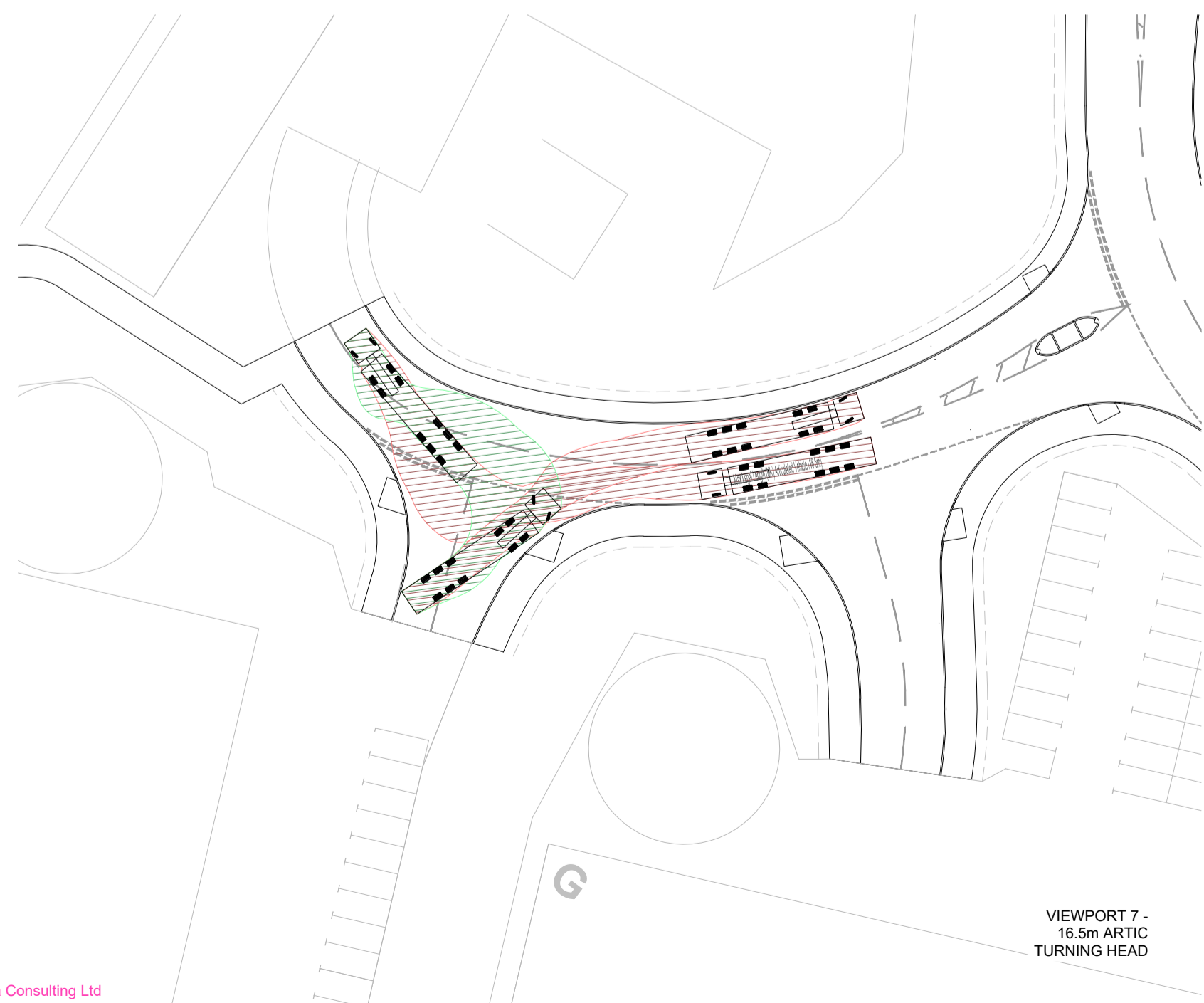

VIEWPORT 7 -
16.5m ARTIC
TURNING HEAD

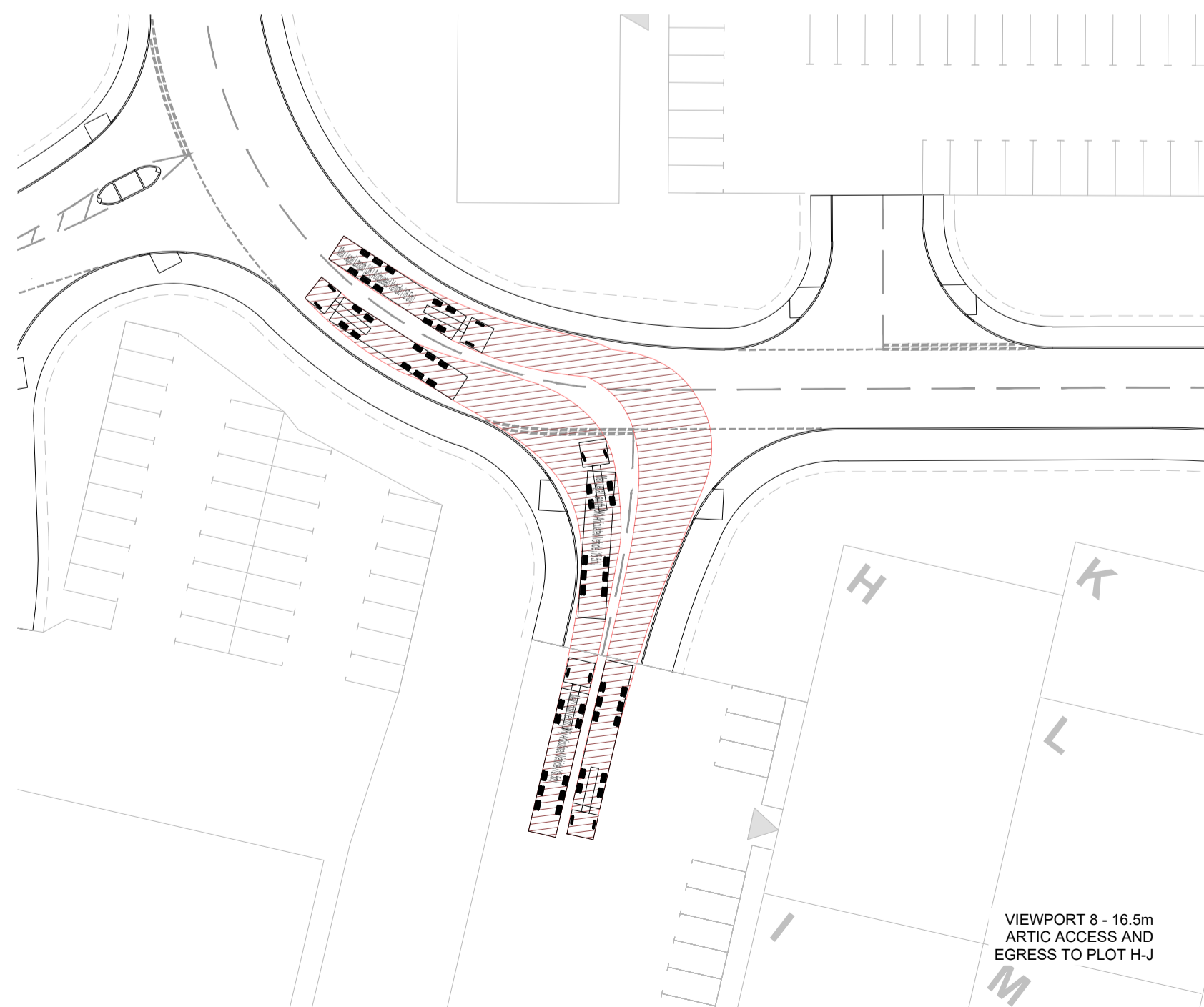

VIEWPORT 8 - 16.5m
ARTIC ACCESS AND
EGRESS TO PLOT H-J

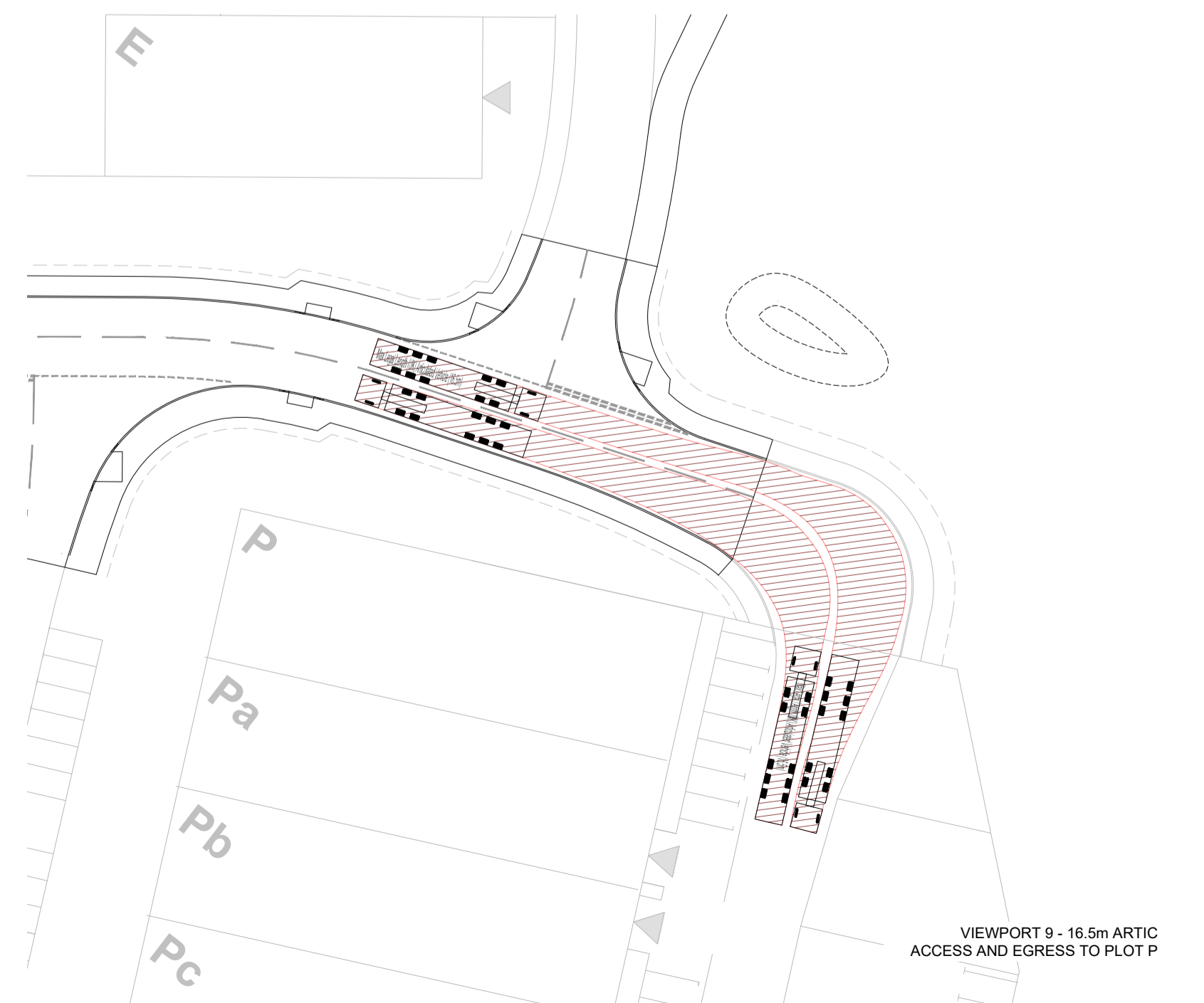

VIEWPORT 9 - 16.5m ARTIC
ACCESS AND EGRESS TO PLOT P

Notes

1. Do not scale this drawing. All dimensions must be checked/verified on site. If in doubt ask.
2. This drawing is to be read in conjunction with all relevant architects, engineers and specialists drawings and specifications.
3. All dimensions in meters unless noted otherwise. All levels in metres unless noted otherwise.
4. Any discrepancies noted on site are to be reported to the engineer immediately.
5. This drawing should be printed and read in colour.

Design Notes

- 1.1 DESIGN SPEEDS
- 1.1.1 FORWARD: 9MPH
- 1.1.2 REVERSE: 2MPH

Legend

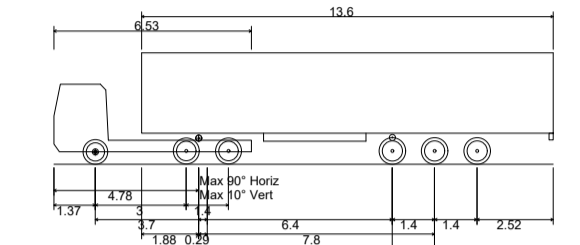

Max Legal Length (UK) Articulated Vehicle (16.5m)
Overall Length 16.500m
Overall Width 2.550m
Overall Body Height 3.681m
Min Body Ground Clearance 0.411m
Max Track Width 2.500m
Lock to lock time 6.00s
Kerb to Kerb Turning Radius 6.530m

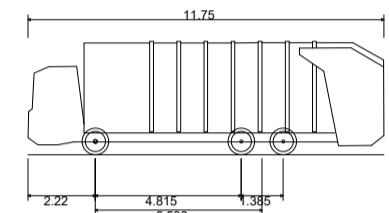

Phoenix 2 Duo (P2-15W with Elite 6x4 chassis) - 11.75m
Overall Length 11.750m
Overall Width 2.550m
Overall Body Height 3.761m
Min Body Ground Clearance 0.304m
Track Width 2.500m
Lock to lock time 4.00s
Kerb to Kerb Turning Radius 9.500m



P02	17.04.26	MINOR NOTATION UPDATE	SM	KJ
P01	10.04.26	PRELIMINARY ISSUE	SM	KJ
Rev	Date	Details of Issue	Drawn	Rwd

Issues & Revisions

Consultant

HEXA

Client

MORE CONSTRUCTION

Project Title

LINDLEY MOOR ROAD

Drawing Title

PROPOSED ESTATE ROAD
VEHICLE TRACKING

Drawn By	SM	Reviewed By	KJ
Hexa Ref	800150	Scale at A1	1:500

Purpose of Issue	Status
PRELIMINARY	S1

Project - Originator - Zone - Level - Type - Role - Number	Revision
800150-HEX-XX-XX-DR-C-0501	P02