

*For the purposes of Planning Consent the following applies to any copy of this drawing made by the Local Authority:
 This copy has been made by and with the authority of the person required to make the plan and drawing open to public inspection pursuant to Section 47 of the Copyright, Designs and Patents Act 1988. Unless that Act provides a relevant exception to copyright, the copy must not be copied without the prior permission of the copyright owner. If any copy is made under the authority only the whole drawing including the copyright holder's name and this notice, is to be copied.*

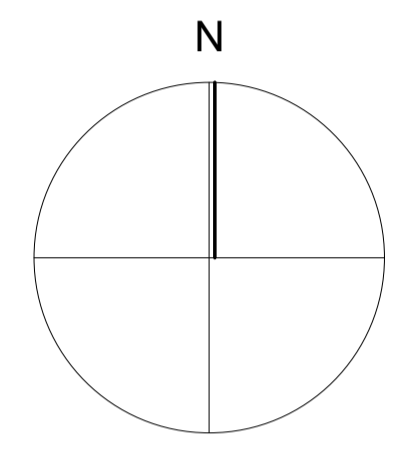
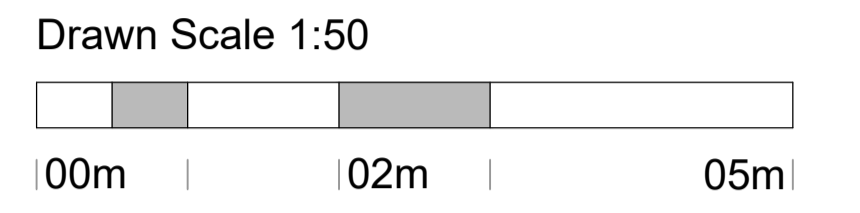
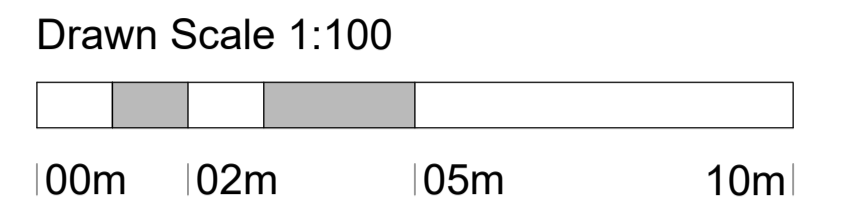
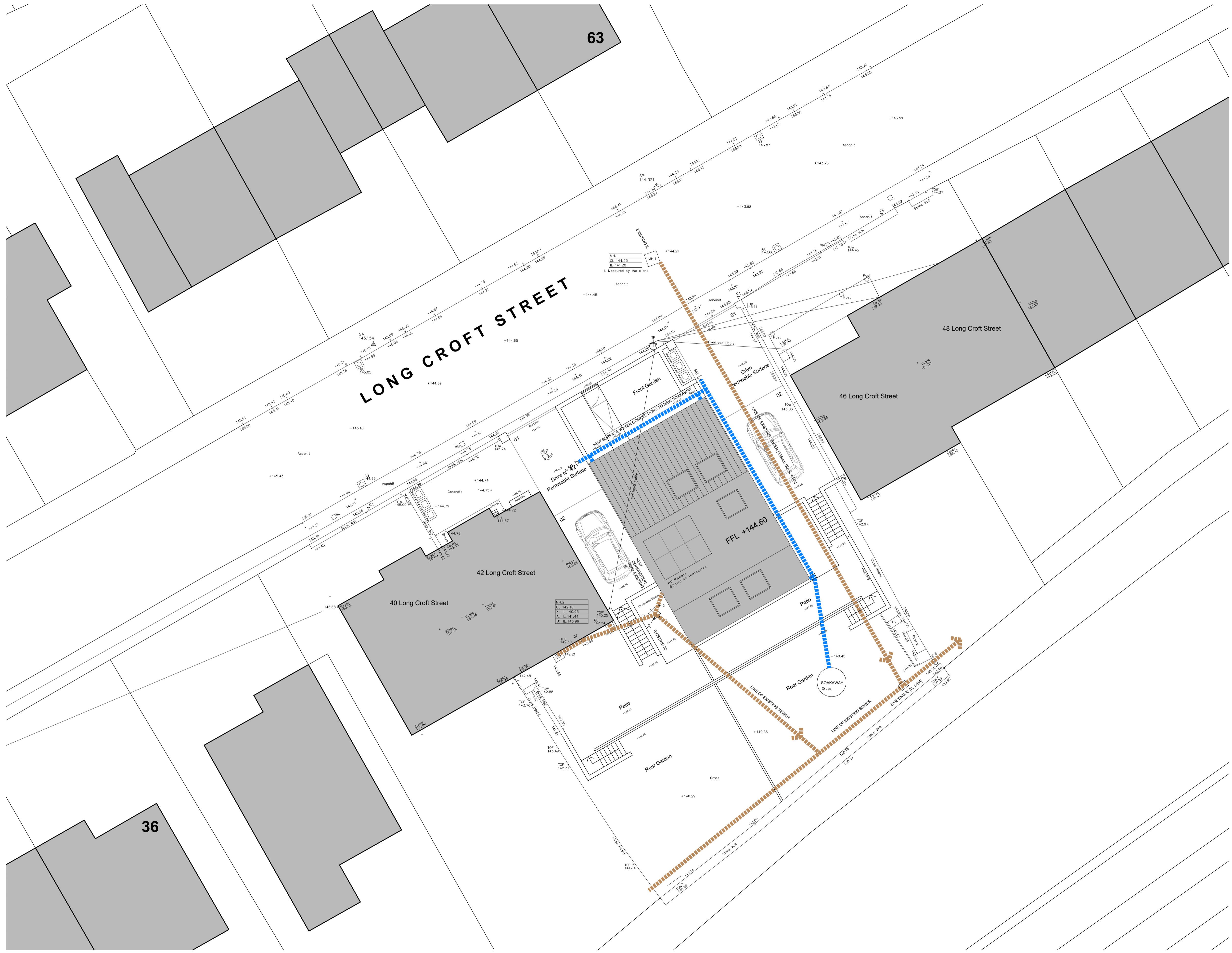

- KEY**
- Foul Water -----
 - Surface Water -----

Rev B : 05.03.26 - Width of the dwelling reduced to allow for additional drainage clearance
 Rev A : 10.10.25 - Rear balcony removed and pitched roof added

Issue Purpose: PLANNING APPLICATION

AHJ architects
 The Courtyard
 12a Commercial Road
 Skelmanthorpe
 Huddersfield
 HD8 9AA
 www.ahjarchitects.co.uk



Client	Jonathan Lindley	Issued From	
Project	2589 - 44 Long Croft Street : New Dwelling	Date	September 2025
Title	Proposed Drainage Plan	Scale	1:100 @ A1
Drawn	BH Auth	Drawn	BH Auth

Drawing Number: 2589 - D - 20 - 004 - B
 Revision: B
 Do not scale from this drawing. Work to original dimensions, and any discrepancy to be reported to the Architect.
 Refer to larger scale drawings where available.

PROPOSED DRAINAGE PLAN 1:100 @ A1