

NO CONSTRUCTION WORK SHOULD COMMENCE UNTIL PLANNING PERMISSION, BUILDING REGULATION APPROVAL, YORKSHIRE WATER H4 CONSULTATION (WHERE APPLICABLE) APPROVALS HAVE BEEN OBTAINED IN WRITING.

ALL PLANS ISSUED MARKED PRELIMINARY DO NOT CONSTITUTE INSTRUCTION TO PROCEED WITH WORKS ON SITE AND ARE PROVIDED FOR DESIGN CONSIDERATION. ALL WORKS CARRIED OUT ON SITE SHOULD FOLLOW THE PLANNING APPROVAL DRAWINGS AND CONDITIONS ATTACHED AND THE BUILDING REGULATION APPROVED PLANS, STRUCTURAL ENGINEERS REPORT/CALCULATIONS AND ANY CONDITIONS ATTACHED.

CLIENT TO ENSURE ALL INFORMATION/ STATUTORY PERMISSIONS /APPROVAL DOCUMENT ARE PROVIDED TO THE CONTRACTOR EXECUTING THE SITE WORKS. ALL WORKS TO BE INSPECTED AND TO THE APPROVAL OF THE BUILDING INSPECTOR. ENSURE YORKSHIRE WATER INSPECTOR APPROVAL/SITE VISIT FOR ALL WORKS CARRIED OUT TO OR NEAR PUBLIC DRAINS OR DRAINS IN RESPECT TO YWA DESIGNATED INTEREST.

CLIENT TO ENSURE ALL PROPOSED WORKS ARE BUILT ON AND OVER OWN LAND. ENSURE FOUNDATION SPREAD AND LEAVES OVERHANG DO NOT PROJECT OVER ADJACENT LAND OWNERSHIP. IF IN DOUBT CONSULT NEIGHBOUR AND OBTAIN LEGAL ADVICE.

ALL DETAILS SHOWN ON THE DRAWINGS ARE INDICATIVE DUE TO NATURE OF WORKING WITH EXISTING BUILDINGS. SUBJECT TO SITE OPENING UP AND SETTING OUT. CONFIRM ALL SIZES AND DIMENSION TO DKA. ALL DIFFERENCE, UNUSUAL OR DIFFERING DETAILS TO BE REPORTED TO DKA FOR FURTHER GUIDANCE.

CDM REGULATIONS – THE CLIENT & CONTRACTOR MUST ABIDE BY THE CONSTRUCTION DESIGN AND MANAGEMENT REGULATIONS 2015 WHICH RELATE TO ANY BUILDING WORKS WHICH (A) LASTS LONGER THAN 30 WORKING DAYS AND HAS MORE THAN 20 WORKERS WORKING SIMULTANEOUSLY AT ANY POINT IN THE PROJECT, OR (B) EXCEEDS 500 PERSON DAYS. PLEASE REFER TO [HTTP://WWW.HSE.GOV.UK/PUBNS/INDG411.HTM](http://www.hse.gov.uk/pubns/INDG411.htm) FOR GUIDANCE AND COMPLIANCE. FOR THE CDM REGULATION THE CLIENT WILL BE EMPLOYING ONE CONTRACTOR AND DKA RESPONSIBILITY FOR THE PROJECT WILL BE FOR THE DESIGN ONLY AND DOES NOT INCLUDE ANY PROJECT MANAGEMENT.

THE CLIENT & THE CONTRACTOR IS REMINDED OF THE PARTY WALL ACT 1996 AND TO APPOINT / OBTAIN SEPARATE LEGAL ADVICE FROM A PARTY WALL SURVEYOR TO ENSURE COMPLIANCE WITH THE LAW. NOTICES MAY REQUIRE SERVING ON THE ADJACENT OWNER/S PRIOR TO COMMENCEMENT. ENSURE NEIGHBOURS CONSENT IS OBTAINED WHERE WORKS ARE CARRIED OUT TO PARTY WALLS, PARTY FENCE WALLS, EXCAVATIONS ETC. APPOINTED PARTY WALL SURVEYOR TO FULLY ADVISE.

**DK ARCHITECTS ARE NOT APPOINTED AS "PRINCIPAL DESIGNERS" ROLE UNDER THE CDM HEALTH AND SAFETY REGULATIONS FOR THIS PROJECT, REFER TO CLIENT FOR FORMAL APPOINTMENT ROLES.**

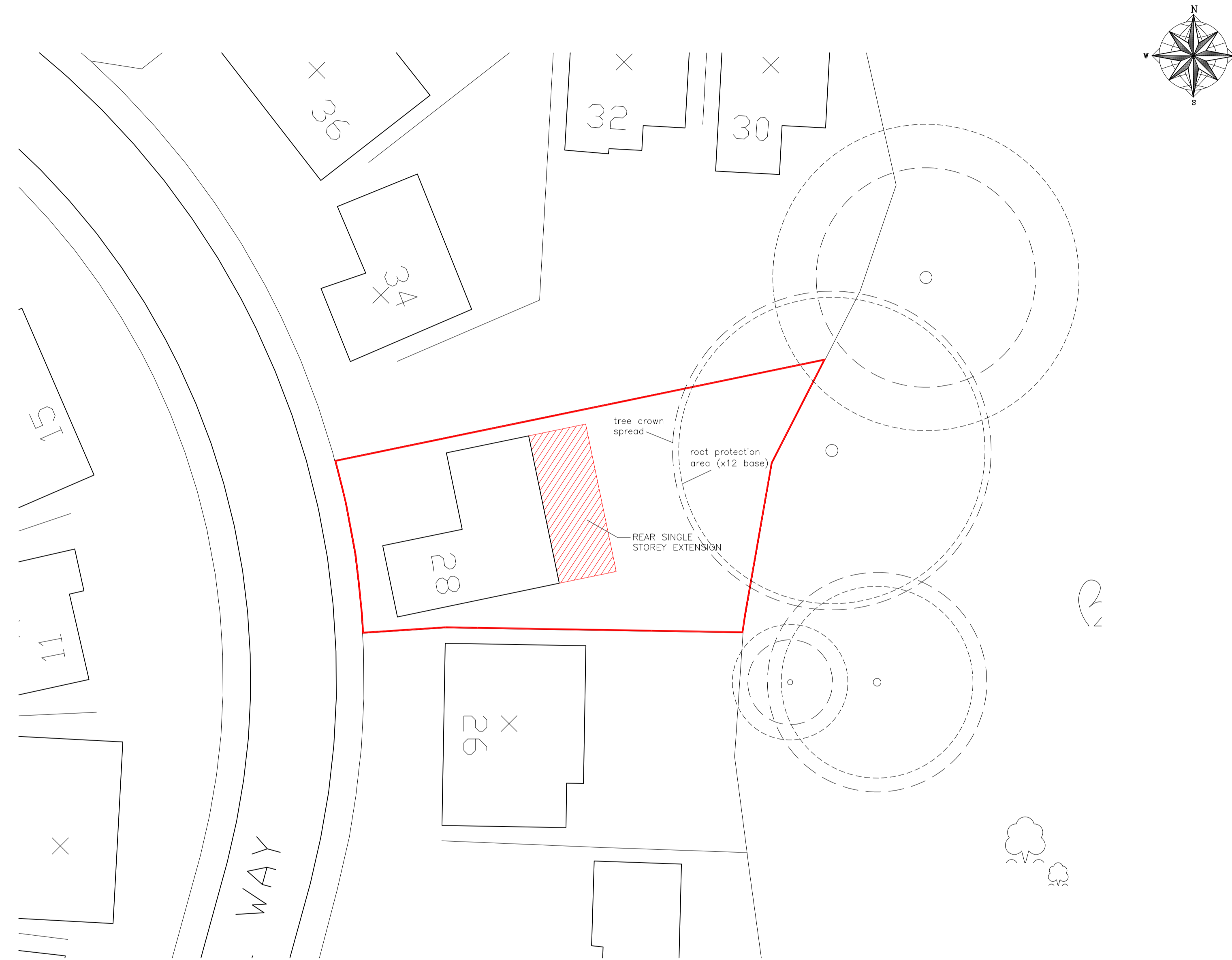

BLOCK TREE PLAN - 1:200



THIS DRAWING IS COPY RIGHT AND MUST NOT BE REPRODUCED / COPIED. MADE USE OF OR ISSUED WITHOUT PRIOR WRITTEN CONSENT OF DK ARCHITECTS

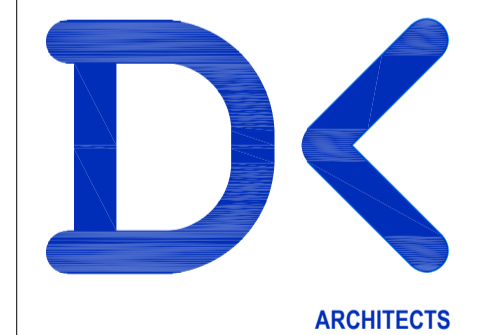

DK ARCHITECTS  
 t 01924 477212  
 m 07718 990668  
 e info@dkarchitects.net  
 w dkarchitects.net  
 DK Architects, Suite 4, Batley  
 Business Park, Technology Drive,  
 Batley, WF17 6ER

PROJECT: EXTENSION TO DWELLING	
ADDRESS: 28 CALDERMILL WAY, THORNHILL LEES, DEWSBURY, WF12 9QP	
DRG: BLOCK TREE PLAN - 1:200	
STATUS: PLANNING APPLICATION (SUBJECT TO APPROVAL)	
DATE: 7.5.26 SCALE: 1:200 SIZE: A1	DRAWN: AHD CHECKED: ANK DRG NO: 15.1740.04A
COPYRIGHT © 2007 DK ARCHITECTS(UK) LIMITED. ALL RIGHTS RESERVED. REFER TO DIMENSIONS AND DO NOT SCALE.	