

Block Plan 1: 500

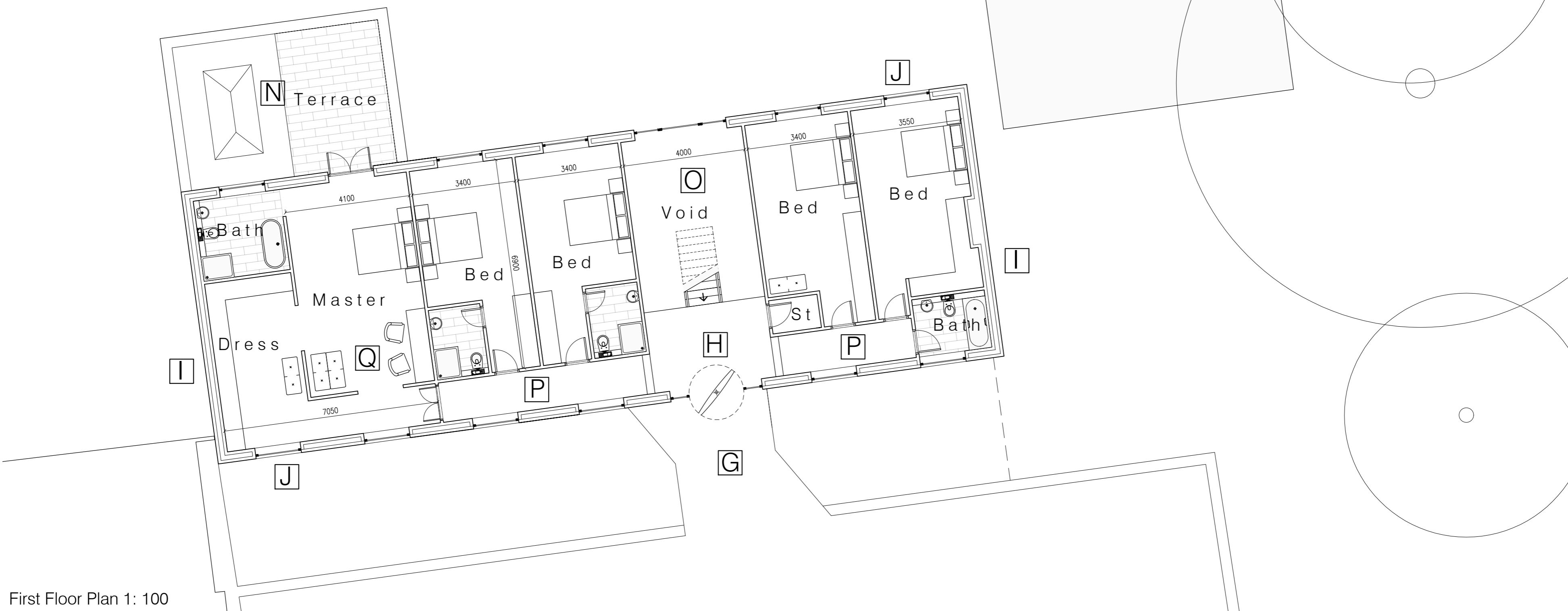

First Floor Plan 1: 100

Notes: A Site access road with gated entrance from Northfield Lane B Existing Residential and Ancillary Buildings C Dutch Barn D Proposed Garage block - approval no. 2023/91908 (due on site Summer 2026) E Paved Courtyard with ramp to access road F Visitor Parking spaces defined with contrasting paving G Bridge access to proposed dwelling over existing void	H Ppc aluminium entrance screen with oversize front door and level threshold from bridge access I Coursed natural stone with stone detail including oversized quoins, gutter corbels, kneelers all to match existing Farmhouse J Ppc aluminium window in opening formed in new walling to match adjacent Farmhouse K Ppc aluminium sliding door in opening formed in new walling as SE detail	L Stone slate roof M Seamless metal gutters and downpipes linked to S/w drainage N Flat roof with glass balustraded Terrace accessed from Master Bedroom and pyramidal glazed rooflight to Family space below O Double height entrance space with feature staircase to primary living accommodation. P Bedroom Corridor with glazed openings to Parking Court	Q Master Suite with dressing room R Island style kitchen with integral appliances as client specification S Secondary entrance with landscaped steps to garage ramp as specialist detail T External Terraced area linked to living accommodation with glazed openings U Detached triple garage to match dwelling with electrically operated up and over garage door.	V Refuse/ recycling provision/ presentation point W Indigenous hedging to plot boundaries X Amenity Lawnspace Y Existing blockwork wall taken down, slab broken out to create 1m planting strip to boundary wall, planted with Laurel hedge to match existing Z Outline of existing Dutch Barn dotted red
---	--	---	--	---

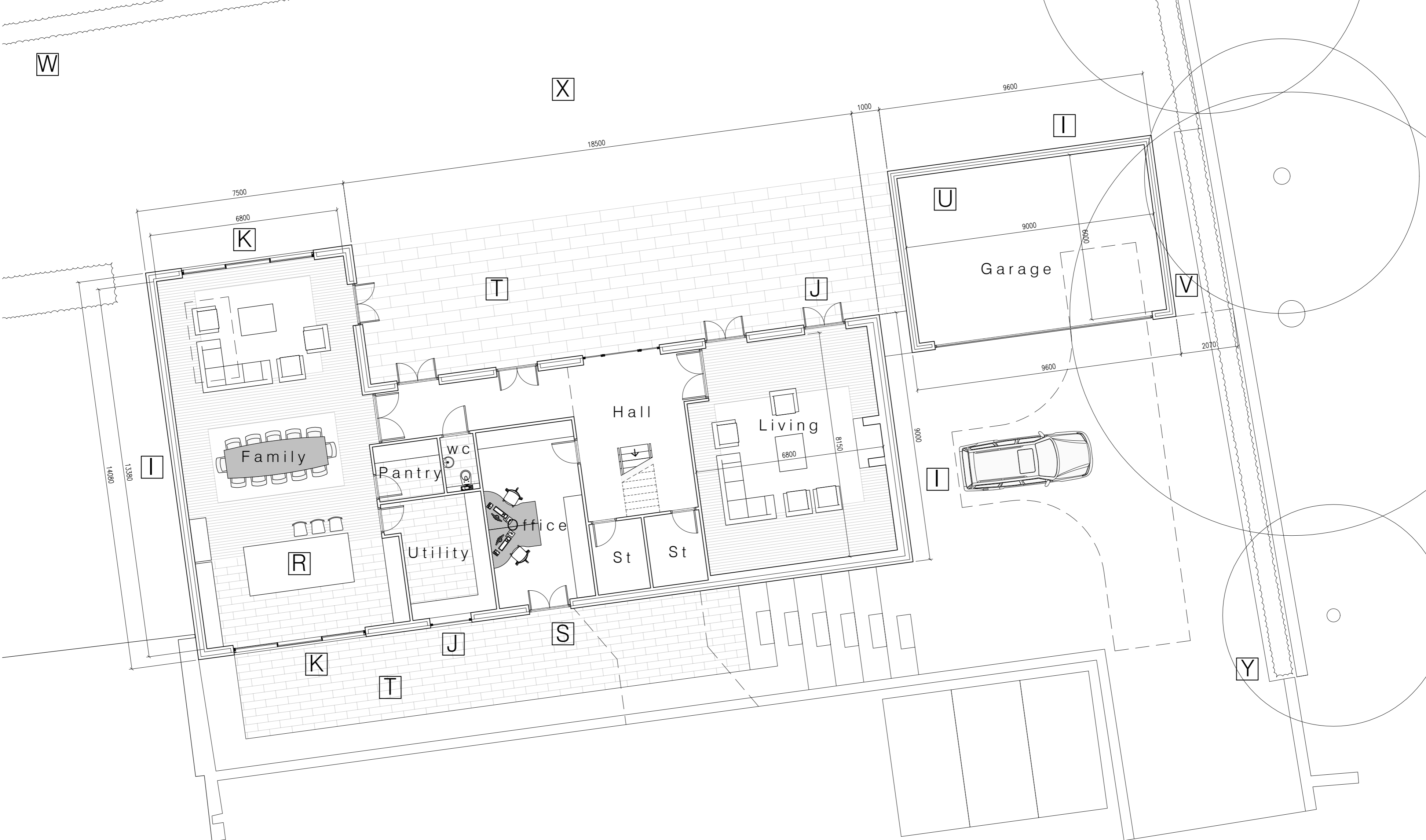

Ground Floor Plan 1: 100