

- All dimensions and levels are to be checked on site.
- Any discrepancies are to be reported to the architect before any work commences
- This drawing shall not be scaled to ascertain any dimensions. Work to figured dimensions only.
- This drawing shall not be reproduced without express written permission from AEW.
- Title overlay drawings and ownership boundaries are produced using all reasonable endeavors. AEW cannot be responsible for the accuracy or scale discrepancy of base plans supplied to them.
- All works are to be undertaken in accordance with Building Regulations and the latest British Standards.
- All proprietary materials and products are to be used strictly in accordance with the manufacturers recommendations.

CDM 2015

Client notified of duties: April 2020

Principal Designer: AEW

Unless noted below, all known hazards have been highlighted on the drawing:

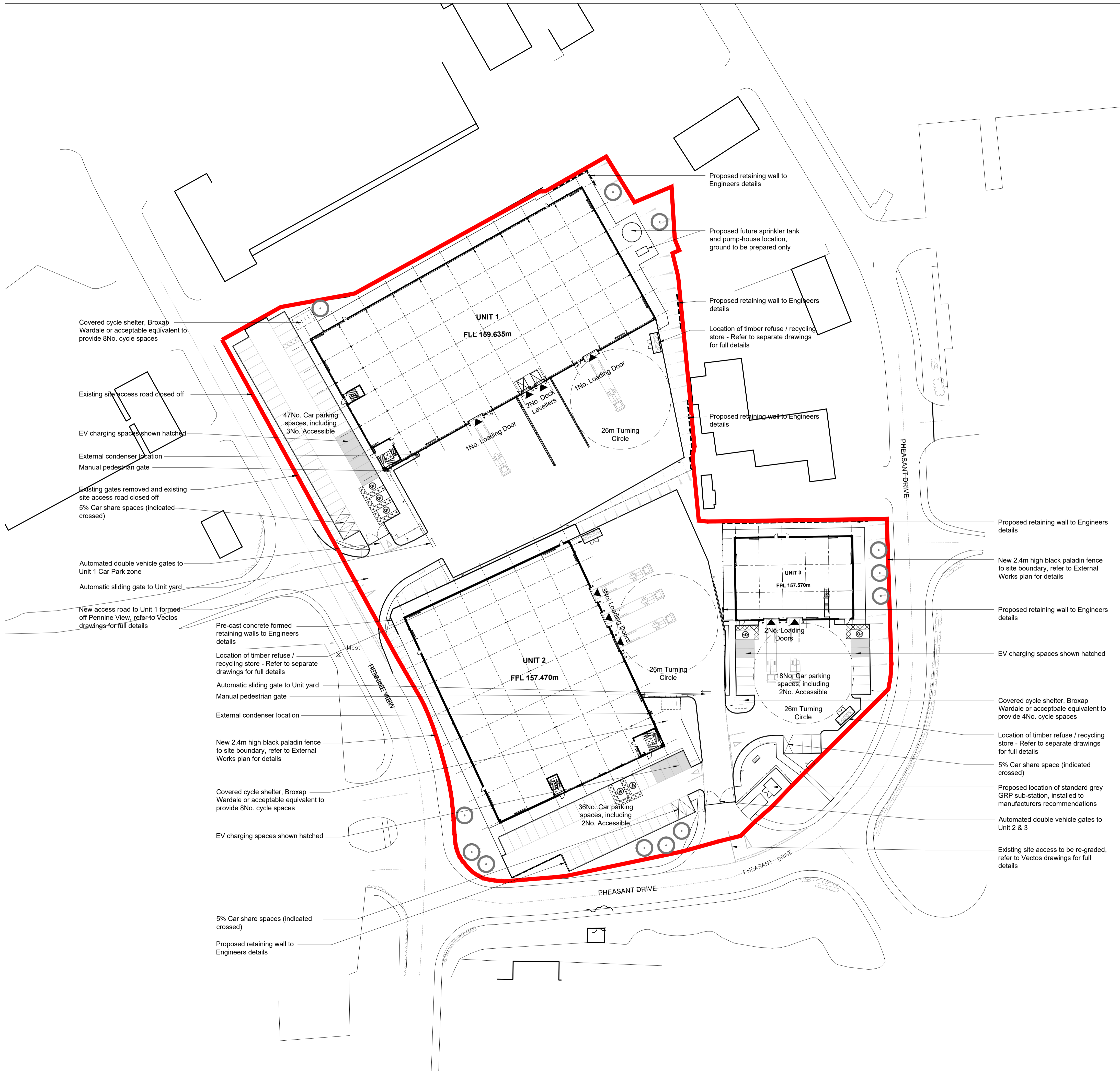
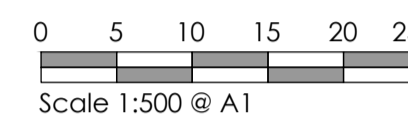

FINAL CONSTRUCTION ISSUE

IN THE ABSENCE OF INFORMATION FROM THE PRINCIPAL CONTRACTOR TO THE CONTRARY, THE INFORMATION CONTAINED IN THIS DRAWING IS GIVEN IN GOOD FAITH AND IS UNDERSTOOD TO BE CORRECT BY AEW. ANY PERSON CARRYING OUT ANY WORKS BELOW GROUND MUST SATISFY THEMSELVES OF THE POSITION OF UNDERGROUND SERVICES AND DRAINAGE. AEW WILL NOT BE LIABLE FOR OCCURRENCES ARISING OUT OF FAILURE TO CHECK ON SITE.

C07	20.10.22	KS	AS
FINAL CONSTRUCTION ISSUE			
C06	10.10.22	NJE	AS
Cycle shelter position to Unit 1 revised and hatched access from car park added			
C05	22.06.22	NJE	NJE
Lamp posts added and Yard to Unit 1 revised to suit			
C04	23.05.22	NJE	ASG
Unit 3 revised to single Unit			
C03	16.05.22	NJE	ASG
Unit 2 yard and fence revised to suit gate size and external condenser unit positions added to Unit 1 & 2			
C02	30.03.22	NJE	ASG
Initial Construction Issue			
C01	15.02.22	NJE	DOH
Automated double vehicle gates to Unit 2 & 3			
Initial Construction Issue			

REV	Date	Drawn by:-	Checked by:-
-----	------	------------	--------------

Status Purpose of Issue

CR Final Construction Issue

drawing stage **Stage 6**

client

Mileway Real Estate

project

**Norquest Industrial Estate
Pheasant Drive
Birstall**

drawing title

Proposed Site Plan

date 13/11/20 drawn NJE

scale@A1 1:500 checked AS