

NOT FOR CONSTRUCTION  
**- DRAFT -**  
 FOR COMMENT ONLY

- External Envelope Materials**
- 1 Primary Masonry - Reclaimed Local Stonework
  - 2 Secondary Masonry - Reconstituted Stone
  - 3 Sash PVC-U Window Frames and external doors - Laurel Grey (RAL 120 70 05)
  - 4 Dark Grey Dormer Cladding to match Roof Colour. Precise texture/colour/finish TBC.
  - 5 Natural Welsh Slate Roof Tile.
  - 6 Powder Coated Aluminium Rainwater Goods - Matte Black (RAL 9005).
  - 7 Cast Iron Railing, Style/Colour TBC.

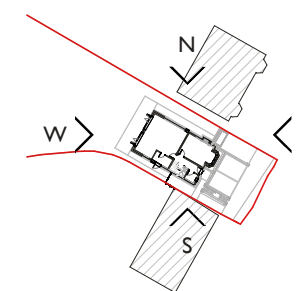

**Elevation Key**  
 1 : 1250



**Front Elevation**  
 1 : 100



**Right Elevation**  
 1 : 100



**Left Elevation**  
 1 : 100



**Rear Elevation**  
 1 : 100

Rev	Date	Notes	Revision
2	Mar '26	PLANNING ISSUE	2
	Mar '26	Elevation 3rd Amend	
	Mar '26	Elevation 2nd Amend	
1	Mar '26	First Issue	

Project Status: For Information

Drawing Number  
**OP-I300-DR-200-02**

Drawing Title  
**Overview Elevations**

Project  
**Hightown Lane, Holmfirth.**

Client  
**Mr. Schofield**

Job Number	Size	Scale
OP-I300	A3	As indicated
Drawn	Approved	Date
KC	LS	Jan '26

**Millson GROUP**  
 www.millsongroup.co.uk  
 info@millsongroup.co.uk  
 0161 228 0558

THIS DRAWING REMAINS THE COPYRIGHT OF MILLSON GROUP LTD. AND IT MUST NOT BE COPIED OR REPRODUCED WITHOUT WRITTEN CONSENT.

ALL SETTING OUT, DIMENSIONS AND LEVELS SHOULD ONLY BE TAKEN FROM THE FIGURED DIMENSION VALUES STATED ON THE DRAWING; NO ATTEMPT SHOULD BE MADE TO SCALE FROM THE DRAWING MANUALLY. ALWAYS ASK IF YOU REQUIRE MORE INFORMATION.

ANY VARIATION BETWEEN DRAWINGS AND SITE CONDITIONS ARE TO BE REPORTED TO MILLSON GROUP LTD. IMMEDIATELY. ALL CONTRACTORS MUST VISIT THE SITE AND ARE SOLELY RESPONSIBLE FOR TAKING AND CHECKING ALL DIMENSIONS RELATIVE TO THE WORK THEY ARE REQUIRED TO CARRY OUT.

THIS DRAWING MUST NOT BE USED ON SITE UNLESS ISSUED FOR CONSTRUCTION.

