

N O T E S

ATTENTION IS DRAWN TO THE REQUIREMENTS OF THE CONSTRUCTION DESIGN AND MANAGEMENT REGULATIONS 2015 AND THE DUTIES AND RESPONSIBILITIES CONTAINED THEREIN

1. Prior to any earthworks, a complete topsoil and non-protected vegetation strip is required.
2. There are no areas of made ground anticipated to be under the embankment. However, if any made ground is encountered, it is to be removed in its entirety. Validation that all made ground has been removed is required.
3. The founding strata is to be benched at a 1v2h ratio for the earth works key-in.
4. CBR tests should be undertaken to assess the founding stratum strength. A CBR value of 2.5% is required. If soft spots are found, they are to either be removed or a geogrid design will be needed.
5. Any material designated for use on site within the embankment should be checked for similar consistency and type. This can then be assessed for suitability for re-engineering into the works.
6. Suitable material for re-engineering will be durable and free from and deleterious materials such as asphalt, bitumen, coal, harmful chemicals, timber and organic materials.
7. Any materials that contain a significant portion of particles larger than 125mm will also be rejected until the particles are crushed or removed.
8. To be considered acceptable for reuse, the materials will need to meet a suitable grading of the Highways Agency Manual of Contract Documents for Highway Works, Volume 1 - Specification for Highway Works, Series 0600 (Earthworks). Materials to be reused should be granular in nature, meeting the class of 1A, the granular end member of 2C, 6F2, 6F4, 6F5, 6P or similar.
9. The materials shall be classified by means of wet sieve grading tests and must also meet the following criteria:
 - o Acid soluble sulphate content <0.24%
 - o Silt content <10%
 - o Organic matter content <5%
10. Example methods of compaction for Class 2C and Class 1A materials are provided below, assuming use of a vibrating roller of between 2,900kg and 3,600kg mass per metre width of roll, in accordance with Table 6/4 of the Specification. The layer thicknesses and number of passes of the roller are dependent on the material and the roller used and, as a result, may be different from the examples below, if other rollers are used. The thicknesses and passes must be designed accordingly.

Class 1A/2C:

Each 200mm layer shall be compacted with at least four (4) passes of a vibrating roller in accordance with Table 6/4 of the Series 600 Earthworks Specification.
11. It is necessary for the materials to meet an end specification of 95% of the maximum dry density and a minimum of 2.5% CBR value. For granular fill, a CBR of 10% should be used.
12. Dry density testing should be carried out with a minimum of 3 tests every alternate layer of compacted material or on a 50m grid spacing, whichever results in the most tests.
13. The above tests should be carried out by a UKAS accredited testing laboratory.
14. Where the retaining wall is to be placed on the fill materials, SPT testing will be required following the placement of the fill. Testing is required on a 25m grid, with tests undertaken at 1m intervals within the fill. A minimum bearing capacity of 65kN/m2 is required for founding.
15. If weather conditions are such that suitable compaction is inhibited and the specified values cannot be achieved, then the Contractor shall cease work until such time as the fill can be placed and compacted to meet the specification requirements.
16. Any areas that do not meet the required level of compaction shall be re-compacted and re-tested as necessary.



LOCATION PLAN 1:1250

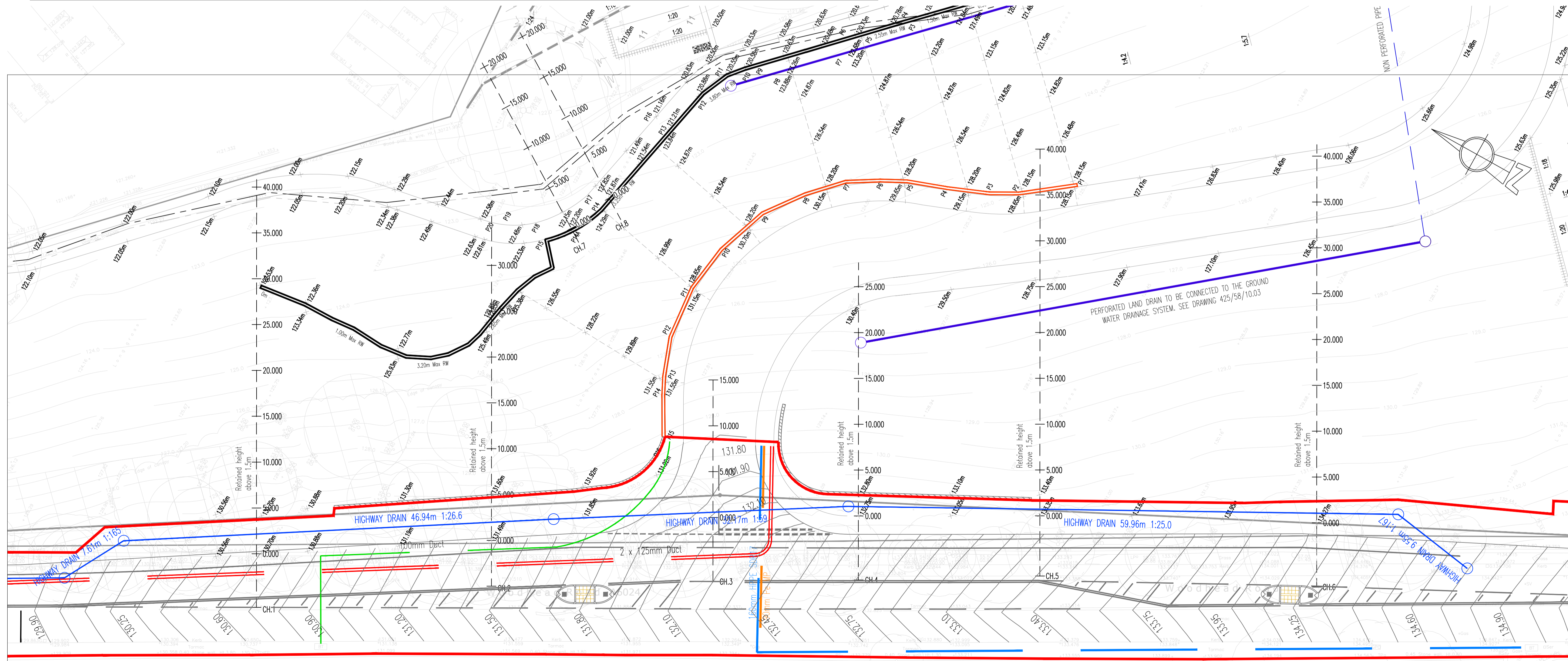

SECTIONS LOCATION PLAN 1:250

Rev	By	Date	Revision	Chk	App'd
G	JC	07.11.23	CH.7 and CH.8 added	DPB	DPB
F	RJ	17.08.23	Drawing revised to Local Authority comments	RJ	MI
E	JC	10.08.23	Drawing revised to Local Authority comments	RJ	MI
D	JC	01.08.23	Drawing revised to 28.07.23 comments	RJ	MI
C	RJ	13.07.23	Updated to suit Kirklees Highways comments	RJ	MI
B	JC	23.2.22	Updated to suit Kirklees Highways comments	JD	JD
A	JC	15.12.22	Updated to suit Kirklees Highways comments	JD	JD
/	JC	23.11.22	Issued for information	JD	JD

ARP ARP ASSOCIATES
Chartered Consulting Engineers

Northwest House • 5 & 6 Northwest Business Park • Servia Hill, Leeds • LS6 2QH
0113 245 9498 • 0113 244 3864 • leeds@arpassociates.co.uk • www.arpassociates.co.uk

ARP Associates is a trading division of ARP Geotechnical Ltd, a company registered in England and Wales with company number 371811, whose registered office is at 5/6 Northwest Business Park, Servia Hill, Leeds LS6 2QH

TITLE **PROPOSED EMBANKMENT SECTIONS SHEET 1**

PROJECT **A6024 WOODHEAD ROAD, HONLEY**

CLIENT **MILLER HOMES (YORKSHIRE) LTD**

DRAWING STATUS **PRELIMINARY**

Scale **As Shown @ A1** Date **NOV 22** Drawn **JC**
Chk. **JD**

Drng. No. **425/58/1022** Rev **G**