

DEMOLITION OF EXISTING DWELLING AND ERECTION OF 4 DWELLINGS

11 WOOD STREET, SKELMANTHORPE HD8 9BN

APP NO: 2024/62/91934/E

CONDITION 10 – BOUNDARY RETAINING WALL TO WOOD STREET

SUBJECT TO THE APPROVAL OF ALL RELEVANT AUTHORITIES
DO NOT SCALE ORIGINAL DRAWING SIZE A3

1. This drawing is to be read in conjunction with the specification and all relevant engineers and architects drawings.
2. All dimensions are given in millimetres.
3. All concrete is to be in accordance with BS8500-1:2023
4. Contractor to be responsible for design, erection and support of any formwork required.
5. Concrete grade:
Reinforced Concrete – C28/35 (UNO)
Mass concrete/Blinding concrete – FND2
ACEC Class = AC-1s
DS Class = DS-1
6. Retaining walls shown on this drawing have been designed allowing for a 300mm unplanned excavation in front of the base, Passive resistance has been ignored.

Retaining wall has been designed in accordance with BS EN 1996. The design has made allowance for a 5kN/m² surcharge

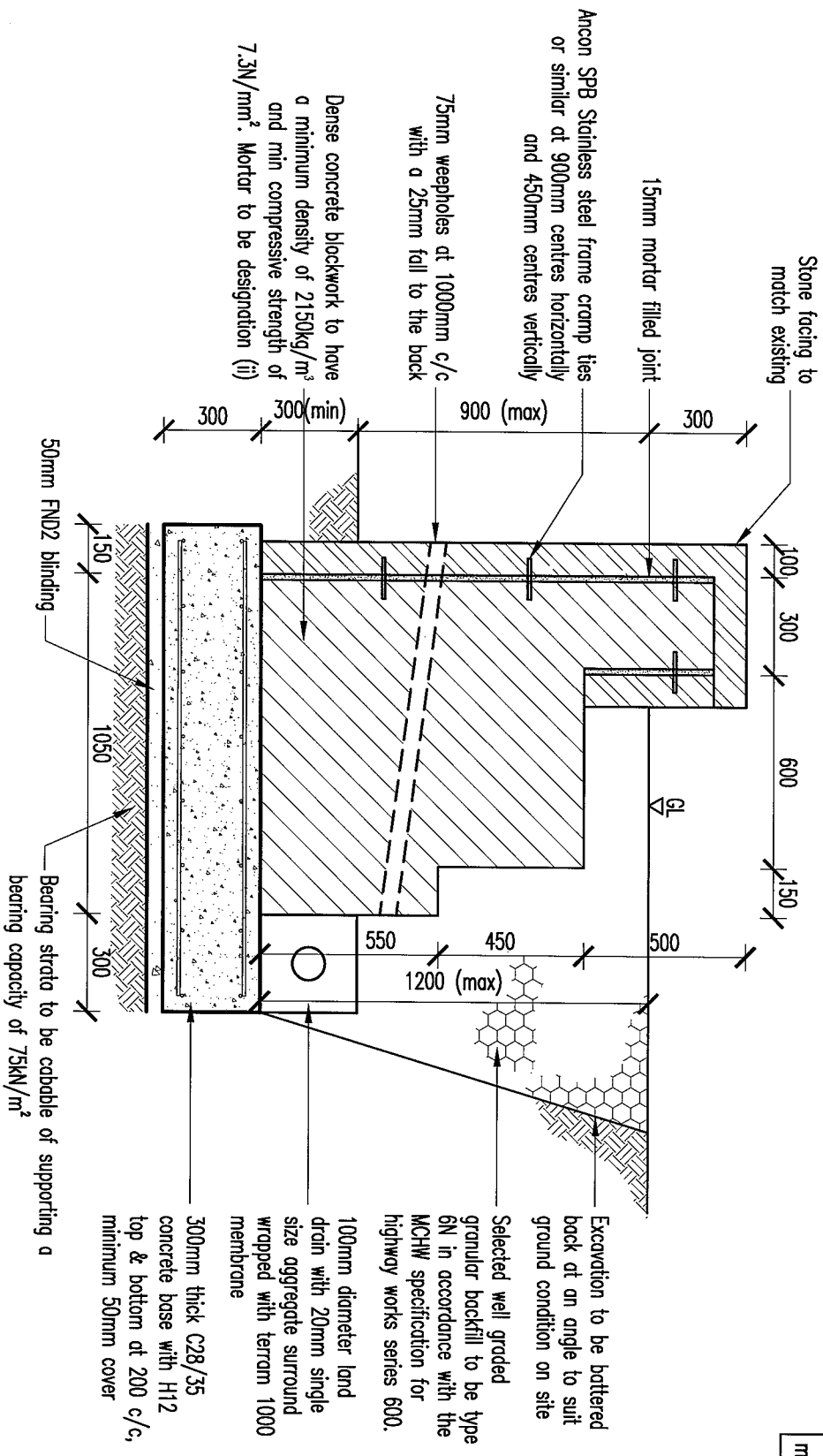

0 RETAINING WALL (900mm RETAINING HEIGHT)
SCALE 1:20

Maximum joint spacing to be 6m to suit masonry facing.

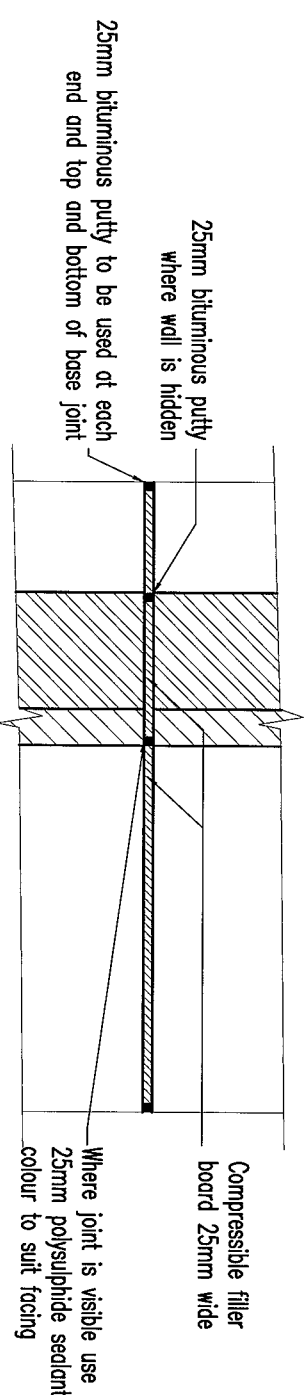

1 TYPICAL RETAINING WALL JOINT DETAIL
SCALE 1:20

SUBJECT TO REGULATORY AUTHORITY APPROVAL

Rev	By	Date	Description	CHK
1	FC	12/02/26	Final Issue	MA

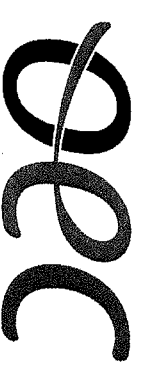

CONSULTING ENGINEERS LTD
Ortle Hall Farm • Aberford Road • Wakefield • WF1 4AL
T: 01924 792312 • E: info@oecconsult.co.uk • W: www.oecconsult.co.uk

Client: LINFIT INVESTMENTS

Project: WOOD STREET
SKELMANTHORPE

Title: RETAINING WALL - TYPICAL SECTION

Scale	AS SHOWN	Drawn	FC	Checked	MA	Date	FEB'26
Drawing Status: APPROVAL							

Job No.	132.010	Drawing No.	1200	Revisions	/
---------	---------	-------------	------	-----------	---