

PROPOSED PPP CUT OFF BUND TO PROTECT EXISTING PROPERTIES ALONG WESTERN BOUNDARY  
RETURN ON BUND TO BE PROVIDED TO ALLOW FOR AN ELEMENT OF STORAGE IN THIS AREA WHICH IS TO BE OVERPUMPED TO THE SOUTH AS REQUIRED

PROPOSED PPP CUT OFF BUND TO PROTECT EXISTING PROPERTIES ALONG WESTERN BOUNDARY  
RETURN ON BUND TO BE PROVIDED TO ALLOW FOR AN ELEMENT OF STORAGE IN THIS AREA WHICH IS TO BE OVERPUMPED TO THE SOUTH OF THE TREE BELT AS REQUIRED  
BUND TO BE REMOVED AS ADJACENT DEVELOPMENT AREAS COMPLETE

**ATTENUATION BASIN**  
BASE AREA= 424.7 m<sup>2</sup>  
TOP OF BASIN AREA= 919.6 m<sup>2</sup>  
SIDE SLOPES=1:3  
TOP OF BASIN=128.55  
BASE LEVEL=127.15  
**PPP MODEL DETAILS**  
TOTAL SITE AREA = 5.4 ha  
CONTRIBUTING AREA TO ATTENUATION BASIN:  
TOPSOIL STRIP = 2.7 ha  
**360 MINUTE 10.0% AEP RAINFALL EVENT MODEL RESULTS:**  
OUTFLOW = 13.3 l/s  
ATTENUATED VOLUME = 502.9 m<sup>3</sup>  
WATER LEVEL = 128.040 m AOD  
FREEBOARD = 0.510 m

SILT FENCING PROVIDED ALONG THE WESTERN BOUNDARY AS SHOWN. FLOWS ALLOWED TO PASS THROUGH SILT FENCING AND OVERLAND ALONG ADJACENT VEGETATED FIELDS AND INFILTRATE TO GROUND

MIN 30m HOSE REQUIRED

TEMPORARY BUND TO BE PLACED IN OUTLET PIPE

TEMPORARY PUMP IN MH S36  
MAX PUMP RATE = 13.3 l/s

SILT FENCING IS TO BE INSTALLED DURING CONSTRUCTION OF THE OFF-SITE PIPWORK DOWNSTREAM OF THE FLOW CONTROL MANHOLE

GROUND LEVELS TO BE ALTERED TO PROVIDE GRAVITY FALL ON CHANNEL

RUNOFF FROM CHANNEL TO DISCHARGE INTO PPPIC OUTLET PIPE TO BE BURIED BELOW EXISTING PROW

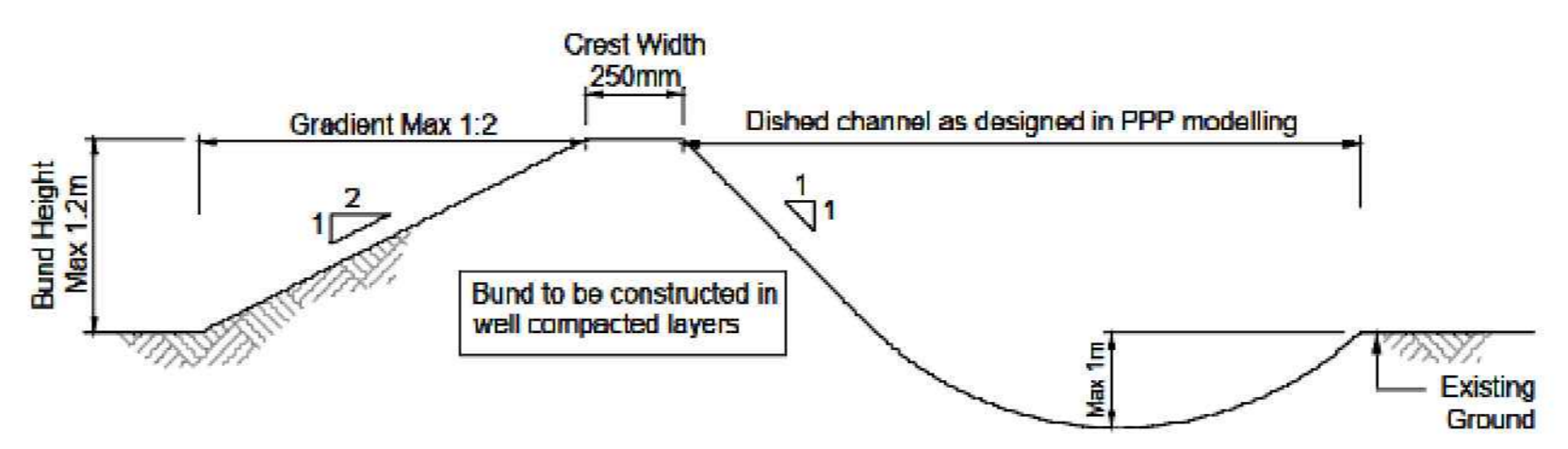

Typical Section Through Proposed Temporary Earth Bunding / Dished Channel (NTS)

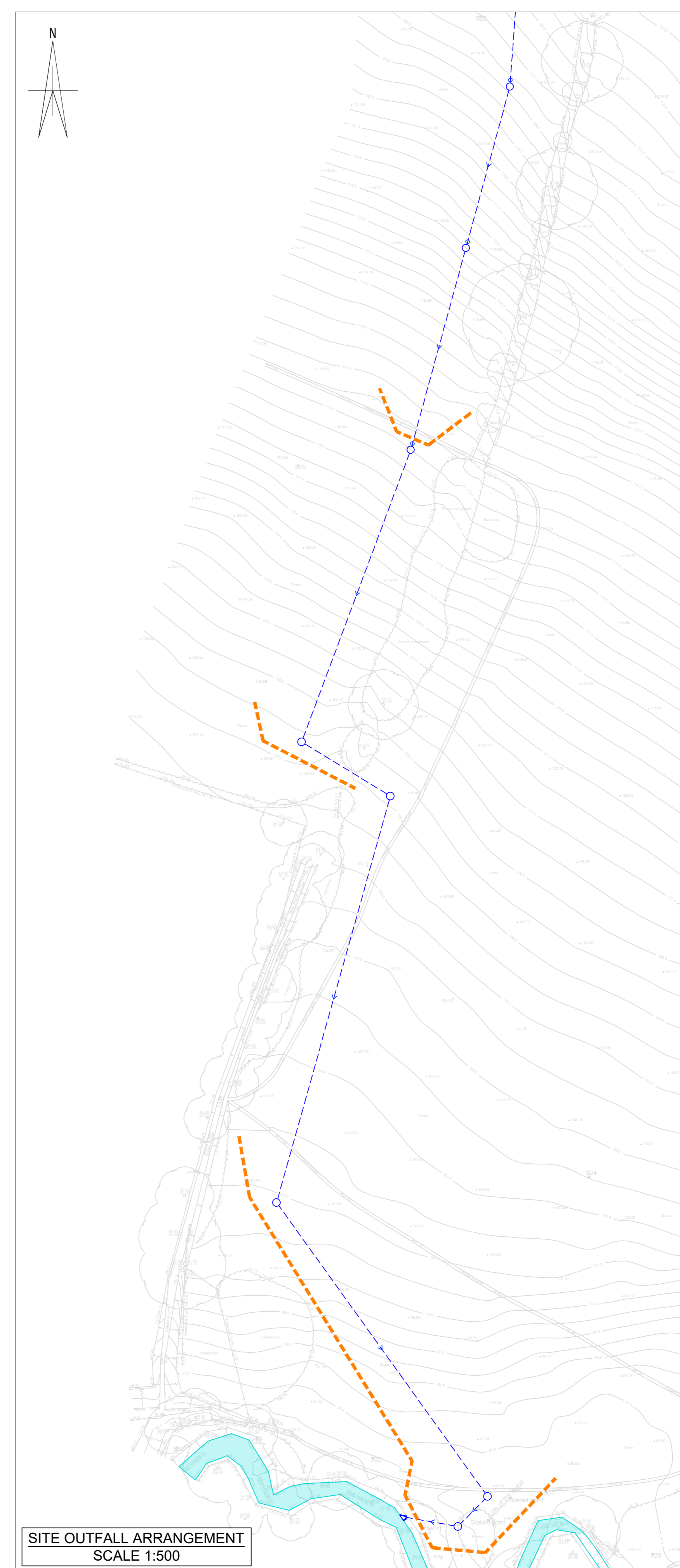

SITE OUTFALL ARRANGEMENT SCALE 1:500

**NOTES**

- THIS DRAWING TO BE READ IN CONJUNCTION WITH ALL RELEVANT WEETWOOD DRAWINGS. ANY DISCREPANCIES, ERRORS OR OMISSIONS TO BE BROUGHT TO THE ATTENTION OF WEETWOOD.
- ANNUAL EXCEEDANCE PROBABILITY RAINFALL EVENTS:
  - 100.0% (1:1) AEP RAINFALL EVENT
  - 50.0% (1:2) AEP RAINFALL EVENT
  - 3.3% (1:30) AEP RAINFALL EVENT
  - 1.0% (1:100) AEP RAINFALL EVENT
- PROPOSED SITE LAYOUT TAKEN FROM LAYOUT PROVIDED BY MILLER HOMES (JUL 2025).
- EXISTING LEVEL INFORMATION TAKEN FROM LAYOUT PROVIDED BY MILLER HOMES (JUL 2025).

- PPP KEY**
- PROPOSED BUNDING
  - PROPOSED DISH CHANNEL
  - PROPOSED SILT FENCING
  - PROPOSED PUMP HOSE/RISING MAIN
  - PROPOSED PUMP
  - PROPOSED PPP CHAMBER
  - PROPOSED PPP OUTLET PIPE
  - EXTENT OF TOPSOIL STRIP (PHASE 1)
  - EXTENT OF TOPSOIL STRIP (PHASE 2)
  - OVERLAND FLOW ROUTE
  - EXISTING GROUND LEVEL
  - PROPOSED GROUND LEVEL
- DESIGNS BY OTHERS:
- PROPOSED SURFACE WATER SEWER
  - EXISTING WATERCOURSE
  - EXISTING TOPOGRAPHICAL LEVEL
  - SITE BOUNDARY

P2	05.02.26	PPP ARRANGEMENTS TO EAST OF ATTENUATION BASIN AMENDED	WC	TB
P1	28.08.25	INITIAL ISSUE	WC	TB

REV	DATE	DESCRIPTION	DRAWN BY	CHECK BY
-----	------	-------------	----------	----------



Client <b>MILLER HOMES</b>		Date AUG 2025
Drawing Status <b>CONSTRUCTION</b>		Scale (m) 1:500
Project <b>HERMITAGE PARK LEPTON HUDDERSFIELD</b>		Drawn by WC
Drawing Number <b>6629-WTWD-00-XX-DR-D-9421</b>		Check by TB
Drawing Title <b>POLLUTION PREVENTION PLAN PHASE 2</b>		Revision P2