

PROPOSED PPP CUT OFF BUND TO PROTECT EXISTING PROPERTIES ALONG WESTERN BOUNDARY
RETURN ON BUND TO BE PROVIDED TO ALLOW FOR AN ELEMENT OF STORAGE IN THIS AREA WHICH IS TO BE OVERPUMPED TO THE SOUTH AS REQUIRED

PROPOSED PPP CUT OFF BUND TO PROTECT EXISTING PROPERTIES ALONG WESTERN BOUNDARY
RETURN ON BUND TO BE PROVIDED TO ALLOW FOR AN ELEMENT OF STORAGE IN THIS AREA WHICH IS TO BE OVERPUMPED TO THE SOUTH OF THE TREE BELT AS REQUIRED
BUND TO BE REMOVED AS ADJACENT DEVELOPMENT AREAS COMPLETE

ATTENUATION BASIN
BASE AREA= 424.7 m²
TOP OF BASIN AREA= 919.6 m²
SIDE SLOPES=1:3
TOP OF BASIN=128.55
BASE LEVEL=127.15
PPP MODEL DETAILS
TOTAL SITE AREA = 5.4 ha
CONTRIBUTING AREA TO ATTENUATION BASIN:
TOPSOIL STRIP = 2.7 ha
360 MINUTE 10.0% AEP RAINFALL EVENT MODEL RESULTS:
OUTFLOW = 13.3 l/s
ATTENUATED VOLUME = 502.9 m³
WATER LEVEL = 128.640 m AOD
FREEBOARD = 0.510 m

SILT FENCING PROVIDED ALONG THE WESTERN BOUNDARY AS SHOWN. FLOWS ALLOWED TO PASS THROUGH SILT FENCING AND OVERLAND ALONG ADJACENT VEGETATED FIELDS AND INFILTRATE TO GROUND

MIN 30m HOSE REQUIRED

TEMPORARY BUND TO BE PLACED IN OUTLET PIPE

TEMPORARY PUMP IN MH S36
MAX PUMP RATE = 13.3 l/s

FLOW CONTROL MH

SILT FENCING IS TO BE INSTALLED DURING CONSTRUCTION OF THE OFF-SITE PIPework DOWNSTREAM OF THE FLOW CONTROL MANHOLE.

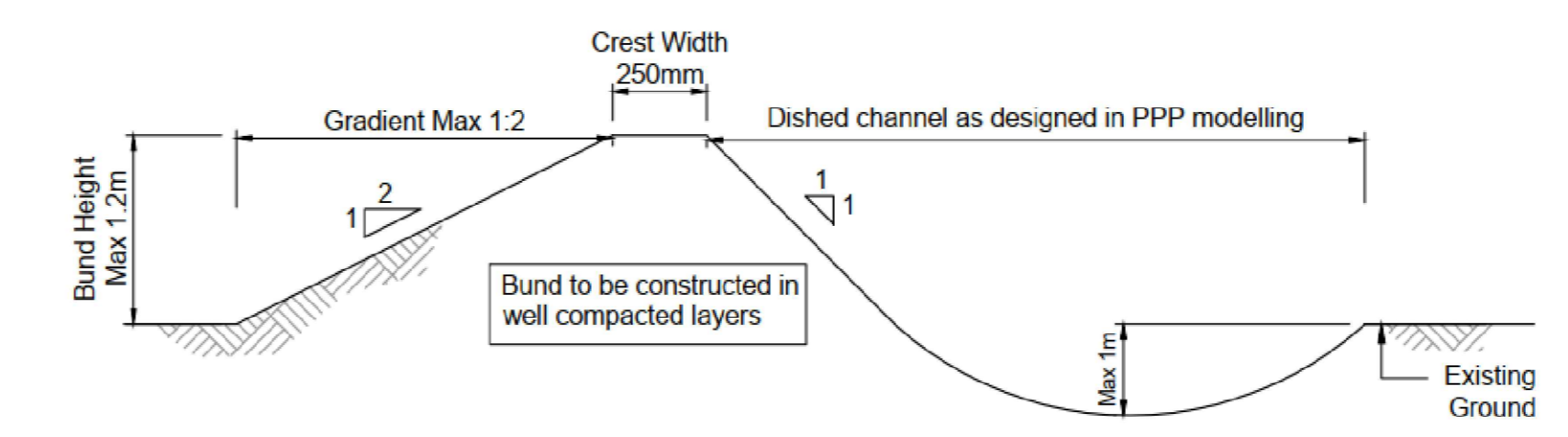

Typical Section Through Proposed Temporary Earth Bunding / Dished Channel (NTS)

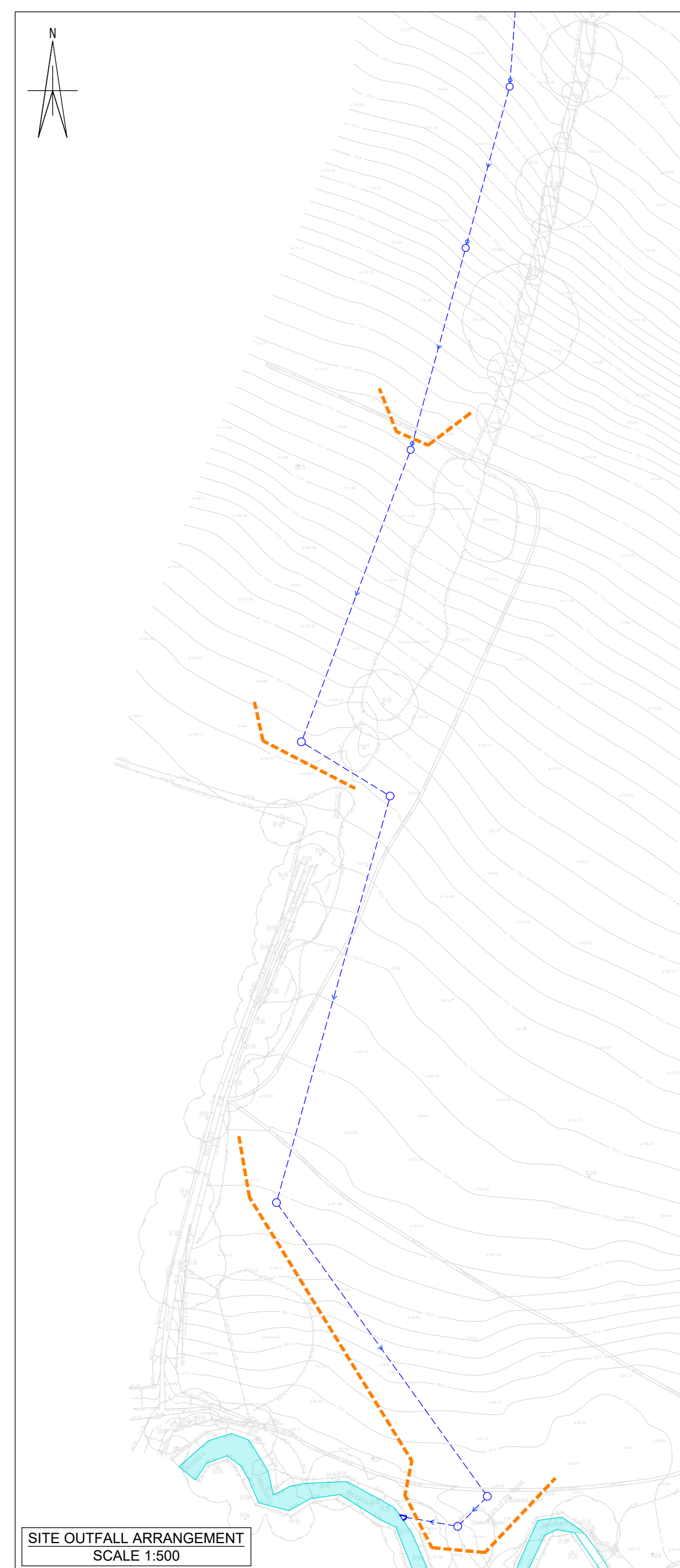

SITE OUTFALL ARRANGEMENT SCALE 1:500

NOTES

- THIS DRAWING TO BE READ IN CONJUNCTION WITH ALL RELEVANT WEETWOOD DRAWINGS. ANY DISCREPANCIES, ERRORS OR OMISSIONS TO BE BROUGHT TO THE ATTENTION OF WEETWOOD.
- ANNUAL EXCEEDANCE PROBABILITY RAINFALL EVENTS:
 - 100.0% (1:1) AEP RAINFALL EVENT
 - 50.0% (1:2) AEP RAINFALL EVENT
 - 3.3% (1:30) AEP RAINFALL EVENT
 - 1.0% (1:100) AEP RAINFALL EVENT
- PROPOSED SITE LAYOUT TAKEN FROM LAYOUT PROVIDED BY MILLER HOMES (JUL 2025).
- EXISTING LEVEL INFORMATION TAKEN FROM LAYOUT PROVIDED BY MILLER HOMES (JUL 2025).

- PPP KEY**
- PROPOSED BUNDING
 - PROPOSED DISH CHANNEL
 - PROPOSED SILT FENCING
 - PROPOSED PUMP HOSE/RISING MAIN
 - PROPOSED PUMP
 - EXTENT OF TOPSOIL STRIP (PHASE 1)
 - EXTENT OF TOPSOIL STRIP (PHASE 2)
 - OVERLAND FLOW ROUTE
 - EXISTING GROUND LEVEL
 - PROPOSED GROUND LEVEL
- DESIGNS BY OTHERS:
- PROPOSED SURFACE WATER SEWER
 - EXISTING WATERCOURSE
 - EXISTING TOPOGRAPHICAL LEVEL
 - SITE BOUNDARY

P1	28.08.25	INITIAL ISSUE	WC	TB
REV	DATE	DESCRIPTION	DRAWN	CHECK BY

Weetwood
Development • Planning • Environment

Park House, Floridd
Bymer Gwatt, Midd
CH7 1FQ
Tel 01352 700045
info@weetwood.net
www.weetwood.net

Client MILLER HOMES	
Drawing Status CONSTRUCTION	Date AUG 2025
Project HERMITAGE PARK LEPTON HUDDERSFIELD	Scale (M): 1:500
Drawn by WC	Drawn by WC
Check by TB	Check by TB
Drawing Number 6629-WTWD-00-XX-DR-D-9421	Revision P1
Drawing Title POLLUTION PREVENTION PLAN PHASE 2	