

Construction staff and operatives must ensure the principal contractor has provided thorough and accurate information on all health and safety aspects relating to the design identified on this drawing including the review of:

- Design/contractor risk assessments
- Method statements
- Permit to work
- Pre construction information

The designer notes that the following health and safety risks relating to this drawing have not been estimated during the design process:

ref	residual risk

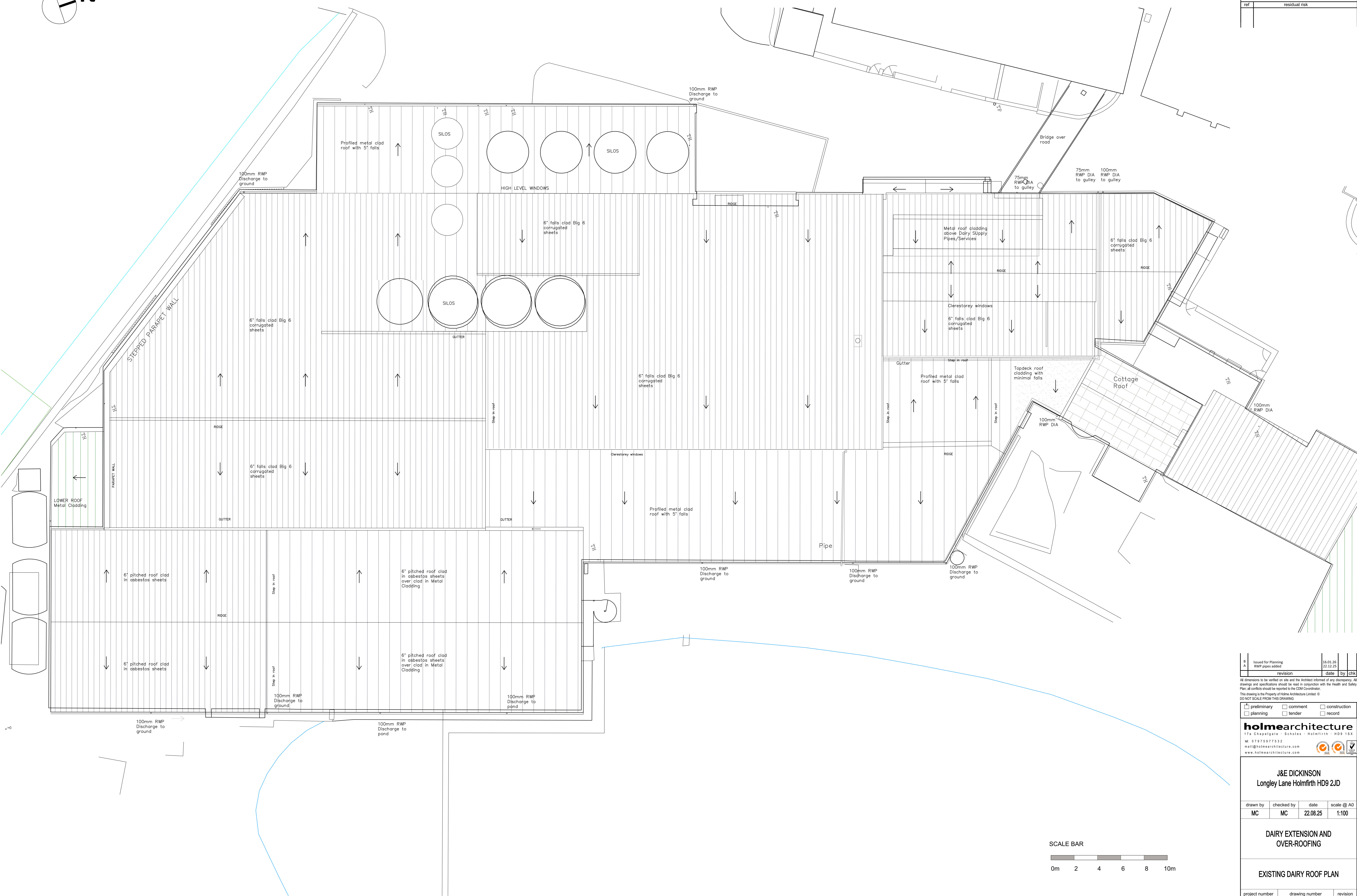

B	Issued for Planning	16.01.26
A	RWP pipes added	22.12.25

All dimensions to be verified on site and the Architect informed of any discrepancy. All drawings and specifications should be read in conjunction with the Health and Safety Plan; all conflicts should be reported to the CDM Co-ordinator. This drawing is the Property of Holme Architecture Limited. © DO NOT SCALE FROM THIS DRAWING.

revision	date	by	CHK

preliminary     comment     construction  
 planning     tender     record

**holmearchitecture**  
 17a Chapelgate · Scholes · Holmfirth · HD9 1SX  
 Tel: 01475 977532  
 mail@holmearchitecture.com  
 www.holmearchitecture.com

<b>J&amp;E DICKINSON</b> Longley Lane Holmfirth HD9 2JD			
drawn by	checked by	date	scale @ A0
MC	MC	22.08.25	1:100
<b>DAIRY EXTENSION AND OVER-ROOFING</b>			
<b>EXISTING DAIRY ROOF PLAN</b>			
project number	drawing number	revision	
120	<b>203</b>	<b>B</b>	

cat reference: D:\02 Projects\Longley\02\_Dairy\_Revamp\02\_Design\0203\_Existing Dairy Roof Plan.rvt