

Construction staff and operatives must ensure the principal contractor has provided thorough and accurate information on all health and safety aspects relating to the design identified on this drawing including the review of:

- Design/contractor risk assessments
- Method statements
- Points to work
- Pre construction information

The designer notes that the following health and safety risks relating to this drawing have not been eliminated during the design process:

ref	residual risk

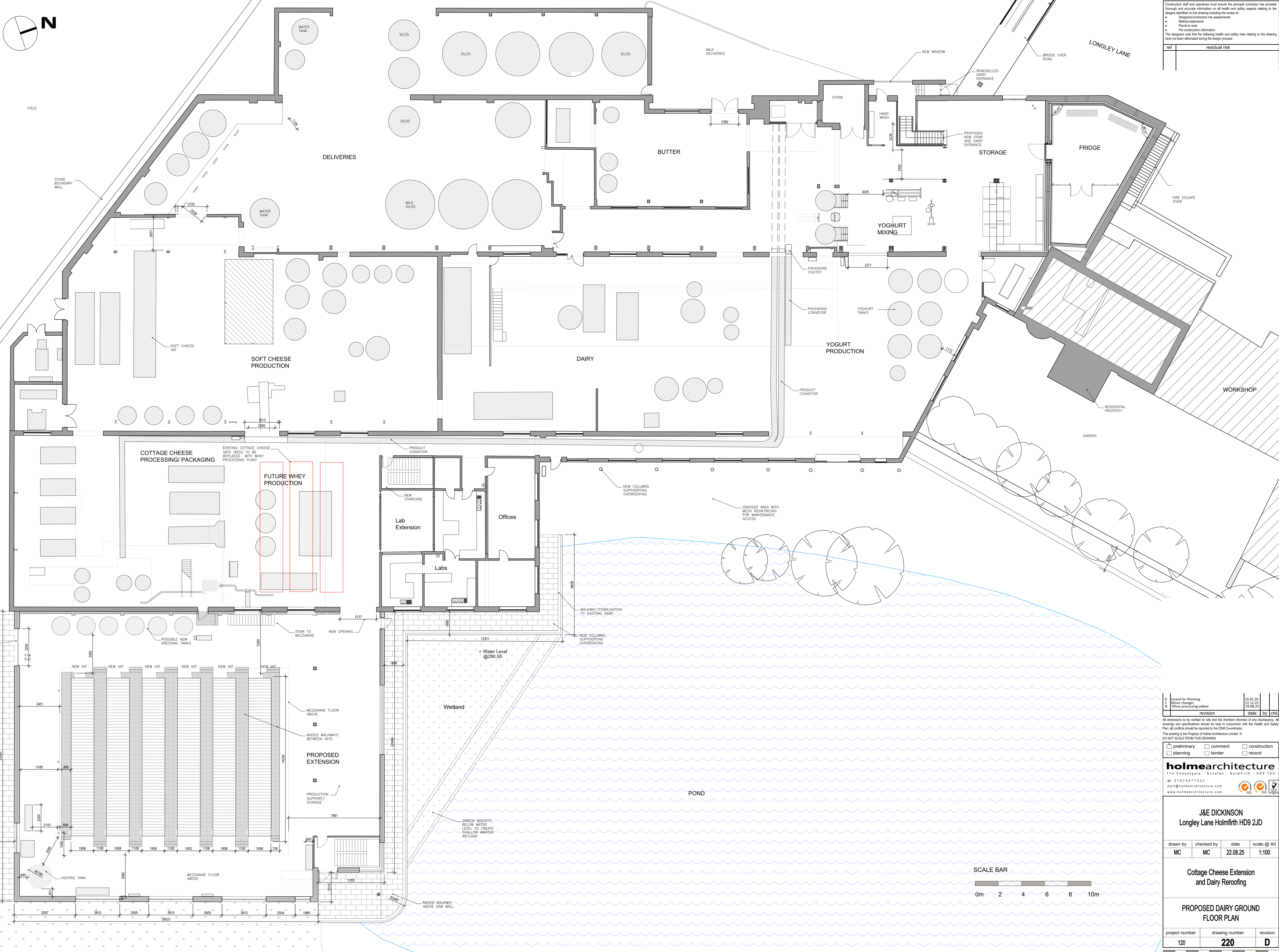

revision	date	by	CHK
A	14.01.20		
B	22.12.25		
C	23.08.25		

Issued for Planning  
 Minor changes  
 Whely processing added

All dimensions to be verified on site and the Architect informed of any discrepancy. All drawings and specifications should be read in conjunction with the Health and Safety Plan; all conflicts should be reported to the CDM Co-ordinator. This drawing is the Property of Holme Architecture Limited. © DO NOT SCALE FROM THIS DRAWING.

<input type="checkbox"/> preliminary	<input type="checkbox"/> comment	<input type="checkbox"/> construction
<input type="checkbox"/> planning	<input type="checkbox"/> tender	<input type="checkbox"/> record

**holmearchitecture**  
 17a Chapelgate - Scholes - Holmfirth - HD9 1SX  
 Tel: 01475 977532  
 mail@holmearchitecture.com  
 www.holmearchitecture.com

**J&E DICKINSON**  
 Longley Lane Holmfirth HD9 2JD

drawn by	checked by	date	scale @ A0
MC	MC	22.08.25	1:100

Cottage Cheese Extension and Dairy Reroofing

**PROPOSED DAIRY GROUND FLOOR PLAN**

project number	drawing number	revision
120	220	D

