

SECTION **ELEVATION**
1800mm HIGH CLOSE-BOARDED TIMBER FENCE
 (REF: BT01)

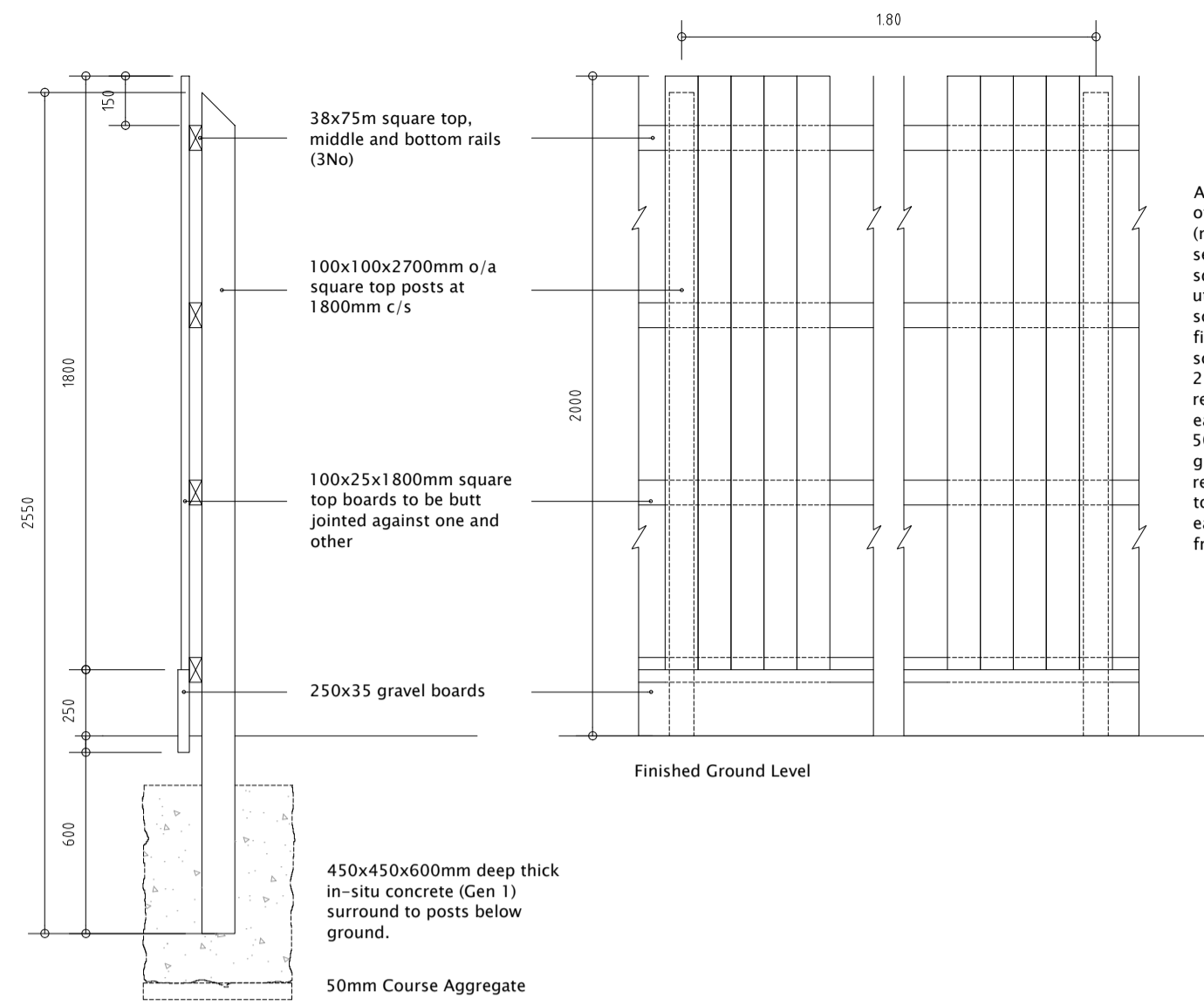

SECTION
2000mm HIGH ACOUSTIC TIMBER FENCE
 (REF: BT02)

Acoustic fence to comprise of timber post 2m High (min 100x100mm sections) infilled with a square topped fence panel utilizing 1800x100x25mm softwood tanilised boards fixed to 3no 75x38mm softwood tanilised rails. A 25mm timber toe board requires fixing between each panel with a min 50mm buried below ground level to act as a retainer. All boards to be butt jointed against each other to make a gap free fence

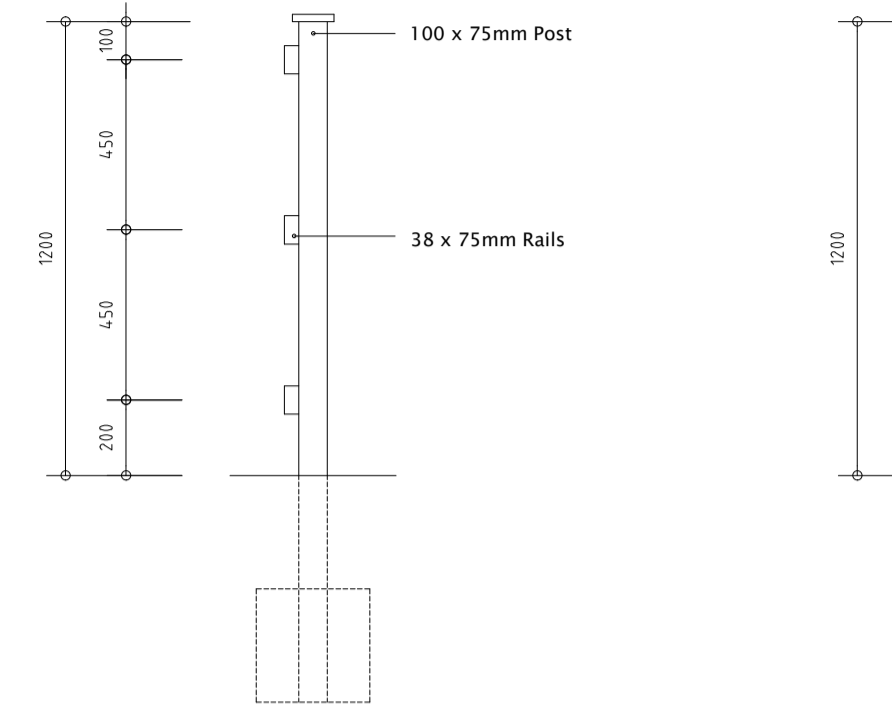

SECTION
1200mm HIGH POST & RAIL TIMBER FENCE
 (REF: BT03)

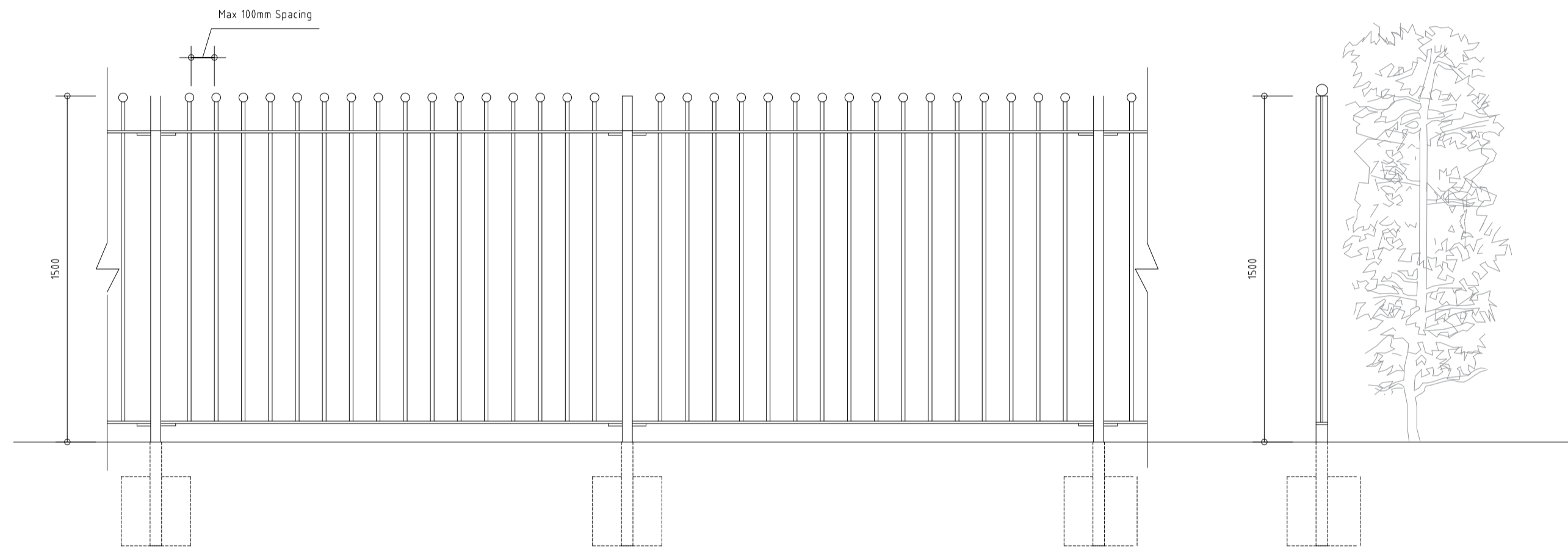
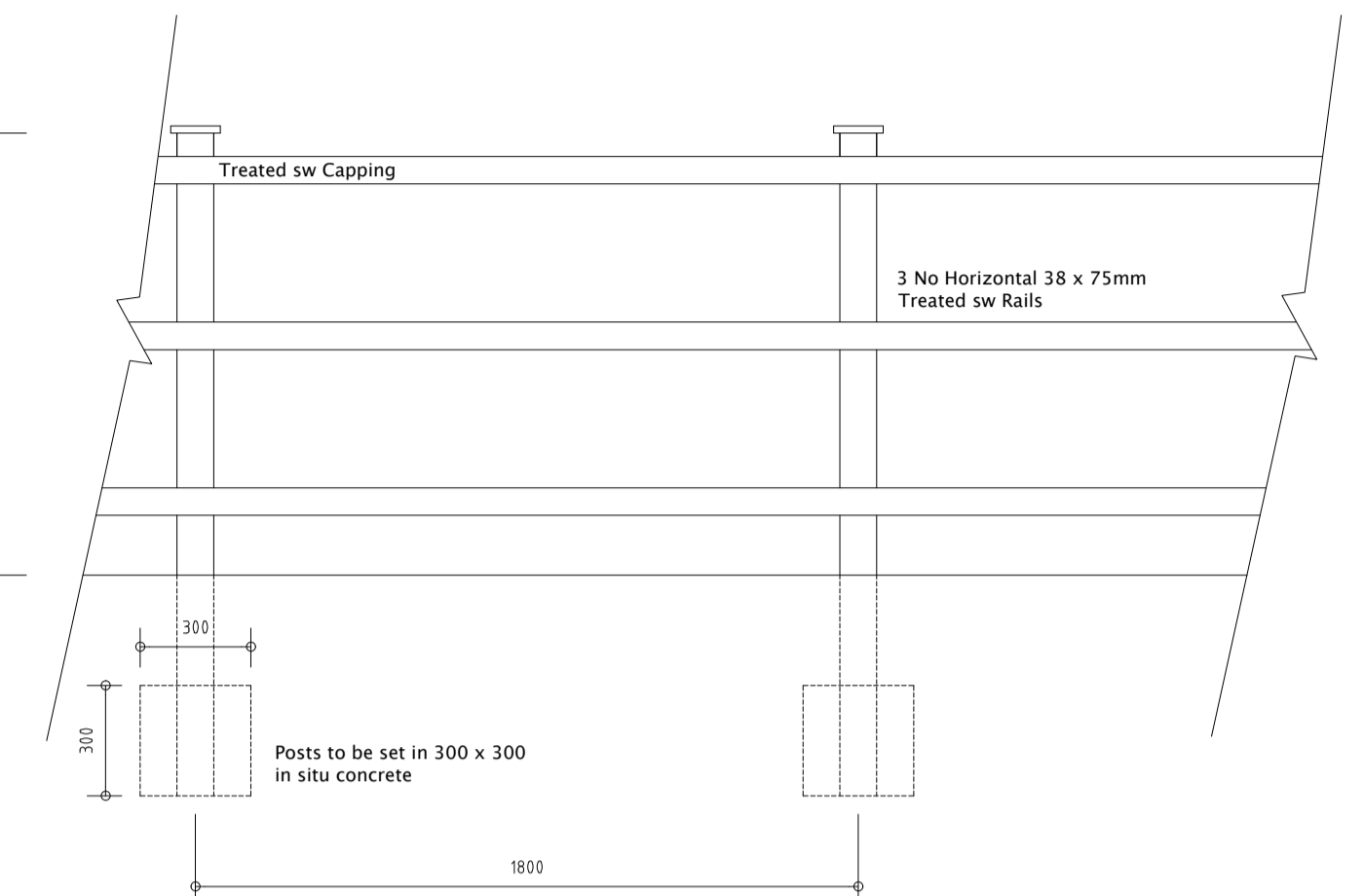

- Railings to be galvanised & polyester powder coated black
 - Footings to be set in concrete to manufacturers specification or core drilled and grouted in a retaining wall situation.
 - Hedge to be positioned behind the railing (Refer to landscaping plans for hedge specification).

Must be designed to be capable of resisting a horizontal load of at least 0.36kN/m at its minimum required height, in accordance with BS 6180.

SECTION
1500mm RAILING WITH HEDGE
 (REF: BT04)

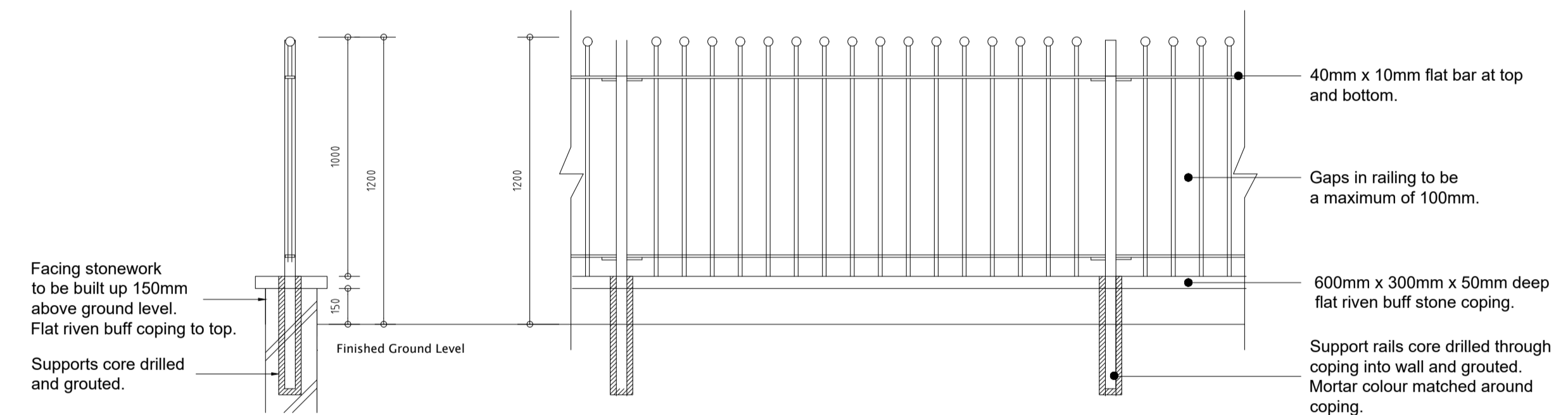

SECTION **ELEVATION**
1200mm BALL TOP RAILING
 (REF: BT05)

- Railings to be galvanised & polyester powder coated black

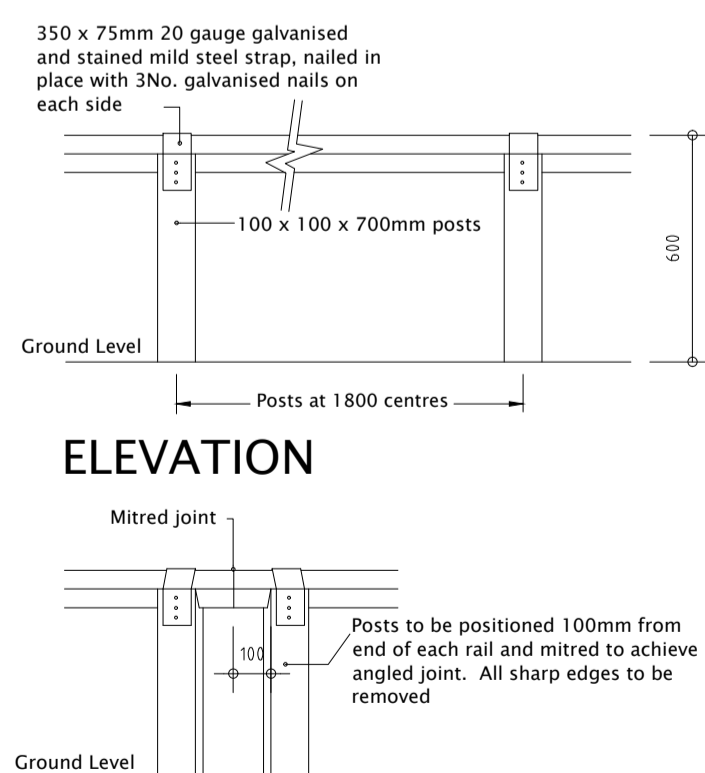

ELEVATION
600mm TIMBER KNEE RAIL
 (REF: BT06)

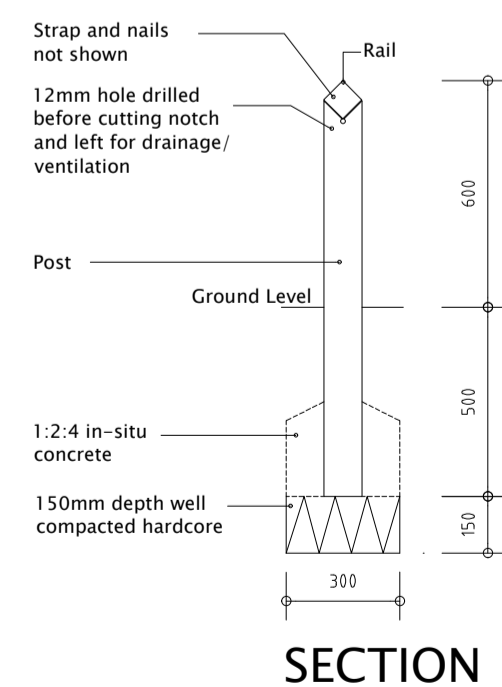

NOTES:
 1. All notch cuts to tops of posts are to be made prior to preservative treatment being applied.
 2. All timber is to be treated with an approved pressure-impregnated preservative.
 3. All timber to be sawn softwood.
 4. All fixings to be galvanised.
 5. Posts are to be positioned at 1200-1500mm centres, at all changes in direction and at all intersections.

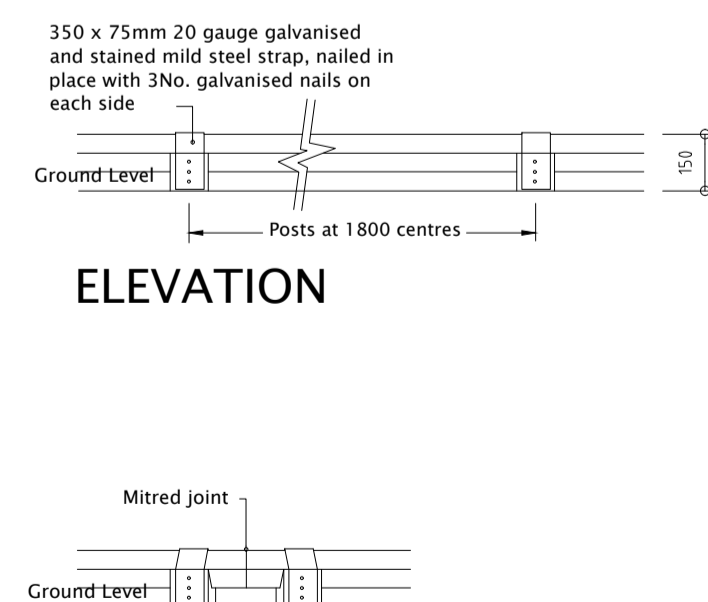

ELEVATION
150mm TIMBER KNEE RAIL
 (REF: BT07)

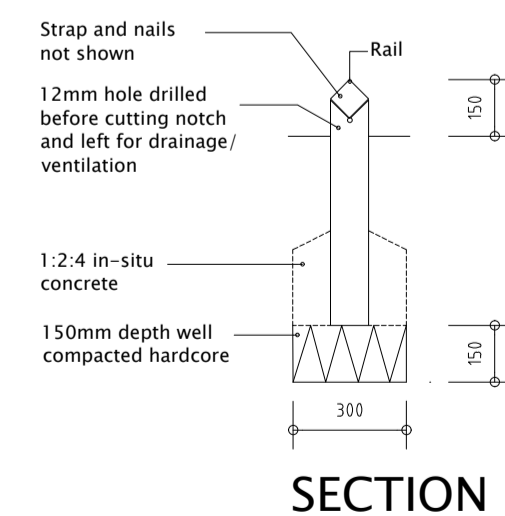

NOTES:
 1. All notch cuts to tops of posts are to be made prior to preservative treatment being applied.
 2. All timber is to be treated with an approved pressure-impregnated preservative.
 3. All timber to be sawn softwood.
 4. All fixings to be galvanised.
 5. Posts are to be positioned at 1200-1500mm centres, at all changes in direction and at all intersections.

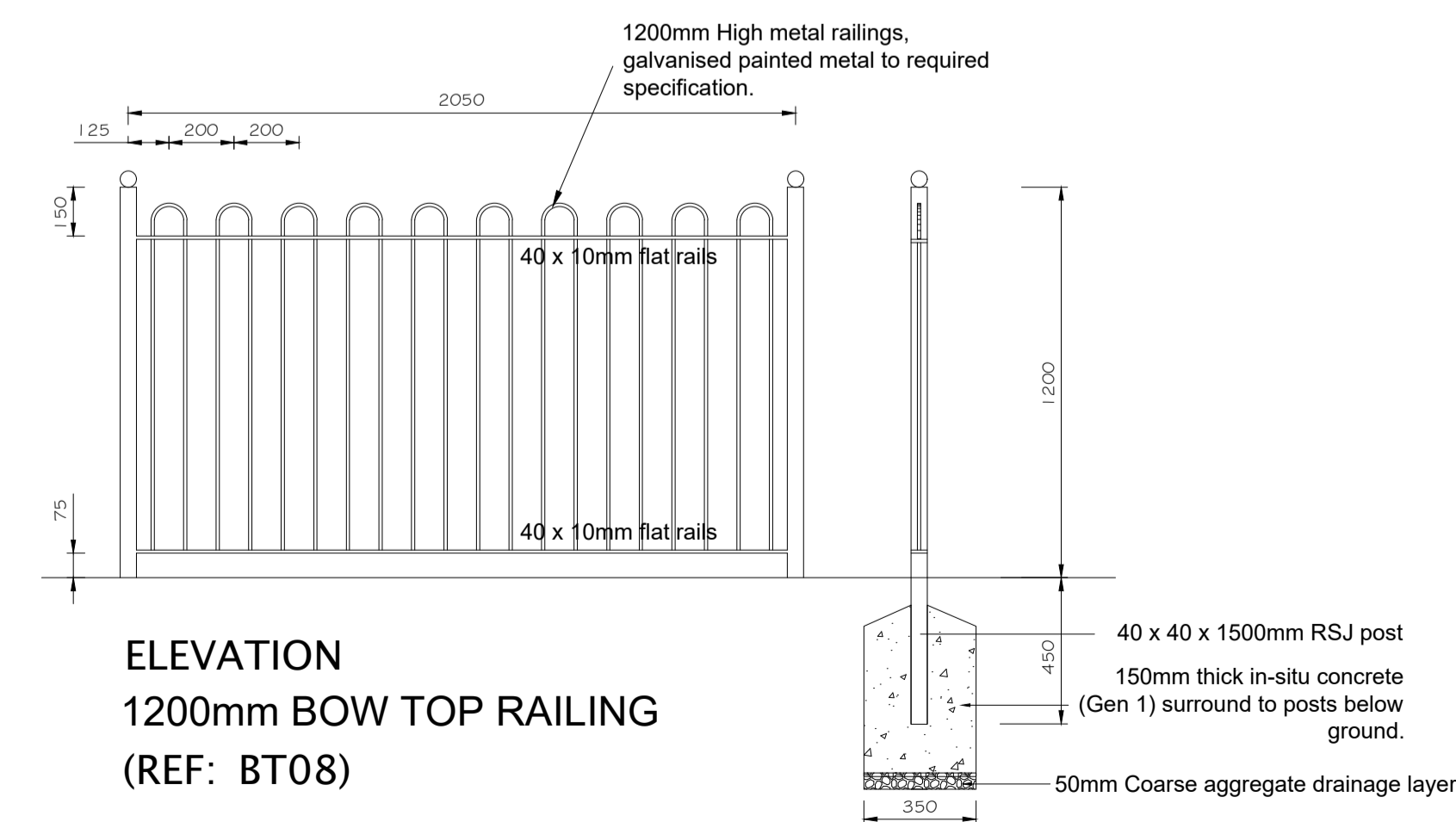

ELEVATION
1200mm BOW TOP RAILING
 (REF: BT08)

Rev	Description	Drawn	Date
C	Pier & panel wall removed and 1500mm railing with hedge amended to comply with building regs fall protection requirements.	JW	05.05.26
B	Title Block updated.	JW	05.05.26
A	Pier and panel wall added.	JW	29.01.26

miller homes
 Miller Homes Ltd - Yorkshire
 Lapwing House
 Peel Avenue, Calder Park
 Wakefield
 West Yorkshire, WF2 7UA
 Telephone 0870 336 4600
 Fax 0870 336 4602
 www.millerhomes.co.uk

Project Title
**Woodsome View,
 Lepton**

Drawing Title
Boundary Treatments

Scale	Drawn By	Checked By	Authorised By
1:20	JW		
	Date May '26	Date	Date
Job No.	Drawing No.	Revision	
811176	05	C	

Original Sheet Size A1