

NOTES:

- THIS DRAWING IS BASED UPON:
 - JRP SITE LAYOUT 22:5611:01X (FORMER AMENDED);
 - HAYCOCK AND TODD SITE SURVEY DRAWING S10979 DATED OCTOBER 2024;
 - SHEDDEN FOREMAN TREE PROTECTION PLAN DRAWING 21367-SFH-XXX-DR-L-TPP01 & TPP02 REV C DATED OCTOBER 2024;
 - ORDNANCE SURVEY MAPS.
- ALL LEVELS AND DIMENSIONS SHALL BE VERIFIED ON SITE PRIOR TO COMMENCEMENT OF ANY WORKS. ANY DISCREPANCIES SHALL IMMEDIATELY BE BROUGHT TO THE ATTENTION OF THE ENGINEER.

KEY:

- DEVELOPMENT BOUNDARY
- EXISTING LEVEL (TAKEN FROM TOPOGRAPHICAL SURVEY)
- PROPOSED LEVEL
- PROPOSED FALL/CURB
- PRIMARY ROAD CONTOUR (20m INTERVALS)
- SECONDARY ROAD CONTOUR (5m INTERVALS)
- BATTERS
- CHANNEL DRAIN
- PRIVATE DRAINAGE GULLY
- ROOT PROTECTION AREA OF RETAINED TREES

WALL TYPE & MATERIAL FINISH KEY

MASONRY RETAINING WALL (BRIDGESTREET NATURAL STONE)

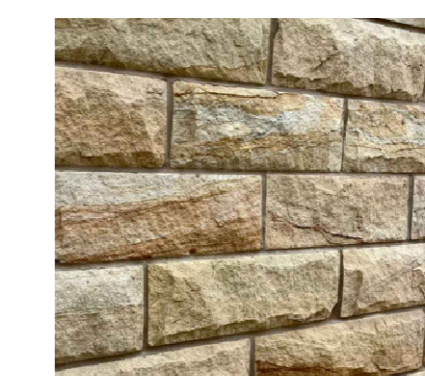

MASONRY RETAINING WALL (RECON STONE - NEWLAY PITCHED FACE CALDER BUFF)



AG WALL (CANELLETTO FACING)



CANELLETTO

FLAG ON EDGE

PRE-CAST L WALL (RECON STONE)

HIGHWAY RETAINING WALL (RECON STONE)

PLEASE REFER TO THE MATERIALS LAYOUT REF: 22:5611:03 REV J FOR MATERIAL SPECIFICATION. ALL FACING MATERIALS TO BE THE SAME AS THE CORRESPONDING PLOT MATERIAL.

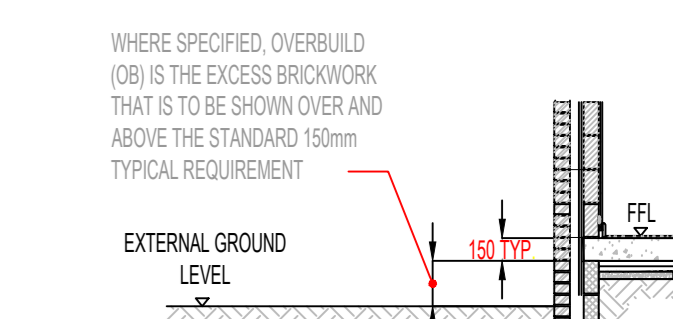

OVERBUILD DETAIL
(SCALE 1:50)

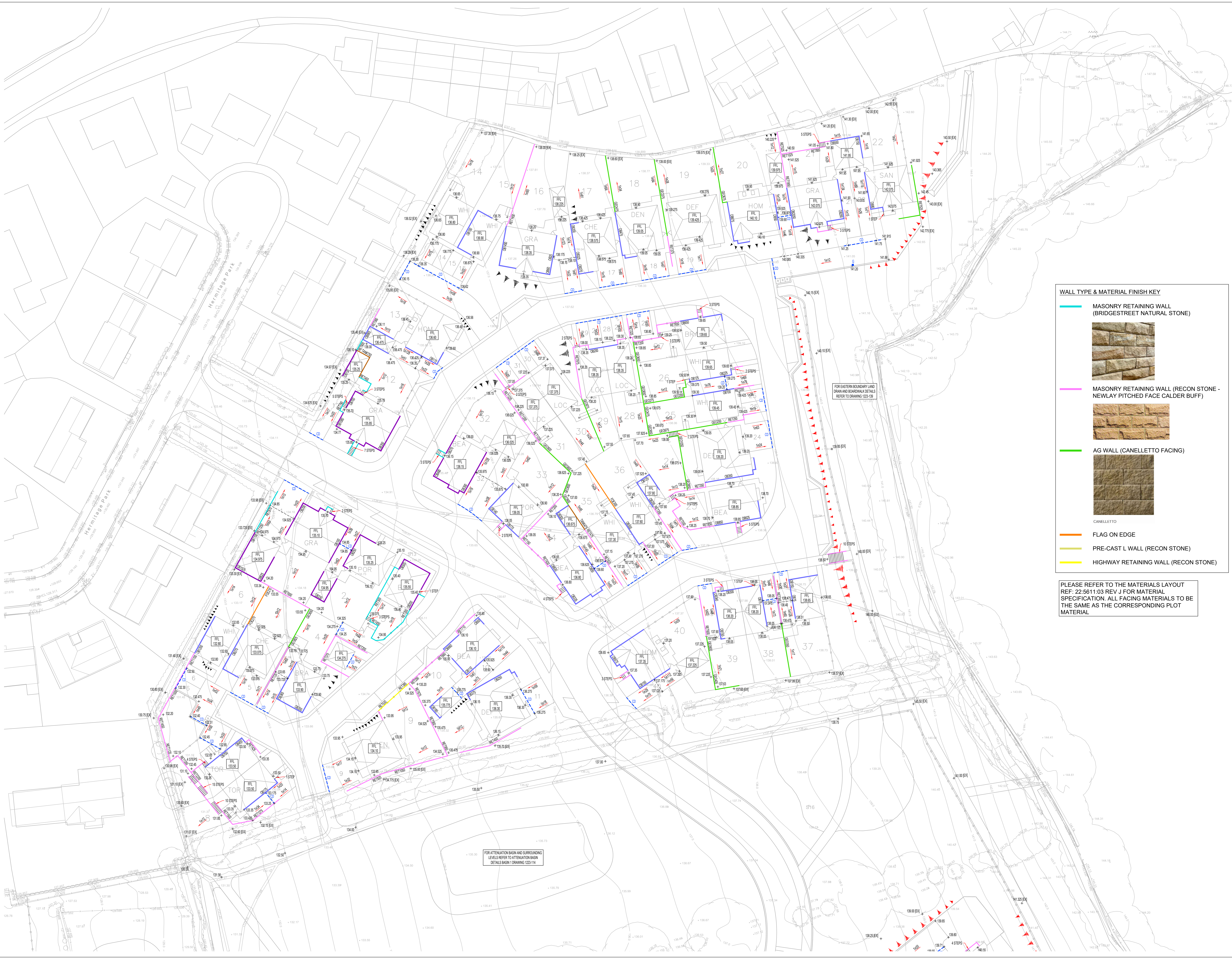

1	10.12.25	FIRST ISSUE	CR
Rev	Date	Amendments	By

miller homes

Project
HERMITAGE PARK, LEPTON

Drawing Title
WALL TYPE & MATERIALS SHEET 1 OF 2

Drawn: CR
Checked: JW
Scale: 1:250 @ A0
Date: DEC 2025

Drawing No.
ENG-20-01