

General Notes

- This drawing should not be scaled for setting out purposes.
- This drawing shows the detailed design only and is subject to Local Authority approval.
- This drawing is based upon a topographical / ordnance survey provided by others.
- This drawing is to be read in conjunction with all other relevant drawings.
- Any conflict between the details shown on this drawing and those of any other related drawings should be noted to the engineer prior to construction on site.
- All dimensions are in millimetres unless otherwise stated.

Construction Notes

- All levels to be confirmed on site prior to commencement of any works.
- Any existing utility covers retained are to be adjusted to suit proposed levels – cover class to be upgraded if required.
- Any existing utility covers that are damaged will require renewing and resetting.
- Gullies located in shared use surfaces must have suitable pedestrian and cyclist friendly covers. The openings in gully gratings must not align with cyclists anticipated wheel tracks.
- Any soft areas will require excavating until firm ground is found and backfilling with a 6F2 material and to be compacted in 150mm layers.
- Proposals assume a CBR of 2% – CBR tests to be undertaken by others for actual values and construction altered to suit.

Kerbing Notes

- Suitable transition kerbs shall be used at all changes in kerb face.
- For radii of 12m or less – kerbs of the appropriate radius shall be used. For radii 12m and above – straight kerbs 600mm long shall be used.
- The length of any kerb shall not be less than 450mm.

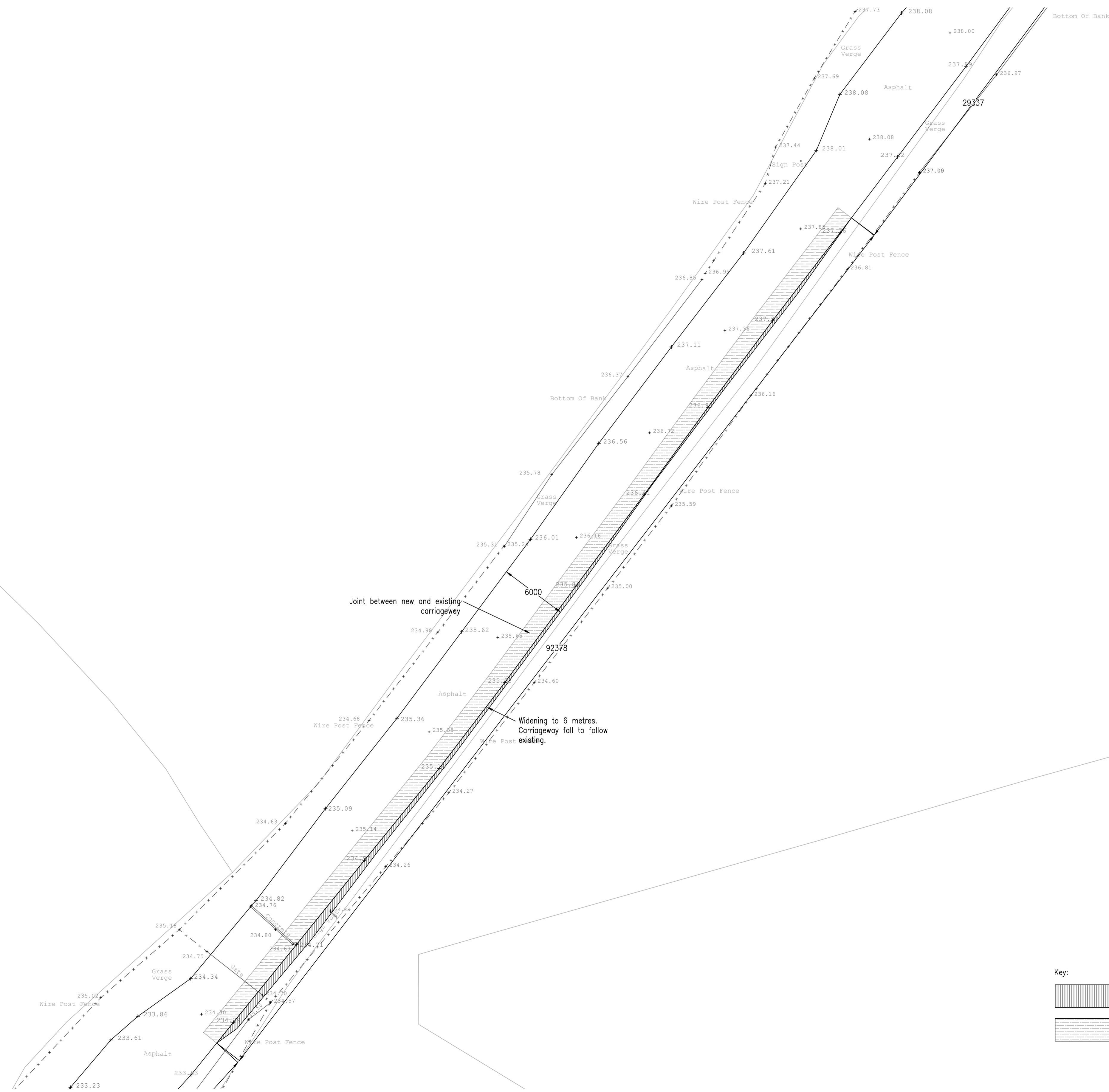

Key:

	Access construction
	Access resurfacing



PROJECT TITLE  
BROMLEY FARM QUARRY, UPPER CUMBERWORTH

DRAWING TITLE  
SURFACING – VIEWPORT 2

DRAWING NUMBER						
ORIGINATOR	PROJECT	VOL.	TYPE	ROLE	NUMBER	
PRGN	2074	HGN	DR	CH	0003	

CLIENT  
SILKSTONE ENVIRONMENTAL LTD

SCALE	SIZE	DRAWN	CHECKED	AUTHORISED	DATE
1:200	A1	AH	LO	AH	AUG 25

PARAGON HIGHWAYS  
PEACH HOUSE WEST, THE WALLED GARDEN  
NOSTELL ESTATE YARD  
WAKEFIELD WF4 1AB

01924 291536  
MAIL@PARAGONHIGHWAYS.COM