

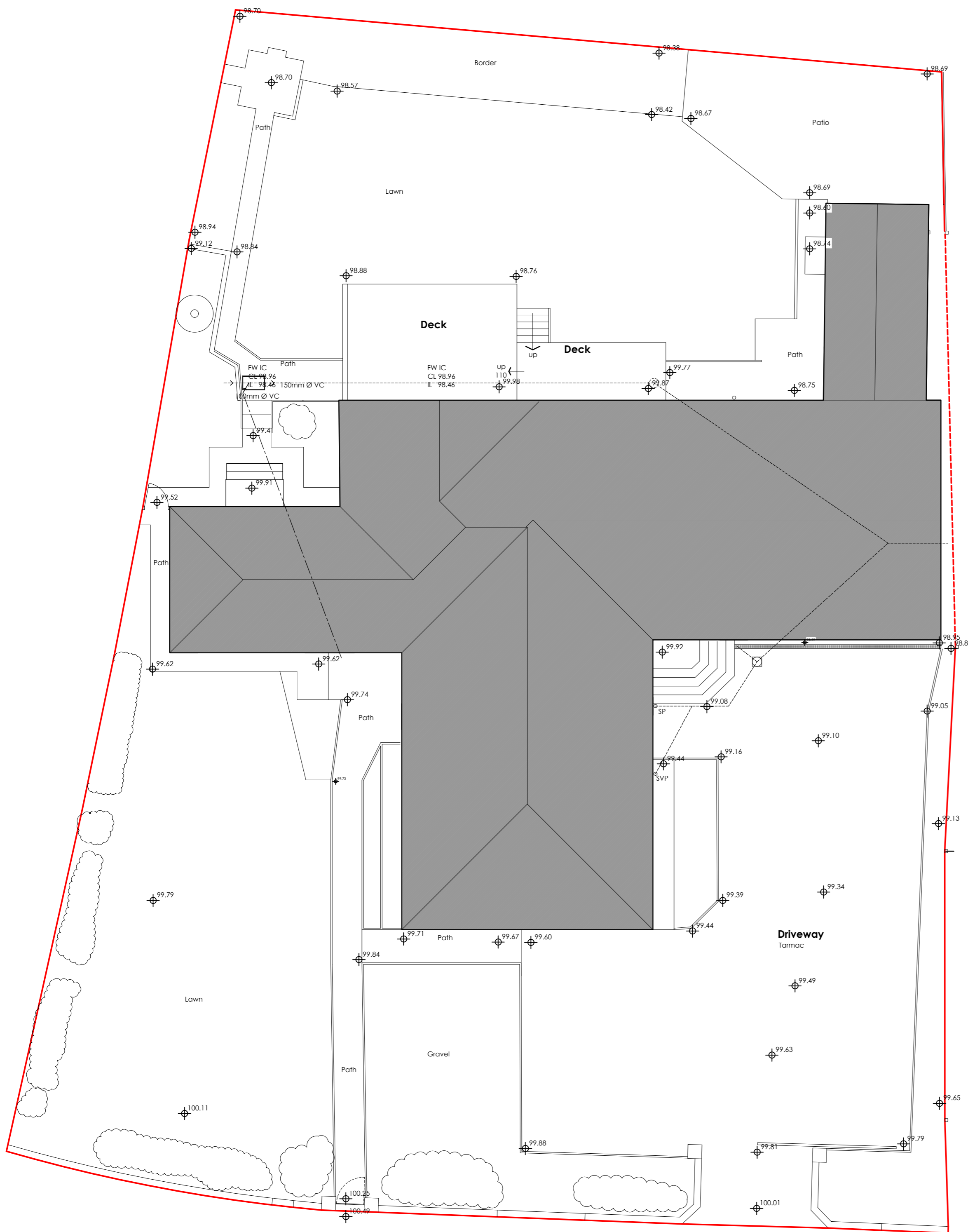

Orthomaps Survey. © Crown Copyright 2024. All rights reserved. Licence number 100022432
Site Location Plan, 1:1250



Existing Site Plan, 1:100

Note - drainage runs and positions of IC2 & M12 based on information in drainage survey prepared by MPH Maintenance Ltd

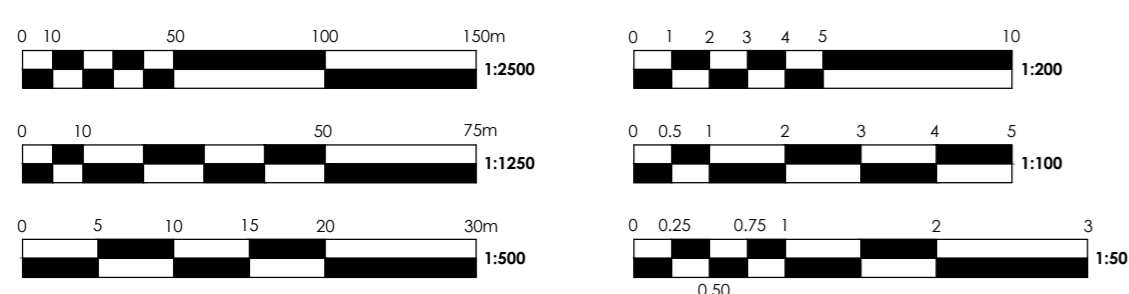

Revisions :	Description :	Date :

**HEALTH
 CARE
 DESIGN**

33 Low Road Keswick Village Norwich Norfolk NR4 6TZ
 Tel 01603 455200 Fax 01603 454343



DRAWING TITLE
Existing Site Plan

CLIENT
Robert McGregor

DATE SCALE REF
March 2024 As noted @ A1 EP

PROJECT
86 Fixby Road, Huddersfield, HD2 2JF

JOB NO / DWG NO
1001-01