



Planting Schedule

Proposed Trees

| Nr | Code | Tree Name | Specification | Girth | Height |
|-----------------|------|--------------------------------|---|---------|-----------|
| 2 | AaRH | Amelanchier arborea Robin Hill | Selected Standard Clear Stem 175-200 RB | 10-12cm | 300-350cm |
| 3 | AcS | Acer campestre 'Streetwise' | Heavy Standard Clear Stem 175-200 RB | 12-14cm | 350-425cm |
| 1 | Al | Amelanchier lamarckii | Selected Standard Clear Stem 175-200 RB | 10-12cm | 300-350cm |
| 2 | PPan | Prunus 'Pandora' | Selected Standard Clear Stem 175-200 RB | 10-12cm | 300-350cm |
| 2 | SaJR | Sorbus aucuparia 'Joseph Rock' | Selected Standard Clear Stem 175-200 RB | 10-12cm | 300-350cm |
| 1 | Sau | Sorbus aucuparia | Selected Standard Clear Stem 175-200 RB | 10-12cm | 300-350cm |
| Total 11 | | | | | |

Proposed Hedges (4m)

| Nr | Code | Tree Name | Specification | Height |
|------------------|------|-----------------------|---------------|---------|
| 529 | Fs | Fagus sylvatica | C | 60-80cm |
| 221 | Gli | Griselinia littoralis | C | 60-80cm |
| Total 750 | | | | |

Proposed Grasses

| Nr | Code | Plant Name | Ctr (l) | Nr/m2 |
|------------------|------|---------------------------------|---------|-----------------|
| 36 | FgEB | Festuca glauca 'Elijah Blue' | | 4m ² |
| 24 | MfRC | Miscanthus sinensis 'Red Chief' | | 3m ² |
| 84 | Pala | Pennisetum alopecuroides | | 4m ² |
| Total 144 | | | | |

Proposed Shrubs

| Nr | Code | Plant Name | Height | Ctr (l) | Nr/m2 |
|------------------|------|---|---------|---------|-----------------|
| 58 | Bg | Brachyglottis greyi | 30-40cm | 5L | 3m ² |
| 49 | BAN | Barberis thunbergii 'Atropurpurea Nama' | 40-60cm | 5L | 3m ² |
| 45 | CaS | Cornus alba 'Sibirica' | 60-80cm | 5-7.5L | 3m ² |
| 42 | CBM | Ceanothus 'Blue Mound' | 30-40cm | 5L | 3m ² |
| 44 | EfEG | Euonymus fortunei 'Emerald 'n' Gold' | 30-40cm | 5L | 4m ² |
| 22 | ERE | Escallonia 'Red Elf' | 40-60cm | 5L | 3m ² |
| 60 | Hi | Helichrysum italicum | 30-40cm | 5L | 4m ² |
| 57 | HISS | Hamamelis x intermedia 'Savill Starlight' | 30-40cm | 5L | 4m ² |
| 22 | Hr | Hebe rakaiensis | 30-40cm | 5-7.5L | 4m ² |
| 69 | HRE | Hebe 'Red Edge' | 20-30cm | 2L | 4m ² |
| 32 | Hs | Hebe 'Sutherlandii' | 30-40cm | 5L | 4m ² |
| 58 | LaH | Lavandula angustifolia 'Hidcote' | 30-40cm | 5L | 4m ² |
| 46 | LnMG | Lonicera nitida 'May Green' | 30-40cm | 5L | 3m ² |
| 31 | PE | Potentilla fruticosa 'Elizabeth' | 20-30cm | 2L | 4m ² |
| 49 | PIOL | Prunus laurocerasus 'Otto Luyken' | 40-60cm | 5L | 3m ² |
| 54 | PorL | Physocarpus opulifolius 'Red Lady' | 40-60cm | 5L | 4m ² |
| 10 | PSR | Pyracantha saphyr 'Red' | 40-60cm | 5L | 3m ² |
| 64 | SoT | Salvia officinalis 'Tricolor' | 20-30cm | 2L | 4m ² |
| 53 | Vd | Viburnum davidii | 30-40cm | 5L | 4m ² |
| 36 | Vmi | Vinca minor | 20-30cm | 2L | 4m ² |
| 11 | WFP | Weigela florida 'Folias Purpurea' | 40-60cm | 5-7.5L | 4m ² |
| 21 | WM | Weigela Florida 'Monet' | 30-40cm | 5-7.5L | 4m ² |
| Total 933 | | | | | |



Planting Notes
 Topsoil shall be a minimum of 400mm depth over planting beds and graded to fall. Imported topsoil must be BS3882:2015 compliant and existing topsoil must be cultivated in accordance with BS3882:2015. No cultivation should take place in well waterlogged conditions.
 Herbicide and cultivation: Topsoil to be treated with two applications of herbicide prior to planting, where necessary, strictly in accordance with the Control of Pesticides Regulations 1986 (as amended 1997, or otherwise updated/superseded legislation) and following manufacturer's instructions by qualified staff. The topsoil shall then be cultivated to 150mm depth.
 Planting: All planting must be in accordance with BS3036:1992 Nursery Stock and BS 8545:2014 Trees from Nursery to Independence.
 Trees: All tree planting should conform to BS8545:2014. Standard trees to be planted in pits 800x600x450mm or dimensions of rootball, whichever is greater. Heavy and Extra Heavy Standard trees to be planted in pits 1000x1000x600mm or dimensions of rootball, whichever is greater. Align soil improver and 150g Emerald (or equivalent) to be incorporated into the soil of all new tree pits. Trees to be planted centrally within a tree pit. Tree stakes shall be of hazel, chestnut or other approved timber. They shall be round, rough sawn, straight, free from projections, large or edge knots and other defects and be pointed at the lower end. They shall be strong enough not to split when driven into the ground and when ties are nailed to them (both initially and when adjusted). For Feathered trees use 2m stakes (1.4m by 70mm) to be driven into ground 800mm, leaving 600mm above ground. For Selected Standard Trees 2m stakes (1.7m by 100mm) and cross bar are required, stakes to be driven 500mm below ground leaving 800mm above ground. For Heavy Extra Heavy trees use 2m stakes (2.2m x 100mm) with a 400x100x15mm cross bar. Stakes to be driven into ground 1m leaving 1.2m above ground.
 Tree ties: All tree ties to be Green-Tech Fibrillated Natural Tree Ties. Natural tree tie is made entirely of natural fibres and is fully bio-degradable. A spacer by formed using the Natural tree tie itself. It will not strangle the tree and will bio-degrade as the tree establishes itself.
 Native Woodland / Shrub areas: Soil depth shall consist of 300mm topsoil and 600mm subsoil (in accordance with BS3882:2015).
 Container grown shrubs, transplants and whips: Shrubs and transplants shall be planted in pits 300x300x400mm (depth), and the backfill shall include 3 litres of peat-free tree and shrub compost. Where two or more shrub species are indicated within a single bed each species shall be randomly mixed throughout the bed in groups of 3/5.
 Herbicide: Spot treat with herbicide throughout the maintenance period in accordance with the manufacturer's instructions.
 Mulch: Planting beds to receive 75mm depth pulverized ornamental bark mulch. Native woodland / shrub / hedgerow plants to be planted with Green-Tech Mulch Mat - Type 11. Mulch Mats are 100% biodegradable with an approximate three year lifespan. Mulch Spats are ready-cut for individual plant production with a centre hole for plant protection. Mats pinned to soil.
 Plant position: Final position of trees and shrubs subject to confirmation of service location and approval of statutory undertakers.
 Protection to planting: Native hedgerow plants, trees and shrubs within mires to be protected by Green-Tech Bio Earth Tree Shelter. The Bio-Earth Tree Shelter is made from a special water-proof FSC-approved cardboard which is 100% biodegradable, recyclable, and compostable. Lifespan is typically 3 years. Once the tree / shrub has established enough to no longer need it, the Bio-Earth Tree Shelter can be left to safely biodegrade.
 Ornamental hedging: Hedges to comprise a single row of plants, 400mm wide trench excavated to take plants and topsoil cultivated to 400mm depth prior to application of fertilizer.
 Grass: All turfbed areas to be cultivated and levelled as required removing any stones, rubble, subsoil, general construction waste.
 Planting Season: Bare-root shrubs to be planted between mid-November and mid-March dependent upon the planting season.

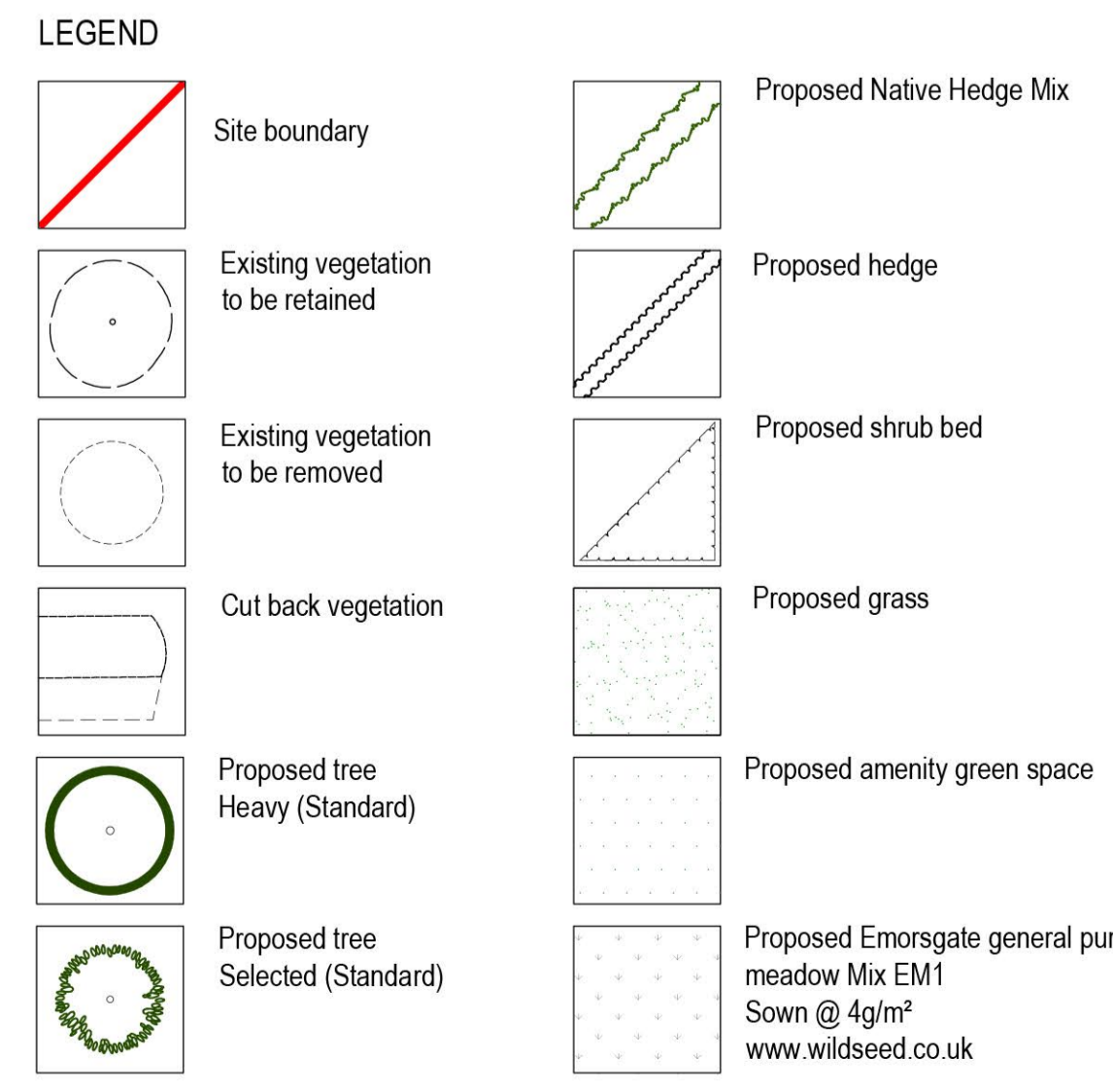

This drawing is the copyright of Rosetta Landscape Design and cannot be reproduced in any form without the express consent of the company. Within and scaled dimensions to be checked on site, any discrepancies reported prior to work commencing. If in doubt please ask.

This drawing has been prepared for the purpose of planning approval.

Rev A: Revised to Elder Lester Architect drawing 2440-P001E - 04Dec25 (BP)
 Base: Elder Lester Architect drawing 2440-P001C Received 10 Nov 25

| | | | |
|---------|------------------------------|-------------|----------|
| PROJECT | Parkwood Road, Golcar | | |
| TITLE | Detailed Landscape Proposals | | |
| CLIENT | Mandale Construction Ltd | | |
| DATE | 17 Nov 25 | SCALE 1:250 | SHEET A0 |
| DRAWN | RP | DRAWING NO | 4230/1 |
| CHECKED | BP | REVISION | A |

ROSETTA LANDSCAPE DESIGN
 Landscape Architects
 Swallow's Nest, Main Street
 Akhram Richard, York, YO23 3PT
 Telephone +44 (0)1904 500410
 Email: design@rosettalandscape.co.uk
 Web: www.rosettalandscape.co.uk