

Notes:
 This drawing is the sole copyright of KPP Architects Ltd and reproduction in any form is forbidden unless permission is obtained in writing.
 Do not scale from this drawing. Any discrepancies on site should be brought to the attention of KPP Architects Ltd.
 Work and materials must comply with the current building regulations and codes of practice and be read in conjunction with building specifications and other sub-contractors information. All materials are to be installed in strict accordance with the recommendations of the manufacturers.

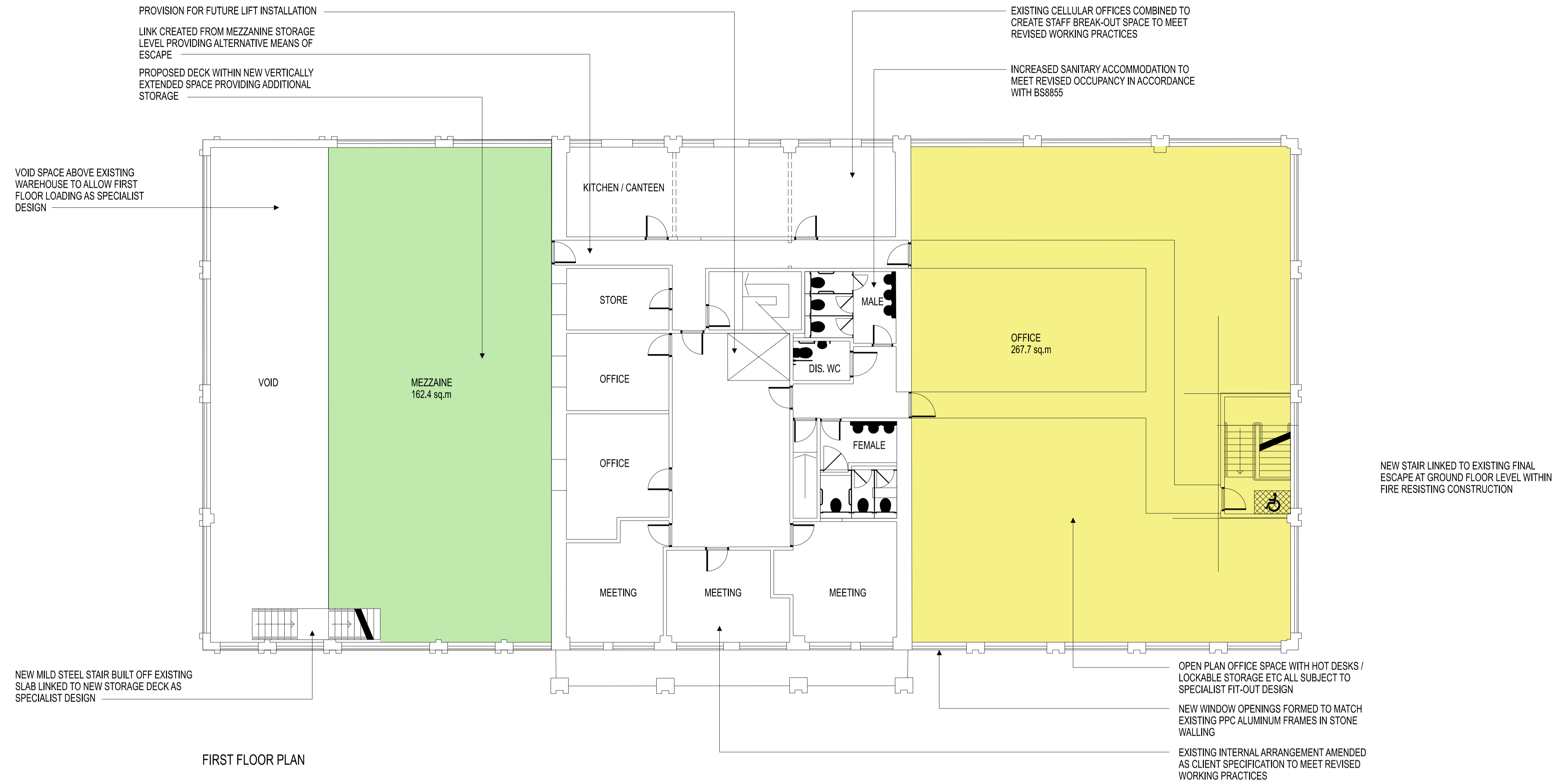

FIRST FLOOR PLAN

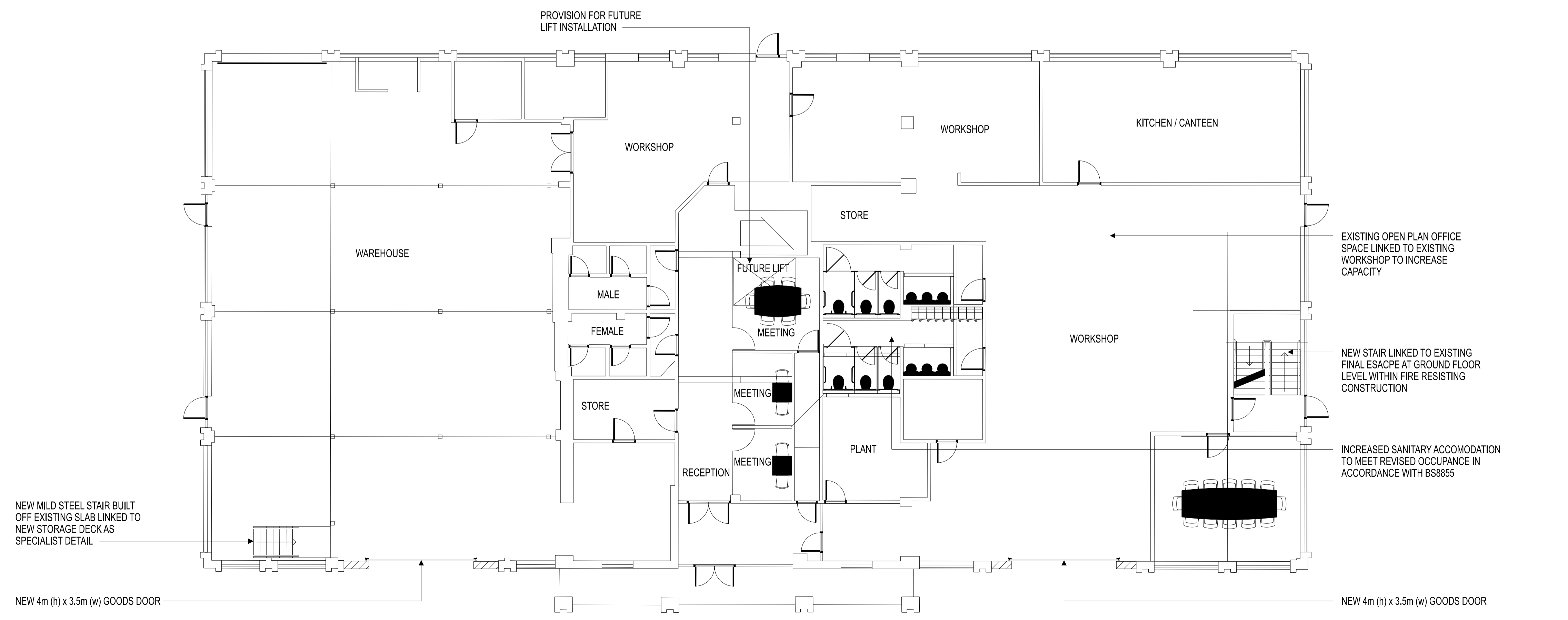

GROUND FLOOR PLAN

P01	ISSUED FOR PLANNING	AB	FEB'25
Rev	Description	By	Chkd

Client
RELIANCE PRECISION LIMITED

Project Title
ROWLEY MILLS

Drawing Title
PROPOSED BUILDING PLANS

KPP ARCHITECTS
 Lodge House
 12 Town Street
 Horsforth, Leeds LS184RJ
 T : +44 (0) 113 2390460
 E : architects@kpp-leeds.co.uk
 W : www.kpp-leeds.co.uk

Scale	Size	Date	Drawn	Checked
1:100	A1	FEB'25	JB	AB

Status PLANNING	
KPP Job No 2421	Rev P01
Number 2105	