

Refer to Drawing "08.24007-ACE-ZZ-ZZ-D-C-2003"

Refer to drawing "08.24007-ACE-ZZ-ZZ-D-C-2004"

Refer to drawing "08.24007-ACE-ZZ-ZZ-D-C-2002"

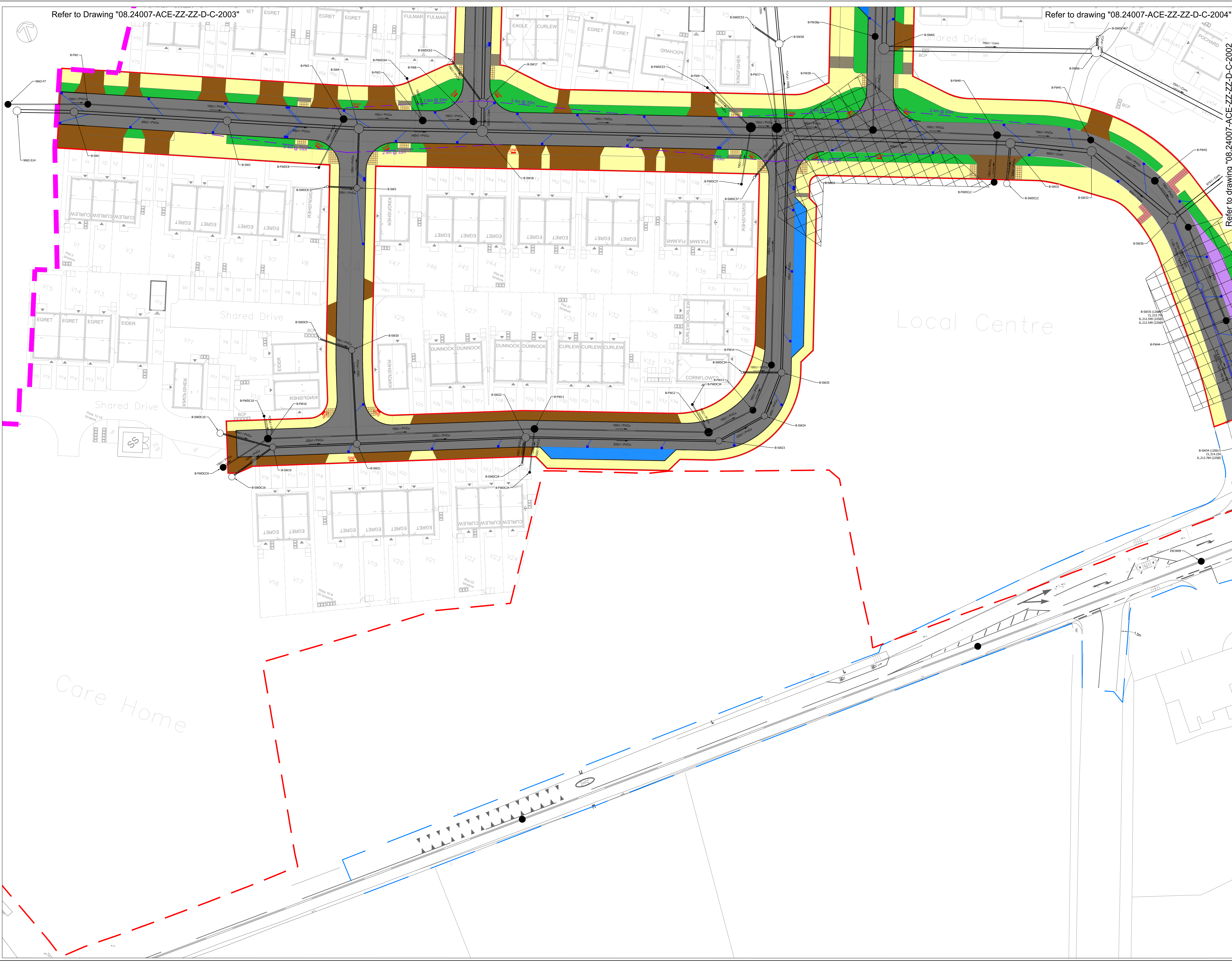

**Do Not Scale**

**Drawing Notes**  
 Drawing & schedule based on the following information:  
 Architect's drawing/model: AWSM - Countryside Collection Layout  
 Received: 23.09.25  
 Topographic Survey: Received:  
 Residual Hazards:

**Health, Safety & Environmental Notes**

**KEY**

- Site Boundary
- S38 Highway Boundary - Phase 1
- S38 Highway Boundary - Phase 2
- Parcel Boundary
- Asphalt Footways and Footpaths
- Hard Margin
- Vehicular crossing footway/margin
- Flexible surfaced asphalt carriageway
- Block Paved surfaced carriageway
- Block Paved Ramp
- Landscaping
- Visitor Parking
- Transition Strip
- Service Margin
- S104 SW Attenuation Tank
- Possible extent of Tensar Triax HX165 Geogrid (or equivalent). Refer to litho's remediation strategy, Litho's Earthworks specification and Adept drawings 2082 and 2083 for further details.
- Visibility Splay
- Channel Drain
- S38 gully and gully leg
- S38 highway drainage
- S104 surface water sewer
- S104 foul water sewer
- S104 Combined sewer
- Tactile Paving - Uncontrolled Crossing
- Tactile Paving - Controlled Crossing
- Courdroy Tactile Paving - Controlled Crossing
- Street light design
- Street name plates

|          |   |     |    |    |
|----------|---|-----|----|----|
| 26.09.25 | Updated to latest highway layout                              | CS  | AT | P4 |
| 28.08.25 | Geogrid extents updated as per geotechnical engineers drawing | CS  | AT | P3 |
| 17.02.25 | Updated to suit frost recent quarry survey                    | WD  | AT | P2 |
| 07.02.25 | Initial Issue   | CRS | AT | P1 |

| Date | Description | By | Chk | Rev |
|------|-------------|----|-----|-----|
|      |             |    |     |     |

**ADEPT**  
 CIVIL AND STRUCTURAL CONSULTING ENGINEERS

Web: www.adeptco.com    Office Address: 2912 Mill, Sunny Bank Mills, Farsley, Leeds LS28 5JJ  
 Email: info@adeptco.com    Tel: 0113 239 4518

Project: **Blackmoorfoot, Huddersfield**

Title: **S38 General Arrangement Phase 1 Sheet 1 of 4**

Client: **Countryside Partnerships**

|             |                      |                                |              |                      |
|-------------|----------------------|--------------------------------|--------------|----------------------|
| Scale: # A0 | Initial author: CRS  | Initial checker: AT            | Approver: RP | Initial Date: JAN 25 |
| Status: S2  | Purpose: Preliminary | Adept Project Number: 08.24007 |              | Rev: P4              |

Project Originator/Functional Breakdown/Spatial Breakdown/Form Description Number: 08.24007-ACE-00-ZZ-D-C-2001