



Jade3 Architecture Ltd

Jade3 Architecture Ltd, Studio 114, Westbourne Road, Huddersfield HD1 4LF
Cellphone . 07535 740097 www.jade3architecture.co.uk

land off Lockwood Road and Albert Street,
(at rear of Kwik fit unit on Bath Street)
Lockwood
Huddersfield
HD1 3QW

Project No. 2025 Enquiry 70
Project Title proposed site and floor plan

Drawn By [blank] Reviewed By MC Scale 1:200 @A3 size Date 31/10/2025

Drawn No. 101 Reviewed Title [blank] Revision B

revisions
A 1-4-2026
The unit is being moved towards the entrance on slightly higher ground but still on stilts and elevated in line with drainage officers suggestion and to minimise flood risk

B 27-4-2026
queue stacking spaces added and a one way loop route to council highways suggestions

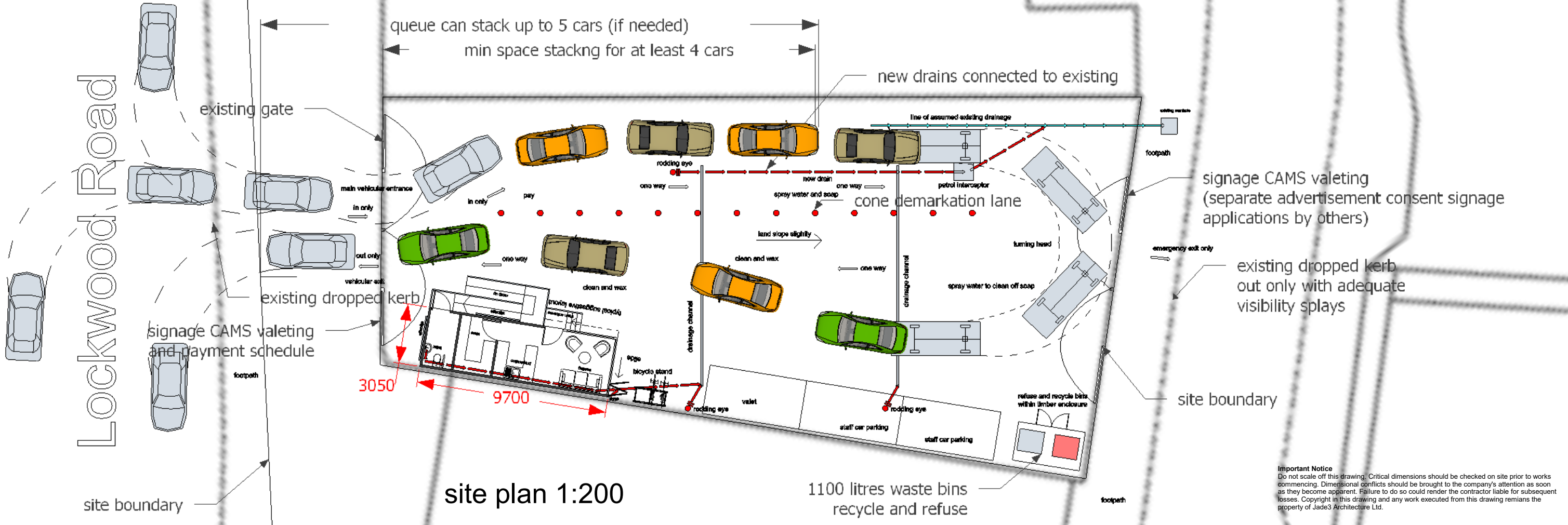
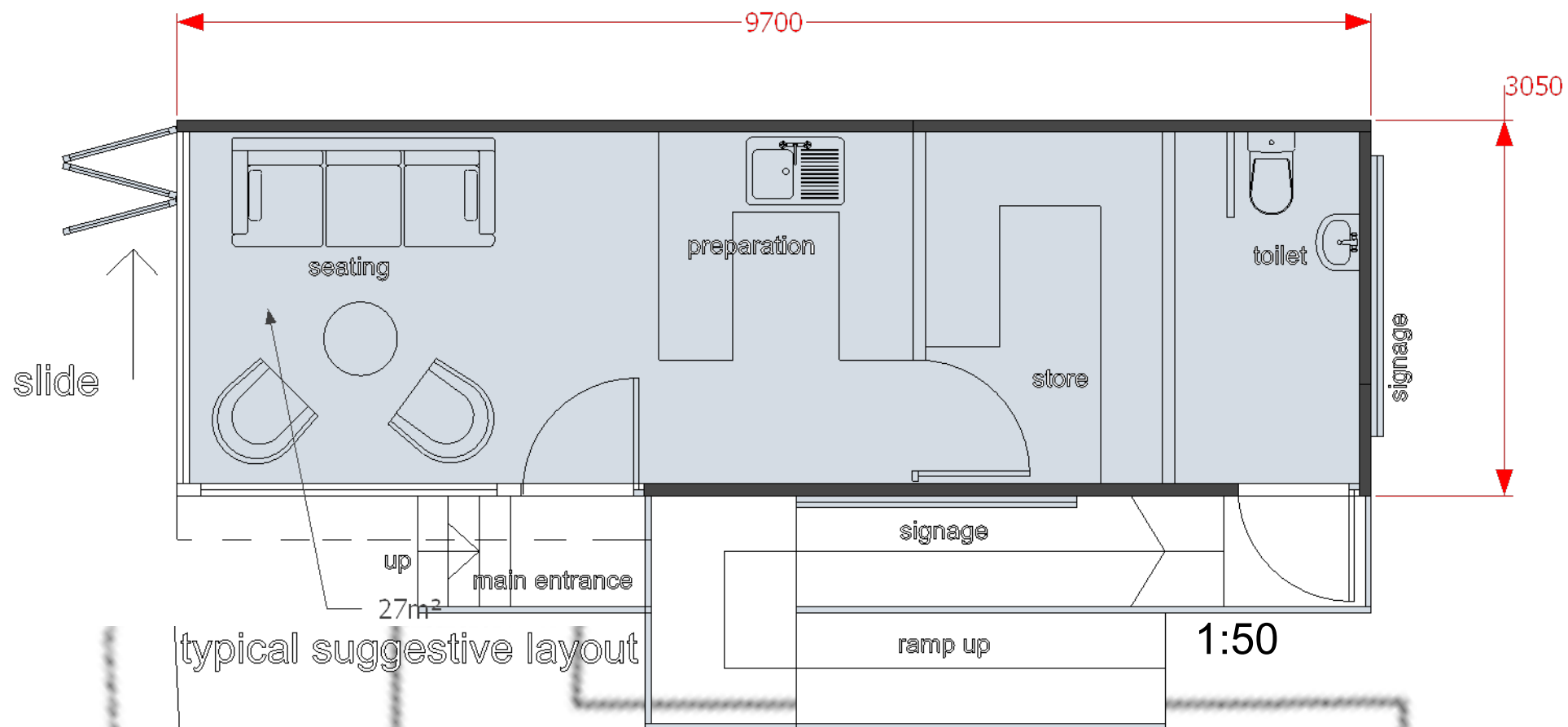

Important Notice
Do not scale off this drawing. Critical dimensions should be checked on site prior to works commencing. Dimensional conflicts should be brought to the company's attention as soon as they become apparent. Failure to do so could render the contractor liable for subsequent losses. Copyright in this drawing and any work executed from this drawing remains the property of Jade3 Architecture Ltd.