

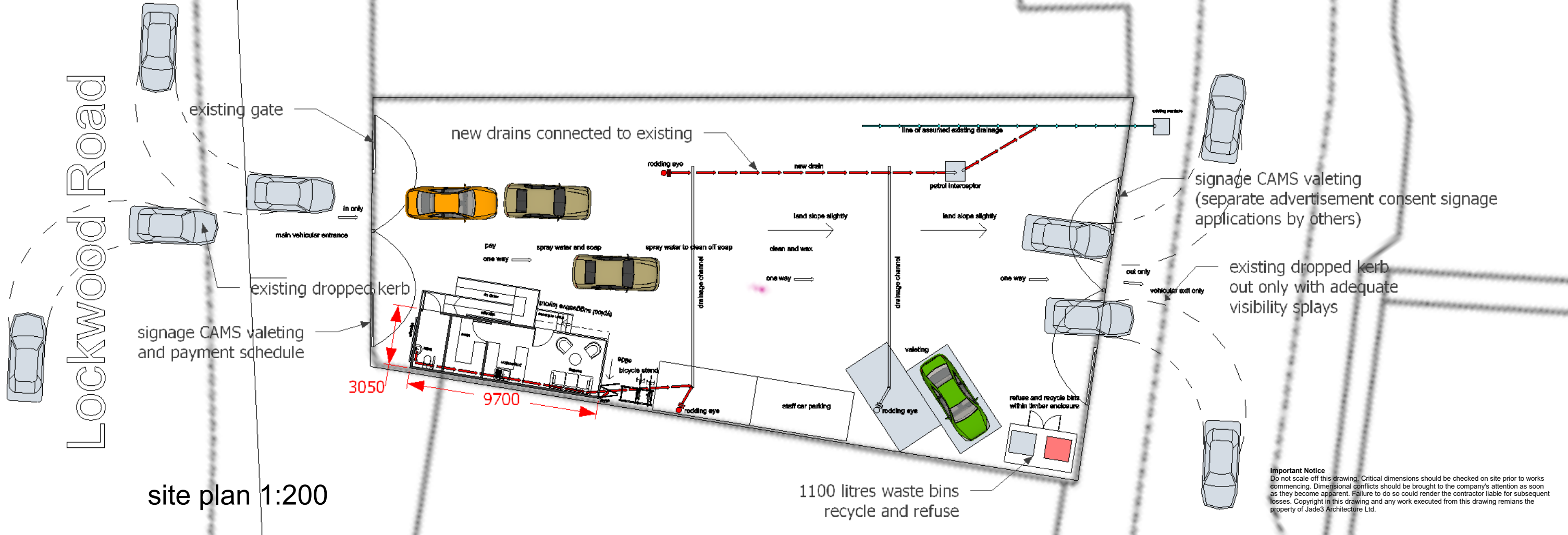

land off Lockwood Road and Albert Street,
(at rear of Kwik fit unit on Bath Street)
Lockwood
Huddersfield
HD1 3QW

Project No. 2025 Enquiry 70	Project Title proposed site and floor plan	Scale 1:200 @A3 size	Date 31/10/2025
Drawn By	Reviewed By MC		
Drawn No. 101	Reviewed Title		Revision A

revisions
A 1-4-2026
The unit is being moved towards the entrance on slightly higher ground but still on stilts and elevated in line with drainage officers suggestion and to minimise flood risk

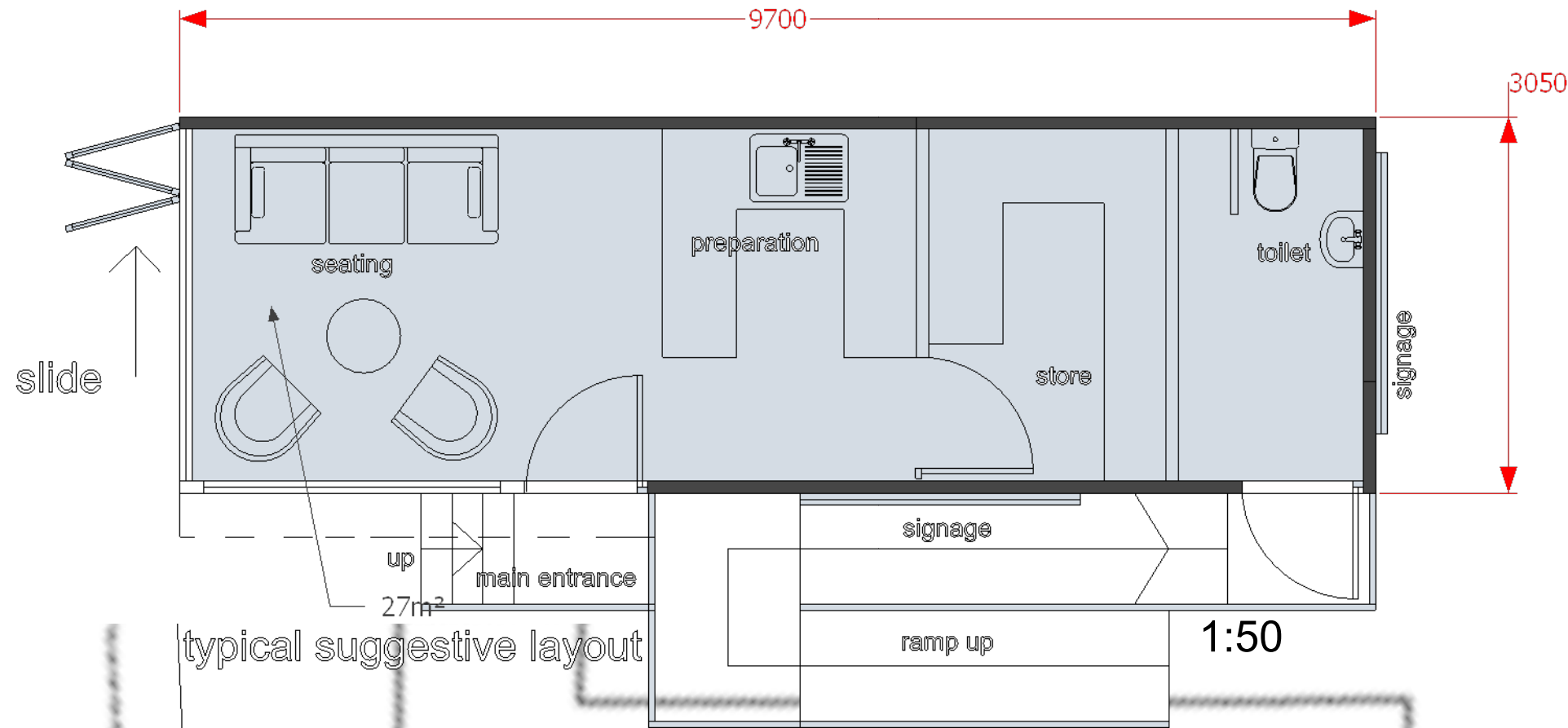

Important Notice
Do not scale off this drawing. Critical dimensions should be checked on site prior to works commencing. Dimensional conflicts should be brought to the company's attention as soon as they become apparent. Failure to do so could render the contractor liable for subsequent losses. Copyright in this drawing and any work executed from this drawing remains the property of Jade3 Architecture Ltd.