

PROJECT ARCHITECT TO BE NOTIFIED OF DISCREPANCIES IN FIGURED DIMENSIONS. CONTRACTOR TO VERIFY ALL DIMENSIONS ON SITE. THIS DRAWING IS COPYRIGHT.

| Schedule of Areas | |
|----------------------------|--------------------------|
| Ground Floor GIA | 19,677 sq.ft / 1828 sq.m |
| Ground Floor Sales | 17,524 sq.ft / 1628 sq.m |
| Ground Floor Back of House | 2,046 sq.ft / 190 sq.m |
| Mezzanine GIA | 721 sq.ft / 67 sq.m |

Key

Key Plan

Notes

| Rev | Description | Date |
|-----|-------------------|----------|
| P00 | Preliminary issue | 16.06.25 |

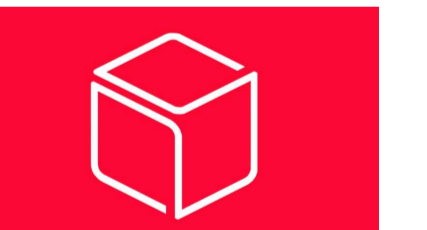

Whitebox Architecture + Design
3 Kenswick Manor
Lower Broadheath
Worcester WR2 6QB

Client
WESTMINSTER PROJECT SERVICES LTD

Project
UNITS 9 & 10, BIRSTALL RETAIL PARK
BIRSTALL, LEEDS, WF17 9DT

Drawing Title
GROUND FLOOR PLAN AS EXISTING

| Project No. | Drawing No. | Revision |
|-------------|----------------|----------|
| 1278 | WHB-MA[20]0001 | P00 |
| Scale | Date | Drawn by |
| 1:100@A1 | 16.06.25 | WHB |

Status
PLANNING

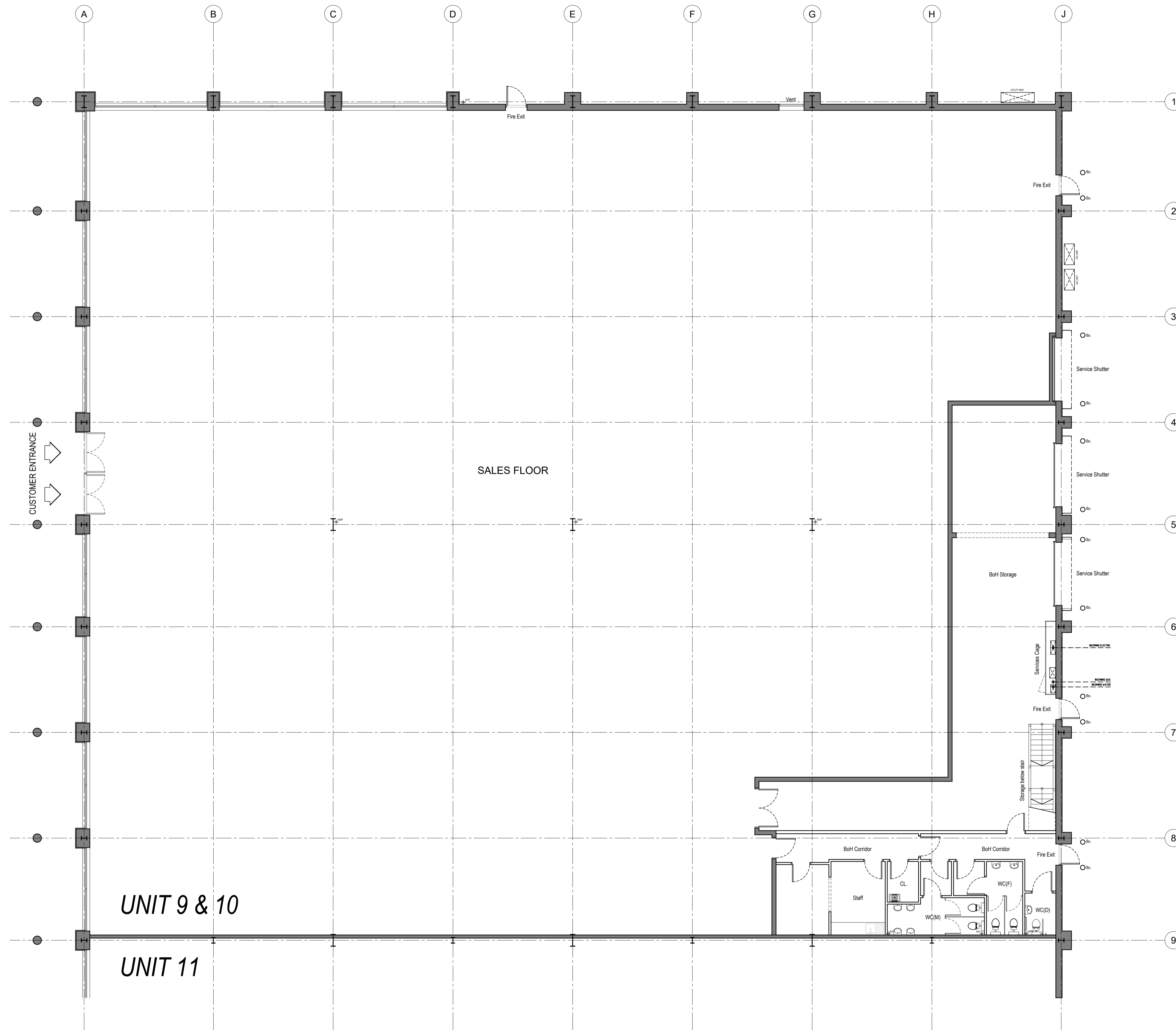

01 GROUND FLOOR AS EXISTING
1:100

