

Chevin

Geoenviro Associates LTD

Land At:

Old Biggin Farm, Cold Hill Lane, New Mill, Holmfirth

Coal Mining Risk Assessment

January 2022

77 High Street, Yeadon, LS19 7SP

Tel: 01943 470363

Email: info@chevin-ltd.co.uk

Land At: Old Biggin Farm, Cold Hill Lane, New Mill, Holmfirth

Coal Mining Risk Assessment

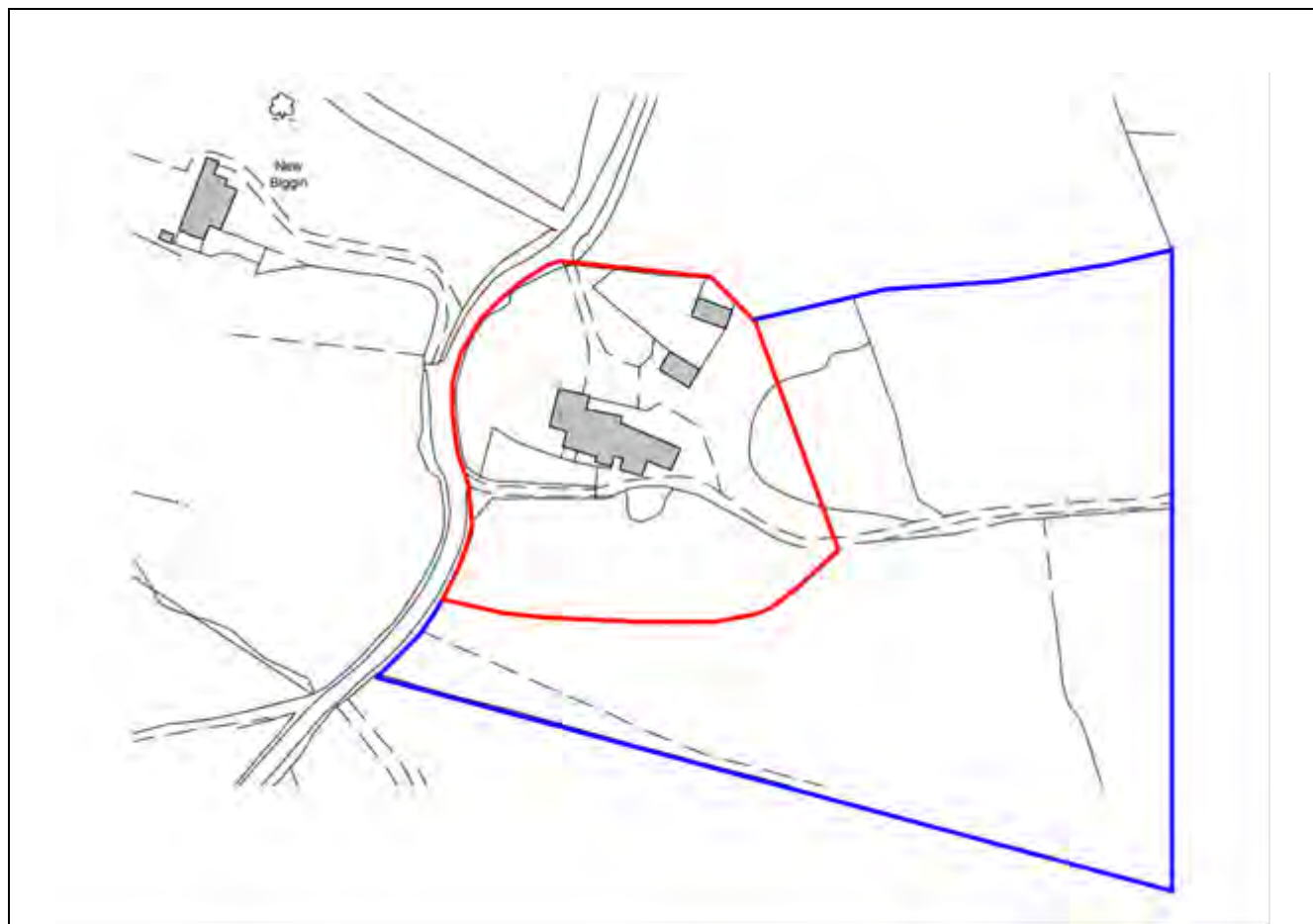

The red outline corresponds to the proposed development area.

Report Title	Land At: Old Biggin Farm, Cold Hill Lane, New Mill, Holmfirth Coal Mining Risk Assessment	Site Address	Old Biggin Farm Cold Hill Lane, New Mill, Holmfirth HD9 7DN (Grid Ref: 416580,409740)
Author	Chevin Geoenviro Associates Ltd.	Report Type	Coal Mining Risk Assessment
Work Stage	Stage 1	Report Date	January 2022
Brief Description of the Report Contents	Review of information to develop an assessment of potential legacy coal mining issues.		

Land At: Old Biggin Farm, Cold Hill Lane, New Mill, Holmfirth
Coal Mining Risk Assessment

Document Control

Client: Mr Glenn Paxman

Job Number: C0501

Document Checking:

Prepared by:	Christopher Evans BSc MSc CGeol FGS
Checked:	David Wilkinson / Christiaan Wilkinson
Issued by:	Christiaan Wilkinson BSc MRes CSci FGS SiLC

Issue	Date	Status	Year
01	17 th January	Final	2022
02	18 th January	Final	2022

Land At: Old Biggin Farm, Cold Hill Lane, New Mill, Holmfirth

Coal Mining Risk Assessment

Contents Page

1.0	INTRODUCTION	2
1.1	Terms and Conditions	2
1.2	Source of Information	2
2.0	SITE DETAILS	3
2.1	Introduction.....	3
2.2	Proposed Development	3
3.0	GEOLOGY	3
3.1	Superficial Geology.....	3
3.2	Solid Geology	3
4.0	COAL MINING	6
4.1	Coal Authority CON29M Report & Interactive Mapping	6
4.2	Review of Online Historical Mapping	8
5.0	RISK ASSESSMENT & CONCLUSIONS	8
6.0	RECOMMENDATIONS	9

Land At: Old Biggin Farm, Cold Hill Lane, New Mill, Holmfirth
Coal Mining Risk Assessment

APPENDIX CONTENTS

Appendix A

Figures and Drawings

Drawing No. C0501-01

Site Location Plan

Drawing No. C0501-02

Proposed Development Layout

Appendix B

Coal Authority Consultants Coal Mining Report

1.0 INTRODUCTION

Chevin Geoenviron Associates Ltd (CGA), were commissioned by Mr & Mrs Paxman to carry out a Coal Mining Risk Assessment for land at Old Biggin Farm, Cold Hill Lane, New Mill, Holmfirth, HD9 7DN.

The purpose of this report is to review and interpret available information pertaining to the site and present the conclusions within a Coal Mining Risk Assessment, as required by the planning regime. The scope of the study is as follows:

- To provide general information on the site such as location and proposals;
- Review available geological maps & memoirs;
- Review appropriate information provided by the Coal Authority;
- Estimate the level of risk based on the information reviewed;
- To provide recommendations for further works where necessary.

1.1 Terms and Conditions

This report has been prepared for Mr & Mrs Paxman, in support of a planning application which relates to later construction of residential properties on the site of an existing farm house with agricultural buildings. The information in this report has been summarised following a review of readily available information and should not be used in a different context without reference to the original author. A Phase 1 desk study for the site was not available or required as part of this study.

1.2 Source of Information

The following sources of information have been reviewed as part of this assessment.

- Coal Authority Consultants Coal Mining Report dated 11th January 2022; (Ref: 51002894045001)
- BGS Solid and Superficial Geology Mapping Sheets No.86, 1,50,000, Glossop, dated 2012;
- British Geological Survey, Geoindex interactive web site. (Viewed 13th January 2022);
- Coal Authority Interactive web site. (Viewed 13th January 2022).
- Historical Maps: <https://maps.nls.uk/view/102345091> (Viewed 13th January 2022).
- Sections of Strata of The Coal Measures of Yorkshire, Midland Institute of Mining Engineers (1950)

2.0 SITE DETAILS

2.1 Introduction

The site is located to the south west of Cold Hill Lane, New Mill, Holmfirth, approximately 2.8km north east of Holmfirth town centre. The site is an irregular square formed by a number of boundary lines and is approximately 0.87ha in area and centred on National Grid Reference: 416580,409740.

A Site Location Plan is presented as Drawing No. C0501-01 in Appendix A.

2.2 Proposed Development

It is proposed to demolish the existing dwelling (422m²) and replace with a new dwelling measuring 320m².

3.0 GEOLOGY

3.1 Superficial Geology

BGS mapping indicates the site and its immediate surroundings are free of superficial deposits.

3.2 Solid Geology

BGS Sheet No.86 Glossop (1:50,000) and interactive mapping shows the bedrock underlying the site to be the Pennine Lower Coal Measures Formation, comprising interbedded mudstone, siltstone, sandstone and coal seams.

The site is within a geological block situated between two faults that generally trend east to west and join beyond 250m east of site. Mapping from the Coal Authority shows that the faults run approximately 15m to 25m inside the north site boundary and just inside the south site boundary.

The strata below the site are shown to include undifferentiated mudstone (site west) and the Stanningley Rock Sandstone (site east). Where present, the Stanningley Rock is recorded to be up to 16.0m in thickness and is locally covered by the 36 Yard Coal that may be up to 0.60m in thickness.

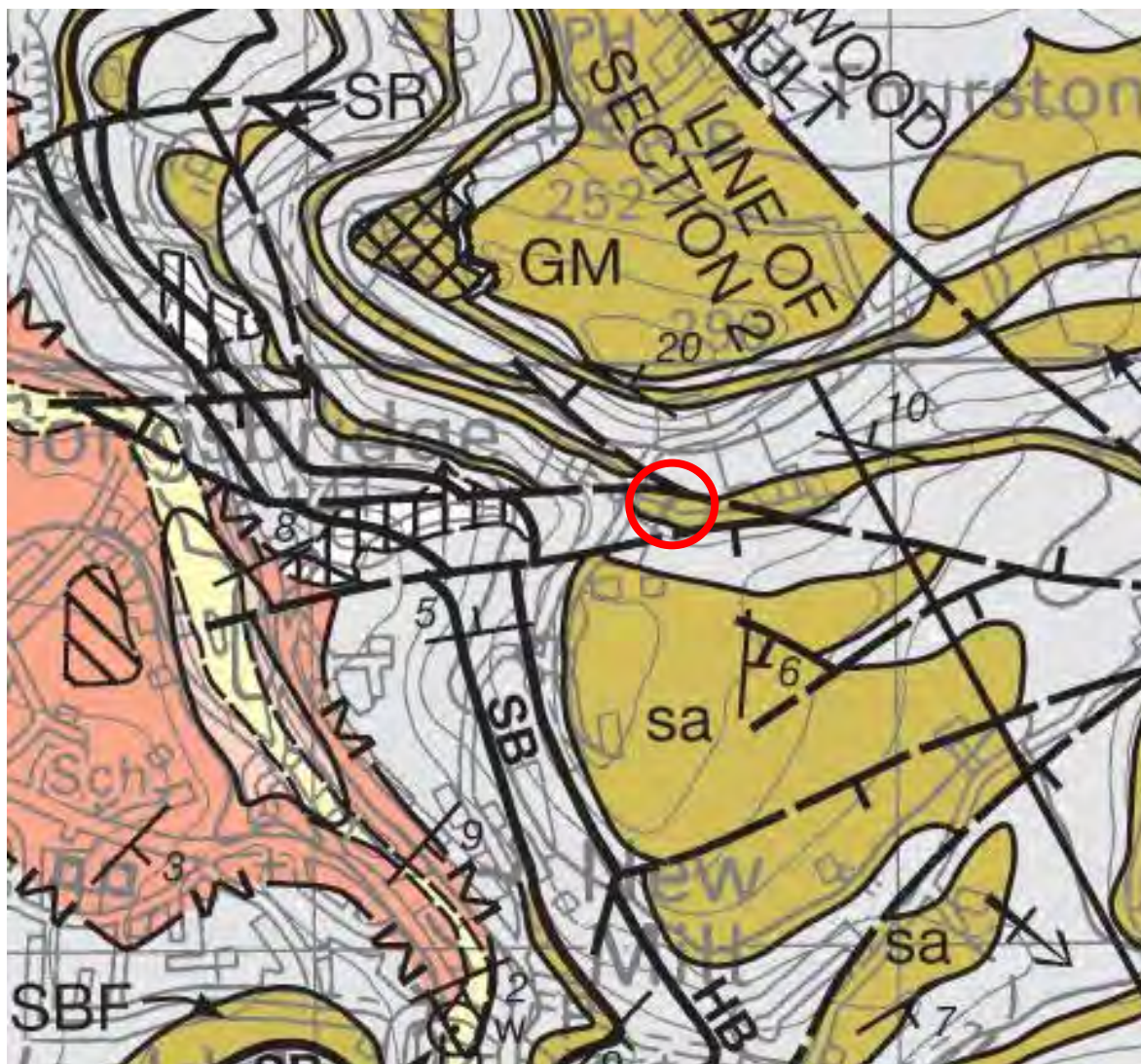

Extract from BGS Sheet No.86 Glossop 1:50,000 (2012). The red circle shows the approximate area of the site location. Coal seam names vary in different references and these have been cross referenced with; Sections of Strata of The Coal Measures of Yorkshire, by the Midland Institute of Mining Engineers (1950).

Mudstones below the Stanningley Rock are interpreted to be of significant thickness (>20m) over the Halifax, Hard Bed or (Ganister Coal) that may be up to 1.0m in thickness. This coal is mapped to outcrop west of the site and is also recorded by the Coal Authority Report to outcrop north east and north west of the site boundary.

The Halifax, Soft Coal or (Coking Coal), is lower in the geological succession. This is recorded by the Coal Authority as worked at 59m to 64m depth below the study site and also looks to be outcropping west of the site beyond the Halifax, Hard Bed.

Land At: Old Biggin Farm, Cold Hill Lane, New Mill, Holmfirth

Coal Mining Risk Assessment

The referenced geological records also show the Halifax, Soft Coal to be locally overlain by the Middle Band or (Clay Coal) that is potentially up to 0.6m in thickness. This could also be at shallow depth below the site.

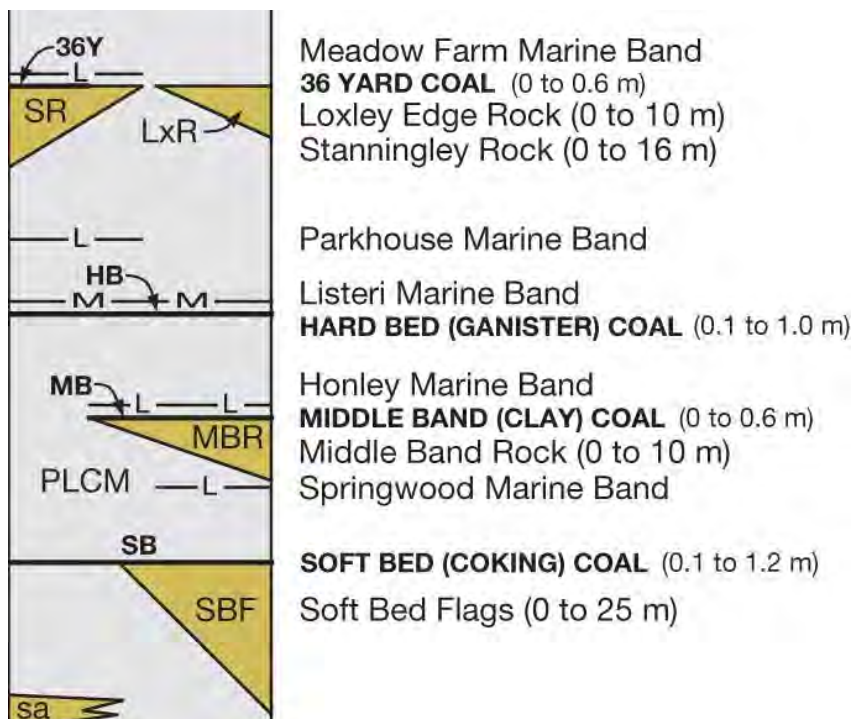

Extract from BGS Sheet No.86 Glossop 1:50,000 (2012). Presenting the likely geological succession under the study site.

The nearest deep borehole records are beyond faulting that surrounds the site. As such they are unlikely to be within the same geological sequence, or representative of the geology below the study site.

4.0 COAL MINING

4.1 Coal Authority CON29M Report & Interactive Mapping

The Coal Authority Interactive map shows the site to be within an Area of Probable Shallow Coal Mine Workings, a Surface Coal Resources Area and a Development High Risk Area. The viewer also shows known areas of former shallow coal mining beyond the north and south site boundaries.

A Coal Authority Mining Report was obtained for the proposed area of development. This considers that the site is in a surface area that could be affected by underground mining in two seams of coal at 58m to 64m depth and last worked in 1889. In addition the report also considers there are probable unrecorded shallow workings.

One record of a mine entry (Ref: 416409-002), is located beyond 20m north east of the defined study site. The entry is recorded to be an adit by the interactive viewer, which also shows it to have a bearing of 85 degrees, suggesting that it runs away from the proposed area of development. A vertical shaft is also shown beyond the south east of the site (Ref:416409-003), and a second adit (Ref:416409-012) to the south west on a bearing of 74 degrees. These features are not considered to affect the proposals, however unrecorded mining features could be present.

Two outcrops of the Halifax, Hard Bed Coal are located beyond faulting to the north east and north west of the site. These are recorded by the Coal Authority report to be at 84.5m distant on a bearing of 67 degrees and 51.2m distant on a bearing of 113 degrees respectively.

Extraction within the closer north west outcrop is considered near enough to be listed by the Coal Authority as potentially of influence to the study site. This is derived from the usual angle of draw (35°), or workings where the enquiry boundary is within 0.7 times the depth of the workings and is increased to allow for seam inclination.

A summary of the information provided within the Coal Authority Mining Report and interactive map is presented below within Table 1.1.

Land At: Old Biggin Farm, Cold Hill Lane, New Mill, Holmfirth

Coal Mining Risk Assessment

Table 1.1 Summary of Coal Authority Report Information

Mining Activities	On Site	Further Information
Section 1: Mining Activity and Geology		
Past Underground Mining	Yes	Mining recorded beneath or local to the property in two seams at depths of 58m to 64m and last worked in 1889.
Probable Unrecorded Shallow Workings	Yes	The Coal Authority consider that not all workings may have been recorded and will require this potential to be discounted by an intrusive investigation, most especially where the site is recorded within a Development High Risk Area.
Spine Roadways at Shallow Depth	No	No spine roadway recorded at shallow depth.
Future Underground Mining	No	None recorded. No coal mining licencing within 200m
Mine Entries	No	None measured within, or within 20m of the boundary of the property.
Coal Mining Geology	Yes	Faulting below the study site mapped by Coal Authority records.
Opencast Mines	No	None recorded within 500 metres of the enquiry boundary.
Coal Authority Managed Tips	No	None recorded within 500 metres of the enquiry boundary.
Site investigations	No	None recorded within 50 metres of the enquiry boundary.
Remediated Sites	No	None recorded within 50 metres of the enquiry boundary.
Coal Mining Subsidence	No	<p>The Coal Authority has not received a damage notice or claim for the subject property, or any property within 50 metres of the enquiry boundary, since 31 October 1994.</p> <p>There is no current Stop Notice delaying the start of remedial works or repairs to the property.</p> <p>The Coal Authority is not aware of any request having been made to carry out preventive works before coal is worked under section 33 of the Coal Mining Subsidence Act 1991.</p>
Mine Gas	No	None recorded.
Mine Water Treatment Schemes	No	None recorded within 500 metres of the enquiry boundary.
Section 48 Notices	No	No notices have been given, under section 46 of the Coal Mining Subsidence Act 1991, stating that the land is at risk of subsidence.
Withdrawal of Support Notices	No	The property is not in an area where a notice to withdraw support has been given. The property is not in an area where a notice has been given under section 41 of the Coal Industry Act 1994, cancelling the entitlement to withdraw support.
Payments to owners of Former Copyholder Land	No	The property is not in an area where a relevant notice has been published under the Coal Industry Act 1975 / 1994.

4.2 Review of Online Historical Mapping

1854: Site area formed by two buildings connected by tracks. Then as now Hill Top Bank is to the west of the site with a roadway curving sharply east around the site. The curved section is later named Cold Hill Lane. Plantation "Biggin Shrogg" is shown east of the site. Areas south east and south west of the site are named "Coal Pit" and Hill Top Sandstone Quarry is beyond 120m south.

1894: Quarry and coal pits no longer shown.

1907: North boundary of site marked "Old Coal Shaft".

1933: Three or four building in location of current farm.

1950 and 2022: No significant changes.

5.0 RISK ASSESSMENT & CONCLUSIONS

BGS, historical and Coal Authority mapping indicate that the site is in a coal mining area. The site is recorded to be within a Development High Risk Area, with known shallow coal workings in one seam below the site, potential influence from at least one extracted coal seam local to the site and also potentially from unrecorded workings in seams at shallower depths than those recorded.

Productive Coal up to 1.06m in thickness has been encountered in the Halifax, Soft coal seam that is interpreted below the site and productive thicknesses of coal may also be present in shallower seams including the Middle Band Coal (0.60m thickness) or the Halifax Hard Coal (1.0m thickness).

Before any ground improvement such as grouting can be discounted, any resulting mine voids or broken ground will require to be interpreted with respect to their rock cover and extraction thicknesses. This will require rotary drilling at the site. There is also considered to be a low potential for unrecorded mine entries on the site.

Due to the unknown depth and thickness of near surface mining and the thickness of competent rock cover over potential shallow workings on the site, a **Medium to High Risk** of surface instability from past mining has been estimated.

6.0 RECOMMENDATIONS

It is recommended that a minimum of three rotary open-hole boreholes be formed close to the proposed building, in order to further investigate the presence of coal and/or workings beneath. At least one borehole location should progress to a target depth of 30m bgl. This should interpret the thicknesses of any near surface coals and/or potential mine workings. Where a significant intact coal seam is found in isolation, it cannot be considered representative of an unworked coal seam and must be followed by further investigation. For example, where additional boreholes are required, these should be located at the opposite end of the structure to the initial boreholes. This need only progress to depths below any coal, broken ground or extractions encountered by the first location.

With regards to assessing risk of void migration, CIRIA 32 (Construction over abandoned mine workings, 1989), continues to be the go to guide in these situations and has recently been enhanced by CIRIA 758 (Abandoned Mine Workings) 2019.

These documents suggest a thickness of solid rock through which a void can migrate is 7h to 10h above the roof of the workings, where h is the height of the workings (generally assumed to be similar to the seam thickness). The lower end of this range (7h) is generally only applicable where the overlying strata are predominantly thickly bedded sandstones, otherwise the 10h rule is likely to be adopted.

Boreholes will ideally be in triangulation and continued to depths at which they bypass any layers of coal or evidence of shallow workings identified by the first locations. In the unlikely event that multiple coal seams have been worked, it may be necessary to take these initial boreholes to still greater depths and to consider the cumulative effect of several voids.

The distance of this investigation to neighbouring occupied properties, may require that rock drilling is undertaken by use of a water flush method and this should be accompanied by a licence from the Coal Authority.

Land At: Old Biggin Farm, Cold Hill Lane, New Mill, Holmfirth
Coal Mining Risk Assessment

Appendices

Land At: Old Biggin Farm, Cold Hill Lane, New Mill, Holmfirth
Coal Mining Risk Assessment

Figures and Drawings

Appendix A – Site Location Plan

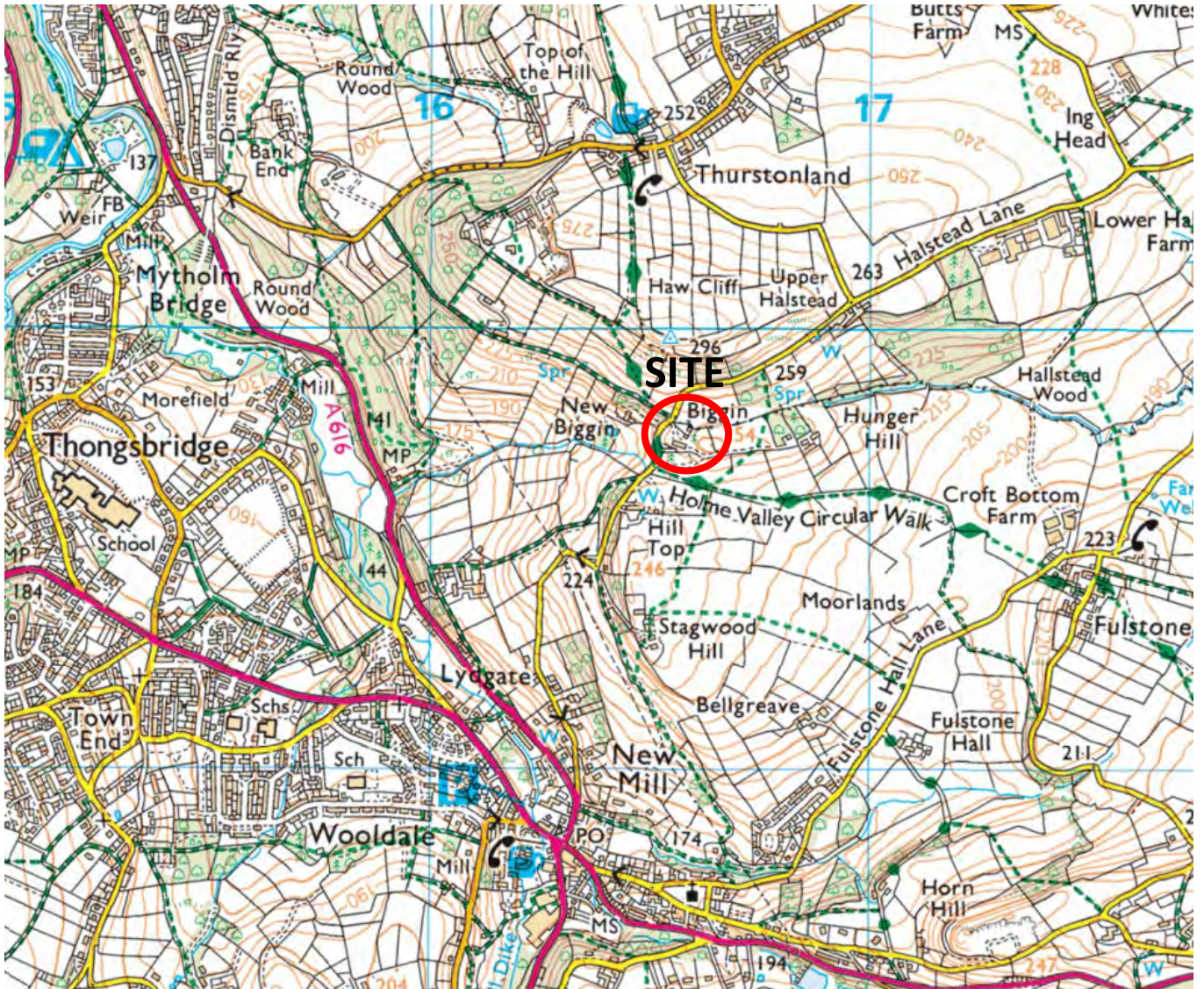

Chevin Geoenviron Associates LTD Tel: 01943 470363 E-mail info@chevin-ltd.co.uk Geo-environmental Consultancy Ground Technologies & Investigation & Remediation	Project: Old Biggin Farm, Cold Hill Lane, New Mill, Holmfirth	
	Client: Mr Glenn Paxman	Project No. C0501
		Date 17/01/2022

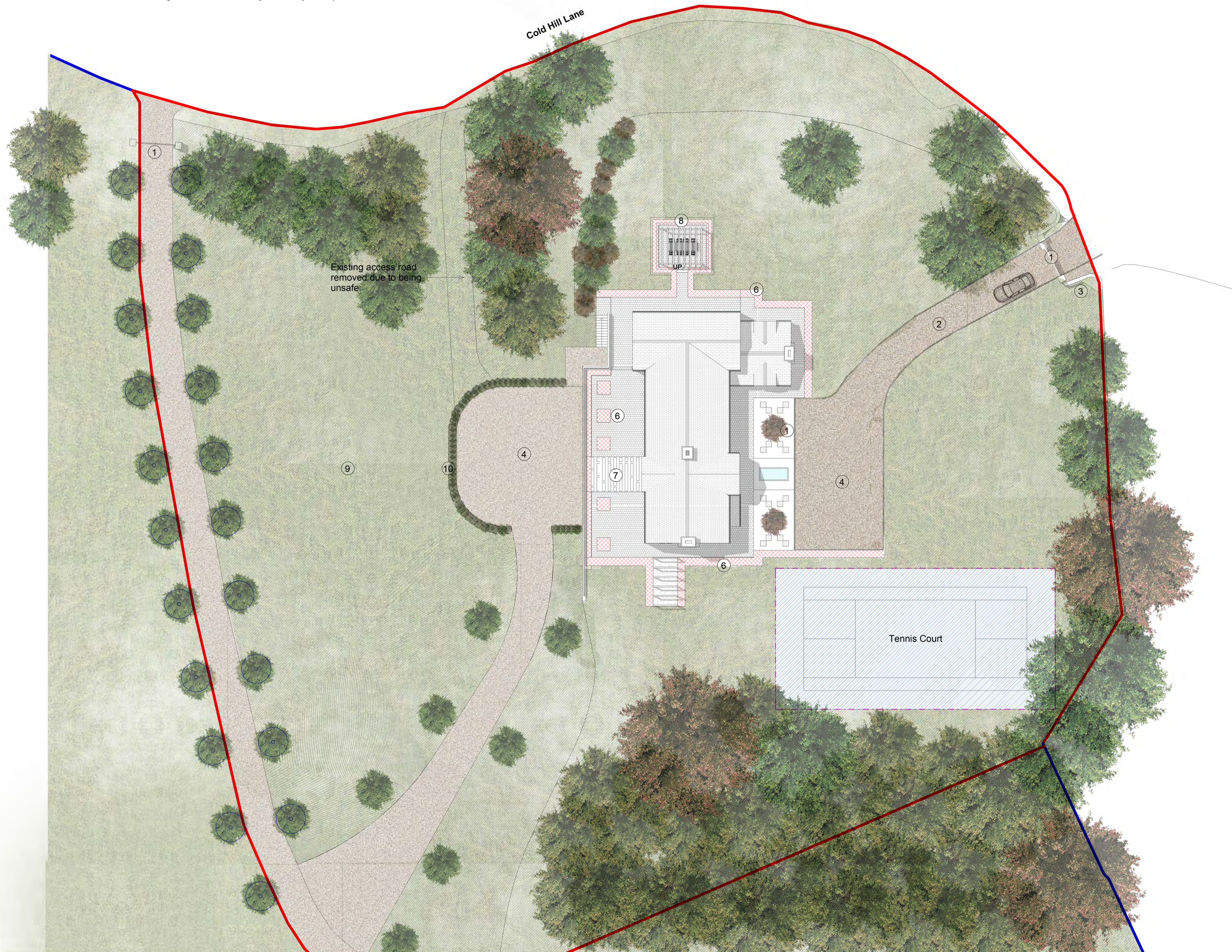

Landscaping Legend

- Balsalt Gravel Chippings 20mm
- 600mm x 900mm Natural Yorkstone flags
- Ornamental Planting
- Amenity Grass
- Permeable Tennis Court Surface
- 250mm x 150mm Natural Stone Sets
- Site Boundary
- Hedge Planting
- Existing Tree Demolished
- Proposed Tree
- 2.4m PPC Weldmesh Fencing - Black

- Notes:**
1. **Gates** - The site is accessed from the highway via a vehicular and pedestrian gate, leading to a short gravel driveway and natural stone footpath.
 2. **Driveway** - The gravel driveway will be constructed of a permeable build up, encouraging free draining of surface water. Views lead to the main entrance to the property, partially obscured by vegetation of varying heights.
 3. **Bin Storage** - A stone constructed bin store for discreet and easily accessible storage.
 4. **Parking** - The gravel driveway offers ample space for parking and manoeuvring.
 5. **Entrance Planting** - The main entrance is surrounded by lush, naturalised planting that provides year-round interest.
 6. **Planting** - The rich ornamental planting takes cues from the surrounding proposed naturalised planting. The planting also allows some level of privacy to the rooms on the ground floor from the garden, softly screening views with dappled planting.
 7. **Main Terrace & Garden Access** - A generous natural stone & gravel terrace area for socialising and lounging, broken up by lush naturalised planting that provides year-round interest. The Terrace provides access to the garden from the various access points at ground floor, with borders of rich ornamental planting.
 8. **Dining Terrace** - A natural stone terrace area for dining will provide a sense of privacy being surrounded by planting, whilst offering framed views across the valley to the west. A small timber pergola frames the terrace whilst providing a framework for climbing planting.
 9. **Grassland** - A simple grass mix will allude to a lawn area while being more species rich than usual and requiring less maintenance.
 10. **Hedge Screening** - The parking area in front of the garages is surrounded by lush, naturalised hedge planting that provides year-round screening of the basement storey when viewed from the footpath below.

Contractor must verify all dimensions on site before commencing any work or shop drawings. If this drawing exceeds the quantities taken in any way the Architects are to be informed before the work is initiated. Only figured dimensions to be taken from this drawing. Do not scale off this drawing. Drawings based on Ordnance Survey and / or existing record drawings - design and drawing content subject to Site Survey, Structural Survey, Site Investigations, Planning and Statutory Requirements and Approvals. Authorised reproduction from Ordnance Survey Map with permission of the Controller of Her Majesty's Stationery Office. Crown Copyright reserved. OneFourOne Architects Ltd.

Notes:

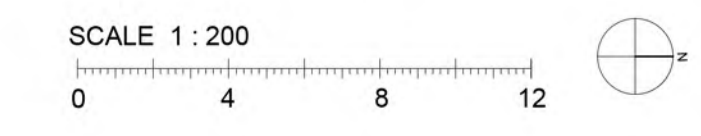

Date created	11/09/18	Client Name	Mr & Mrs Paxman
Approved by:	-	Project	Old Biggin Farm
Project number:	2019.00107.000		
Drawn by:	MS	Title:	Proposed Site Plan
Scale:	As indicated	Drawing number	OBF-IVI-XX-ZZ-DR-A-90-002
Status:	PL	Revision:	P02

P02	Planning Submission	04.01.2022	MCS	-
P01	Drawing Issued For Pre-application Advice	04.06.2021	MCS	-
Rev	Description	Date	Dr by	App by

ONEFOURONE ARCHITECTS

5 Beech Court
 Family Tyas
 Huddersfield
 HD4 6AX
 United Kingdom

T +447730 691282
 E info@onefourone-arch.co.uk
 www.onefourone-arch.co.uk

Land At: Old Biggin Farm, Cold Hill Lane, New Mill, Holmfirth
Coal Mining Risk Assessment

Appendix B - Coal Authority Consultants Coal Mining Report



The Coal
Authority

Consultants Coal Mining Report

Old Biggin Farm
Cold Hill Lane
New Mill
Holmfirth
Kirklees
HD9 7DN

Date of enquiry: 11 January 2022
Date enquiry received: 11 January 2022
Issue date: 11 January 2022

Our reference: 51002894045001
Your reference: C0501

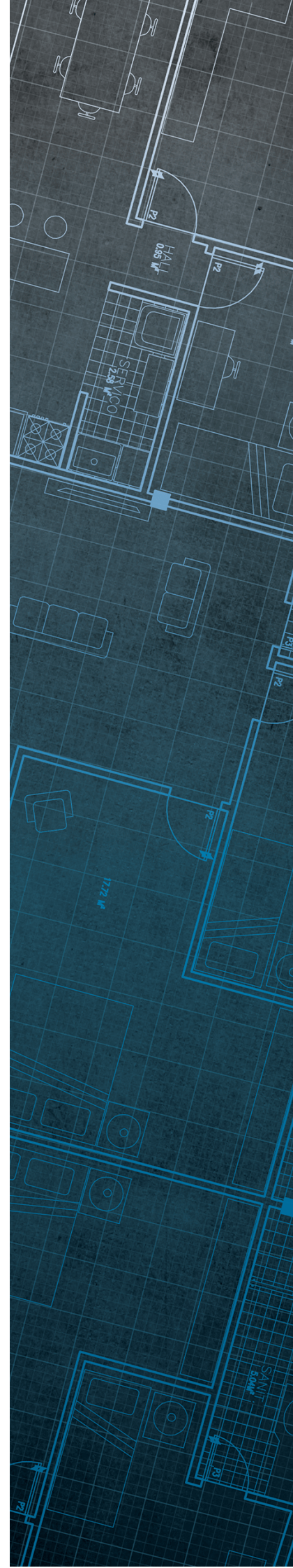

Consultants

Coal Mining Report

This report is based on and limited to the records held by the Coal Authority at the time the report was produced.

Client name

Christiaan Wilkinson

Enquiry address

Old Biggin Farm
Cold Hill Lane
New Mill
Holmfirth
Kirklees
HD9 7DN

How to contact us

0345 762 6848 (UK)
+44 (0)1623 637 000 (International)

200 Lichfield Lane
Mansfield
Nottinghamshire
NG18 4RG

www.groundstability.com

 @coalauthority

 /company/the-coal-authority

 /thecoalauthority

 /thecoalauthority



Approximate position of property



Reproduced by permission of Ordnance Survey on behalf of HMSO. © Crown copyright and database right 2018. All rights reserved.

Ordnance Survey Licence number: 100020315

Section 1 – Mining activity and geology

Past underground mining

Colliery	Seam	Mineral	Coal Authority reference	Depth (m)	Direction to working	Dipping rate of seam worked (degrees)	Dipped direction of seam worked	Extraction thickness (cm)	Year last mined
unnamed	HALIFAX HARD	Coal	6ZGK	58	North-West	8.1	North	51	1889
unnamed	HALIFAX SOFT	Coal	6ZGT	59	Beneath Property	1.6	North	106	1889
unnamed	HALIFAX SOFT	Coal	6ZG9	64	Beneath Property	5.7	North	106	1856

Probable unrecorded shallow workings

Yes.

Spine roadways at shallow depth

No spine roadway recorded at shallow depth.

Mine entries

Entry type	Reference	Grid reference	Treatment description	Mineral	Conveyancing details
Shaft	416409-002	416635 409773		Coal	

Abandoned mine plan catalogue numbers

The following abandoned mine plan catalogue numbers intersect with some, or all, of the enquiry boundary:

2357	419	10628
PO0	M185	

Please contact us on 0345 762 6848 to determine the exact abandoned mine plans you require based on your needs.

Outcrops

Seam name	Mineral	Seam workable	Distance to outcrop (m)	Direction to outcrop	Bearing of outcrop
HARD BED BAND	Coal	Yes	84.5	East	67
HARD BED BAND	Coal	Yes	51.2	West	113

Geological faults, fissures and breaklines

Please refer to the 'Summary of findings' map (on separate sheet) for details of any geological faults, fissures or breaklines either within or intersecting the enquiry boundary.

Faults under or close to the property recorded.

Opencast mines

None recorded within 500 metres of the enquiry boundary.

Coal Authority managed tips

None recorded within 500 metres of the enquiry boundary.

Section 2 – Investigative or remedial activity

Please refer to the 'Summary of findings' map (on separate sheet) for details of any activity within the area of the site boundary.

Site investigations

None recorded within 50 metres of the enquiry boundary.

Remediated sites

None recorded within 50 metres of the enquiry boundary.

Coal mining subsidence

The Coal Authority has not received a damage notice or claim for the subject property, or any property within 50 metres of the enquiry boundary, since 31 October 1994.

There is no current Stop Notice delaying the start of remedial works or repairs to the property.

The Coal Authority is not aware of any request having been made to carry out preventive works before coal is worked under section 33 of the Coal Mining Subsidence Act 1991.

Mine gas

None recorded within 500 metres of the enquiry boundary.

Mine water treatment schemes

None recorded within 500 metres of the enquiry boundary.

Section 3 – Licensing and future mining activity

Future underground mining

None recorded.

Coal mining licensing

None recorded within 200 metres of the enquiry boundary.

Court orders

None recorded.

Section 46 notices

No notices have been given, under section 46 of the Coal Mining Subsidence Act 1991, stating that the land is at risk of subsidence.

Withdrawal of support notices

The property is not in an area where a notice to withdraw support has been given.

The property is not in an area where a notice has been given under section 41 of the Coal Industry Act 1994, cancelling the entitlement to withdraw support.

Payments to owners of former copyhold land

The property is not in an area where a relevant notice has been published under the Coal Industry Act 1975/Coal Industry Act 1994.

Section 4 – Further information

The following potential risks have been identified and as part of your risk assessment should be investigated further.

Development advice

The site is within an area of historical coal mining activity. Should you require advice and/or support on understanding the mining legacy, its risks to your development or what next steps you need to take, please contact us.

For further information on specific site or ground investigations in relation to any issues raised in Section 4, please call us on 0345 762 6848 or email us at groundstability@coal.gov.uk.

Section 5 – Data definitions

The datasets used in this report have limitations and assumptions within their results. For more guidance on the data and the results specific to the enquiry boundary, please **call us on 0345 762 6848** or **email us at groundstability@coal.gov.uk**.

Past underground coal mining

Details of all recorded underground mining relative to the enquiry boundary. Only past underground workings where the enquiry boundary is within 0.7 times the depth of the workings (zone of likely physical influence) allowing for seam inclination, will be included.

Probable unrecorded shallow workings

Areas where the Coal Authority believes there to be unrecorded coal workings that exist at or close to the surface (less than 30 metres deep).

Spine roadways at shallow depth

Connecting roadways either, working to working, or, surface to working, both in-seam and cross measures that exist at or close to the surface (less than 30 metres deep), either within or within 10 metres of the enquiry boundary.

Mine entries

Details of any shaft or adit either within, or within 100 metres of the enquiry boundary including approximate location, brief treatment details where known, the mineral worked from the mine entry and conveyance details where the mine entry has previously been sold by the Authority or its predecessors British Coal or the National Coal Board.

Abandoned mine plan catalogue numbers

Plan numbers extracted from the abandoned mines catalogue containing details of coal and other mineral abandonment plans deposited via the Mines Inspectorate in accordance with the Coal Mines Regulation Act and Metalliferous Mines Regulation Act 1872. A maximum of 9 plan extents that intersect with the enquiry boundary will be included. This does not infer that the workings and/or mine entries shown on the abandonment plan will be relevant to the site/property boundary.

Outcrops

Details of seam outcrops will be included where the enquiry boundary intersects with a conjectured or actual seam outcrop location (derived by either the British Geological Survey or the Coal Authority) or intersects with a defined 50 metres buffer on the coal (dip) side of the outcrop. An indication of whether the Coal Authority believes the seam to be of sufficient thickness and/or quality to have been worked will also be included.

Geological faults, fissures and breaklines

Geological disturbances or fractures in the bedrock. Surface fault lines (British Geological Survey derived data) and fissures and breaklines (Coal Authority derived data) intersecting with the enquiry boundary will be included. In some circumstances faults, fissures or breaklines have been known to contribute to surface subsidence damage as a consequence of underground coal mining.

Opencast mines

Opencast coal sites from which coal has been removed in the past by opencast (surface) methods and where the enquiry boundary is within 500 metres of either the licence area, site boundary, excavation area (high wall) or coaling area.

Coal Authority managed tips

Locations of disused colliery tip sites owned and managed by the Coal Authority, located within 500 metres of the enquiry boundary.

Site investigations

Details of site investigations within 50 metres of the enquiry boundary where the Coal Authority has received information relating to coal mining risk investigation and/or remediation by third parties.

Remediated sites

Sites where the Coal Authority has undertaken remedial works either within or within 50 metres of the enquiry boundary following report of a hazard relating to coal mining under the Coal Authority's Emergency Surface Hazard Call Out procedures.

Coal mining subsidence

Details of alleged coal mining subsidence claims made since 31 October 1994 either within or within 50 metres of the enquiry boundary. Where the claim relates to the enquiry boundary confirmation of whether the claim was accepted, rejected or whether liability is still being determined will be given. Where the claim has been discharged, whether this was by repair, payment of compensation or a combination of both, the value of the claim, where known, will also be given.

Details of any current 'Stop Notice' deferring remedial works or repairs affecting the property/site, and if so the date of the notice.

Details of any request made to execute preventative works before coal is worked under section 33 of the Coal Mining Subsidence Act 1991. If yes, whether any person withheld consent or failed to comply with any request to execute preventative works.

Mine gas

Reports of alleged mine gas emissions received by the Coal Authority, either within or within 500 metres of the enquiry boundary that subsequently required investigation and action by the Coal Authority to mitigate the effects of the mine gas emission.

Mine water treatment schemes

Locations where the Coal Authority has constructed or operates assets that remove pollutants from mine water prior to the treated mine water being discharged into the receiving water body.

These schemes are part of the UK's strategy to meet the requirements of the Water Framework Directive. Schemes fall into 2 basic categories: Remedial – mitigating the impact of existing pollution or Preventative – preventing a future pollution incident.

Mine water treatment schemes generally consist of one or more primary settlement lagoons and one or more reed beds for secondary treatment. A small number are more specialised process treatment plants.

Future underground mining

Details of all planned underground mining relative to the enquiry boundary. Only those future workings where the enquiry boundary is within 0.7 times the depth of the workings (zone of likely physical influence) allowing for seam inclination will be included.

Coal mining licensing

Details of all licenses issued by the Coal Authority either within or within 200 metres of the enquiry boundary in relation to the under taking of surface coal mining, underground coal mining or underground coal gasification.

Court orders

Orders in respect of the working of coal under the Mines (Working Facilities and Support) Acts of 1923 and 1966 or any statutory modification or amendment thereof.

Section 46 notices

Notice of proposals relating to underground coal mining operations that have been given under section 46 of the Coal Mining Subsidence Act 1991.

Withdrawal of support notices

Published notices of entitlement to withdraw support and the date of the notice. Details of any revocation notice withdrawing the entitlement to withdraw support given under Section 41 of the Coal Industry Act 1994.

Payment to owners of former copyhold land

Relevant notices which may affect the property and any subsequent notice of retained interests in coal and coal mines, acceptance or rejection notices and whether any compensation has been paid to a claimant.

