

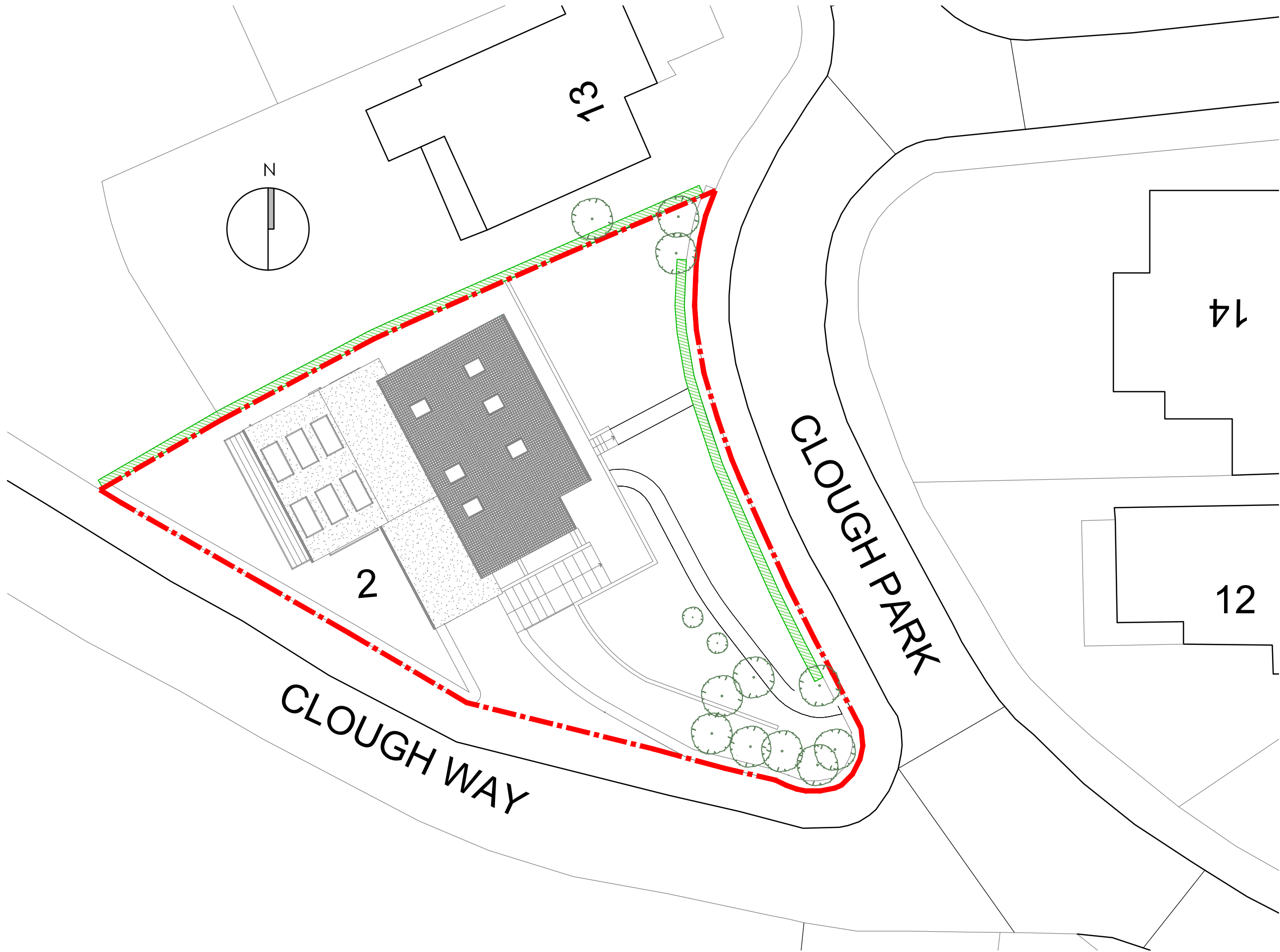

This drawing is copyright of JKT Architecture, and shall not be reproduced nor used for any other purpose without the written permission of the Architects. This drawing must be read in conjunction with all other related drawings and documentation. It is the contractors responsibility to ensure full compliance with the Building Regulations. Do not scale from this drawing, use figured dimensions only. It is the contractors responsibility to check and verify all dimensions on site. Any discrepancies to be reported immediately. IF IN DOUBT ASK.  
Materials not in conformity with relevant British or European Standards/Codes of practice or materials known to be deleterious to health & safety must not be used or specified on this project.

| Date: | Rev: | Description: | By: | Chkd: |
|-------|------|--------------|-----|-------|
| 00.24 | -    | -            | JKT | JKT   |



Site Plan Key:

-  Existing Boundary
-  Existing Trees (Plotted Indicatively)



Project Title:  
2 Clough Way, Fenay Bridge,  
Huddersfield HD8 0JL

| Client:        | Drawn by: | Checked by: |
|----------------|-----------|-------------|
| Matt & Natasha | JKT.      | JKT.        |

| Drawing Title:     | Scale: | Paper Size: |
|--------------------|--------|-------------|
| Existing Site Plan | 1:200  | A3          |

| Drawing Number: | Revision: | Date: |
|-----------------|-----------|-------|
| 21.06 - 302     | -         | 08.25 |

Drawing Status:  
Planning

Existing Site Plan  
Scale 1:200

