

**Surface Demarcation**

- Proposed EV bay
- 1** Standard bay
- 2** Accessible bay
- 3** Motorcycle bay
- 4** Painted pedestrian crossing
- 5** Road
- 6** Painted pedestrian walkway

**Colour Demarcation**

- Final colours to be agreed with WYP
- RAL 3013 Tomato Red to EV / operation markings, EV floor signage
  - RAL 7043 Traffic Grey to all parking bays
  - RAL 7042 Light Grey to all road and pedestrian footpath surfaces
  - White to road markings and parking bays

All signage requirements and markings to be agreed and finalised with WYP

1 Road Markings Plan\_CP Deck 2.5\_3.0  
1:100

**MSCP Internal Signage**

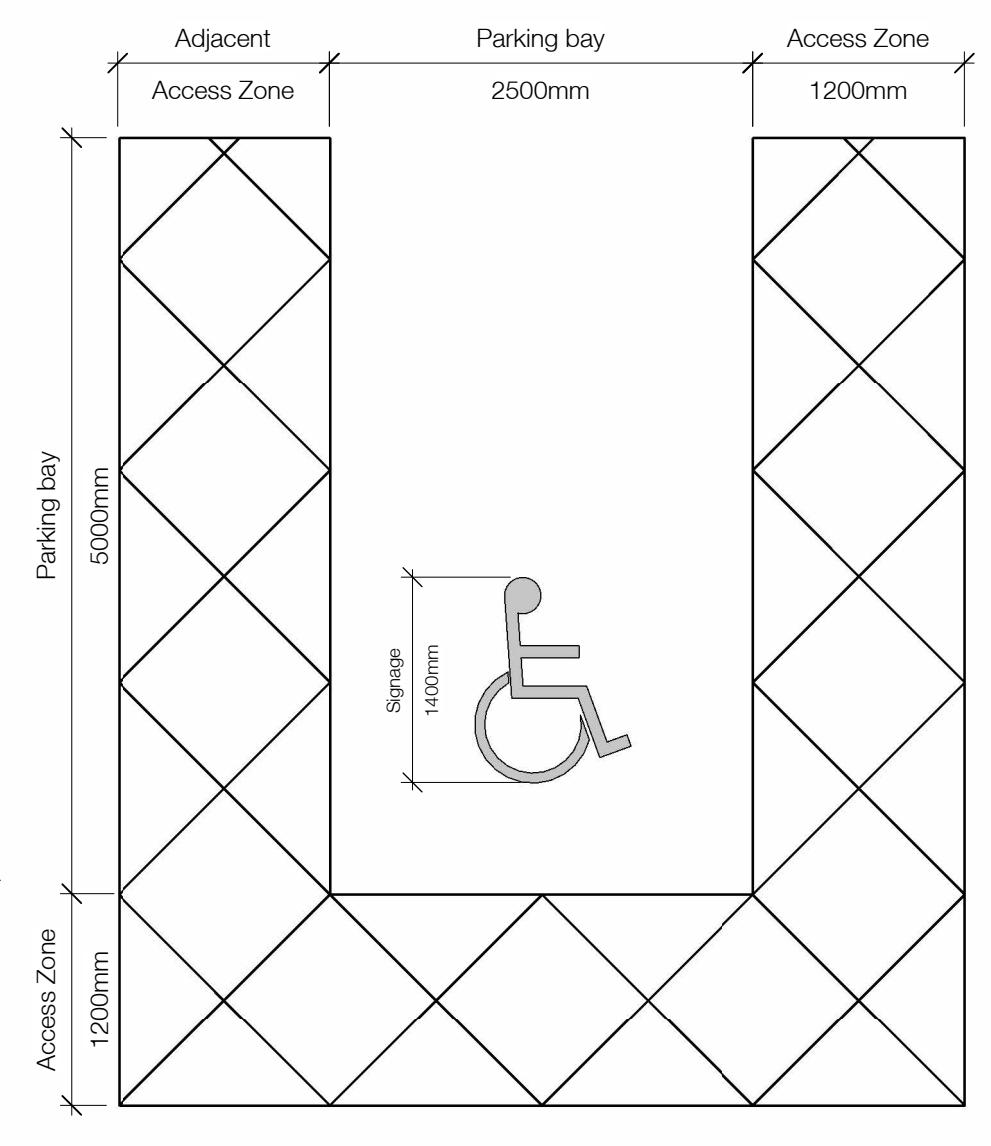
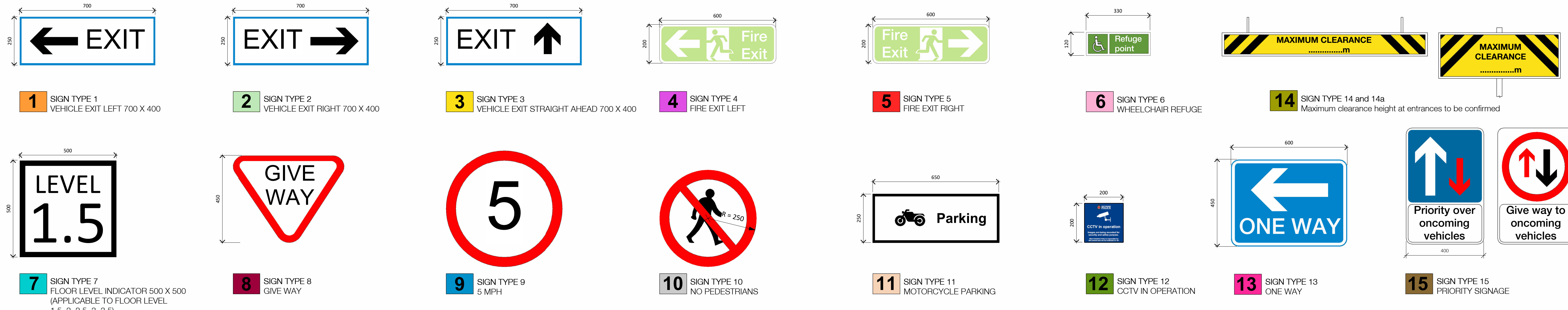

Road Marking sizes  
1:25



P4	Drawing updated in accordance with client	JSD	AYD	15/04/25
P3	Priority signage indicated	SAV	SAV	04/09/24
P2	Client comments incorporated	SAV	SAV	17/09/24
P1	Issued for review and comment	SAV	SAV	30/05/24
Rev Description		Drawn	Checked	Date
Submittal Issued for Construction Approval				
Project West Yorkshire Police Wilmetts Data Centre Halifax Road, Dewsbury, WF13 2AS				
Drawing Signage and Demarcation - MSCP Level 2.5 & 03				
Drawing Number				
68001	Originator	Zone	Level	Type
RYD	RYD	ZZ	03	SA
3273-01	Project Number	Scale as indicated	Status	Revision
			S4	P4