

Key:

- 200mm timber post with 2 layers plasterboard
- ▤ 100x50 studs with 2 layers plasterboard

Indicative joists indicated in green dash @ 600 centres

Overhead ceiling structure to have hatches to facilitate maintenance to existing ceiling above

1 Proposed Ground Floor Plan  
 1 : 50

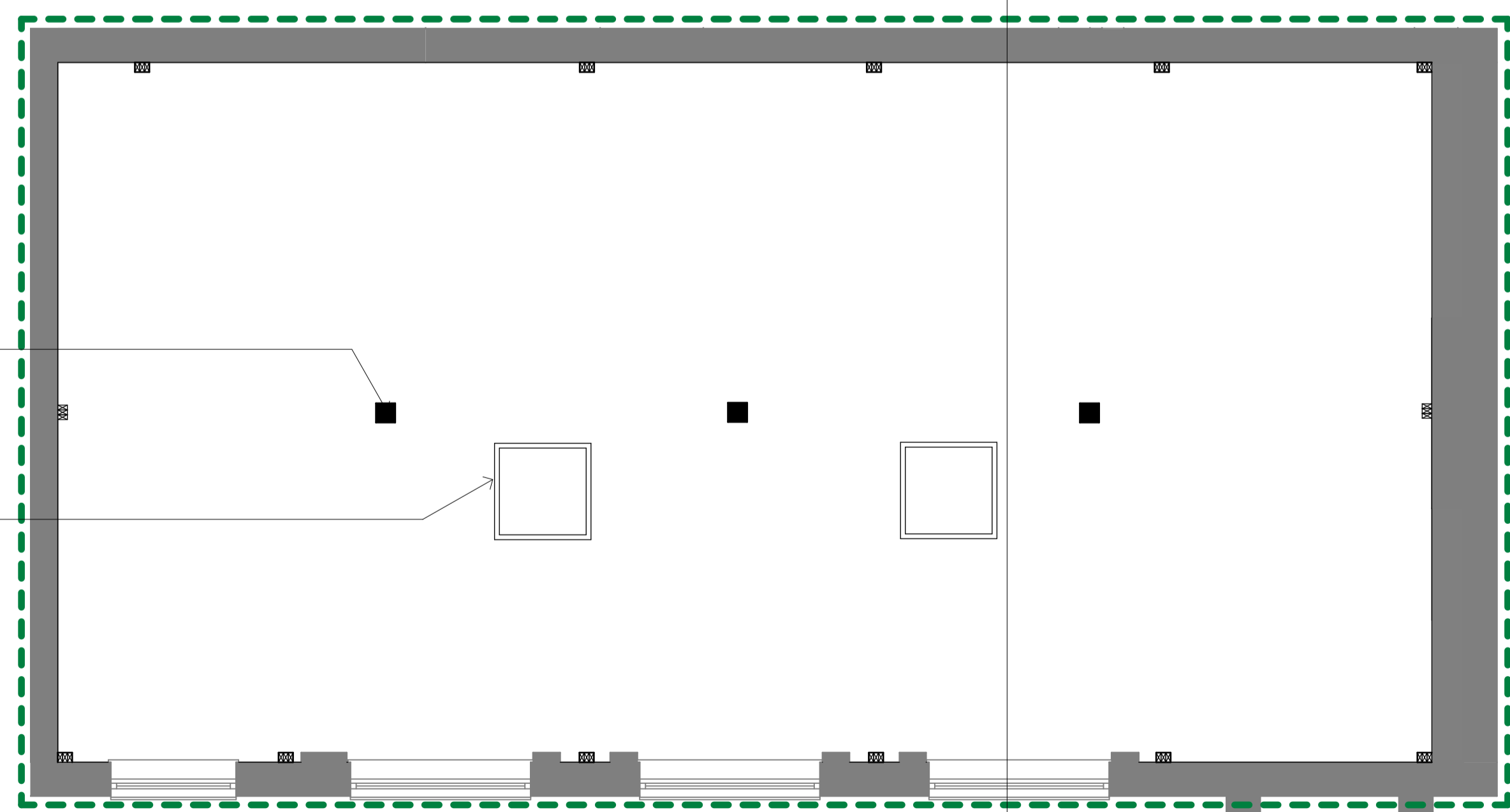

Timber columns to support British Gypsum proprietary structure

Overhead ceiling structure to have hatches to facilitate maintenance to existing ceiling above

3 Proposed Reflected Ceiling Plan  
 1 : 50

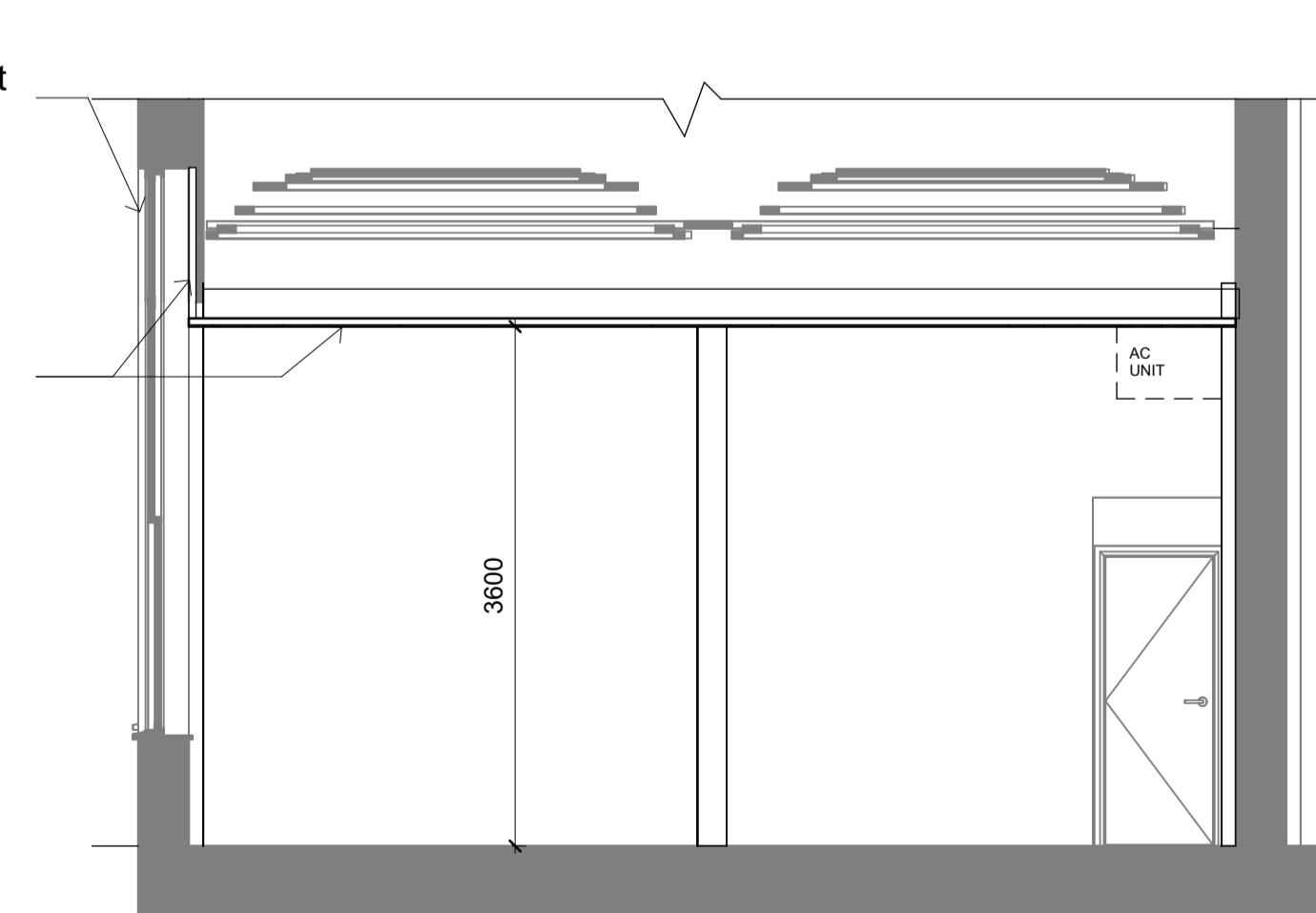

Glazing above new ceiling structure height to have opaque logo film applied

Ceiling structure to be boxed up behind window where ceiling structure overlaps glazing

2 Proposed Section A-A  
 1 : 50

rev	description	drawn	auth	date
DO NOT SCALE OFF THIS DRAWING				
<b>ACUMEN</b> Designers & Architects				
acumenarchitects.co.uk 01484 546 000 Headrow House, Old Leeds Road, Huddersfield, Huddersfield HD1 1SG				
Client MR J NOBLE				
Project 27 MARKET PLACE, HUDDERSFIELD, HD1 2AD				
Project No 2957	Drawing No (100)03	Rev		
Description PROPOSED FLOOR PLAN, SECTION THROUGH CEILING AND INVERTED CEILING PLAN				
Scale 1 : 50 @ A1	Date Drawn AUG 25	Drawn By GH	Authorised By JC	
Purpose of Issue Planning <input type="checkbox"/> Building Regs <input type="checkbox"/> Tender <input type="checkbox"/> Construction <input type="checkbox"/> Comment <input checked="" type="checkbox"/> Info <input type="checkbox"/>				