

Notes

- Temporary Pedestrian push-button crossing to be installed.

- Existing traffic lights to be switched off / bagged

- Light grey road markings will be removed, and the link road markings shown on the plan, will be added to suit the road layout.

Key

- Traffic Cones
- Pedestrian Barrier
- ● ● Traffic Signal
- Pedestrian Traffic Signal
- Work Area
- Pedestrian Diversion Route
- RAMP Kerb Ramp

Crown Copyright. All rights reserved.

Drawing No:
AREA 3B.4

Unauthorised reproduction infringes Crown Copyright and may lead to prosecution or civil proceedings.

Scale: **NTS** Drawn by: **SB** Approved by: **MB**

TEMPORARY TRAFFIC LIGHT TIMINGS							
PHASE 1		PHASE 2		PHASE 3		PHASE 4	
Green	Red	Green	Red	Green	Red	Green	Red
40 Sec	10 Sec	40 Sec	10 Sec	30 Sec	10 Sec	30 Sec	10 Sec

NOTE
Temporary Pedestrian push-button crossing to be installed.

NOTE
Existing traffic lights to be switched off / bagged.

PEDESTRIAN CROSSING TIMINGS	
RED	10s
GREEN	7s

NOTE
This section of footway to be installed during area 2.

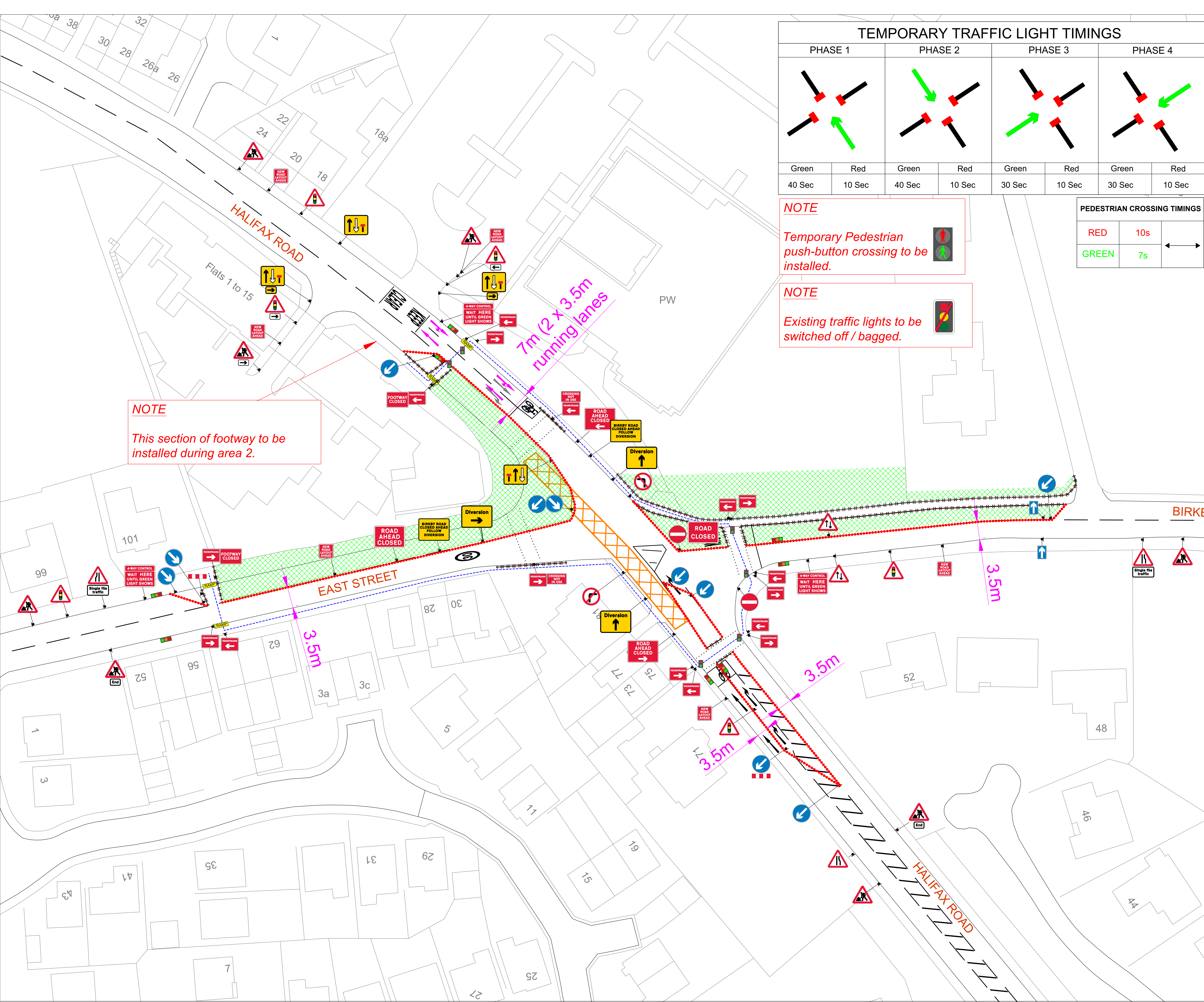

Customer **C R REYNOLDS**

Contract **A629 Halifax Road**

Location **A629 Halifax Road**

Date **08-07-2025**

Version/Amendment No. **2**

Notes

Key

- █ Road Closure
- █ Diversion Route

Crown Copyright. All rights reserved.

Drawing No:
AREA 3B.4

Unauthorised reproduction infringes Crown Copyright and may lead to prosecution or civil proceedings.

Scale: NTS Drawn by: SB Approved by: MB

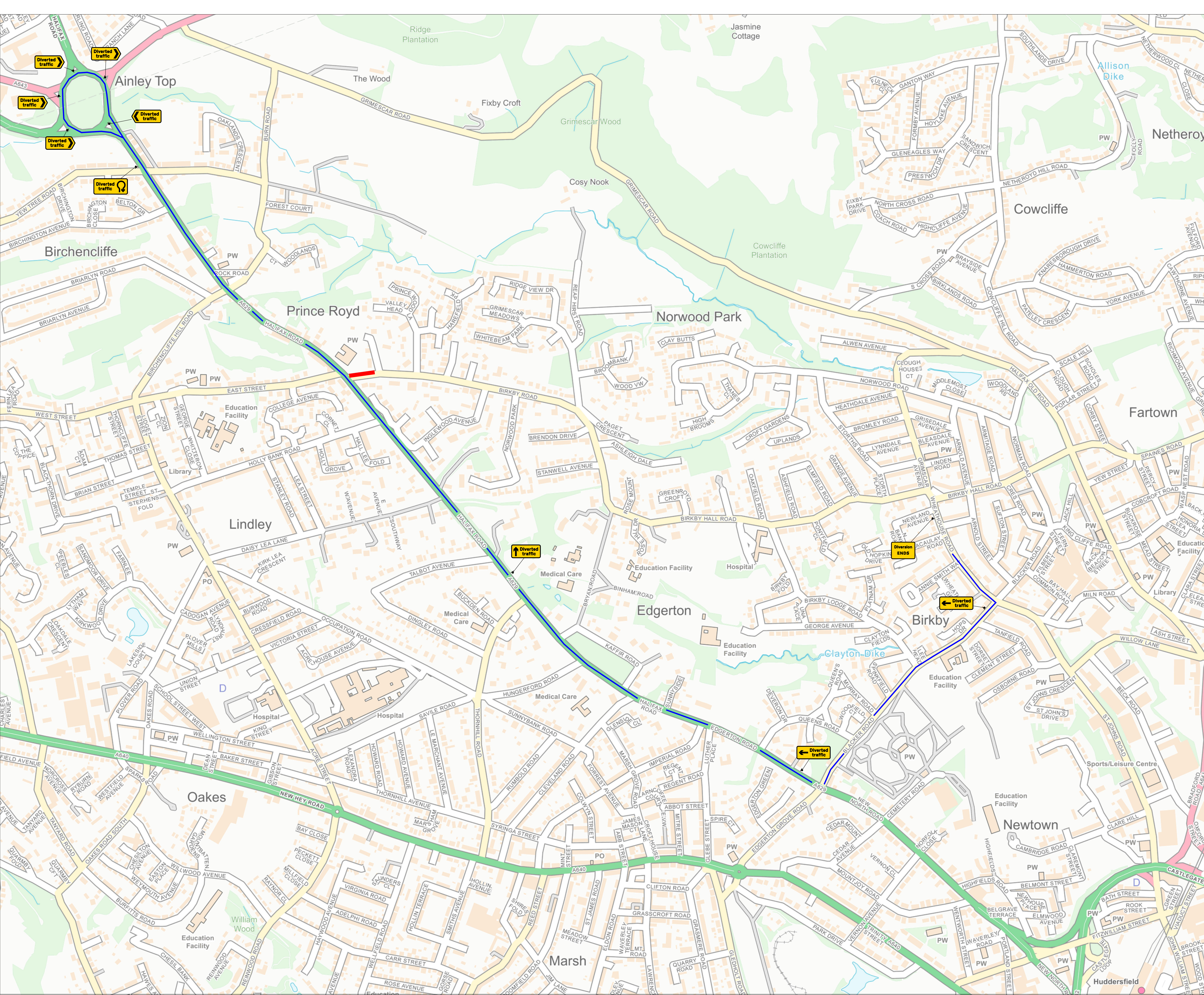

Customer	C R REYNOLDS
Contract	A629 Halifax Road
Location	A629 Halifax Road
Date	08-07-2025

Version/Amendment No. 2

Notes

Key

- Road Closure
- Diversion Route

Crown Copyright. All rights reserved.

Drawing No:
AREA 3B.4

Unauthorised reproduction infringes Crown Copyright and may lead to prosecution or civil proceedings.

Scale:	Drawn by:	Approved by:
NTS	SB	MB

Qty: 2 Ref: 13-9-YAL Direction to hazard Left		Qty: 1 Ref: 2703 Direction of temporary diversion route from junction ahead		Qty: 7 Ref: 610 Keep left		Qty: 3 Ref: 7011.1 4 Way Control - Wait here until green light shows	
Qty: 2 Ref: 13.9 Schedule 13-9 : Temporary Information		Qty: 1 Ref: 2704 Direction of temporary diversion route		Qty: 3 Ref: 610 Keep right		Qty: 6 Ref: 7014 New road layout ahead	
Qty: 1 Ref: 13.9 Schedule 13-9 : Temporary Information		Qty: 4 Ref: 2704 Direction of temporary diversion route		Qty: 1 Ref: 612 No right turn		Qty: 2 Ref: 7016 Crossing not in use [sign for pedestrians]	
Qty: 1 Ref: 13.9 Schedule 13-9 : Temporary Information		Qty: 2 Ref: 517 Road narrows on one side only ahead - right		Qty: 1 Ref: 613 No left turn		Qty: 8 Ref: 7018 Pedestrian diversion Right	
Qty: 2 Ref: 13.9 Schedule 13-9 : Temporary Information		Qty: 1 Ref: 517 Road narrows on one side only ahead - left		Qty: 2 Ref: 616 No entry		Qty: 8 Ref: 7018 Pedestrian diversion Left	
Qty: 2 Ref: 2702 Start of temporary diversion route		Qty: 2 Ref: 518 Single file traffic		Qty: 2 Ref: 645 End panel		Qty: 2 Ref: 7105 Lane closure barrier	
Qty: 1 Ref: 2702 Start of temporary diversion route		Qty: 2 Ref: 521 Two-way traffic		Qty: 2 Ref: 652 One way traffic		Qty: 3 Ref: 7202.1 Temporary lane availability	
Qty: 1 Ref: 2702 End of temporary diversion route		Qty: 6 Ref: 543 Traffic signals ahead		Qty: 8 Ref: 7001 Road works ahead		Qty: 1 Ref: 7202.1 Temporary lane availability	
Qty: 2 Ref: 2703 Direction of temporary diversion route from junction ahead		Qty: 1 Ref: 573 Direction to hazard left		Qty: 1 Ref: 7010-FP-13-9 Nature of temporary hazard ahead - Road Ahead Closed			
Qty: 1 Ref: 2703 Direction of temporary diversion route u-turn at roundabout ahead		Qty: 2 Ref: 573 Direction to hazard right		Qty: 1 Ref: 7010-FP-13-9 Nature of temporary hazard ahead - Road Closed			