

Customer **C R REYNOLDS**

Contract **A629 Halifax Road**

Location **A629 Halifax Road**

Date **08-07-2025**







Version/Amendment No. **2**

Notes

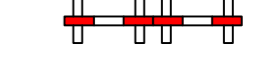
- Existing traffic lights to be switched off / bagged.

- Bus stop(s) to be suspended.
Bus stop I.D: 45020305

Key

-  Traffic Cones
-  Pedestrian Barrier
-  Traffic Signal
-  Pedestrian Traffic Signal
-  Work Area
-  Pedestrian Diversion Route
-  Kerb Ramp

Crown Copyright. All rights reserved.



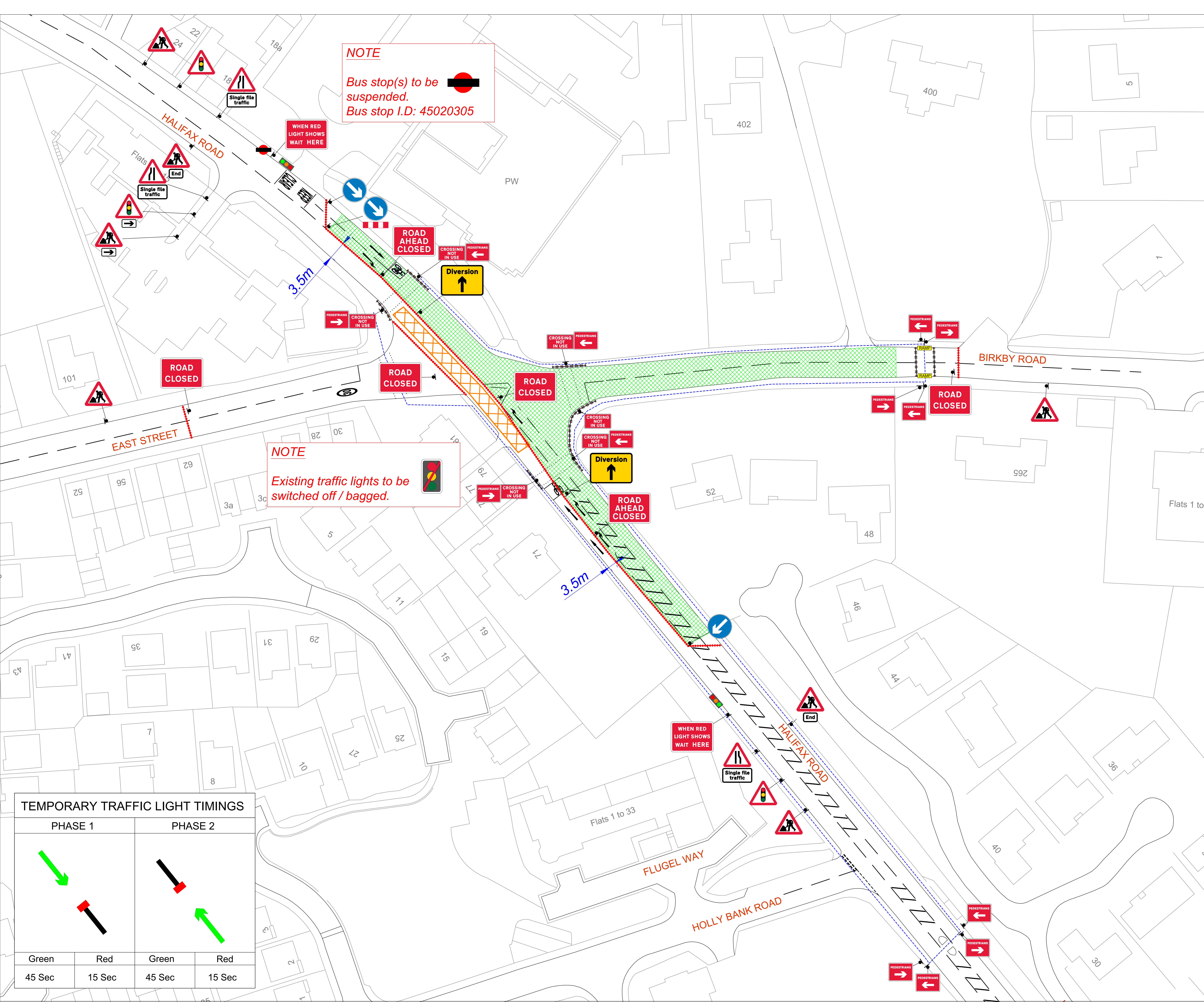

Drawing No:
AREA 3B SURF 1

Unauthorised reproduction infringes Crown Copyright and may lead to prosecution or civil proceedings.

Scale: **NTS** Drawn by: **SB** Approved by: **MB**

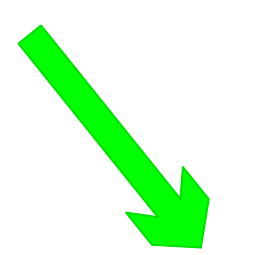

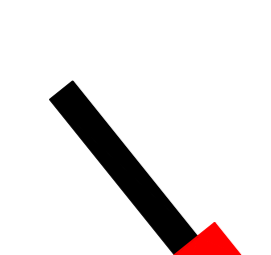
TEMPORARY TRAFFIC LIGHT TIMINGS

PHASE 1		PHASE 2	
			
Green	Red	Green	Red
45 Sec	15 Sec	45 Sec	15 Sec

Customer	C R REYNOLDS
Contract	A629 Halifax Road
Location	A629 Halifax Road
Date	08-07-2025

Version/Amendment No. 2

Notes

Key

- █ Road Closure
- █ Diversion Route

Crown Copyright. All rights reserved.

Drawing No:
AREA 3B SURF 1

Unauthorised reproduction infringes Crown Copyright and may lead to prosecution or civil proceedings.

Scale:	Drawn by:	Approved by:
NTS	SB	MB

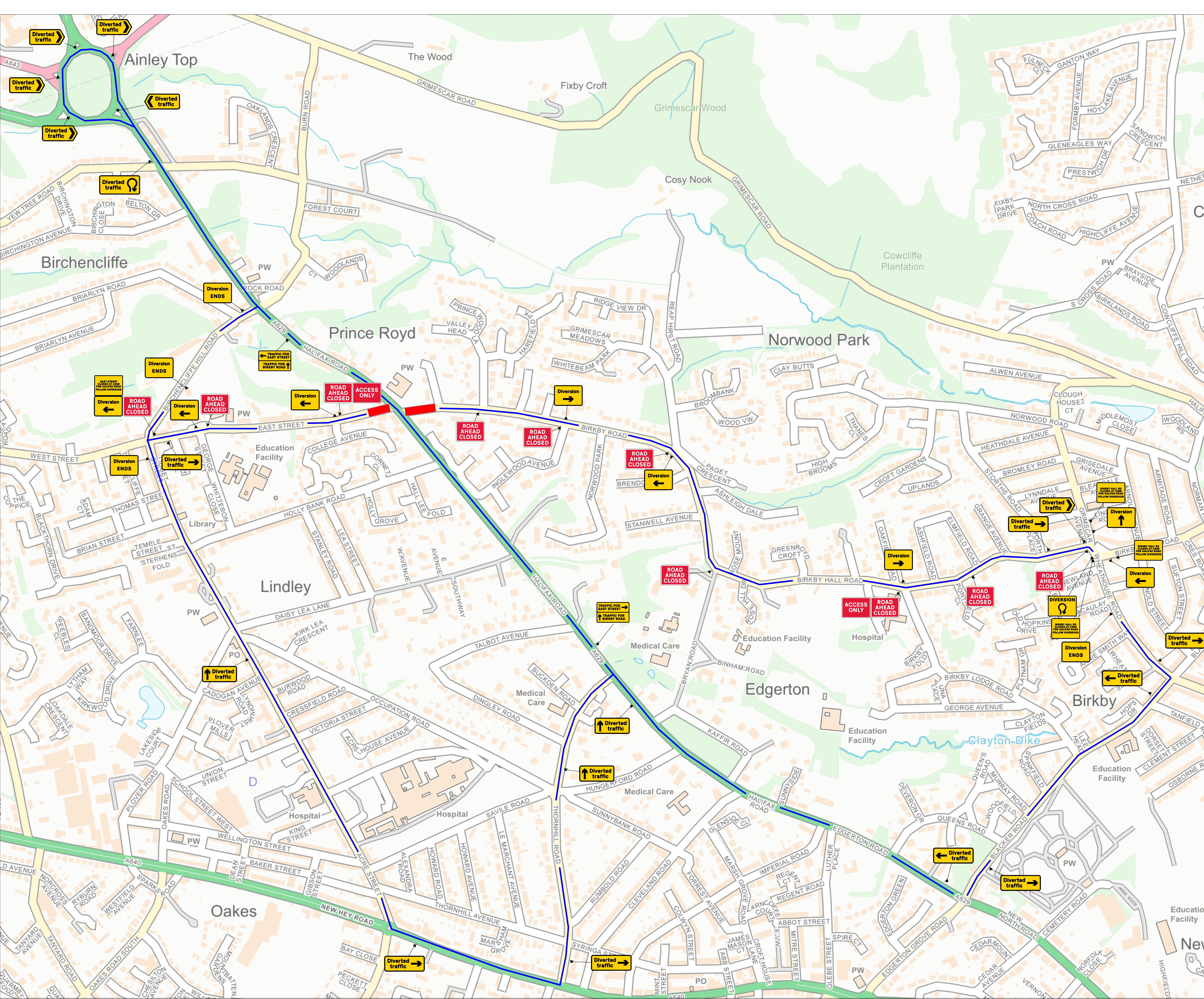

Qty: 1 Ref: 13-9 Schedule 13 : Temporary Sign		Qty: 6 Ref: 2703 Direction of temporary diversion route from junction ahead		Qty: 2 Ref: 610 Keep right	
Qty: 1 Ref: 13-9 Schedule 13 : Temporary Sign		Qty: 3 Ref: 2703 Direction of temporary diversion route from junction ahead		Qty: 2 Ref: 645 End panel	
Qty: 1 Ref: 13.9 Schedule 13-9 : Temporary Information		Qty: 1 Ref: 2703 Direction of temporary diversion route u-turn at roundabout ahead		Qty: 7 Ref: 7001 Road works ahead	
Qty: 3 Ref: 13.9 Schedule 13-9 : Temporary Information		Qty: 5 Ref: 2704 Direction of temporary diversion route		Qty: 4 Ref: 7010-FP-13-9 Nature of temporary hazard ahead - Road Closed	
Qty: 1 Ref: 13.9 Schedule 13-9 : Temporary Information		Qty: 1 Ref: 2704 Direction of temporary diversion route		Qty: 12 Ref: 7010-FP-13-9 Nature of temporary hazard ahead - Road Ahead Closed	
Qty: 2 Ref: 13.9 Schedule 13-9 : Temporary Information		Qty: 2 Ref: 517 Road narrows on one side only ahead - left		Qty: 2 Ref: 7011 When Red Light Shows Wait Here	
Qty: 5 Ref: 2702 Start of temporary diversion route		Qty: 1 Ref: 517 Road narrows on one side only ahead - right		Qty: 6 Ref: 7016 Crossing not in use [sign for pedestrians]	
Qty: 3 Ref: 2702 Start of temporary diversion route		Qty: 3 Ref: 518 Single file traffic		Qty: 7 Ref: 7018 Pedestrian diversion Left	
Qty: 4 Ref: 2702 End of temporary diversion route		Qty: 3 Ref: 543 Traffic signals ahead		Qty: 6 Ref: 7018 Pedestrian diversion Right	
Qty: 2 Ref: 2702 Start of temporary diversion route		Qty: 2 Ref: 573 Direction to hazard right		Qty: 1 Ref: 7105 Lane closure barrier	
Qty: 2 Ref: 2703 Direction of temporary diversion route from junction ahead		Qty: 1 Ref: 610 Keep left			

Key

- Road Closure
- Diversion Route

Crown Copyright. All rights reserved.

Drawing No:
AREA 3B SURF 1

Unauthorised reproduction infringes Crown Copyright and may lead to prosecution or civil proceedings.

Scale: NTS	Drawn by: SB	Approved by: MB
---------------	-----------------	--------------------