

Legend:

- Site boundary
- - - - Public Rights of Way
- Existing notable trees

Surfaces Proposed	sq m
LV-Existing - Woodland / scrub	25,726
LV-Proposed - Area of ecological enhancement	23,165
LV-Proposed - Neutral grassland	610,311
LV-Proposed - Site access	13,713
LV-Proposed - Tree / shrub belt planting at 1m centres	14,019
LV-Proposed - Tree / shrub belt planting at 2m centres	16,206
LV-Proposed - Tussocky grassland and wildflowers	149,564

Hedgerows	LM
LV-Existing - Hedgerows gapped up or new hedgerows planted	3,773
LV-Proposed - New native hedgerow	670

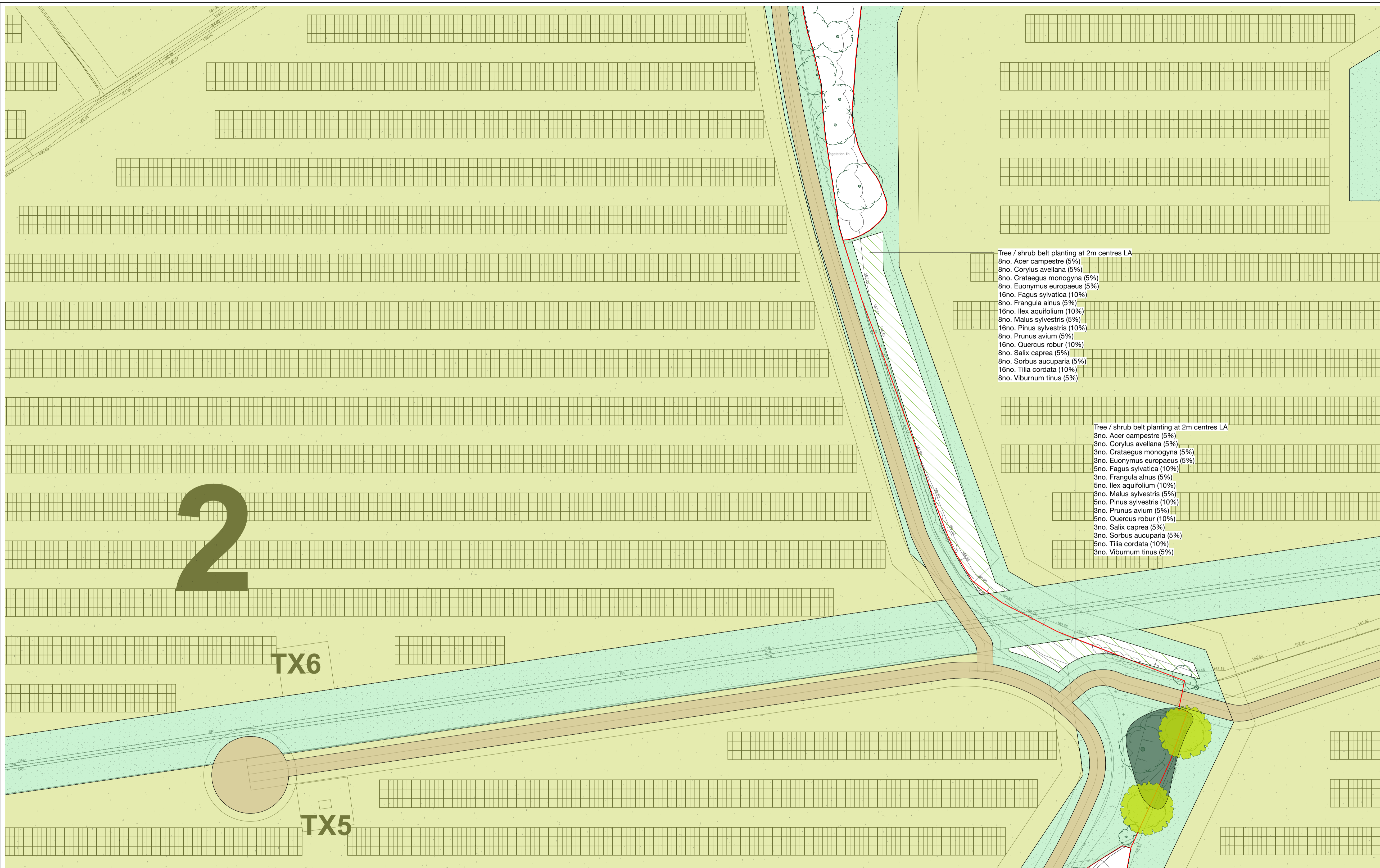

Tree / shrub belt planting at 2m centres LA
 8no. Acer campestre (5%)
 8no. Corylus avellana (5%)
 8no. Crataegus monogyna (5%)
 8no. Euonymus europaeus (5%)
 16no. Fagus sylvatica (10%)
 8no. Frangula alnus (5%)
 16no. Ilex aquifolium (10%)
 8no. Malus sylvestris (5%)
 16no. Pinus sylvestris (10%)
 8no. Prunus avium (5%)
 16no. Quercus robur (10%)
 8no. Salix caprea (5%)
 8no. Sorbus aucuparia (5%)
 16no. Tilia cordata (10%)
 8no. Viburnum tinus (5%)

Tree / shrub belt planting at 2m centres LA
 3no. Acer campestre (5%)
 3no. Corylus avellana (5%)
 3no. Crataegus monogyna (5%)
 3no. Euonymus europaeus (5%)
 5no. Fagus sylvatica (10%)
 3no. Frangula alnus (5%)
 5no. Ilex aquifolium (10%)
 3no. Malus sylvestris (5%)
 5no. Pinus sylvestris (10%)
 3no. Prunus avium (5%)
 5no. Quercus robur (10%)
 3no. Salix caprea (5%)
 3no. Sorbus aucuparia (5%)
 5no. Tilia cordata (10%)
 3no. Viburnum tinus (5%)

Planting Schedule	Latin Name	Percent	Density	Form / Girth / Height	Condition*	Qty
Neutral grassland LA			0			0
Emorsgate EM1		100	4 Plants/sq m	Seed / g		2440177
Proposed hedgerow LA			0			0
	Acer campestre	10	1.82 Plants/sq m	Branched / 1.2-1.5m high	BR	404
	Corylus avellana	10	1.82 Plants/sq m	Branched / 1.2-1.5m high	BR	404
	Crataegus monogyna	40	1.82 Plants/sq m	Branched / 1.2-1.5m high	BR	1612
	Ilex aquifolium	10	1.82 Plants/sq m	50-60cm leader with laterals	BR	404
	Prunus spinosa	10	1.82 Plants/sq m	Branched / 1.2-1.5m high	BR	404
	Rosa canina	10	1.82 Plants/sq m	3L	SKU	404
	Viburnum opulus	10	1.82 Plants/sq m	Branched / 1.2-1.5m high	BR	404
			0			0
Tree / shrub belt planting at 1m centres LA			0			0
	Acer campestre	5	1 Meters on center	Standard / 8-10 (2.5-3m high)	RB	699
	Corylus avellana	5	1 Meters on center	5L	SKU	699
	Crataegus monogyna	5	1 Meters on center	Standard / 8-10 (2.5-3m high)	RB	699
	Euonymus europaeus	5	1 Meters on center	Branched / 60-80cm	C 3L	699
	Fagus sylvatica	10	1 Meters on center	Standard / 8-10 (2.5-3m high)	SKU	1403
	Frangula alnus	5	1 Meters on center	Branched / 60-80cm	BR	699
	Ilex aquifolium	10	1 Meters on center	50-60cm leader with laterals	BR	1403
	Malus sylvestris	5	1 Meters on center	Feathered / 125-150cm	RB	699
	Pinus sylvestris	10	1 Meters on center	Standard / 8-10 (2.5-3m high)	SKU	1403
	Prunus avium	5	1 Meters on center	Branched / 60-80cm	BR	699
	Quercus robur	10	1 Meters on center	Standard 8-10 (2.5-3m high)	RB	1403
	Salix caprea	5	1 Meters on center	5L	SKU	699
	Sorbus aucuparia	5	1 Meters on center	Standard / 8-10 (2.5-3m high)	BR	699
	Tilia cordata	10	1 Meters on center	Standard / 8-10 (2.5-3m high)	RB	1403
	Viburnum tinus	5	1 Meters on center	3L	SKU	699
			0			0
Tree / shrub belt planting at 2m centres LA			0			0
	Acer campestre	5	2 Meters on center	Standard / 8-10 (2.5-3m high)	RB	204
	Corylus avellana	5	2 Meters on center	5L	SKU	204
	Crataegus monogyna	5	2 Meters on center	Standard / 8-10 (2.5-3m high)	RB	204
	Euonymus europaeus	5	2 Meters on center	Branched / 60-80cm	C 3L	204
	Fagus sylvatica	10	2 Meters on center	Standard / 8-10 (2.5-3m high)	SKU	404
	Frangula alnus	5	2 Meters on center	Branched / 60-80cm	BR	204
	Ilex aquifolium	10	2 Meters on center	50-60cm leader with laterals	BR	404
	Malus sylvestris	5	2 Meters on center	Feathered / 125-150cm	RB	204
	Pinus sylvestris	10	2 Meters on center	Standard / 8-10 (2.5-3m high)	SKU	404
	Prunus avium	5	2 Meters on center	Branched / 60-80cm	BR	204
	Quercus robur	10	2 Meters on center	Standard 8-10 (2.5-3m high)	RB	404
	Salix caprea	5	2 Meters on center	5L	SKU	204
	Sorbus aucuparia	5	2 Meters on center	Standard / 8-10 (2.5-3m high)	BR	204
	Tilia cordata	10	2 Meters on center	Standard / 8-10 (2.5-3m high)	RB	404
	Viburnum tinus	5	2 Meters on center	3L	SKU	204
			0			0
Tussocky grassland with wildflowers LA			0			0
Landlife Wildflowers LW1M		100	5 Plants/sq m	Seed / g		863657

Latin Name	Form / Girth / Height	Condition*	Qty
Quercus robur	Standard 8-10 (2.5-3m high)	RB	63

Condition * C 2L = 2 litre container; BR = Bareroot; RB = Rootball

The schedule does not include hedging plants for gapping-up the existing hedgerows, which would be subject to further survey.

Revision	Date	Notes
A	31/07/25	Proposed trees in parcel 5 moved within redline

Project: **Low Farm, Flockton**
 Title: **Area 8**
 Date: **July 2025**
 Ref: **1282/108**
 Scale: **1:500@ A1**

