

Notes

PLANNING

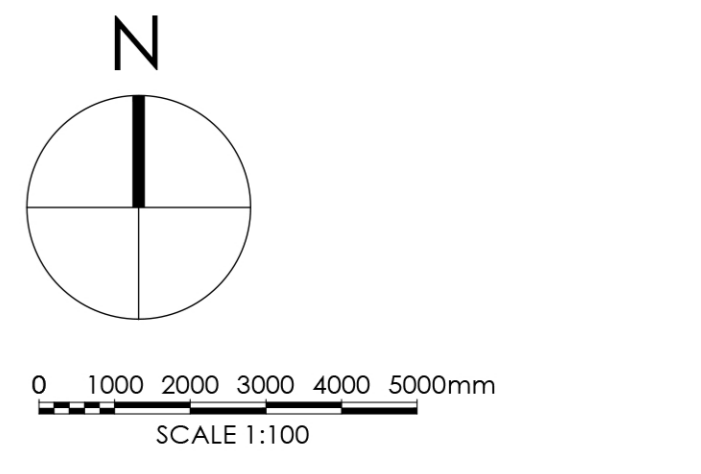

**Note:** Surrounding contextual buildings and information are based on received ordinance survey drawings and are shown for illustrative purposes only. assumed site boundary is subject to confirmation to legal confirmation.

**Note:** Information is based on OS map and received information and is subject to full topographical survey. Assumed site boundary and site constraints subject to legal confirmation. All legal easements and extent of existing underground services locations are subject to confirmation.

A.	21/07/25	Updated to planners officers comments	Jat.	Jat.
Rev.	Date	Amendments	By	App'd

# Eight OneTwo Architects

Tel: +44 [0]7761 570735  
 Email: mail@eightonetwo.co.uk  
 www.eightonetwo.co.uk  
 Studio A5, Brooke's Mill, Armitage Bridge, Huddersfield, HD4 7NR

Drawing Status: PLANNING

Client: MR + MRS WILLIAMS

Project: UNDERHILL, 178 LAMB HILL ROAD, HUDDERSFIELD

Drawing Title: AS PROPOSED SITE PLAN

Drawing Scale: 1:100  
 Drawn By: Jat.  
 Checked By: Jat.

Paper Size: A1  
 Drawn Date: MARCH 2025  
 Checked Date: APRIL 2025

Drawing Number: 24\_824\_117 A

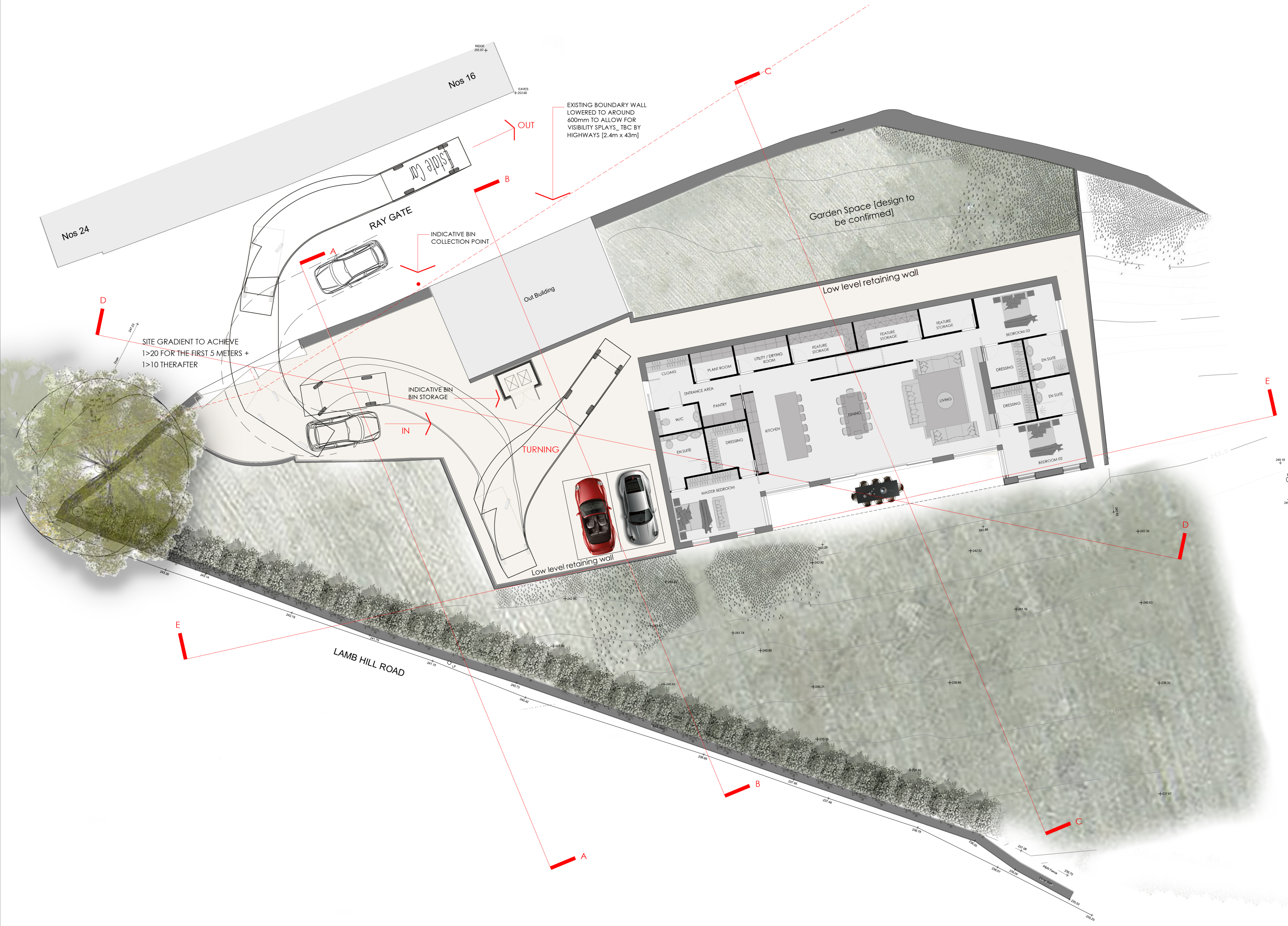

SITE PLAN AS PROPOSED Scale 1:100