

Bradford Road, Huddersfield

ISSUE FOR PLANNING

- NOTES:**
1. ALL DIMENSIONS ARE IN MILLIMETRES, UNLESS STATED OTHERWISE.
 2. DO NOT SCALE FROM THIS DRAWING.
 3. ALL DIMENSIONS TO BE VERIFIED ON SITE BEFORE CONSTRUCTION COMMENCES.
 4. EXISTING SERVICE RINGS TO BE VERIFIED BY SITE INSPECTION.

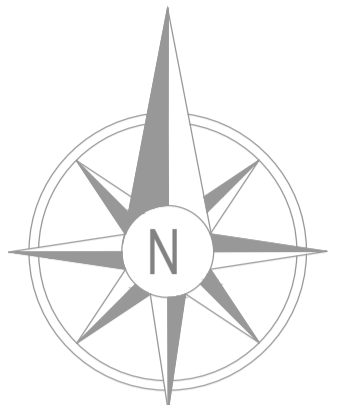

DRAWING LEGEND

	INTERMEDIATE UNITS +11 PLOTS IN TOTAL
	INTERMEDIATE UNITS +8 PLOTS IN TOTAL
	INTERMEDIATE UNITS +14 PLOTS IN TOTAL

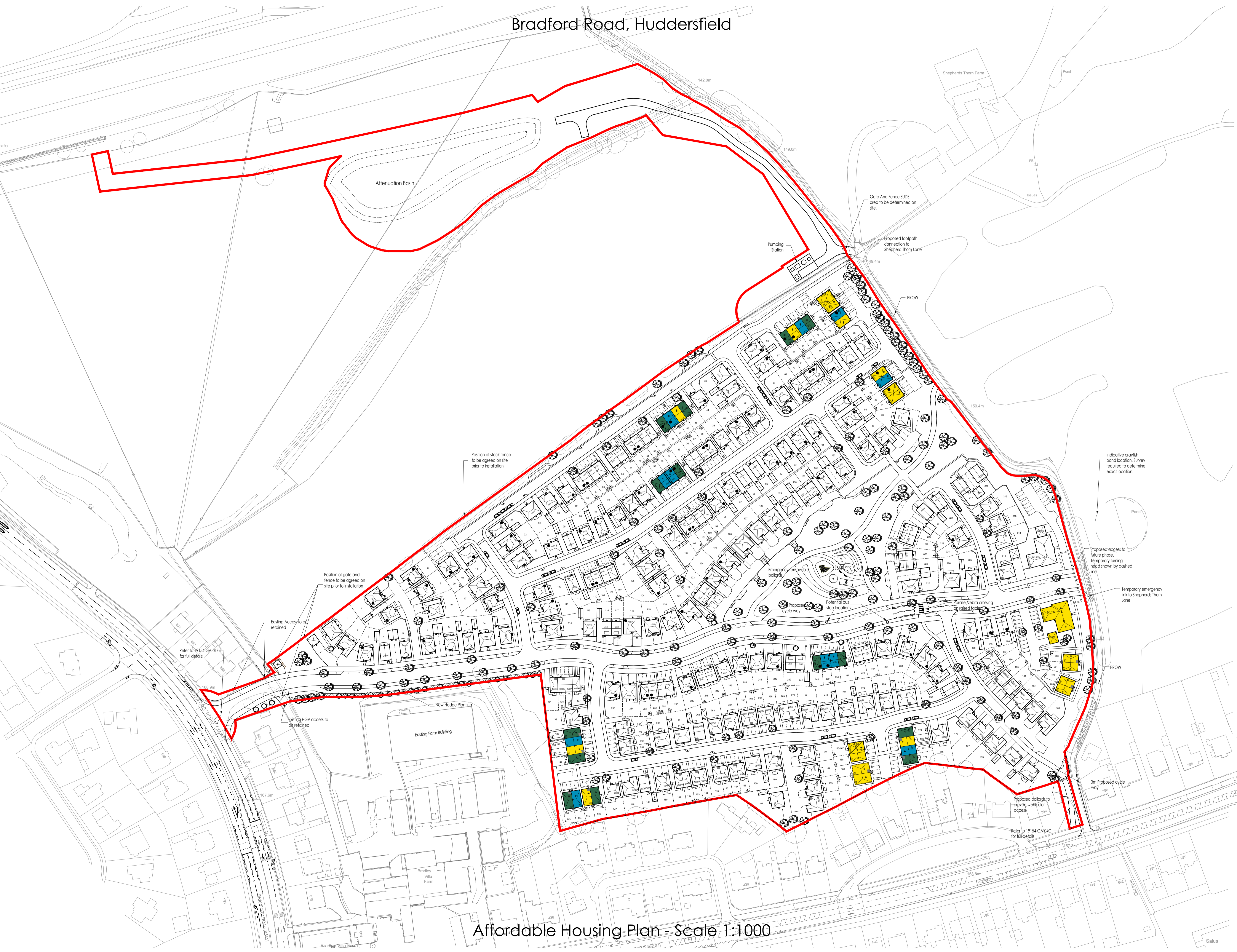

Affordable Housing Plan - Scale 1:1000

**REDROW
HOMES**

AN ASSOCIATED MEMBER OF THE STRANGLERS GROUP

AN ASSOCIATED MEMBER OF THE STRANGLERS GROUP

140@parkerpeel.co.uk | www.parkerpeel.co.uk | 01924 921 860

Client: David Wilson Homes / Redrow Homes

Project: 2504 Residential Development at Bradford Road, Huddersfield

Title: Affordable Housing Plan

Drawn	Rev. No.	Scale	Sheet	Checked	Date
2504-AF-01	-	1:1000@A1 LA	AK		04/25