

Wilmar Drive

existing drop kerb

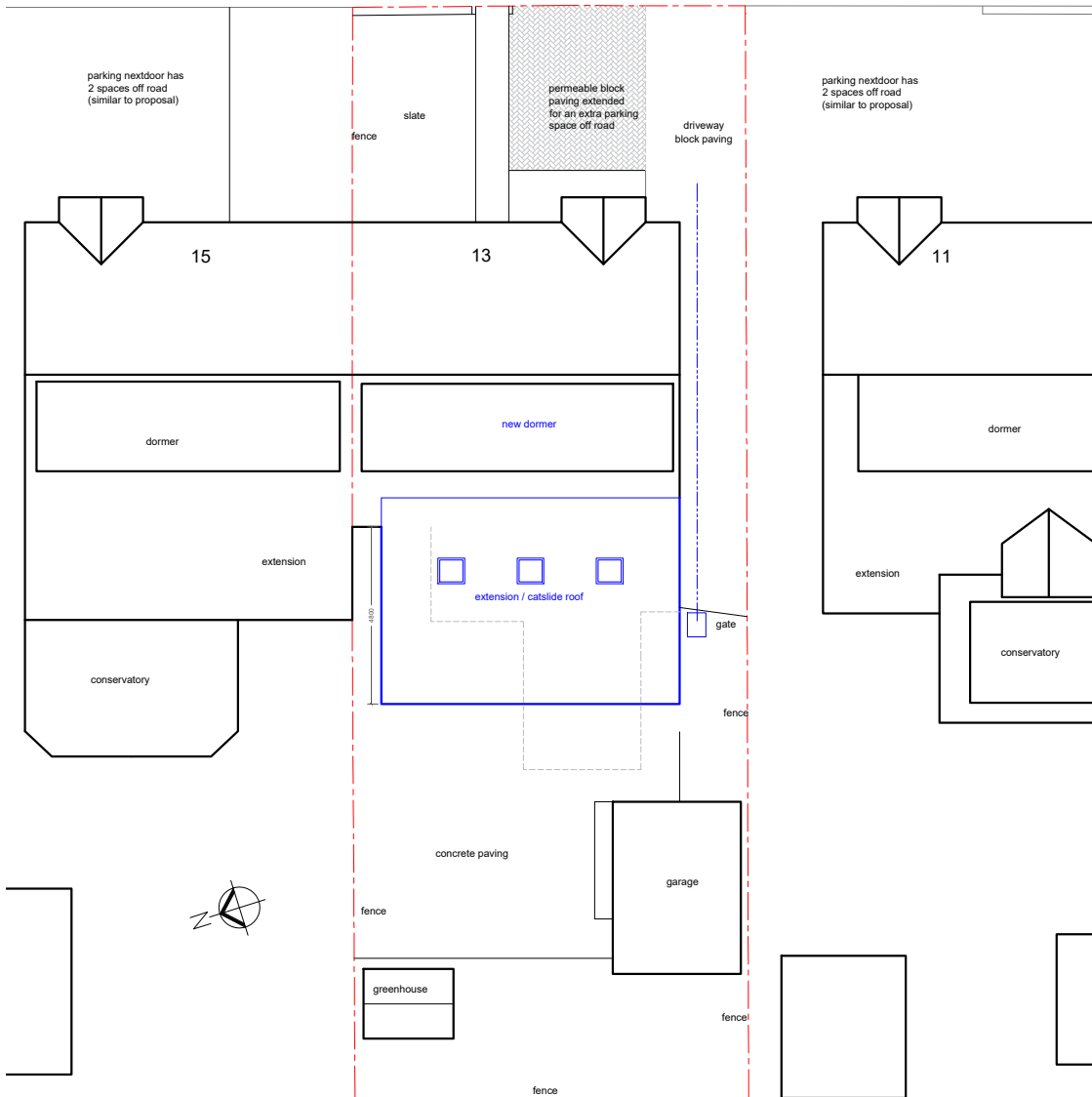

Applicant:  
Mr A Jackson  
Miss J Gartside

Address:  
13 Wilmar Drive  
Salendine Nook  
HD3 3XQ

Project:  
Rear Extension,  
Dormer and  
Alterations

Title:  
Proposed Site Plan

Drg No:  
WD-04

Scale:  
1:200

Revision:  
#

Status:  
Planning

Date:  
April 2025