

ARCHITECTURE | PLANNING | DESIGN

Malkin Farm  
Brow Lane  
Holmfirth  
HD9 2RJ  
07946872499  
paul@paulmatthewsarchitectural.co.uk  
www.paulmatthewsarchitectural.co.uk

Company Registration Number: 09898149 – Company Registered in England and Wales

Do not scale from drawing, use figured dimensions only.

All dimensions must be checked and verified on site prior to commencement of works and architect to be notified of any discrepancies.

The copyright for these drawings remains the property of Paul MatthewsArchitectural Ltd. They must not be reproduced in any way without prior written consent from the originator (Paul MatthewsArchitecturalLtd).

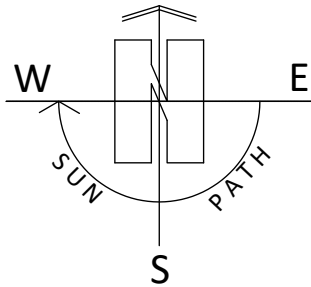

Project  
Removal of UPVC Conservatory Erection of Replacement Extension and Alterations to Garage/Stable to form one dwelling with associated Alterations (within a Conservation Area).At, Former Stables/Garage adj, 84, Woodhead Road, Holmbridge, Holmfirth, HD9 2NL  
Client

Mrs H Sutton

Drawing Title/Issue

Existing Block Plan

scale 1:500 date 03/2025 sheet size A4 dwg. no. 25/1145/02c

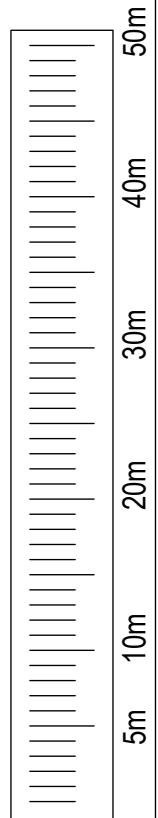
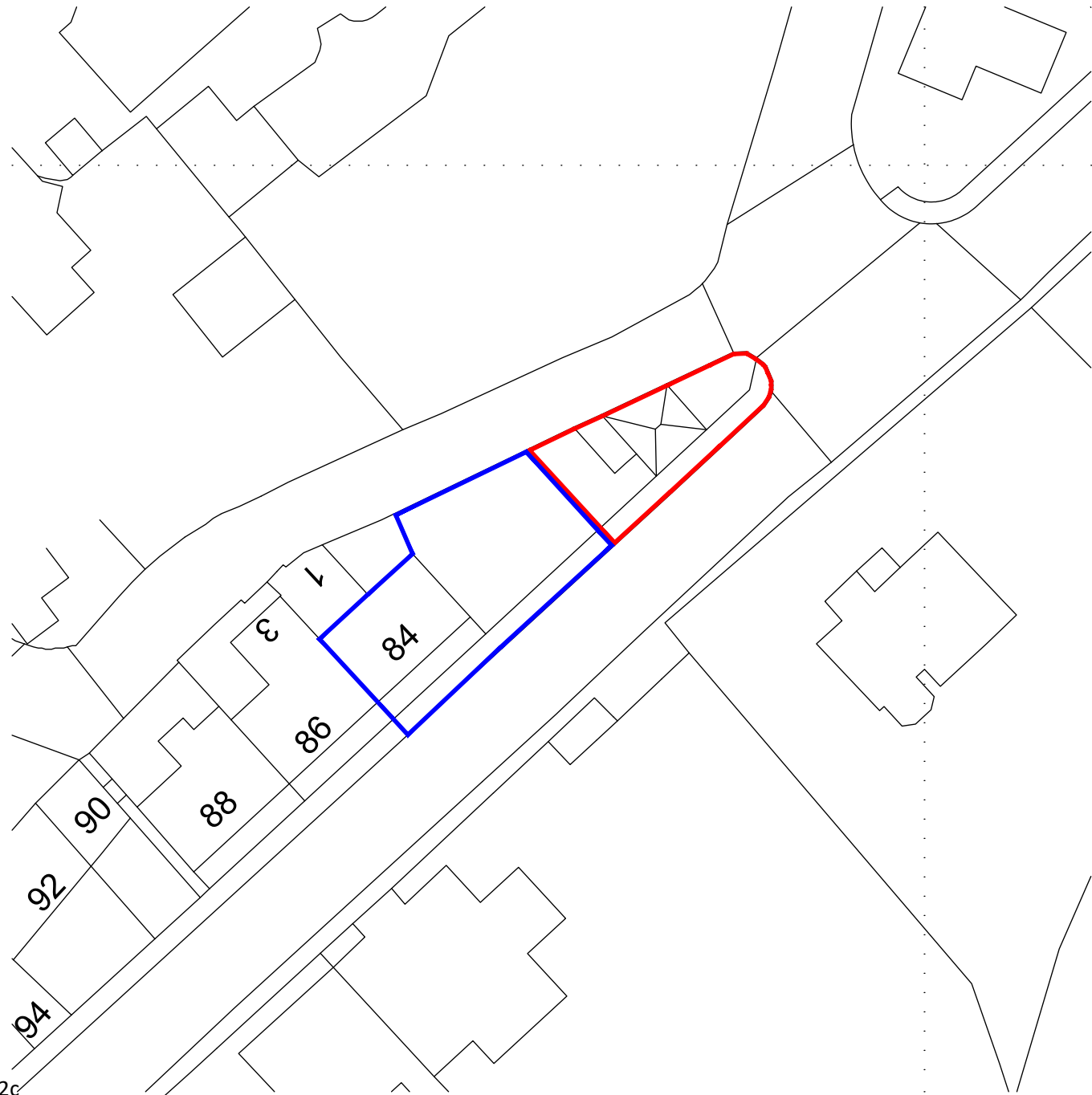

1:500