

Information provided below with reference to the sketch included in the application;

Intended height and spread of the trees after pruning

- Horse chestnut tree- 8m high spread 6m
- Ash trees and sycamore tree adjacent Elms Hill - 6m high, 4m
- Sycamore trees adjacent Varley Road- 50%, 10m high, 5m

### Sketch plan

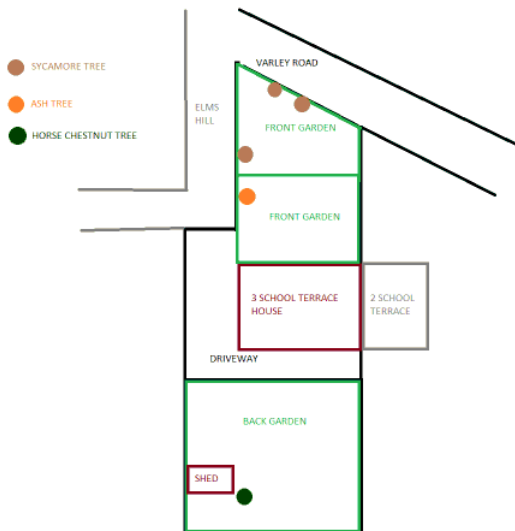

### Guidance extract

**Crown Reduction** - The tree crown is reduced by shortening branches, and so changes the overall size and shape of the tree. Reductions are usually carried out all round the outer parts of the crown to maintain a balanced shape, but seldom should it include cutting through the main stem.



The amount of reduction proposed should be stated in terms of the intended height and spread of the tree after pruning (rather than what percentage (%) of the overall crown is to be removed).

- Partial reduction may be useful for preventing branches contacting buildings, roofs and guttering