

**NOTES**

- Do not scale from this drawing, except for planning purposes.
- Check all dimensions on site.
- Subject to survey.
- Subject to site inspection.
- Site boundary lines are indicative only.

**NOTE:**

GA: 148m<sup>2</sup>  
(1593R<sup>2</sup>)

All Works must comply with appropriate building regulations, and in particular Part M access to and use of buildings and Part K Protection from falling, collision and impact.

All proposed wall removals are subject to confirmation and approval by a structural engineer.  
Allow for the steel plate on the floor where needed for load. Subject to structural engineer specification.

Floor of above flat to receive appropriate sound proofing and fire separation to achieve min 60 min fire resistance treatment as part of Landlords Works.

GAS CUPBOARD - Proposed location - Kiosk in the back yard - TBC

ELECTRIC CUPBOARD - to be retained in existing location- basement

CONDENSERS - to the back of the property in Plant Room yard, as per drawings.

EURO BINS - to the back of the property.

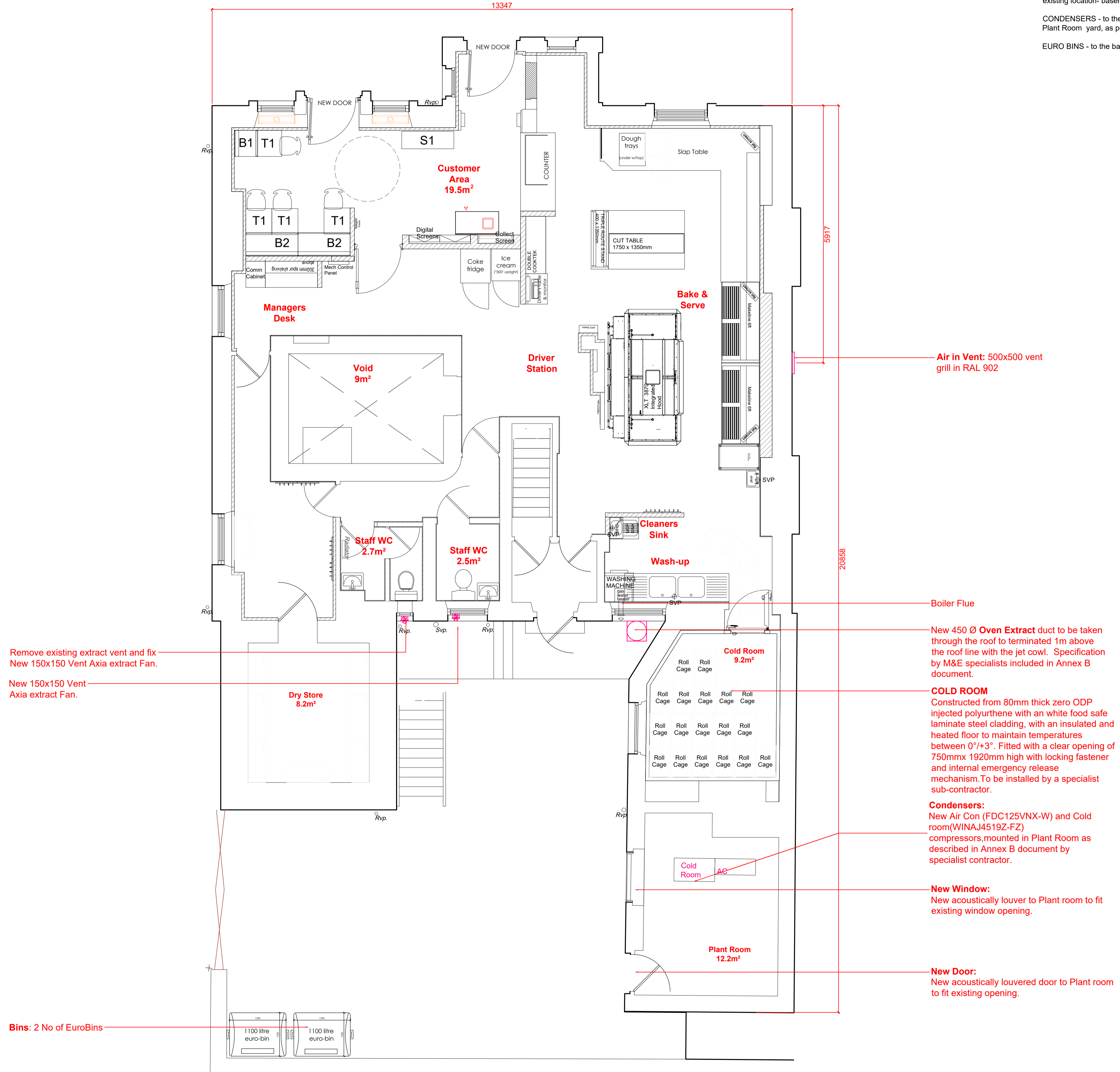

Remove existing extract vent and fix New 150x150 Vent Axia extract Fan.

New 150x150 Vent Axia extract Fan.

Bins: 2 No of EuroBins

Air in Vent: 500x500 vent grill in RAL 902

Boiler Flue

New 450 Ø Oven Extract duct to be taken through the roof to terminated 1m above the roof line with the jet cowl. Specification by M&E specialists included in Annex B document.

**COLD ROOM**  
Constructed from 80mm thick zero ODP injected polyurethane with a white food safe laminate steel cladding, with an insulated and heated floor to maintain temperatures between 0°/+3°. Fitted with a clear opening of 750mmx 1920mm high with locking fastener and internal emergency release mechanism. To be installed by a specialist sub-contractor.

**Condensers:**  
New Air Con (FDC125VNX-W) and Cold room (WINAJ4519Z-FZ) compressors, mounted in Plant Room as described in Annex B document by specialist contractor.

**New Window:**  
New acoustically louvre to Plant room to fit existing window opening.

**New Door:**  
New acoustically louvered door to Plant room to fit existing opening.

02	07/02/25	HCH	Changed to comments by Pegasus.
01	31/01/25	HCH	First Issue
Rev	Date	By	Description

Revision Schedule

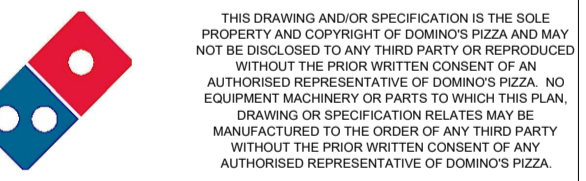

project  
**Domino's Mirfield**  
47 Huddersfield Road  
Mirfield, WF14 8AE

title  
**Proposed**  
Ground Floor Layout

drawing status  
**Planning**

contract no.	scale
-	1:50@ A1
client ref.	date
-	30/01/2025
drawn by	checked by
HCH	-

drawing number	revision
10131-SD-XX-00-P-A-11001	02
project number-originate/alter/issue/revision/issue/revision	



**Simons Design Ltd**  
architects  
Newland House, The Point, Weaver Road, Lincoln,  
Lincolnshire, LN6 3GN  
T: +44 (0) 1522 815 114  
E: info@simons-design.co.uk  
www.simons-design.co.uk

**01 - Proposed Ground Floor Layout**  
Scale: 1 : 50

1:50 0 1 2 3 4 5 10mts