

\* 3no heritage style low profile rooflights installed to existing dwelling roof (side and rear elevations)

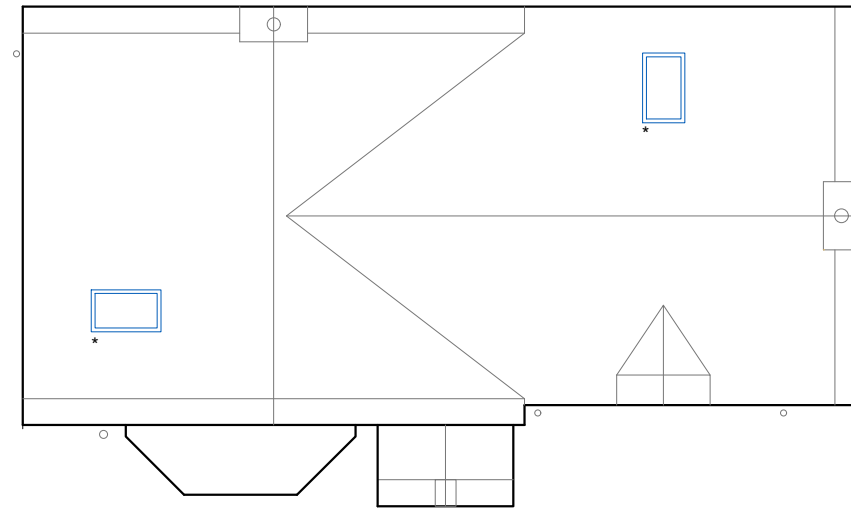

Roof Plan

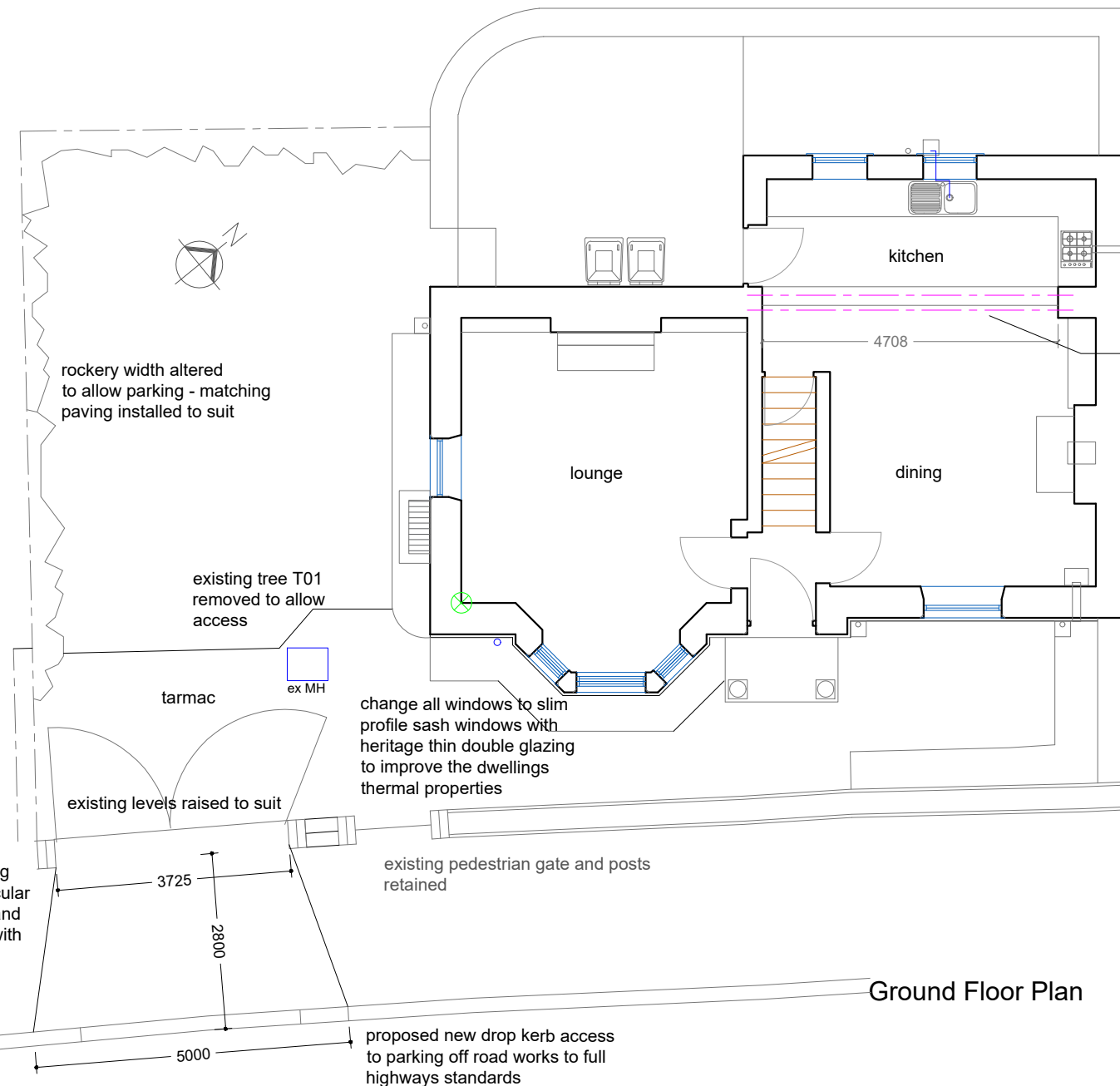

Ground Floor Plan

external boundary wall made good where collapsing store removed

new steel beams installed to kitchen opening, coving retained and matching skirtings installed

\* heritage style low profile rooflights installed to modern extension

new traditional stud partitions installed with skirtings and mouldings / door frames to suit original dwelling

new shower room suit installed, drainage connected to existing svp (main connection re-routed and old made good)

change all windows to slim profile sash windows with heritage thin double glazing to improve the dwellings thermal properties

First Floor Plan

Status:  
Planning

Date:  
Jan 2025

Scale:  
1:100

Drg No:  
BR07.A

A - Rooflight to rear bedroom removed - 10.06.25

Title: Proposed Plans  
#

Project: Internal and External Alterations  
202 Blacker Road, Edgerton