

RESIDUAL HAZARDS - SITE CLEARANCE	
High	THE DESIGNERS WOULD LIKE TO DRAW ATTENTION TO KEY RESIDUAL CONSTRUCTION HEALTH & SAFETY HAZARDS THAT MAY NOT BE ELIMINATED FROM THE WORKS BY THE DESIGN PROCESS. THESE HAZARDS ARE IDENTIFIED BELOW & ON THE DRAWING
Med	
Low	
A	LIVE SERVICES - ENSURE WORKS ARE PROTECTED BY THE APPROPRIATE MEANS AND SIGNED CORRECTLY. OPERATIVES TO HAND DIG WHERE SERVICES ARE KNOWN TO BE PRESENT.
B	OVERHEAD SERVICES - APPROPRIATE WORKING METHODS TO BE EMPLOYED IN PROXIMITY TO THE OVERHEAD CABLES AND EARLY COORDINATION WITH THE STATUTORY UNDERTAKERS.

ANY PERSONNEL UNDERTAKING CONSTRUCTION WORKS ASSOCIATED WITH THE DETAILS SHOWN ON THIS DRAWING SHOULD BE FULLY BRIEFED BY THE PRINCIPLE CONTRACTOR AND SHOULD BE MADE AWARE AND HAVE SIGHT OF THE FOLLOWING DOCUMENTS:

- THE DEVELOPMENT CONSTRUCTION PHASE HEALTH & SAFETY PLAN
- THE CONTRACTORS CONSTRUCTION METHOD STATEMENTS
- ANY REQUIREMENT FOR PERMIT TO WORK ASSOCIATED WITH ANY ACTIVITY

- Sanderson Associates Consulting Engineers ("the consultant"), has not checked or verified, and shall have no liability whatsoever for any inaccuracies which may be attributable to any data, reports, base plan(s) and drawings provided by the client, or purchased by the consultant on the client's behalf, that may have been utilised within this drawing.
- The consultant shall not be liable for the use by any person of any document for any purpose other than that for which the same were provided by the consultant.
- No liability whatsoever is accepted by the consultant for any error or omissions.
- The consultant accepts no liability for any vehicle specification errors within the vehicle track software used and / or it's vehicle libraries.
- The locations of utilities apparatus, if shown, is reproduced from plans supplied to the consultant, although care has been taken when duplicating this information. These locations are approximate only and no guarantee can be given for their accuracy. It is the client's or it's appointed agent/contractors responsibility to verify the exact locations on site by hand dug trial holes or other appropriate means prior to mechanical excavation.
- Service connections are not shown but their presence should be anticipated.
- Reference to any third party equipment shown on this drawing was only relevant at the time the drawing was prepared.
- It is the client's responsibility to ensure that any equipment ordered meets the design.

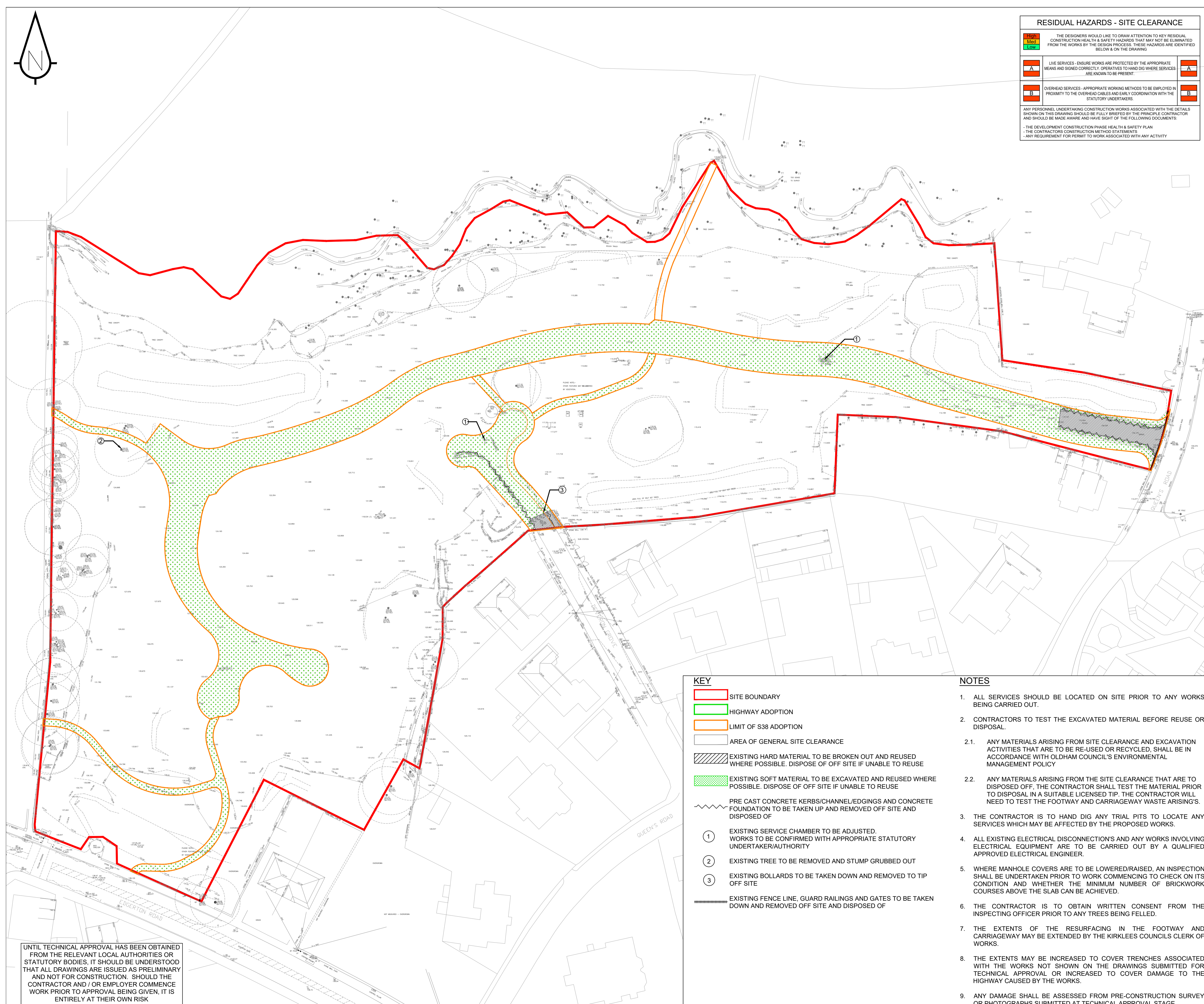

KEY	
[Red line]	SITE BOUNDARY
[Green dotted area]	HIGHWAY ADOPTION
[Orange line]	LIMIT OF S38 ADOPTION
[White area]	AREA OF GENERAL SITE CLEARANCE
[Hatched area]	EXISTING HARD MATERIAL TO BE BROKEN OUT AND REUSED WHERE POSSIBLE. DISPOSE OF OFF SITE IF UNABLE TO REUSE
[Green dotted area]	EXISTING SOFT MATERIAL TO BE EXCAVATED AND REUSED WHERE POSSIBLE. DISPOSE OF OFF SITE IF UNABLE TO REUSE
[Wavy line]	PRE CAST CONCRETE KERBS/CHANNEL/EDGINGS AND CONCRETE FOUNDATION TO BE TAKEN UP AND REMOVED OFF SITE AND DISPOSED OF
①	EXISTING SERVICE CHAMBER TO BE ADJUSTED. WORKS TO BE CONFIRMED WITH APPROPRIATE STATUTORY UNDERTAKER/AUTHORITY
②	EXISTING TREE TO BE REMOVED AND STUMP GRUBBED OUT
③	EXISTING BOLLARDS TO BE TAKEN DOWN AND REMOVED TO TIP OFF SITE
[Dashed line]	EXISTING FENCE LINE, GUARD RAILINGS AND GATES TO BE TAKEN DOWN AND REMOVED OFF SITE AND DISPOSED OF

- NOTES**
- ALL SERVICES SHOULD BE LOCATED ON SITE PRIOR TO ANY WORKS BEING CARRIED OUT.
  - CONTRACTORS TO TEST THE EXCAVATED MATERIAL BEFORE REUSE OR DISPOSAL.
    - ANY MATERIALS ARISING FROM SITE CLEARANCE AND EXCAVATION ACTIVITIES THAT ARE TO BE RE-USED OR RECYCLED, SHALL BE IN ACCORDANCE WITH OLDHAM COUNCIL'S ENVIRONMENTAL MANAGEMENT POLICY
    - ANY MATERIALS ARISING FROM THE SITE CLEARANCE THAT ARE TO BE DISPOSED OFF, THE CONTRACTOR SHALL TEST THE MATERIAL PRIOR TO DISPOSAL IN A SUITABLE LICENSED TIP. THE CONTRACTOR WILL NEED TO TEST THE FOOTWAY AND CARRIAGEWAY WASTE ARISING'S.
  - THE CONTRACTOR IS TO HAND DIG ANY TRIAL PITS TO LOCATE ANY SERVICES WHICH MAY BE AFFECTED BY THE PROPOSED WORKS.
  - ALL EXISTING ELECTRICAL DISCONNECTIONS AND ANY WORKS INVOLVING ELECTRICAL EQUIPMENT ARE TO BE CARRIED OUT BY A QUALIFIED APPROVED ELECTRICAL ENGINEER.
  - WHERE MANHOLE COVERS ARE TO BE LOWERED/RAISED, AN INSPECTION SHALL BE UNDERTAKEN PRIOR TO WORK COMMENCING TO CHECK ON ITS CONDITION AND WHETHER THE MINIMUM NUMBER OF BRICKWORK COURSES ABOVE THE SLAB CAN BE ACHIEVED.
  - THE CONTRACTOR IS TO OBTAIN WRITTEN CONSENT FROM THE INSPECTING OFFICER PRIOR TO ANY TREES BEING FELLED.
  - THE EXTENTS OF THE RESURFACING IN THE FOOTWAY AND CARRIAGEWAY MAY BE EXTENDED BY THE KIRKLEES COUNCILS CLERK OF WORKS.
  - THE EXTENTS MAY BE INCREASED TO COVER TRENCHES ASSOCIATED WITH THE WORKS NOT SHOWN ON THE DRAWINGS SUBMITTED FOR TECHNICAL APPROVAL OR INCREASED TO COVER DAMAGE TO THE HIGHWAY CAUSED BY THE WORKS.
  - ANY DAMAGE SHALL BE ASSESSED FROM PRE-CONSTRUCTION SURVEY OR PHOTOGRAPHS SUBMITTED AT TECHNICAL APPROVAL STAGE.

UNTIL TECHNICAL APPROVAL HAS BEEN OBTAINED FROM THE RELEVANT LOCAL AUTHORITIES OR STATUTORY BODIES, IT SHOULD BE UNDERSTOOD THAT ALL DRAWINGS ARE ISSUED AS PRELIMINARY AND NOT FOR CONSTRUCTION. SHOULD THE CONTRACTOR AND / OR EMPLOYER COMMENCE WORK PRIOR TO APPROVAL BEING GIVEN, IT IS ENTIRELY AT THEIR OWN RISK

P01	FIRST ISSUE	TOD	10/01/2025	TC
Rev	Amendment	Drawn	Date	Checked
Drawing Status				
S5 - FOR APPROVAL				

**sanderson**  
associates  
consulting engineers

Highways | Traffic | Transportation | Water

T 01924 844080 mail@sandersonassociates.co.uk  
www.sandersonassociates.co.uk

Client  
**JONES HOMES (YORKSHIRE) LTD**

Project Title  
**SECTION 38  
CLAYTON FIELDS**

Drawing Title  
**SITE CLEARANCE**

Scale	Drawing Size	Drawn By	Checked By
1:500	A1	TOD	TC
Project Number	Date	Approved By	
163366	December 24	DB	
Drawing Number	Rev		
163366-SAN-CLF-XX-DR-C-02_001	P01		