



GROUND FLOOR PLAN (86 persons)

PURCHASE LEDGER 20
 CREDIT SERVICES 24
 FACILITIES / MARKETING 8
 I.T - 34

WORKS TO FORM :- PURCHASE LEDGER / FACILITIES & MARKETING

- REMOVE ALL COMMS EQUIPMENT BY SPECIALIST
- REMOVE EXTINGUISHMENT FOAM BY SPECIALIST
- REMOVE DOUBLE DOORS INTO WAREHOUSE AND BLOCK UP OPENING
- DATA CENTRE FALSE FLOOR TO BE STRENGTHENED (BY SPECIALIST) CIRCA 400MM VOID
- REMOVE WALL BETWEEN DATA ROOMS
- PROVIDE CARPET TILES TO MATCH I.T. DEPT
- AIR CONDITIONING (WARM AND COLD AIR, REUSE EXISTING UNITS IF POSSIBLE)
- NEW SUSPENDED CEILING
- ADDITIONAL LED LIGHTING
- NEW MEETING ROOM IN FORMER BRIDGE ROOM.
- POWER AND DATA IN DADO TRUNKING TO PERIMETER.
- FULL DECORATION
- BREAK THROUGH EXTERNAL WALL AND FORM 4 No WINDOWS
- MECHANICAL VENTILATION IN EXTERNAL WALL
- CHECK FLAT ROOF HAS NO LEAKS / OVERLAY ?
- NEW RECTANGULAR DESKS 1400 X 800
- FORM NEW I.T MEETING ROOM IN FORMER BRIDGE ROOM
- PROVIDE NEW SMALL I.T MEETING ROOM
- REMOVE CCTV
- NEW SUSPENDED CEILING
- FORM OPENING IN I.T WALL AND PROVIDE NEW DOUBLE DOORS (FD60S WITH VP)
- PROVIDE STARK / MURAL VISUALS
- REMOVE EXTERNAL GENERATOR (LOCATION TO BE AGREED)
- PROVIDE 1 No SOUNDBOX ACOUSTIC SINGLE PERSON POD. (POWER REQUIRED NO DATA)

WORKS TO FORM :- CREDIT SERVICES

- NEW MEETING ROOM.
- NEW 1400 X 800 RECTANGULAR DESKS
- PROVIDE STARK / MURAL VISUALS
- PROVIDE 1 No SOUNDBOX ACOUSTIC SINGLE PERSON POD
- (POWER REQUIRED NO DATA)

WORKS TO FORM :- WELFARE AREA

- REMOVE PARTIAL KITCHEN UNITS AND BREAK THRO WALL BETWEEN FEMALE TOILET AND KITCHEN AREA AND FORM OPENING FOR CUBICLE DOOR.
- FORM ADDITIONAL FEMALE WC.
- ADJUST KITCHEN WORKTOP AND UNITS .RELOCATE WATER HEATER
- REMOVE KITCHEN WALL BETWEEN KITCHEN AND OFFICE.
- CONSTRUCT NEW WALLS / WINDOWS TO INCREASE BREAKOUT SPACE.
- PROVIDE MECHANICAL VENTILATION

WORKS TO :- I.T DEPT

- NEW 1400 X 800 RECTANGULAR DESKS
- NEW COMMS UNITS WITHIN SUB STATION
- LESSABLED (CHECK IF 2 No BASINS - MAY NEED ADDITIONAL TO CONFORM TO UNISEX STANDARDS)
- REMOVE ALL SECURITY GRILLES (MAJORITY DONT WORK)

WORKS TO :- WAREHOUSE

- 2 No PALLET RACKS (2.4 AND 3M LENGTHS , LIMITED HEIGHT APP 2.5M)

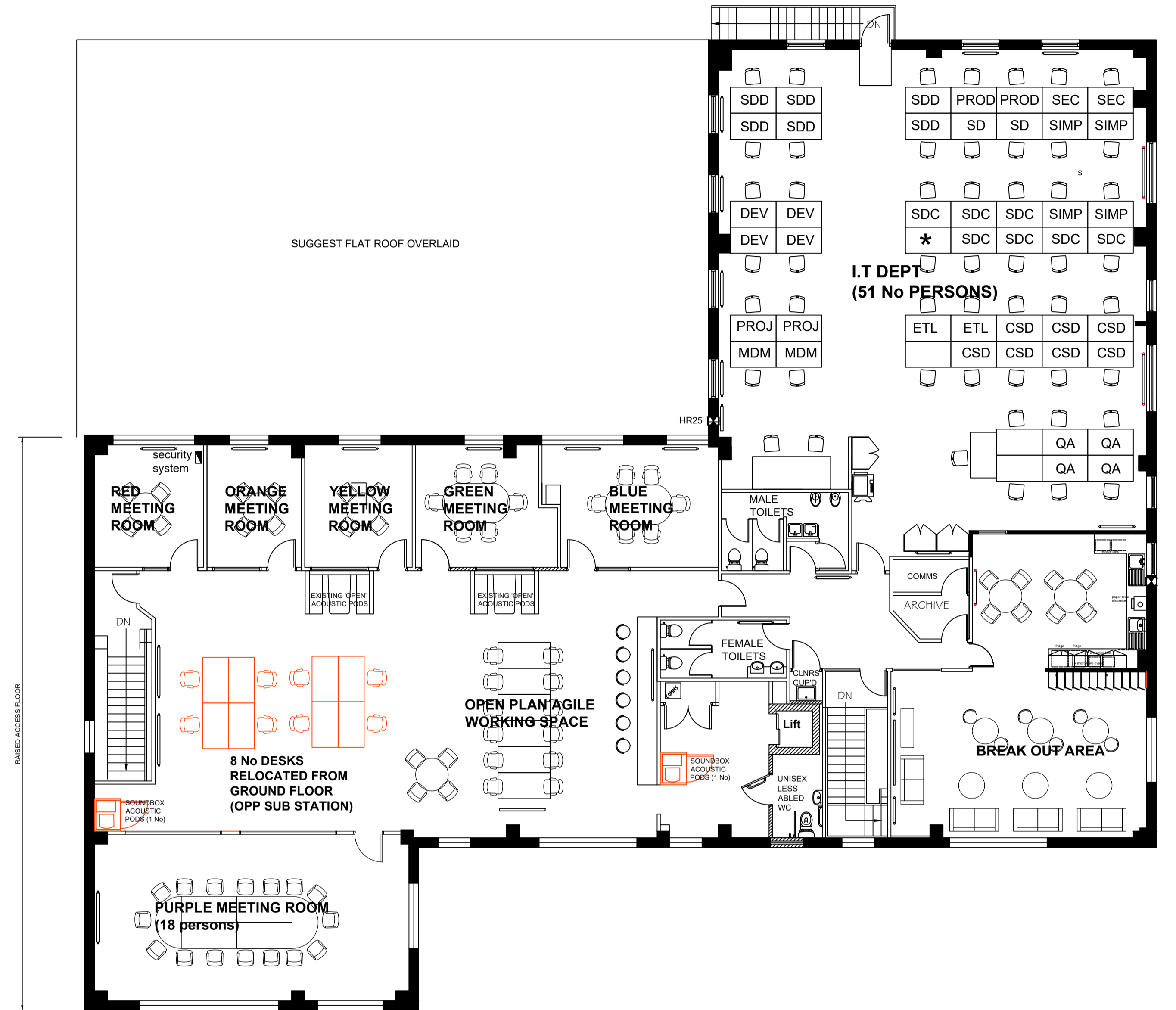

FIRST FLOOR PLAN (67 persons)

I.T - 59 PERSONS
 WORKSPACE DESKS - 8 PERSONS

WORKS TO FIRST FLOOR

- PROVIDE 2 No SOUNDBOX ACOUSTIC SINGLE OCCUPANCY 'MEETING PODS'
- PROVIDE 8 No DESKS FROM GROUND FLOOR

Ground Floor TOILET Nos (cater for 81 persons)

MALE (max 45)
 2 WC
 2 URINALS
 2 BASINS
 1 SHOWER
FEMALE (max 30)
 3 WC
 2 BASINS
 1 SHOWER
UNISEX / LESSABLED (max 6)
 1 DOC M PACK

First Floor TOILET Nos (cater for 66 persons)

MALE (max 45)
 2 WC
 2 URINALS
 2 BASINS
FEMALE (max 15)
 2 WC
 2 BASINS
UNISEX / LESSABLED (max 6)
 1 DOC M PACK

Combined TOILET Nos (cater for 160 persons)

MALE (max 100)
 5 WC
 4 URINALS
 5 BASINS
 1 SHOWER
FEMALE (max 60)
 6 WC
 5 BASINS
 1 SHOWER
UNISEX / LESSABLED (inc in above)
 1 DOC M PACK

GROUND FLOOR 874M²/9407FT²
FIRST FLOOR 673M²/7245FT²

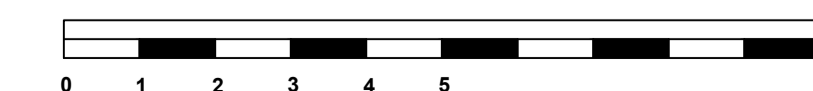

REV 'A' LIGHTWEIGHT STORAGE/RACKING IN PRINT ROOM TO BE RELOCATED WITHIN WAREHOUSE . CCTV ALSO TO BE RELOCATED INTO WAREHOUSE 03-02-25



STARK Building Materials UK Limited
 Development Team, 1st Floor, Parkview House, Woodvale Road, Brighouse, HD6 4AB

GROUND AND FIRST FLOOR OFFICE - SCHEME A

RELIANCE HOUSE HUDDERSFIELD

BRANCH:	HUDDERSFIELD
	RELIANCE HOUSE
	LEEDS ROAD
	HUDDERSFIELD
BRANCH No:	...
DATE:	06-01-25
SCALE:	1:100@A1
DRAWN BY:	M.L
DRAWING No:	HRH043A