

Notes

Do not scale from drawing, use figured dimensions only.
 All dimensions must be checked and verified on site prior to commencement of work and Architect to be notified of any discrepancies.
 This drawing is intended to permit overall scheme proposals only and cannot be used for construction purposes without further information.

Rev	Description	Drawn	Date
A	Updated, Site info added	MJN	15.01.25



South Elevation - 1:100



East (Front) Elevation - 1:100



North Elevation - 1:100



West Elevation - 1:100



Proposed Ground Floor Plan - 1:100

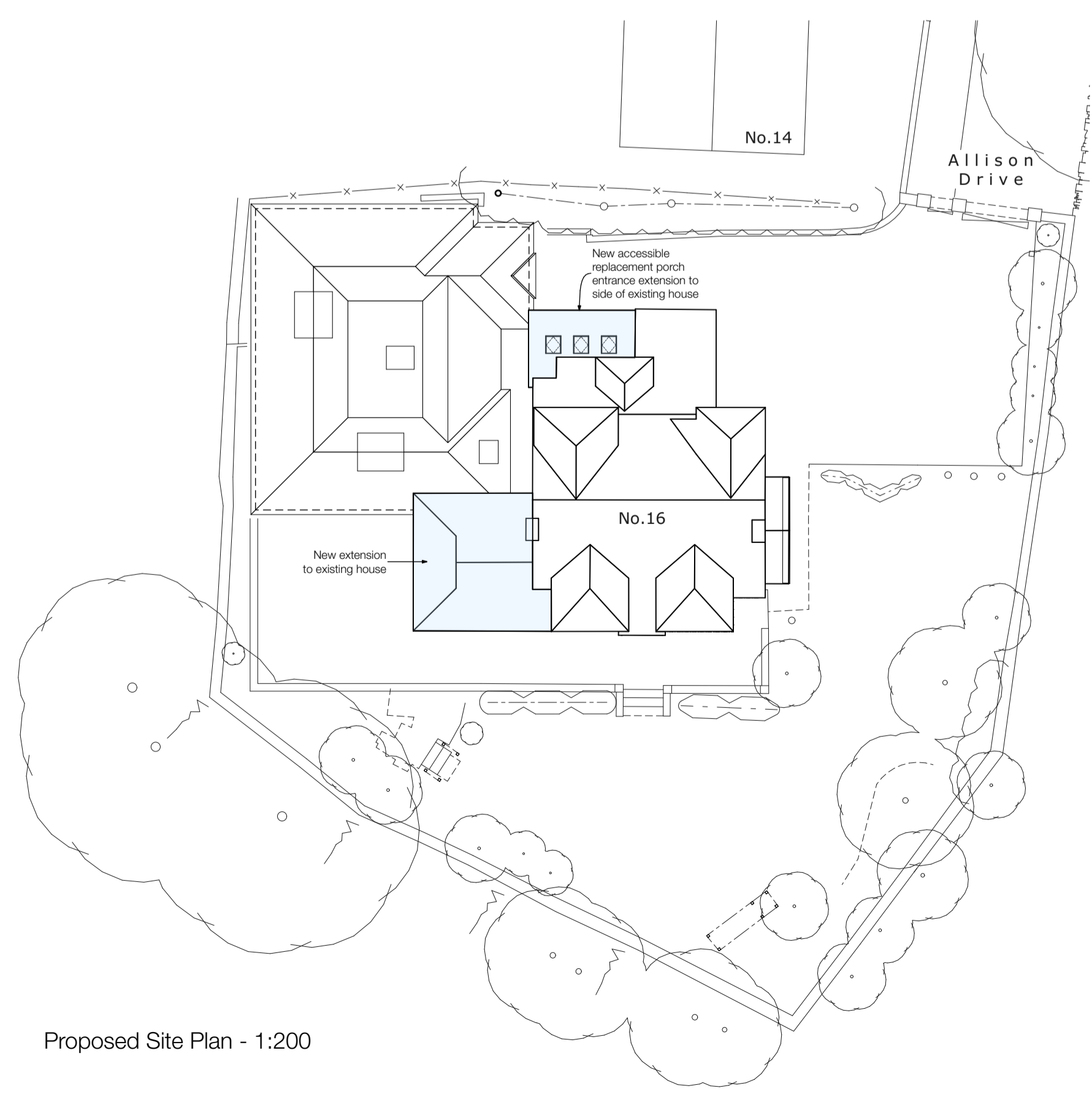

Proposed Site Plan - 1:200

Project Description Proposed Rear Extension & Self Contained Annexe	
Site Address 16 Allison Drive, Fixby, Huddersfield, HD22RA	
Client Mr A Ali	Company AD
Status Planning	
Drawing Proposed Plans and Elevations	Scale @ A1 1:100, 1:200
Date December 2024	Drawn / Checked MJN
Drawing No. 3461 (0-) 07	Revision A

ONE17
 ARCHITECTS & INTERIOR DESIGNERS

The Dyehouse, Armitage Bridge
 Huddersfield, West Yorkshire HD4 7PD
 T 01484 668 000 F 01484 668 001
 E solutions@one17design.com

ONE17DESIGN.COM