

Station Easting Northing Level
 ST01 411095.532 419577.700 135.750
 ST02 411073.077 419564.738 137.854

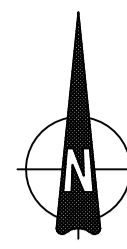

LEGEND	
	Foul Drainage
	Surface Drainage
	Combined Drainage
	Electricity
	Electricity High Voltage
	Electricity Low Voltage
	Gas
	Ground Probing Radar
	Water
	Cable Television
	Close Circuit Television
	Communication
	British Telecom
	Compressed Air
	Offset Fill-Line
	Oil Pipe
	Pipe
	Ventilation
	Fuel Line
	Vapour Recovery
	Gauge Line
	Telemetry
	Fibre Optics
	Unknown
	Fence
	Edge of Canopy
	Gully Run
	Electricity (TFR) Taken From Records
	BT (TFR) Taken From Records
	Gas (TFR) Taken From Records
	Water (TFR) Taken From Records
	End Of Trace
	Do Not Drill / Banded Pipes
	T TANK* - W=Water U=Unknown
	Borehole
	Trial Pit Location
	Excavated Area
	Window Sample
	Soil Vapour Sample

ABBREVIATIONS			
AR	Assumed Route	MW	Monitoring Well
BO	Bollard	NPV	No Pipes Visible
BOILL	Illuminated Bollard	OH	Overhead Service
BH	Borehole	OSA	Off Survey Area
BTB	British Telecom Box	OSBM	Ordnance Survey Bench Mark
BTC	British Telecom Cover	PR	Pipe Riser
C/BOX	Control Box	P	Post
C/B FENCE	Closeboard Fence	P&R FENCE	Post & Rail Fence
CR	Cable Riser	RET WALL	Retaining Wall
CATV	Cable TV	RWP	Rain Water Pipe
CP	Catch Pit	RS	Road Sign
Co	Concrete	RE	Roading Eye
CON	Conifer	S/A	Soakaway
CL	Cover Level	S/BIRCH	Silver Birch
d	Depth (in metres)	SAP	Sapling
D/CHAN	Drainage Channel	SEC FENCE	Security Fence
DP	Down Pipe	SL	Spot Light
ER	Earth Road	SP	Soil Pipe
EIC	Electricity IC	ST	Stop Tap
EP	Electricity Pole	SV	Sluice Valve
ECC	Edge of Canopy	SVP	Soil Vent Pipe
EOT	End of Trace	SVS	Soil Vapour Sample
F/BED	Flower Bed	TBM	Temporary Bench Mark
FH	Fire Hydrant	TFR	Taken From Records
FS	Fire Switch	TL	Traffic Light
GV	Gas Valve	TP	Telegraph Pole
G	Gully	TS	Traffic Sensor
GPR	Ground Probing Radar	UTL	Unable to Locate
GRUN	Gully Run	UTR	Unable to Raise
HT	Height	UTS	Unable to Survey
H/CHESTNUT	Horse Chestnut	UTT	Unable to Trace
H/HORN	Hawthorn	VR	Vapour Recovery
IC	Inspection Cover	VP	Vent Pipe
IL	Invert Level	WM	Water Meter
INT	Interceptor	WFC	Water Filled Chamber
KO	Kerb Outlet	WP	Waste Pipe
LP	Lamp Post	WR	Water Riser
LC	Lighting Column	WS	Window Sample
LH	Lamp Hole	U/S	Underside
MH	Manhole Cover	Ø	Pipe Diameter

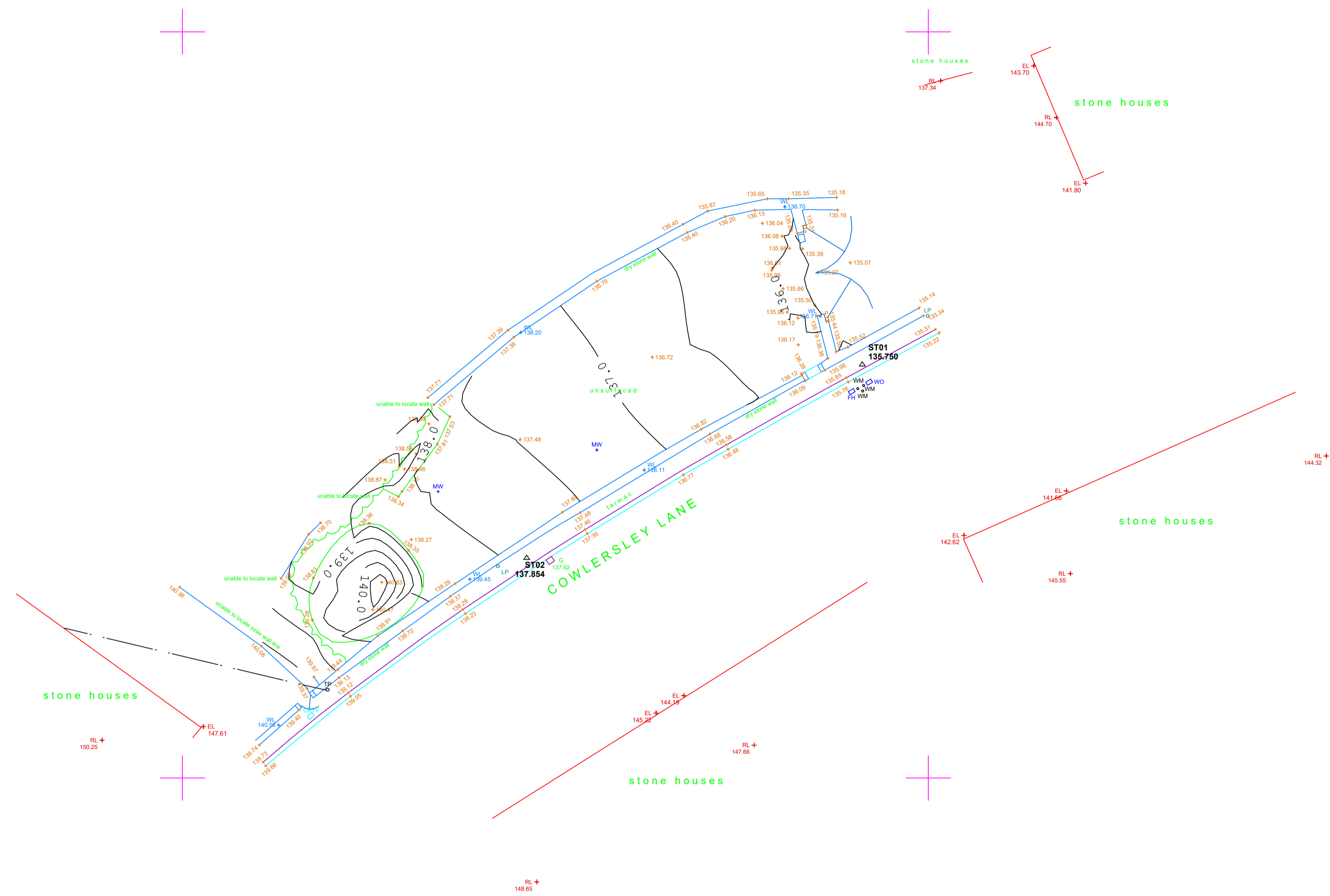

32 Doncaster Road, Burnley, South Yorkshire, S70 1TL.
 Tel: 01226 292 377 Mobile: 07969 560287
 E-Mail: scott@avoinsurveys.com & info@avoinsurveys.com
 Website: www.avoinsurveys.com

Client
Rogers

Site Location
**Cowlersley Lane
 Huddersfield
 HD4 5TY**

Surveyed by JA	Drawn by JA	Approved by
Drawing No. 0724-ROG-11076	Date 18-07-2024	Revision
Scale 1:200@ A1		Sheet No. 1 of 1

DISCLAIMER: The location of under ground services shown on this drawing has been determined using electro-magnetic (and/or ground probing radar, where requested) techniques and visual observations. The limitations of this drawing should be realised and no guarantee can be given that all services have been identified. This drawing may not include the location of all public services that may cross the site and therefore the relevant service drawings should be obtained from the appropriate utility company and used in conjunction with this drawing. Additional services, structures or other below ground obstructions not indicated on this drawing may be present on site. reference should be made to historical plans and as built drawings. Excavations in the vicinity of services should be carried out with due diligence ref: HSG47 document "avoiding dangers from underground services". Location accuracy is determined by referring to manufacturers guidelines for the systems deployed. Reference should be made to the latest version of AMS Ltd site procedures document for utility location surveys Please note ground penetrating radar depths are approximate only.