

CALDER ROAD

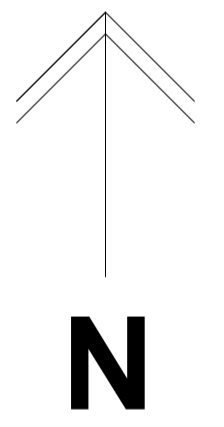
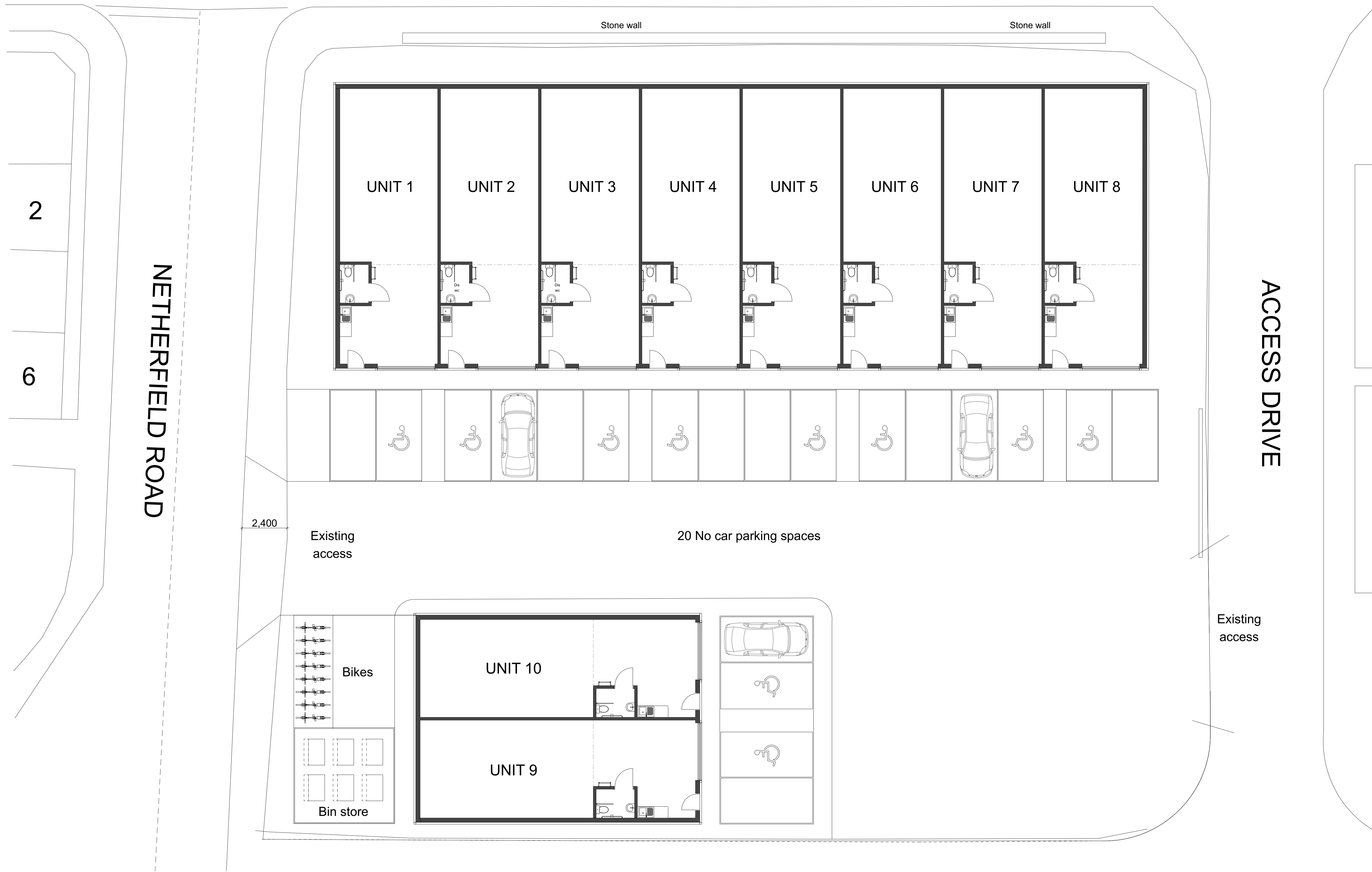

01 Proposed block plan
Scale 1:100

STUDIO H78
ARCHITECTURAL DESIGN

Address: 2 Medlock Road Sheffield S13 9AY
Telephone: 07890261186
Email: michael@studioh78.com

Project
Unit 1, Netherfield Mills,
Calder Road, Dewsbury

Client
Mr Hassan Marden

Proposed BlockPlan

Scale	Date	Drawn	Checked
1:100	16.11.24	MH	

Job No.	Category/Draw No.	Revision
1070	(90)002	

DESIGN