

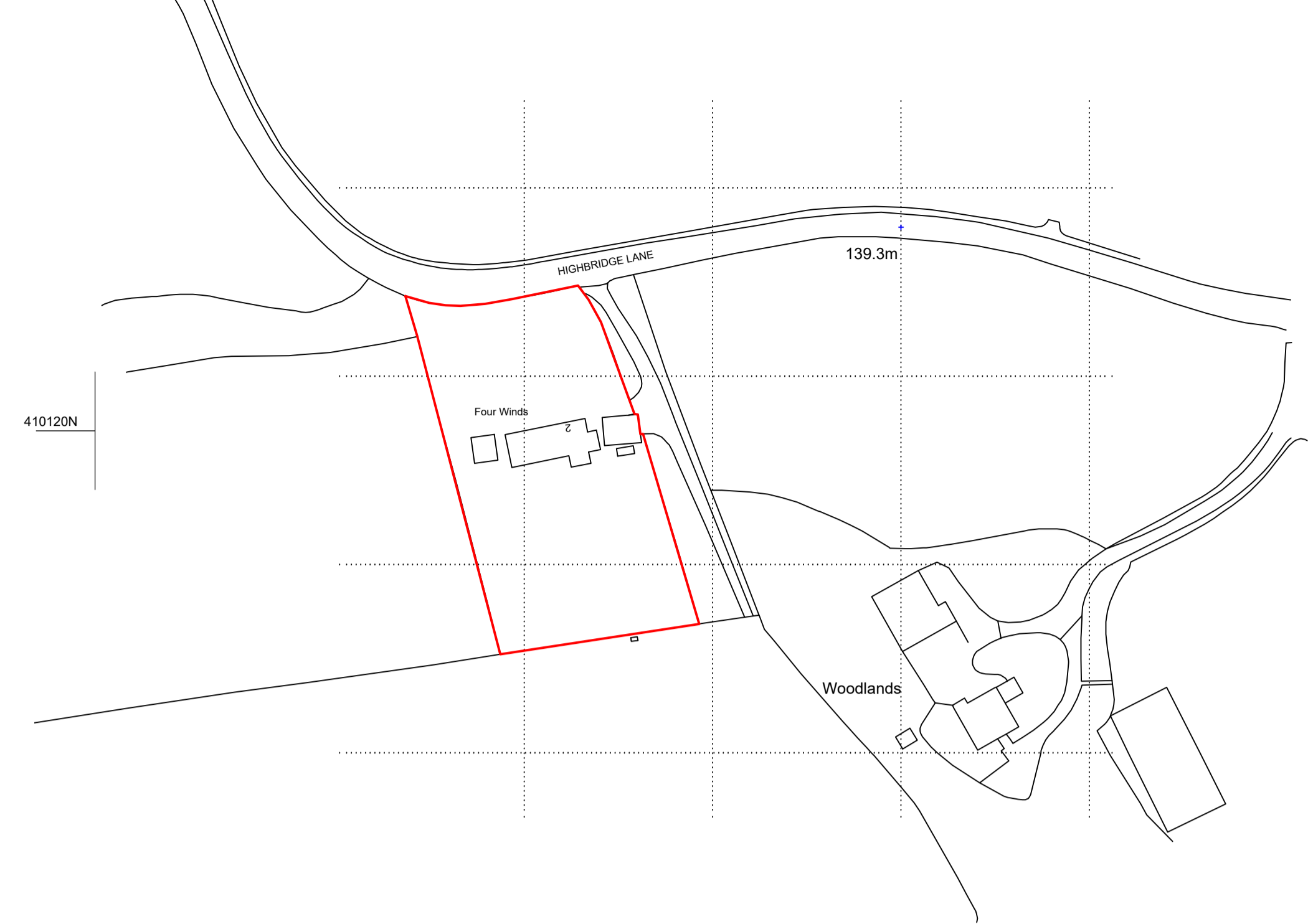

Station	Easting	Northing	Level
S1	424231.813	410108.664	147.335
S2	424233.938	410128.764	147.231
S3	424211.688	410133.985	148.647
S4	424266.532	410133.070	144.037
S5	424277.355	410115.295	145.083
S6	424287.212	410093.308	147.390
S7	424270.627	410088.792	148.377
S8	424274.027	410062.319	148.594
S9	424248.260	410088.599	148.810
S10	424284.823	410045.467	148.896
S11	424268.889	410038.624	150.219
S12	424249.045	410044.470	150.918
S13	424249.429	410063.839	149.696
S14	424233.897	410072.840	150.013
S15	424232.337	410096.904	148.080
S16	424253.894	410111.046	145.614
S20	424297.140	410061.873	148.504

site block plan - 1:200

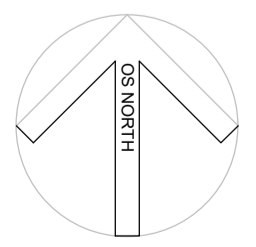

site location plan - 1:1250

410080N

410040N

This drawing has been prepared specifically for the purpose of obtaining Planning Permission and/or Building Regulation Approval. Its suitability for other purposes, without supplementary details and specifications cannot be guaranteed. The Permissions and/or Approvals are beyond the Architects control, and no guarantee that such will be granted is given or to be inferred by reason of the preparation of this drawing.

Only figured dimensions are to be used. All dimensions to be checked on site. This drawing together with the design is the property and copyright of the Architect and must not be reproduced without prior written permission.

P01 Drawing originated 14.10.24 JW NG
 rev. description date draw. appd



project Roof and window alterations

at
 Four Winds, 2 Highbridge Lane,
 Scissett, Huddersfield, HD8 9JY
 for
 Nick and Kate Hepworth

title Site Block & Location Plan
 number 22014D-12-P01
 scale 1:200 / 1:1250
 size A1