

Notes

Do not scale from drawing, use figured dimensions only.
 All dimensions must be checked and verified on site prior to commencement of work and Architect to be notified of any discrepancies.
 This drawing is intended to permit overall scheme proposals only and cannot be used for construction purposes without further information.

Rev	Description	Drawn	Date
•	Drawing created.	KA	25.03.25

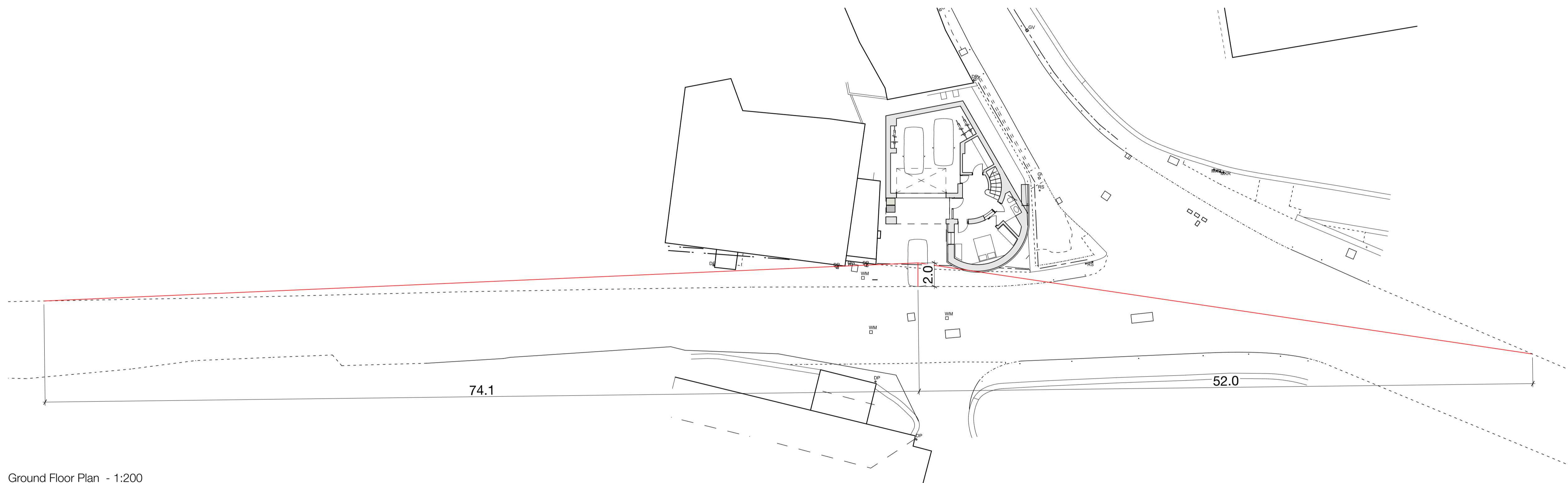

Ground Floor Plan - 1:200

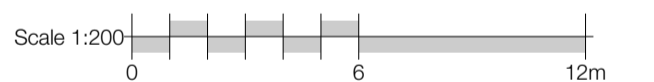
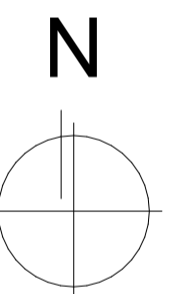

Speed	Kilometres per hour	16	20	24	25	30	32	40	45	48	50	60
	Miles per hour	10	12	15	16	19	20	25	28	30	31	37
SSD (metres)	9	12	15	16	20	22	31	36	40	43	56	
SSD adjusted for bonnet length. See 7.6.4	11	14	17	18	23	25	33	39	43	45	59	

Extract from the Kirklees Highway Design Guide

10.5.8 A minimum X distance of 2m may be considered in some slow-speed situations when flows on the minor arm are low, but using this value will mean that the front of some vehicles will protrude slightly into the running carriageway of the major arm, and many drivers will tend to cautiously nose out into traffic. The ability of drivers and cyclists to see this overhang from a reasonable distance, and to manoeuvre around it without undue difficulty, should be considered. This also applies in lightly-trafficked rural lanes.

Extract from Manual For Streets 2

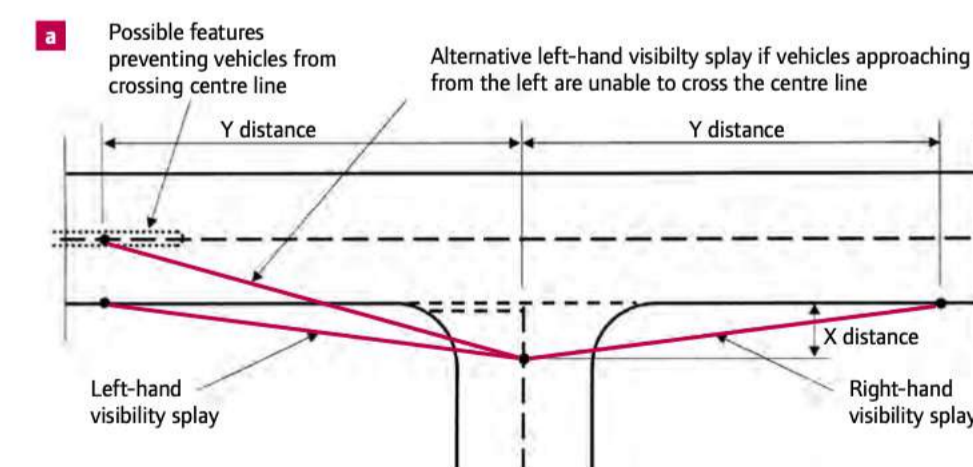

Extract from Manual For Streets 2

Client
 Mr I Masterson

Site Address
 Building Plot, Nabbs Lane, Slaithwaite, Huddersfield, HD7 5AU

Project Description
 New Dwelling

Status
 Planning

Date March 2025
Drawn KA
Checked

Drawing Visibility Splays	Scale # A1 1:200
Drawing No. 3594 (0-) 11	Revision -

ONE17
 DESIGN

THE DYEHOUSE, ARMITAGE BRIDGE
 HUDDERSFIELD, WEST YORKS HD4 7PD
 T 01484 448000 E SOLUTIONS@ONE17DESIGN.COM
 ONE17DESIGN.COM