

Notes

Do not scale from drawing, use figured dimensions only.
 All dimensions must be checked and verified on site prior to commencement of work and architect to be notified of any discrepancies.
 This drawing is intended to permit overall scheme proposals only and cannot be used for construction purposes without further information.

Rev	Drawn	Checked	Date
A	Updated	MUN	18.09.24

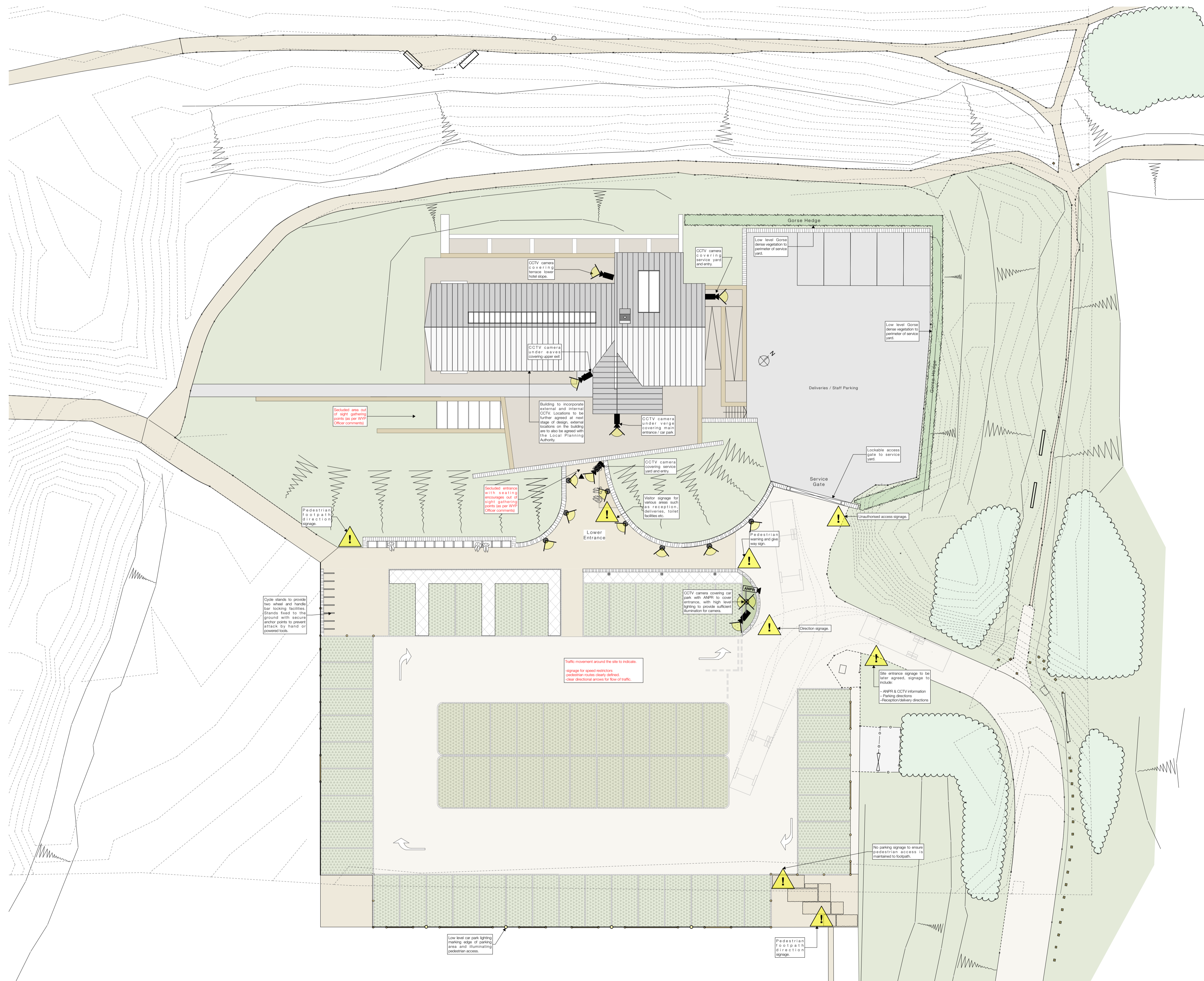

Site Plan Key:

CCTV Camera:
 Full CCTV system to provide coverage of car park and monument, capable of being monitored from each individual unit (subject to formal monitoring agreement). Cameras protected within a vandal resistant housing.

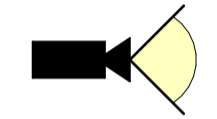

ANPR Camera:
 Camera positioned above ground level to prevent interference from individuals.



Site Signage:
 Displayed around the car park and vehicular and pedestrian access to the site.



External Lighting:
 External street and car park lighting to BS5489-2013 standard. Low energy photoelectric cell, dusk until dawn lighting or similar installed above building access doors. Fittings and wiring are to be vandal resistant, located within inaccessible positions. High and low level lighting as indicated.

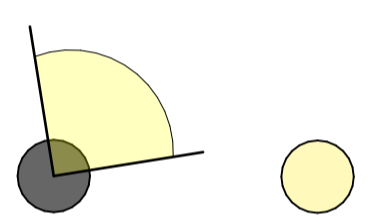

External Landscaping:
 Low level dense hedging/shrubberies to aid in deterring crime, not exceeding 1m in height and are to be maintained as part of the site management plan.

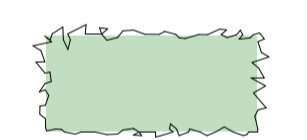

Job Title Castle Hill Visitor Centre, Huddersfield	
Client The Thandi Partnership	
Status Planning	Company AD
Drawing Crime Prevention	Scale @ A1 1:200, 1:500
Date December 2022	Drawn JS
Checked	
Drawing No. 3267 (SK) 111	Revision A

ONE17
 ARCHITECTS & INTERIOR DESIGNERS

The Dyehouse, Armitage Bridge
 Huddersfield, West Yorkshire HD4 7PD
 T 01484 668 000 F 01484 668 001
 E solutions@one17design.com

ONE17DESIGN.COM