

1:250 INSET TO SHOW NATIVE HEDGE



- Native Hedge Mix (5/lin m double)
- 11nr Acer campestre
 - 11nr Corylus avellana
 - 115nr Crataegus monogyna
 - 23nr Ilex aquifolium
 - 34nr Ligustrum vulgare
 - 11nr Rosa canina
 - 23nr Sambucus nigra

- Native Hedge Mix (5/lin m double)
- 24nr Acer campestre
 - 24nr Corylus avellana
 - 236nr Crataegus monogyna
 - 47nr Ilex aquifolium
 - 71nr Ligustrum vulgare
 - 24nr Rosa canina
 - 47nr Sambucus nigra

- Native Shrub Mix 8 species (0.75ctr)
- 31nr Cornus sanguinea
 - 41nr Crataegus monogyna
 - 31nr Hedera helix
 - 31nr Ilex aquifolium
 - 10nr Lonicera periclymenum
 - 20nr Rosa arvensis
 - 10nr Sambucus nigra
 - 31nr Viburnum opulus

- Marginals Mix (7m2)
- 146nr Caltha palustris
 - 295nr Eleocharis palustris
 - 148nr Iris pseudacorus
 - 148nr Juncus conglomeratus
 - 295nr Juncus effusus
 - 148nr Lychnis flos-cuculi
 - 148nr Lythrum salicaria
 - 148nr Mentha aquatica

- Native Shrub Mix 8 species (0.75ctr)
- 61nr Cornus sanguinea
 - 82nr Crataegus monogyna
 - 61nr Hedera helix
 - 61nr Ilex aquifolium
 - 20nr Lonicera periclymenum
 - 41nr Rosa arvensis
 - 20nr Sambucus nigra
 - 61nr Viburnum opulus

- Marginals Mix (7m2)
- 68nr Caltha palustris
 - 137nr Eleocharis palustris
 - 68nr Iris pseudacorus
 - 68nr Juncus conglomeratus
 - 137nr Juncus effusus
 - 68nr Lychnis flos-cuculi
 - 68nr Lythrum salicaria
 - 68nr Mentha aquatica

- Native Shrub Mix 8 species (0.75ctr)
- 36nr Cornus sanguinea
 - 49nr Crataegus monogyna
 - 36nr Hedera helix
 - 36nr Ilex aquifolium
 - 12nr Lonicera periclymenum
 - 24nr Rosa arvensis
 - 12nr Sambucus nigra
 - 36nr Viburnum opulus

KEY

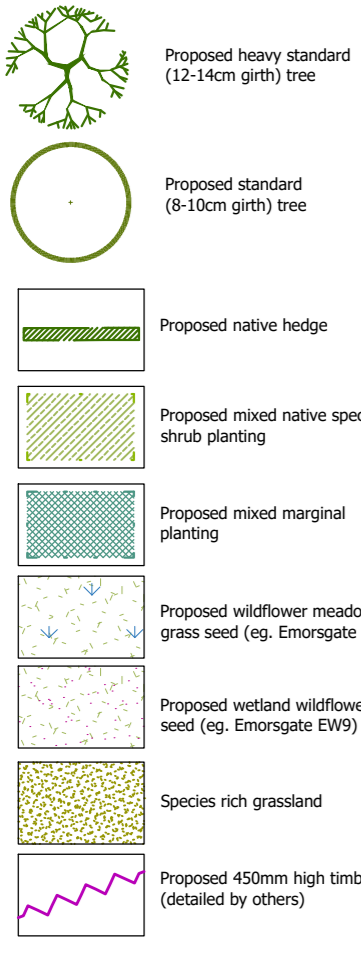

PLANTING DETAILS AND SCHEDULES

NATIVE SPECIES HEDGEROW

NATIVE HEDGE SCHEDULE						
Nr	Name	Height/cm	Age	Root	Pot/L	
35	Acer campestre	60-80cm	1u1	BR	BR	
35	Corylus avellana	40-50cm	1/0	BR	BR	
351	Crataegus monogyna	40-50cm	1u1	BR	BR	
70	Ilex aquifolium	50-60cm		C	2L	
105	Ligustrum vulgare	50-60cm	0/1	RB	BR	
35	Rosa canina	50-60cm	1/1	BR	BR	
70	Sambucus nigra	60-80cm	1/1	BR	BR	

Hedge to be planted in a previously prepared trench, 500mm wide and 450mm deep backfilled with a 3:1 mix of multipurpose topsoil to BS3882:2007 and planting compost. Bareroot transplants to be dipped in a suitable mycorrhizal dip before planting. Plants to be planted in a double staggered row, 300-350mm wide, at 5nr plants per linear metre with species planted randomly throughout in groups of 7 to 30 of a single species. The hedge lines shall be mulched after planting with forest mulch to a uniform depth of 50mm. Where the hedge is to be planted within 10 metres of any house the hawthorn (Crataegus monogyna) shall be excluded from the mix.

MARGINAL PLANTING

MARGINALS MIX SCHEDULE			
Nr	Name	Root	Pot/L
216	Caltha palustris	Ce	5cm(0.2L)
432	Eleocharis palustris	Ce	5cm(0.2L)
216	Iris pseudacorus	Ce	5cm(0.2L)
216	Juncus conglomeratus	Ce	5cm(0.2L)
432	Juncus effusus	Ce	5cm(0.2L)
216	Lychnis flos-cuculi	Ce	5cm(0.2L)
216	Lythrum salicaria	Ce	5cm(0.2L)
216	Mentha aquatica	Ce	5cm(0.2L)

Shallow basin and swale margins are to be planted with a mix of adaptable wetland species which will be tolerant of changing water regimes and various depths and durations of inundation. These are to be planted as plug plants in irregular groupings of between 7 and 21 of a single species at spacings of between 100-300mm, with an average density of 7 plugs per m². Typha latifolia has not been included within the schedule as this species can become invasive and is likely to colonise.

NATIVE SPECIES SHRUB PLANTING

NATIVE SHRUB MIX SCHEDULE					
Nr	Name	Height/cm	Age	Root	Pot/L
128	Cornus sanguinea	40-60cm	1/1	B	B
172	Crataegus monogyna	40-60cm	1/1	B	B
128	Hedera helix	40-60cm		C	2L
128	Ilex aquifolium	60-80cm		C	3L
42	Lonicera periclymenum	60-80cm		C	3L
85	Rosa arvensis	30-40cm		B	B
42	Sambucus nigra	60-80cm	1/1	B	B
128	Viburnum opulus	40-60cm	1/1	B	B

Native species shall be planted into 450mm depth, good quality clean topsoil incorporating organic compost and slow release fertiliser, over un-compacted sub-grade. Prior to planting all bareroot plant stock shall be dipped into a suitable mycorrhizal plant dip in accordance with the manufacturers recommendations. Plants shall be planted in groups of 3-11 of a single species with the taller growing species to the back of the areas of the areas and the lower growing species to the edges of the areas. Planted areas to be mulched after planting with coarse grade forest mulch to a uniform depth of 50mm.

GRASS SEEDING

MEADOW AND SPECIES RICH GRASS SEEDING

A variety of grassland habitats will be created incorporating species to attract locally important species and enhance the biodiversity of the site. Where appropriate the seeds should be of local provenance and locally sourced but based on the mixed specified below:
SPECIES RICH GRASS (Emorsgate EL1 or similar approved)
 Mixture EL1 contains slow growing grasses with a selection of wild flowers that respond well to regular short mowing.
GENERAL WILDFLOWER MEADOW (Emorsgate EM2 or similar approved)
 EM2 standard meadow mix contains the core meadow wild flower species which grow across a wide range of soils, and is a good foundation mix for landscaping and habitat creation. This meadow mixture is designed to create flower rich grassland with a particular emphasis on species which are known to be important as sources of pollen and nectar for bees, butterflies, hoverflies and other insects.
SUDS BASIN (Emorsgate EGB or similar approved)
 EGB contains species suitable for seasonally wet soils and is based on the vegetation of traditional floodplain and water meadows. Soils in wet meadows may flood for short periods in winter, but are usually well drained in summer.

TREE SCHEDULE

SPECIES	Ht in m	NUMBERS REQUIRED	
		2.5-3.0	3.5-4.25
	Grnth in cm	8-10	12-14
Acer campestre (Ac)	3	-	-
Alnus glutinosa (Ag)	3	3	-
Betula pendula (Bp)	3	-	-
Carpinus betulus (Cb)	2	2	-
Malus sylvestris (Ms)	2	-	-
Quercus robur (Qr)	4	-	-
Sorbus aucuparia (Sau)	4	3	-

All trees to have clear stems to 1.8m above ground level with well developed branching heads with a single, central leader and healthy, fibrous root systems. Trees shall be either container grown or rootballed in accordance with season of planting. Trees shall be planted into pits of an appropriate size to accommodate the root system without restriction, backfilled with a 3:1 topsoil:compost mix and shall be secured to a machine rounded stake using 1 no. tree tie with rubber spacer. Finished height of stake shall not exceed 1/3 height of staked tree above ground. Foundation design of new buildings shall accommodate proposed tree planting in accordance with NHBC guidelines.

<p>Sue Farmer MALD LU Landscape Architect</p> <p>Westleigh Hall Wakefield Road Denby Dale Huddersfield HD8 8QJ telephone 01484 861611 fax 01484 861616 isdn 01484 866900 email info@fadandscape.co.uk www.fadandscape.co.uk</p>	client	Harron Homes
	project	Residential Development
		MERCHANTS FIELDS, CLECKHEATON
	drawing title	ATTENUATION BASIN PLANTING DETAILS
scale	date	drawn by
1:250	Oct 24	SF
@A1		R/1794/2