

Planting Schedule

Hedges				
Number	Species	Height	Pot Size	Specification
170	Carpinus betulus	40-60cm		Whip :BR :Plant and maintain as hedge at 1.2m height 0.5Ctr Double Staggered at 0.3m offset
187	Osmanthus burkwoodii	60-80cm	5L	Bushy :C :Plant and maintain as hedge at 1.2m height 0.25Ctr

Planting					
Number	Species	Height	Pot Size	Specification	Density
77	Achillea filipendulina 'Cloth of Gold'	20-30cm	2L	C	6/m ²
163	Alchemilla mollis	20-30cm	2L	C	5/m ²
178	Anemranthe lessoniana	20-30cm	2L	C	7/m ²
59	Astrantia major 'Ruby Wedding'	20-30cm	2L	C	7/m ²
94	Brunnera macrophylla 'Jack Frost'	10-20cm	2L	C	7/m ²
1992	Calamagrostis x acutiflora 'Karl Foerster'	40-60cm	5L	C	5/m ²
83	Cornus alba 'Elegantissima'	40-60cm	5L	Branched :C	3/m ²
34	Dryopteris erythrosora	40-60cm	3L	C	5/m ²
97	Dryopteris erythrosora 'Brilliance'	40-60cm	3L	C	5/m ²
217	Hebe rakaiensis	20-30cm	2L	Bushy :C	5/m ²
50	Helenium amarum	20-30cm	2L	C	7/m ²
128	Hemerocallis 'Crimson Pirate'	20-30cm	2L	C	7/m ²
46	Lamium maculatum 'White Nancy'	10-20cm	2L	C	7/m ²
1079	Pachysandra terminalis	10-20cm	2L	Bushy :C	7/m ²
133	Polypodium vulgare	20-30cm	2L	C	6/m ²
77	Polystichum polyblepharum	40-60cm	3L	C	5/m ²
366	Polystichum setiferum	40-60cm	3L	C	5/m ²
299	Sedum 'Autumn Joy'	20-30cm	2L	C	6/m ²
89	Tellima grandiflora	20-30cm	2L	C	7/m ²

rev	details	by	date
P01	First issue	JRD	23.02.2024

Notes

- Information shown on these drawings is not valid for Construction. Please refer to the status of the drawing in the Title and Issue box.
- Do not scale from this drawing. Use figured dimensions only where they are shown.
- Do not procure or manufacture materials, or undertake construction site works from this drawing unless the issue status is noted as 'for construction'.
- Any contractor that chooses to take forward this information for construction without full review process and sign-off does so at their own risk.
- All measurements are to be checked on site prior to construction.
- This drawing is to be read in conjunction with all other Gillespies drawings and specification and other consultants drawings as referred.
- Where any conflict or inconsistency occurs between drawing and specification information the Contractor is to immediately notify Gillespies prior to continuing working.
- Information to be read in coordination with Structural Engineer & M&E Engineer drawings & spec.
- Where any conflict or inconsistency occurs between Gillespies and Engineers drawing and specification information the Contractor is to immediately notify Gillespies prior to continuing working.
- Refer to drawing IR430301-GIL-ZZ-00-DR-L-410001 for Bulb and Tree Planting Plan

Location Plan

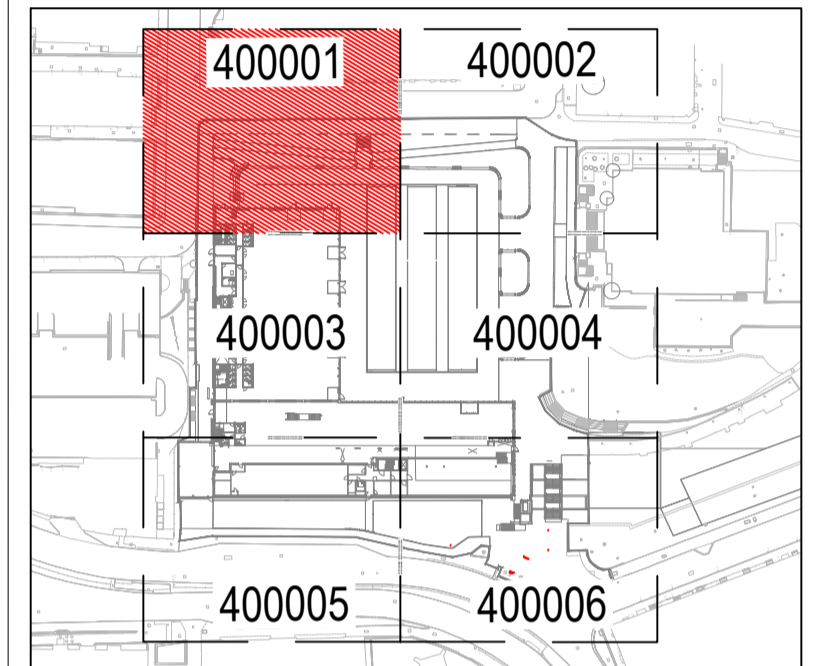

REFER TO DRAWING: IR430301-GIL-ZZ-00-DR-L-400001
REFER TO DRAWING: IR430301-GIL-ZZ-00-DR-L-400002

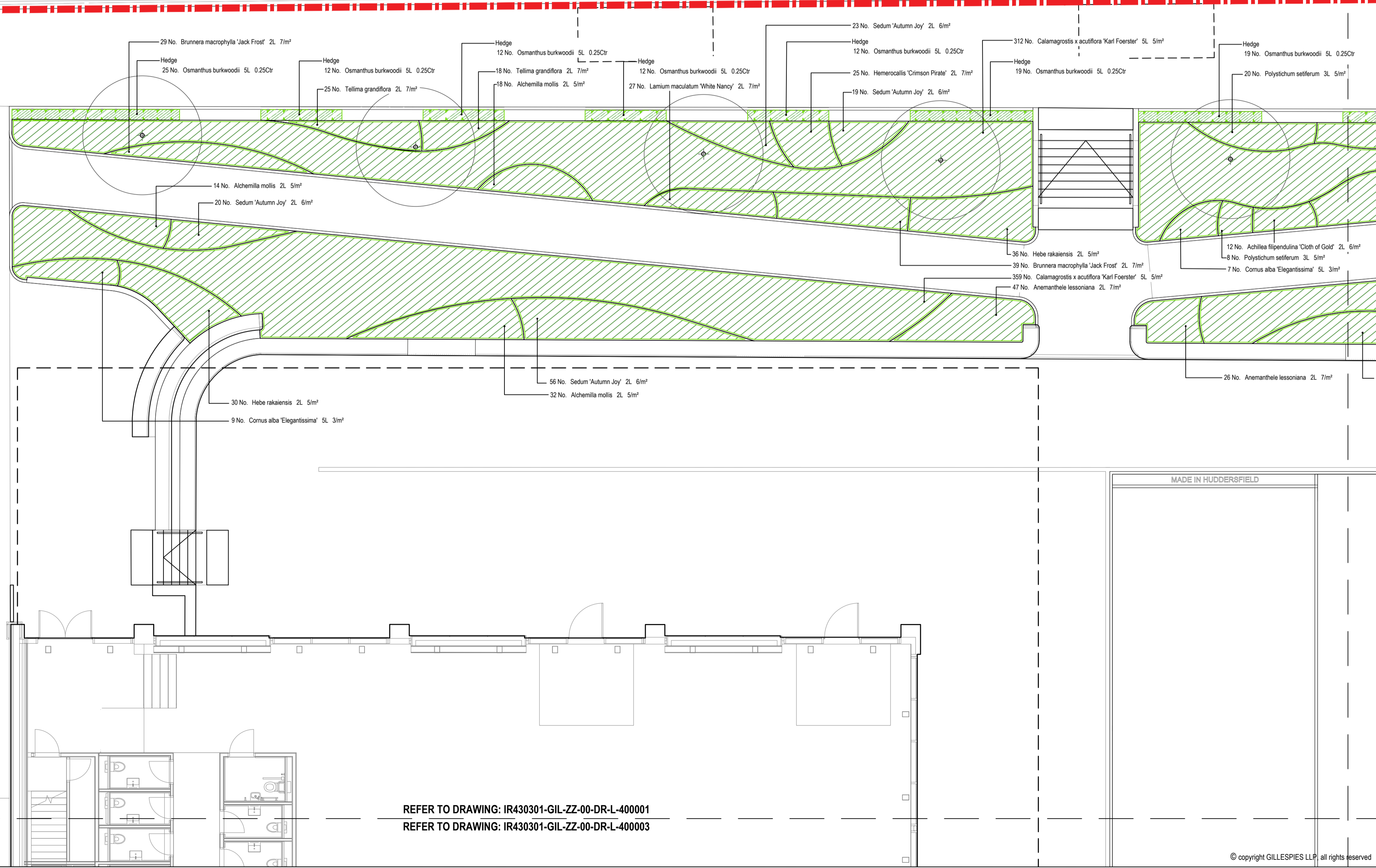

LEGEND

- Basement slab
- Existing Trees Retained
To be retained and protected in line with Arboricultural reports
- S1 - Species Rich Lawn Turf
Refer: IR430301-GIL-ZZ-00-DR-L-450001
605m² area (Q28.115A & Q30.400)
- S2 - Ornamental Planting
Refer: IR430301-GIL-ZZ-00-DR-L-450001
(Q28.135A & Q28.135B)
- S3 - Temporary Planting
Refer: IR430301-GIL-ZZ-00-DR-L-450001
(Q28.135A & Q28.135B)
- Hedge Planting (Single Row)
Maintained to a height of 1.2m
(Q28.135A & Q28.135B)
- Hedge Planting (Double Row)
Maintained to a height of 1.2m
(Q28.135A & Q28.135B)

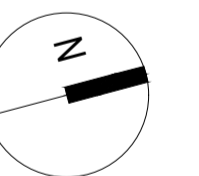

REFER TO DRAWING: IR430301-GIL-ZZ-00-DR-L-400001
REFER TO DRAWING: IR430301-GIL-ZZ-00-DR-L-400003

© copyright GILLESPIES LLP all rights reserved

Our Cultural Heart
Huddersfield

Planting Plan
Sheet 01

Stage	Drawing status	Scale	Drawn	Checked	Revision
STAGE 4	1:100 @ A1	JRD	RB		
	23.01.2024				
	Drawing number				

IR430301-GIL-ZZ-00-DR-L-400001 P01

Client
BAM

Gillespies

5th Floor, Phoenix House, 3 South Parade, Leeds, LS1 5DQ
P: 0113 247 0550 F: 0113 247 0550 E: design.team@gillespies.co.uk