

**Consultation Response from Mike Hibbert,
KC Waste Strategy(Refuse & Recycling)**

2024/92302 Huddersfield Bus Station, Upperhead Row, Huddersfield, HD1 2JN

Refurbishment comprising (phase 1): facade improvements including Henry Street entrance; replacement shop fronts; alterations to external bus apron; extension and alterations to existing barrier within the bus alighting lane adjacent to Henry Street; (phase 2): new entrance canopy; public realm improvements; cycle hub; facade improvements including replacement shop fronts

Date Responded: 13/11/2024.

Responding Officer: Mike Hibbert

Responding Ref: WPS 24-075

The application relates to the redevelopment of the bus station site. The comments below are in addition to Consultation response WPS 24-046 and reflect the submission of revised plans and information.

GA Floor Plan (Overall) Drawing Number HBS-AHR-XX-00-D-A-20-001 S2 Rev P4 dated 25/10/24 shows the location and orientation of the proposed main bin store. The dimensions are acceptable and the gates at either end enable access to both the Front-End Loader (FEL) skip and wheeliebins. Vehicular access for collection vehicles by shown by the hatched area in yellow.

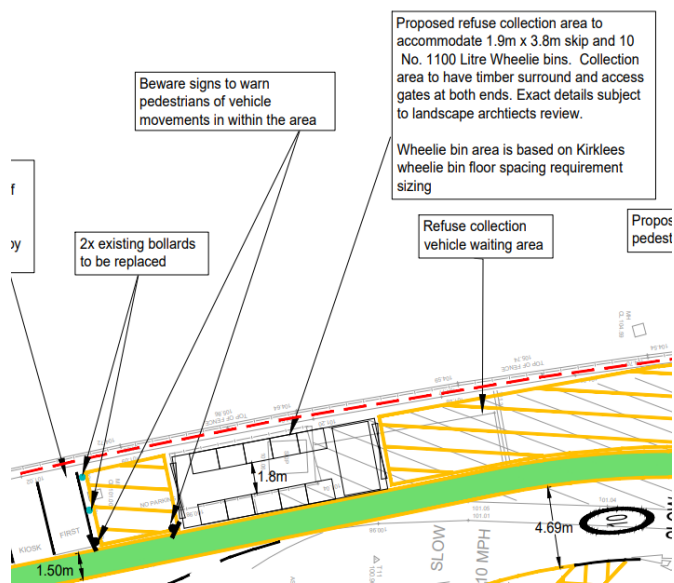

Bin store design drawing HBS-ECS-Z0-SL-DR-L-00004-P02 - Bin Store dated 25.06.24 Shows the design, specification and screening of the bin store. These proposals are acceptable.

A bin store is shown at the front of the bin station within the cycle store on GA Floor Plan (Overall) HBS-AHR-XX-00-D-A-20-001 S2 Rev P4 dated 25/10/2024.

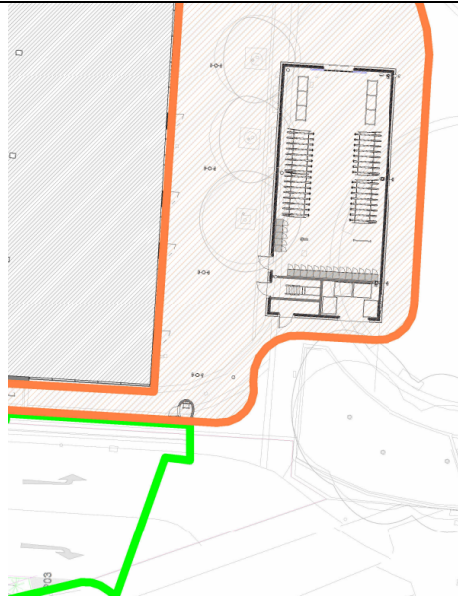

This bin store is also detailed on Page 31 of the Huddersfield Bus Station Design & Access Statement 2023.00190.000 Kirklees Council Planning Authority dated June 2024

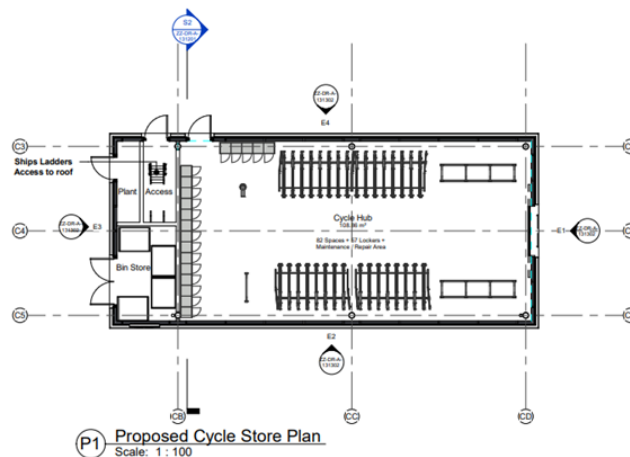

- **It is not clear from the plan for documentation what types/ capacity of wheeliebins will be used, the intended wastes to be stored and where the Bin Collection Point (BCP) with access for a Refuse Collection Vehicle (RCV) will be located.**
- The overall proposal should incorporate storage for specific waste arisings such as canteen/ food waste, baby changing/ sanitary waste, litter bins, vehicle washing effluent and maintenance wastes if required.
- There should be provision of litters bins and landscaping design layout must consider suitability for use of mechanical street sweeping equipment.
- It is not clear from the application if waste generated from tenants within the wider bus station building e.g. retail premises will be stored within the waste compound.