

# Castlegate A62

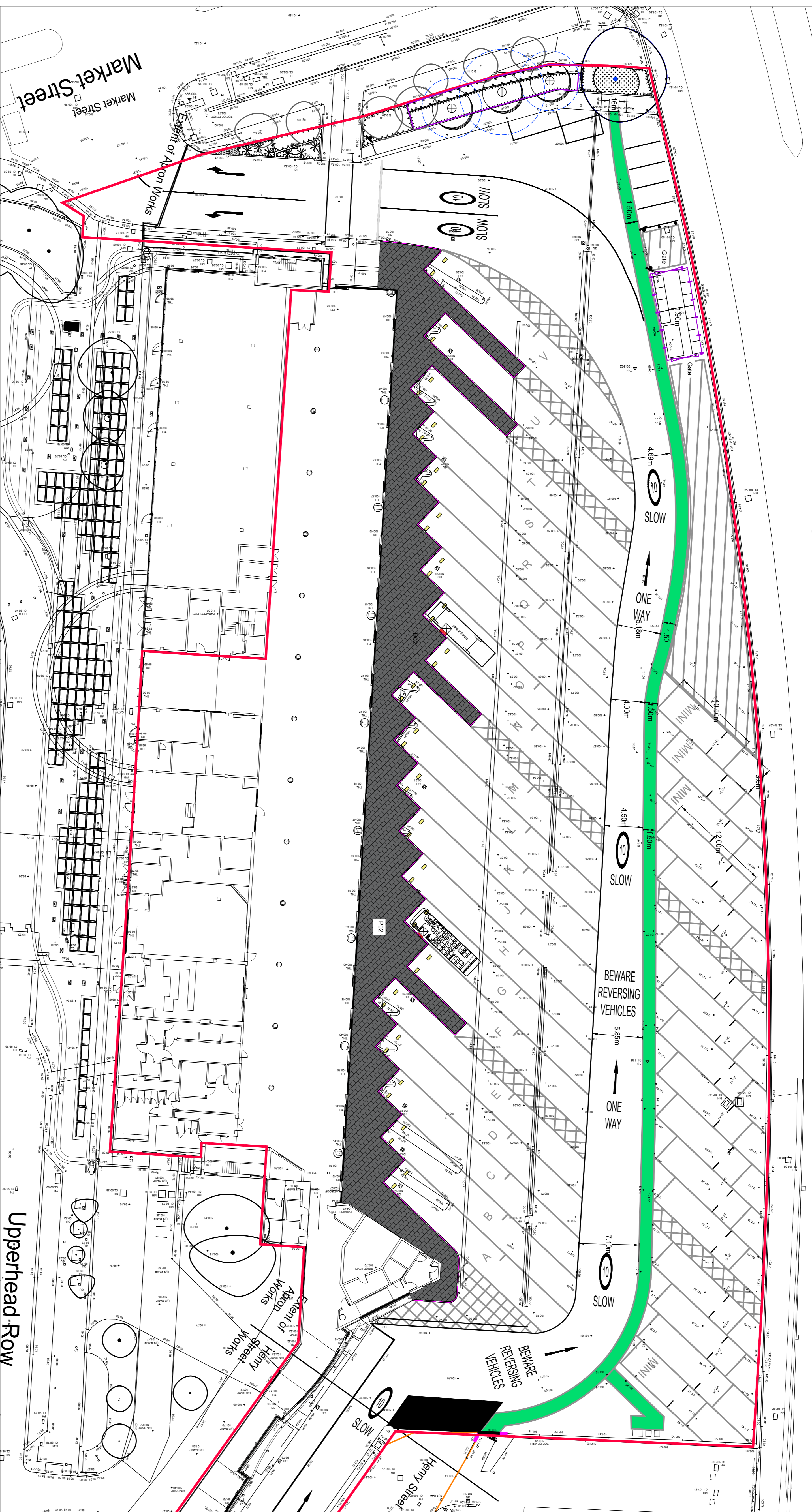

## KEY

- Existing (Cat B) Trees to be Retained - see Arboriculture report Huddersfield Bus Station - BS 5837/2012 Arboricultural Report, Impact Assessment and Method Statement\* produced by Ecus Ltd for further details
- Existing (Cat C) Trees to be Retained - see Arboriculture report Huddersfield Bus Station - BS 5837/2012 Arboricultural Report, Impact Assessment and Method Statement\* produced by Ecus Ltd for further details
- Existing tree as part of phase 2 - see Arboriculture report for further details
- Proposed Paving Type P01 - Asphalt for pedestrian loading
- Proposed Paving Type P02 - Concrete Flags, 600x400x50mm. Graphical colour: Mayfair by Tomorrow
- Proposed Paving Type P03 - Concrete Block Paving, 200x100x50mm. Slate colour: Fusion by Tomorrow or similar approved
- Proposed Kerb K01 - Precast Concrete Road Kerb, HB2 125mm wide x 914mm with all necessary drop/transition kerbs, laid in accordance with engineer's specification

- Proposed Kerb K02 - Conservation Style Kerb - Granite finish, 120mm wide x 914mm with all necessary drop/transition kerbs, laid in accordance with engineer's specification
- Proposed Traffic Signs Inductively, see Engineer's drawing X for further details
- Proposed Speed Induction Device - Shown inductively, see Engineer's drawing for further details
- Proposed Lighting - 6m column, see HBS/KCE/XX-XX-633/07 produced by Kazzen Consulting Engineers for further details
- Proposed Lighting - 10m column, see HBS/KCE/XX-XX-633/07 produced by Kazzen Consulting Engineers for further details
- Proposed Close boarded Fence: 2.4m high. Pressure treated timber from FSC approved source, with chartered capping rail, fixed in accordance with Engineer's details
- Proposed Double Leaf Gate, 2.4m high. Close boarded. Pressure treated timber from FSC approved source, fixed in accordance with Engineer's details
- Proposed Tree - Heavy Standard / Standard - see plant schedule for species and specification

- Indicate extent of tree's mature canopy spread (if it extends beyond tree graphic symbol)
- Proposed Root barrier - shown inductively, ReRoot 1000 (Ribbed) by GreenBlue Urban (www.greenblue.com) or similar approved
- Existing Vegetation to be protected and retained. Cut to 1m height at the appropriate time for the species.
- Proposed Hedge Planting - see plant schedule for species and specification
- Proposed Herbaceous / Perennial Planting - see plant schedule for species and specification
- Proposed Specimen Shrub - see plant schedule for species and specification

ID	RISK	MITIGATION	DATE OF MITIGATION
<b>RESIDUAL PROJECT RISKS</b>			
P03	24.10.24 JS	Ecus	Site layout updated & root barriers extended
P02	25.06.24 JS	Ecus	Bin store updated
P01	15.05.24 JS	Ecus	Preliminary

REV	DATE	BY	CHECKED	REVISION COMMENT
P01	15.05.24	JS	Ecus	Preliminary

**DRAWING STATUS:** Preliminary

	<b>ecus</b> Backburn Road Sheffield S61 2DW Tel: (0114) 268292 www.ecus.co.uk
	Job: <b>Huddersfield Bus Station, Upperhead Row, Huddersfield</b> Title: <b>Landscape Proposals - General Arrangement</b>

Drawn by	Date	Scale
JS	Mar 24	1:250 at A1

Dwg. no.	Revision
HBS-ECS-Z0-SL-DR-L-00001	P03

### GENERAL NOTES

- Drawing for Planning purposes only
- Ecus drawing document references:
  - HBS-ECS-Z0-SL-DR-L-00001 General Arrangement
  - HBS-ECS-Z0-SL-DR-L-00002 Planning Plan sheet
  - HBS-ECS-Z0-SL-DR-L-00003 Outline Soft Specification & Nameplate Schedule
  - HBS-ECS-Z0-SL-DR-L-00004 "XXXXX" for details of existing vegetation to be retained and protection measures. All works within the vicinity of the existing trees to be overseen by an appointed qualified Arboricultural consultant acting as ECOW in accordance with the Arboricultural Method Statement.
- Site Layout provided by BSGH Ltd on drawing no:
  - HBS-BG-H-20-XX-DR-C-0021 P01
- Building foundations to be confirmed by Engineer with reference to planning proposals and NHBC guidance (or alternative where applicable). Tree locations to be fully co-ordinated once building foundation depth are confirmed. Requirements for root barriers to be confirmed by an engineer. Refer to Engineer's details for level and drainage information
- Levels to be confirmed following coordination with the design team to be verified by the contractor with any variations to be reported to the design engineer
- For lighting proposals, see HBS-KCE/XX-XX-D-E-6310\* produced by Kazzen Consulting Engineers
- Setting out on site to be agreed with Landscape Architect
- Check all dimensions on site
- Do not scale from this drawing
- Report any discrepancies and omissions to Ecus Ltd
- This drawing is Copyright
- All levels indicative only. Extrapolated from site levels. All require to be checked.
- All details subject to approval by the local authority for the discharge of relevant planning conditions.

### 3RD PARTY INFORMATION

NB The information provided by independent suppliers and/or consultants, to whom all queries shall be made. Ecus Ltd can accept no liability for its context or accuracy.

### DESIGN

Unless stated otherwise, the designs shown are subject to detailed site survey, investigations, and legal definition, the CDM regulations and the comments and / or approval of the various relevant local Authority Officers, Statutory Undertakers, Fire Officers, Engineers and the like. They are copyright, protected specific and confidential. No part is to be used or copied in anyway without the express prior consent of Ecus Ltd

### NOTE NOTES:

- Note that all tree and shrub locations are subject to coordination with services to be undertaken by others. The requirement for root barriers is to be confirmed by an engineer.
- Note that it is best practice that root barriers are required to extend 2m beyond the mature canopy spread of new trees to protect all structures and buildings. In addition, root barriers are required for all new trees within 5m of highways - e.g. GreenBlue Urban Retroot 2000\* or similar. Depth of tree root barrier to be confirmed by an engineer or see services design has been produced at construction detail. Install to manufacturer's and engineer's guidance

### CDM - Risks / Hazards

1. Proposed locations of landscape elements shown are subject to the presence of below ground services. A detailed survey is to be undertaken and necessary method statements prepared and approved prior to undertaking any excavations / work within this area
2. Care to be taken when working in proximity to the surrounding existing roads
3. Care to be taken when clearing the existing site due to the potential presence of needles, litter etc.

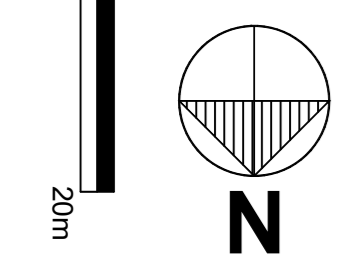

SCALE BAR 1:250